

# Modern Mid-Century 12-Light Sputnik Glass Globe Chandelier

**Caution:** Please turn off power before installation and read the manual carefully, we advise you contact professional electricians to install for safety purpose.

## Product Features

Style: Modern

Material: Metal, Glass

Base Type: E26

Light Source Included: No

Voltage: 120VAC

Wattage: 40W

## Package includes

1 x Chandelier

1 x Accessories Kit

1 x User's Manual

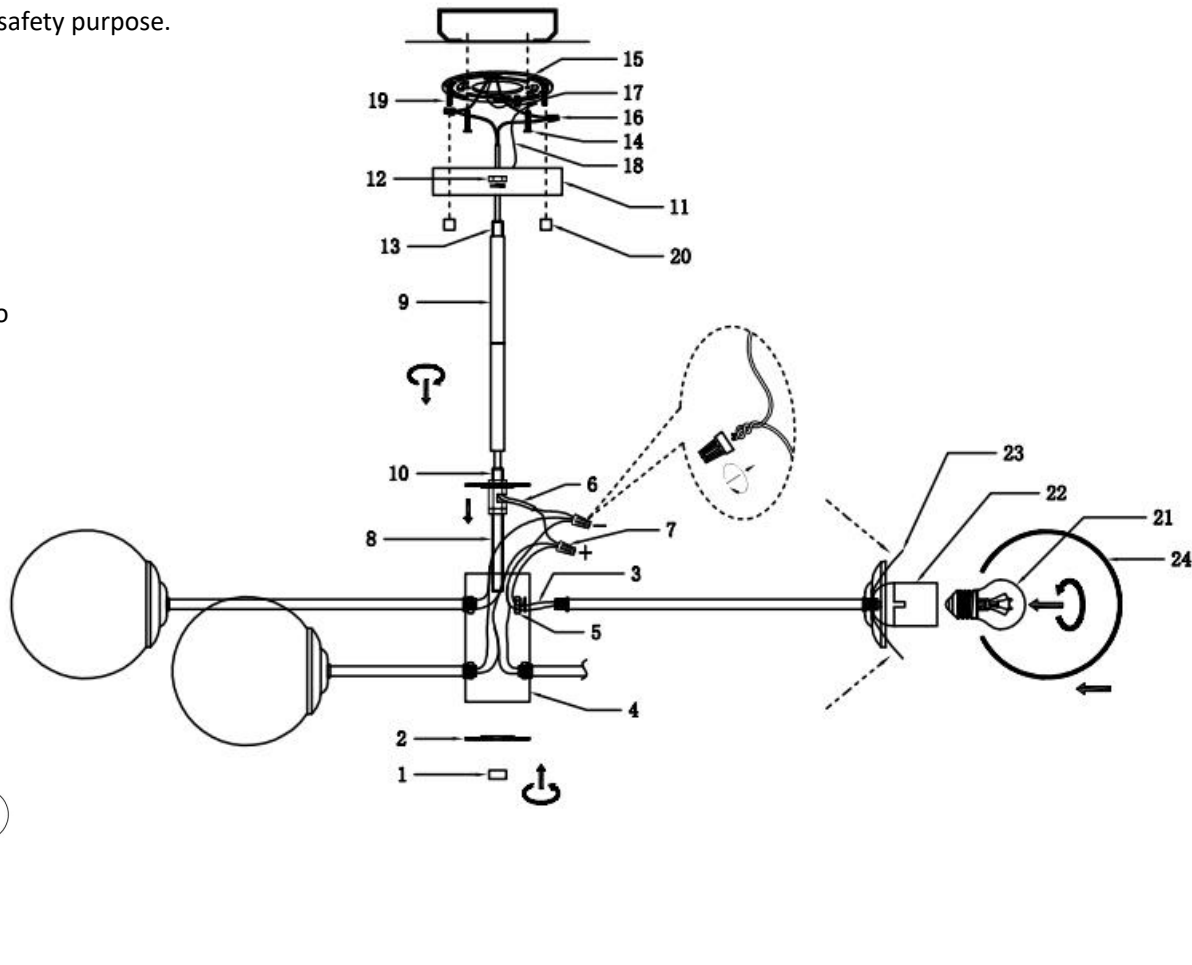

## Installation Instructions

A: Loosen the cap nut (1) and remove the lamp housing cover (2).

B: Pass the lamp arm wires (3) through the side hole of the lamp housing (4), then tighten the nut (5).

C: Connect the live wire of the lamp arm (3) to the live wire of the main wire (6) using a wiring cap (7). Similarly, connect the neutral wire to the neutral wire of the main wire (6) using a wiring cap (7). Be careful not to expose the wire to prevent leakage.

D: Insert the threaded (8) through the lamp housing (4) and secure it with the nut (1).

E: Pass the main wire (6) through the hanging rod (9), then screw the hanging rod (9) onto the threaded (10). Next, pass the main wire (6) through the center hole of the ceiling plate (11) and secure it with the nut (12) onto the threaded (13).

F: Fasten the mounting plate (15) to the junction box using the junction box screws (14).

G: Connect the live wire of the main wire (6) to the live wire by using the wiring cap (16), and also connect the neutral wire of the main wire to the neutral wire by using the wiring cap (16). Be careful not to expose the wire to prevent leakage. Fixed the ground wire and the ground wire of the fixture (18) on the mounting plate (15) through the green screw (17).

H: Insert the mounting plate screws (19) through the two small holes on the ceiling plate (11), then tighten the ball nut (20) to secure the fixture.

I: Screw the light bulbs (21) into the lamp sockets (22) and test to ensure it lights up.

J: Press the spring clip (23) and install the glass shade (24) into the spring clip (25).

**Note:** please use this product accordingly to its intended purpose, do not retrofit or remodeling the product. The warranty does not cover if the failure is caused by the third party product, or natural disasters.

Made in China