

MoNiBloom

SEWING MACHINE TABLE Installation instruction

SKU : SMT-001-60

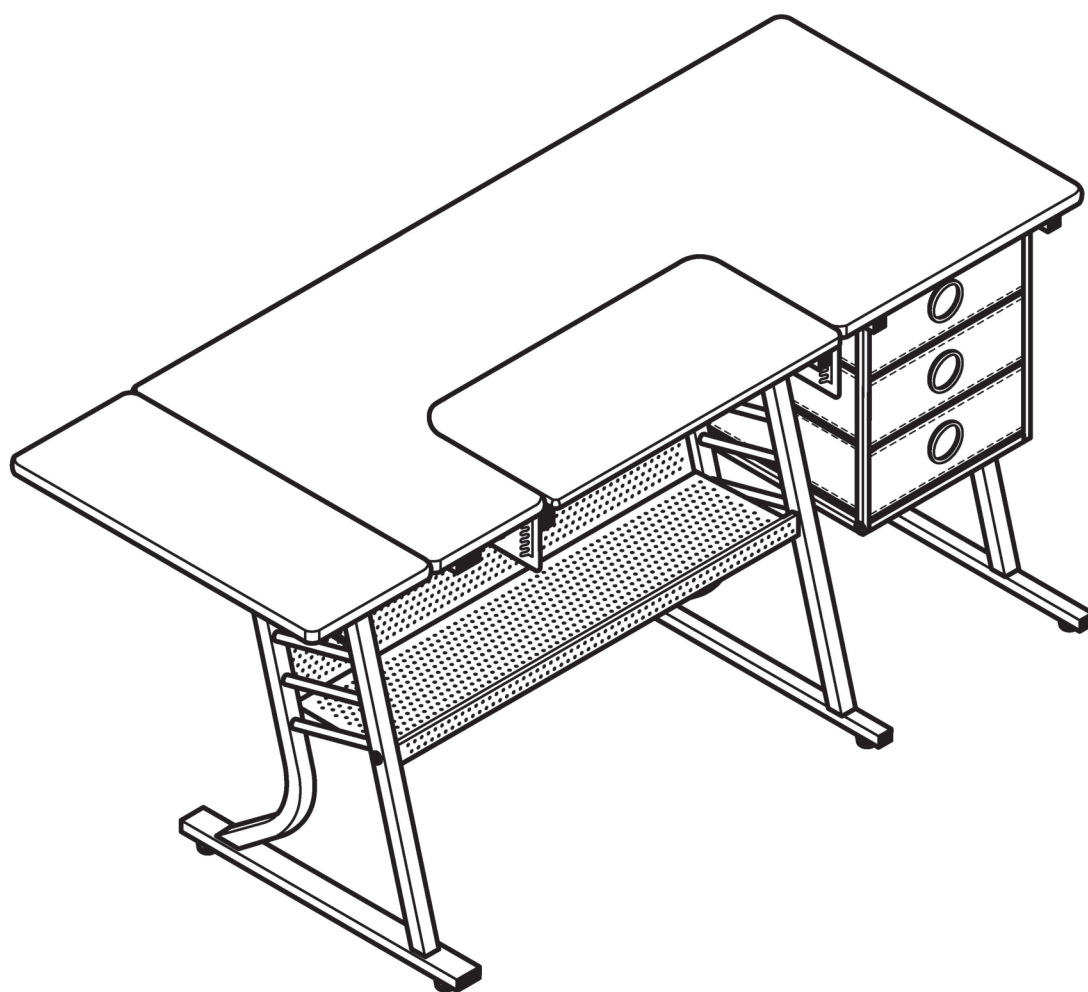

Scan the QR code
to view the
assembly video.

1. Left table Leg

1

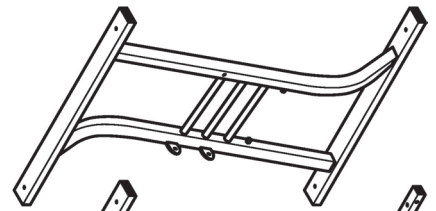

2. Center table leg

1

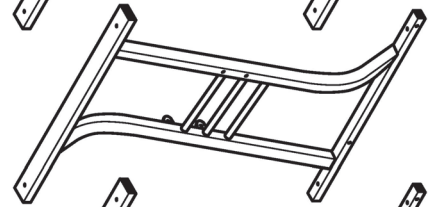

3. Right table leg

1

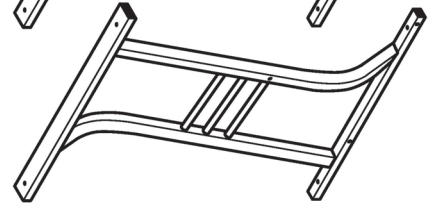

4. Table top

1

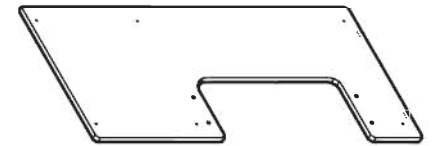

5. Adjustable Table Platform

1



6. Side Shelf

1

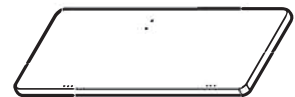

7. Rear Shelf

1



8. Lower Shelf

1

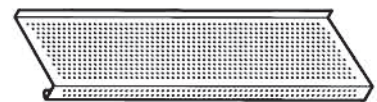

9. Left Bracket

1

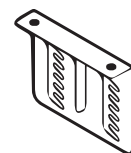

10. Right Bracket

1

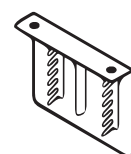

11. Platform Bar

2

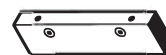

12. Drawer Frame Left Side

1

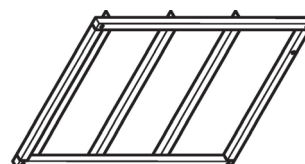

13. Drawer Frame Right Side

1

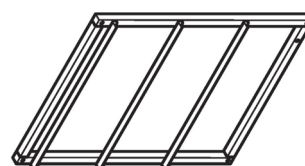

14. Drawer Crossbar

2



15. Cloth Drawer and Bottom Panel

3

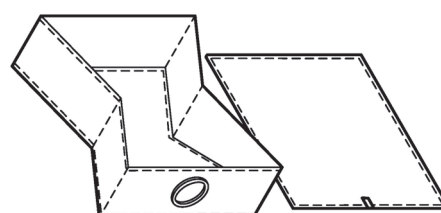

16. Shelf Support

1

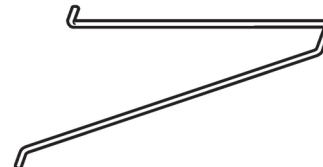

17. Plastic Bracket

1



18. Hinge

2



19. Floor Leveler

6

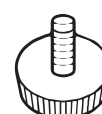

20. Nut

10



21. Allen Bolt - 6mm x 12mm

8

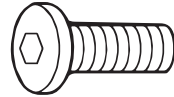

22. Allen Bolt - 6mm x 20mm

4

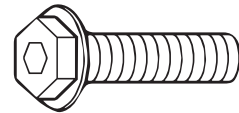

23. Allen Bolt - 6mm x 30mm

8

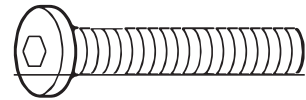

24. Allen Bolt - 6mm x 50mm

4

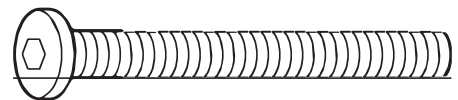

25. Allen Bolt - 6mm x 20mm

4

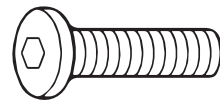

26. Allen Bolt - 6mm x 40mm

6

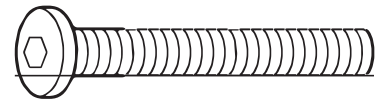

27. Philips Screw (round) 14mm

14



28. Allen Key

1

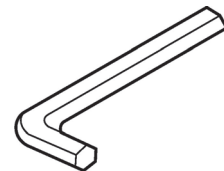

29. Hex Wrench

1

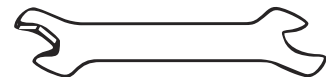

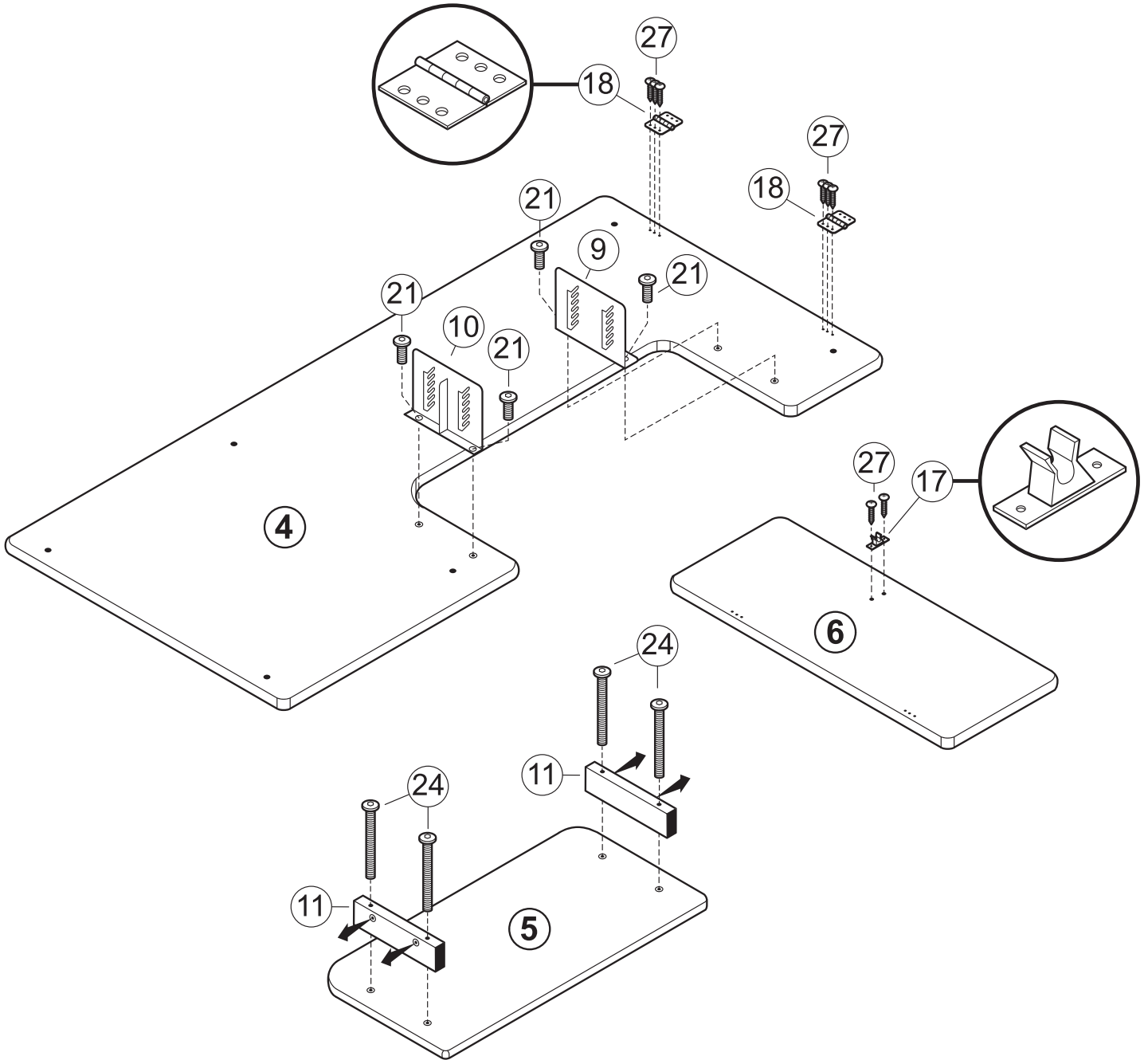

Part #11 - Ensure all holes are located near the top, facing outwards, use arrows as reference.

Ensure tabs are facing inwards, use arrows as reference.

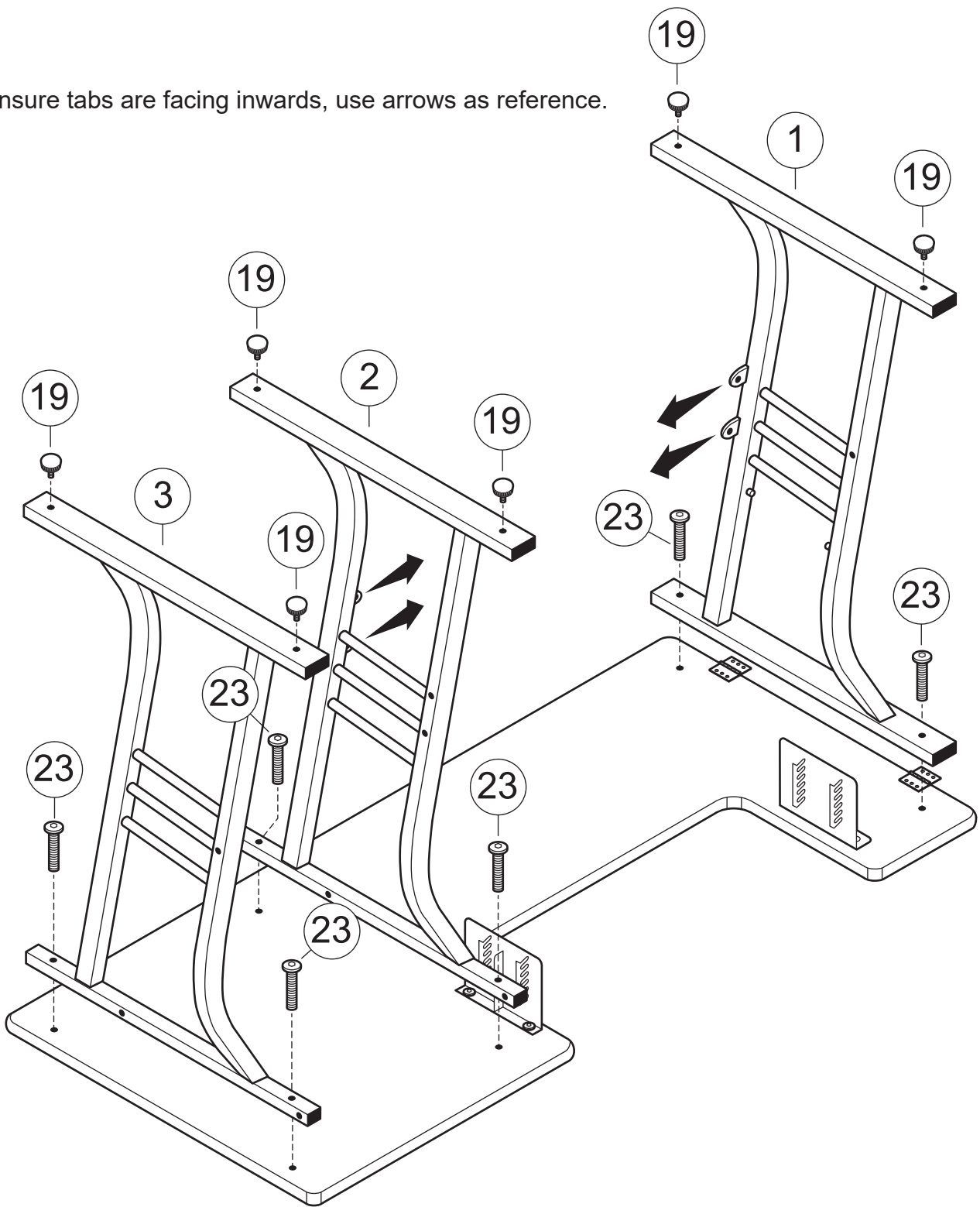

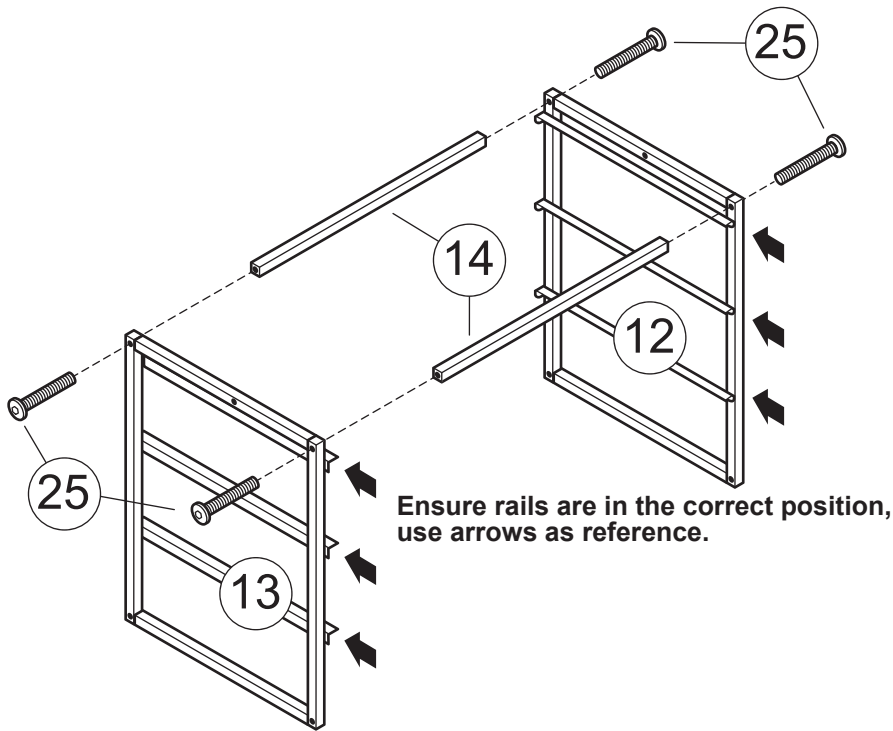

Ensure rails are in the correct position, use arrows as reference.

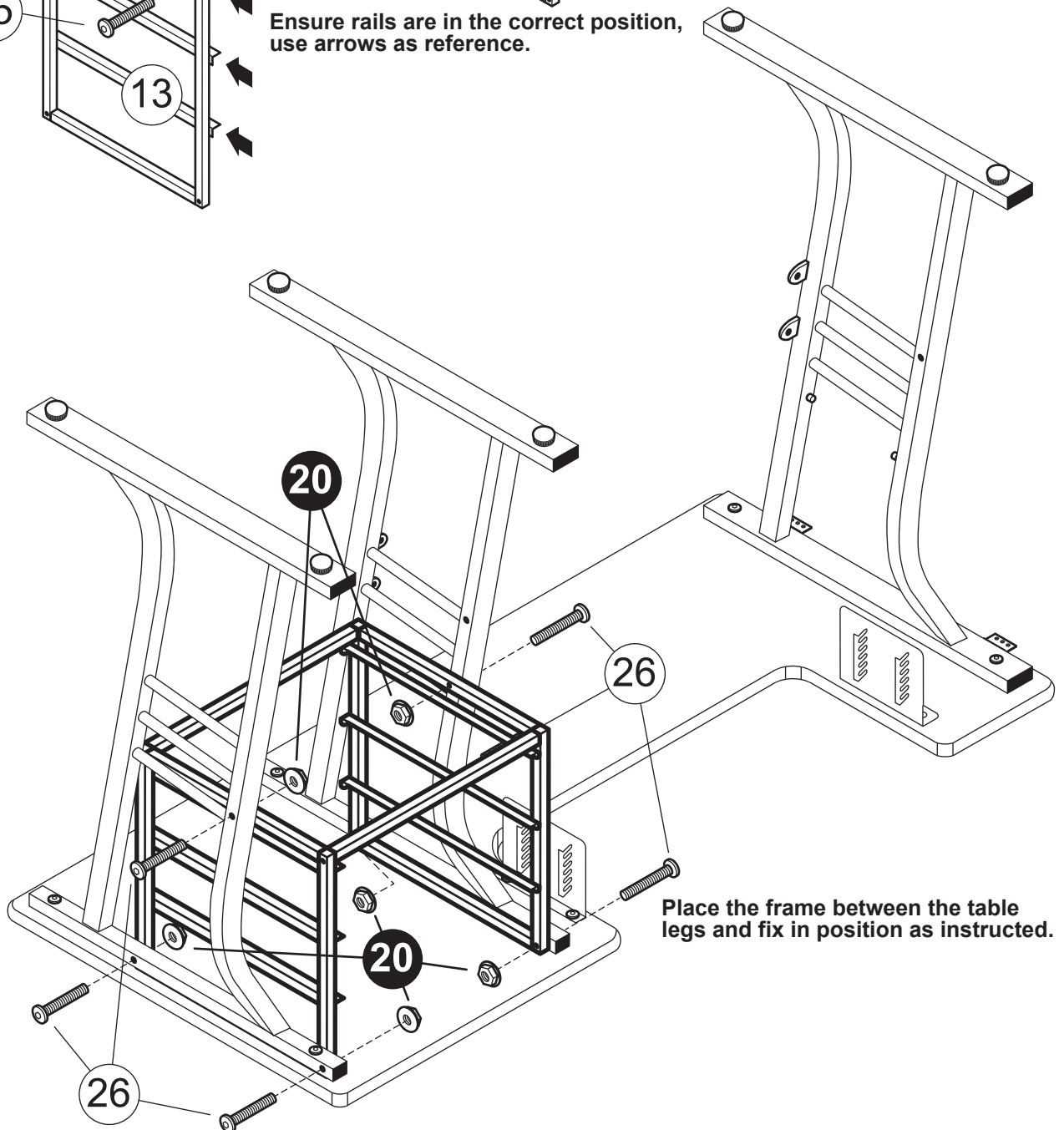

Place the frame between the table legs and fix in position as instructed.

First install the Rear Shelf (7), then place edge of Lower Shelf (8) under Rear Shelf (7).

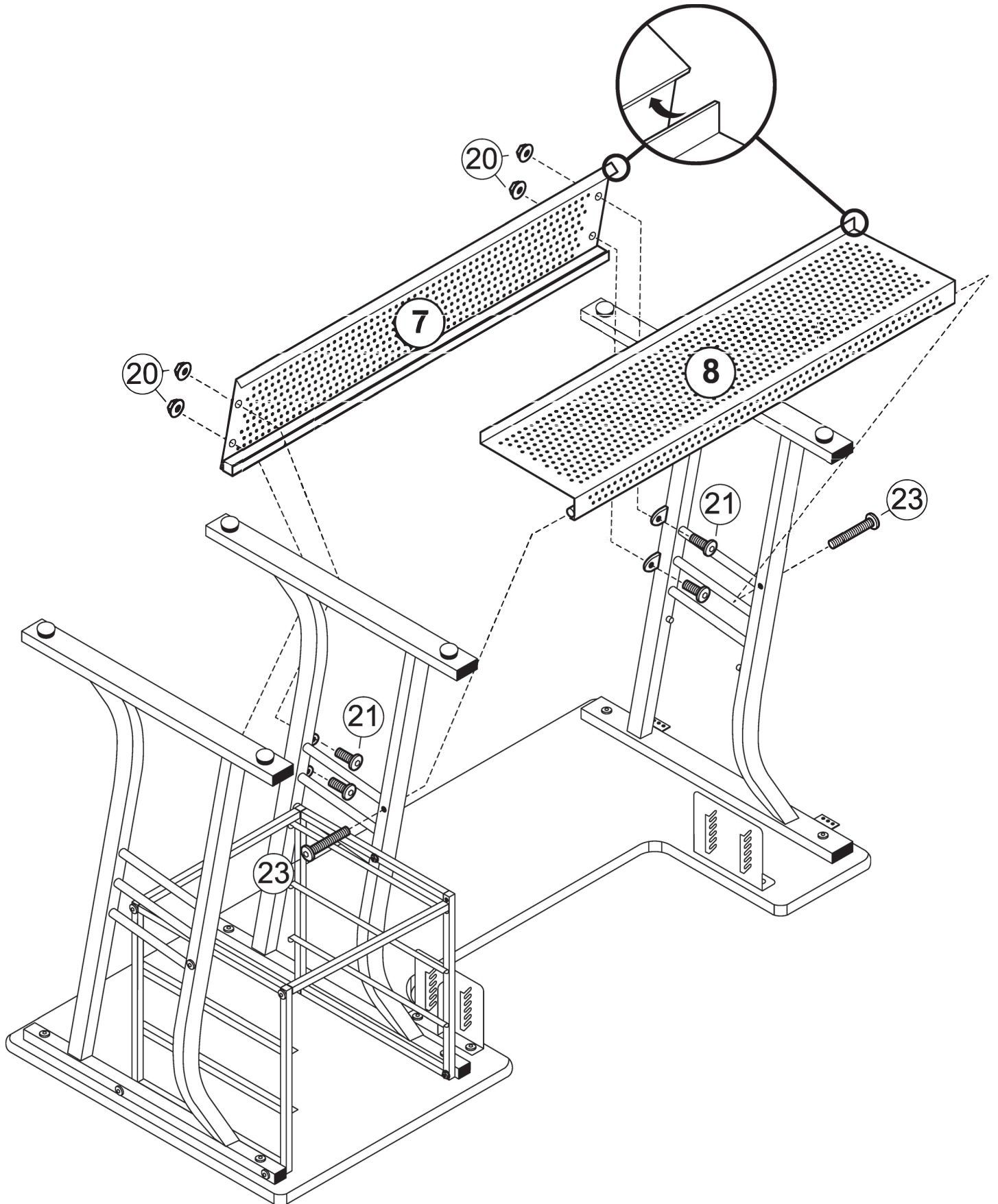

Warning: This task should be performed by 2 persons.

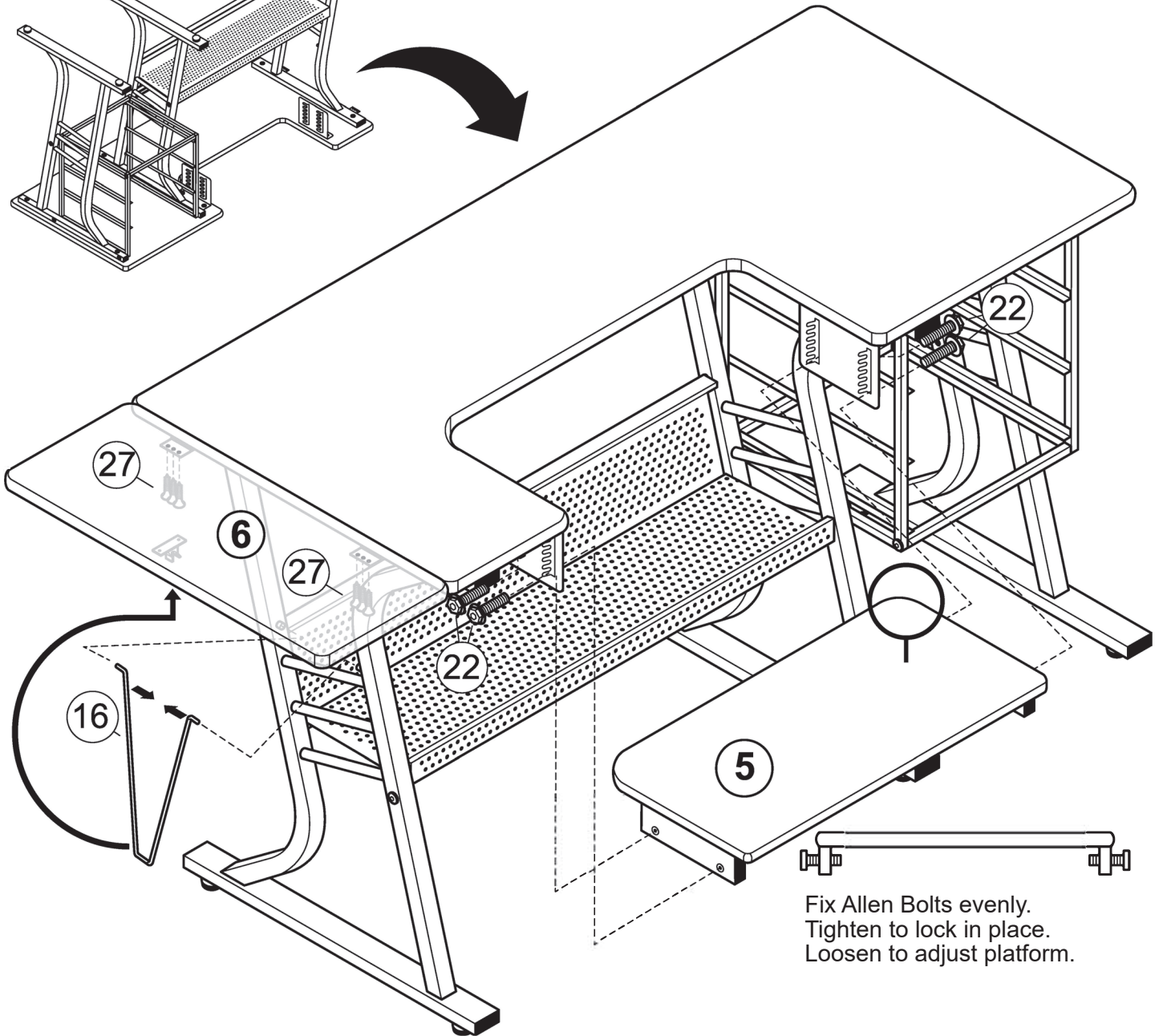
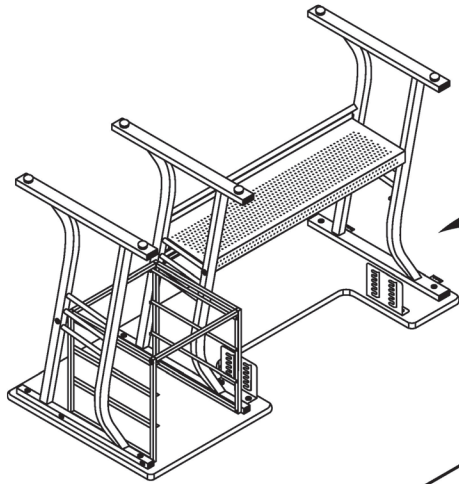

Fix Allen Bolts evenly.
Tighten to lock in place.
Loosen to adjust platform.

