

ASSEMBLY INSTRUCTIONS

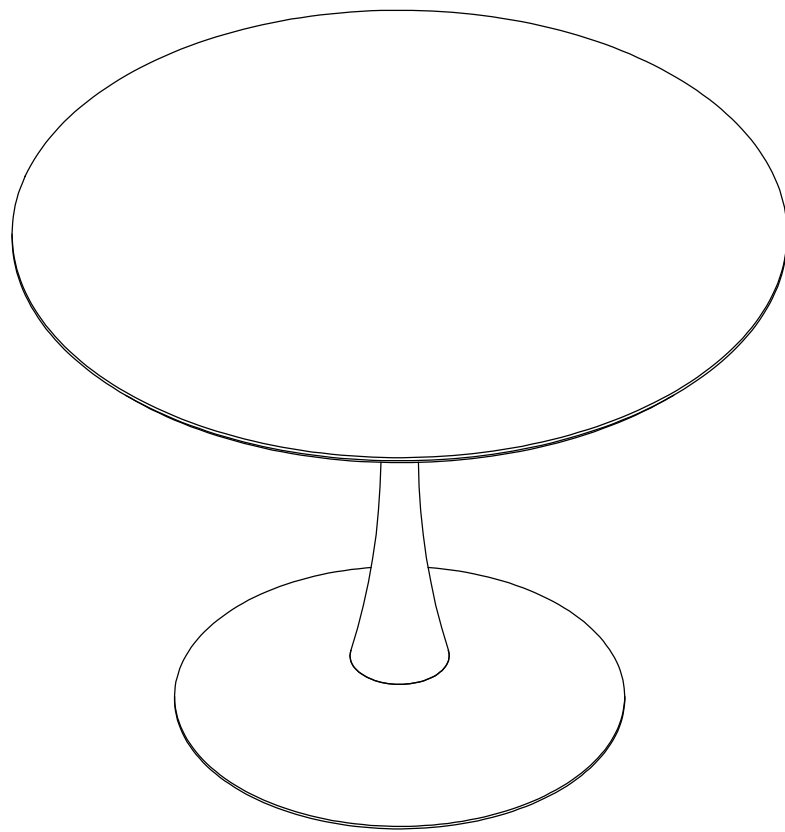

Round Dining Table

ASSEMBLY INSTRUCTIONS

ASSEMBLY TIPS:

1. Remove hardware from box and sort by size.
2. Please check to see that all hardware and parts are present prior to start of assembly.
3. Please follow attached instructions in the same sequence as numbered to assure fast & easy assembly.



WARNING!

1. Don't attempt to repair or modify parts that are broken or defective. Please contact the store immediately.
2. This product is for home use only and not intended for commercial establishments.

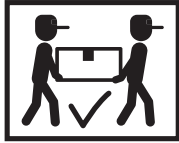

ASSEMBLY TIME

30 MINUTES

PARTS IDENTIFICATION

No	DESCRIPTION & FIGURE	QTY
A	<p>TOP</p>	1pc
B	<p>MAIN POST</p>	1pc
C	<p>MOUNTING PLATE</p>	1pc
D	<p>BASE COVER</p>	1pc
E	<p>BASE</p>	1pc
F	<p>ISOLATION BLOCK</p>	1pc

HARDWARE PACKAGE:

No	DESCRIPTION	FIGURE	QTY
1	BOLT	M6×15mm	4pcs
2	SPRING WASHER	Ø6mm	4pcs
3	WASHER	Ø16×Ø6×1mm	4pcs
4	BOLT	M8×25mm	6pcs
5	SPRING WASHER	Ø8mm	6pcs
6	WASHER	Ø17×Ø8×1.2mm	3pcs
7	WASHER	Ø14×Ø8×1.2mm	3pcs
8	BOLT	M12×98mm	1pc
9	BOLT	M12×35mm	1pc
10	SPRING WASHER	Ø13mm	2pcs
11	WASHER	Ø44×Ø13×3.5mm	1pc
12	WASHER	Ø22×Ø12×1.5mm	1pc
13	ALLEN KEY (4mm)		1pc
14	ALLEN KEY (5mm)		1pc
15	ALLEN KEY (10mm)		1pc

STEP 1

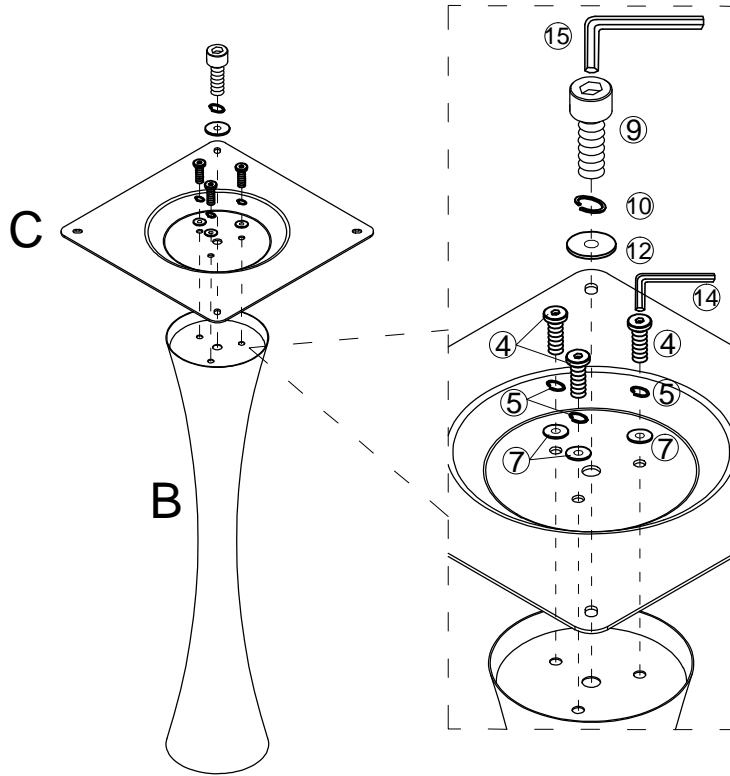

STEP 2

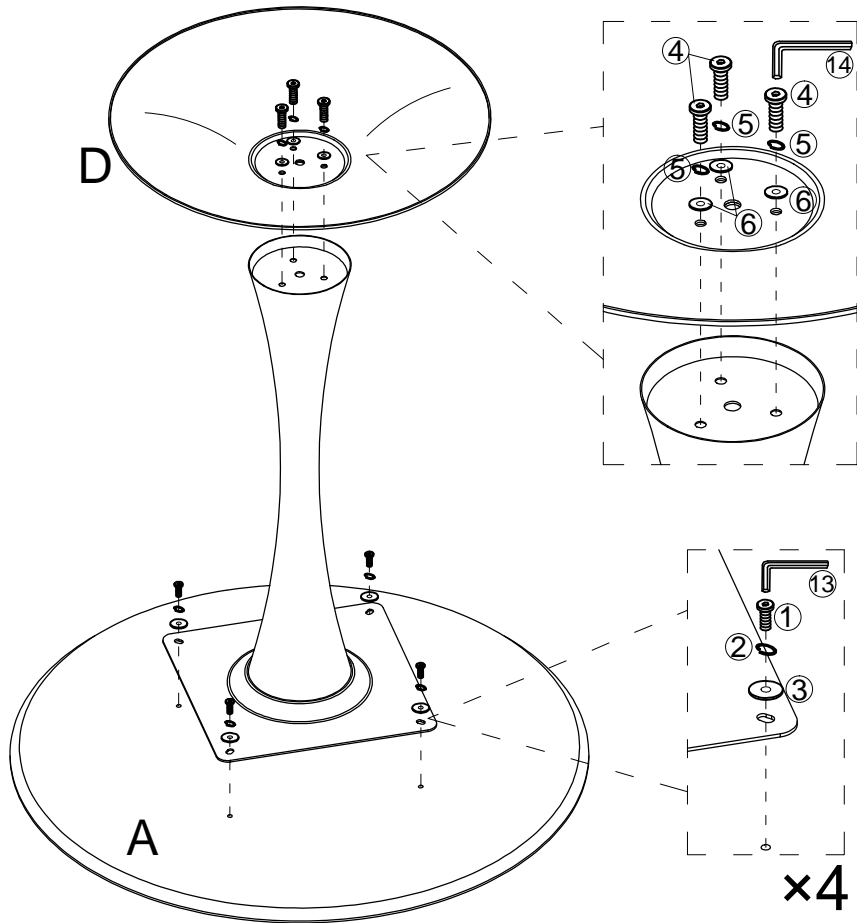

STEP 3

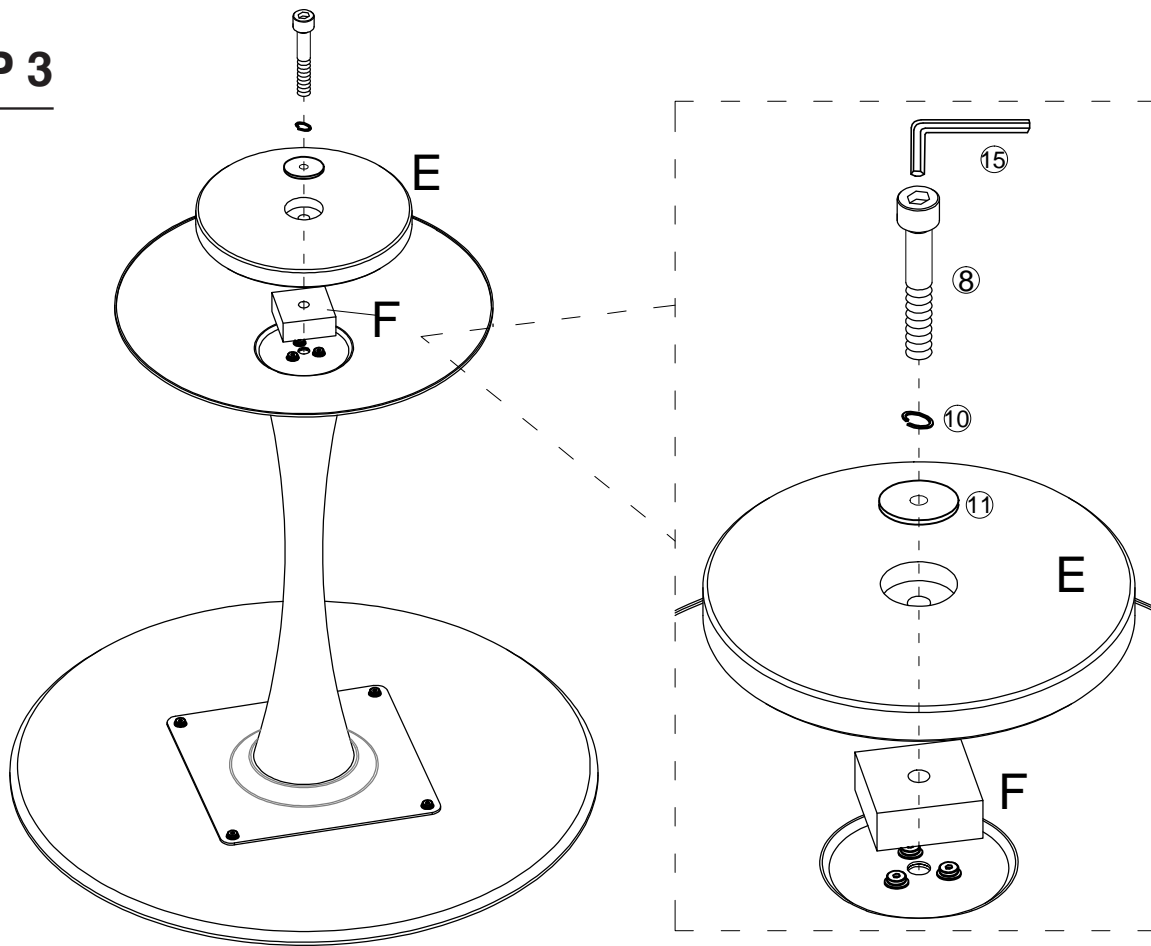

STEP 4 **COMPLETE**

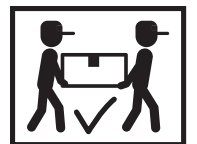
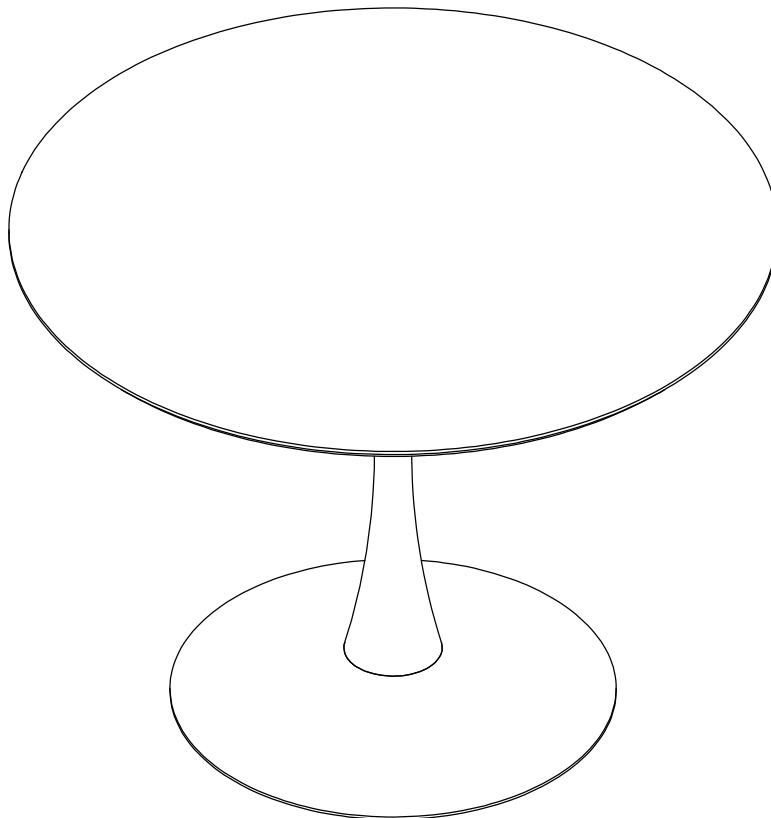

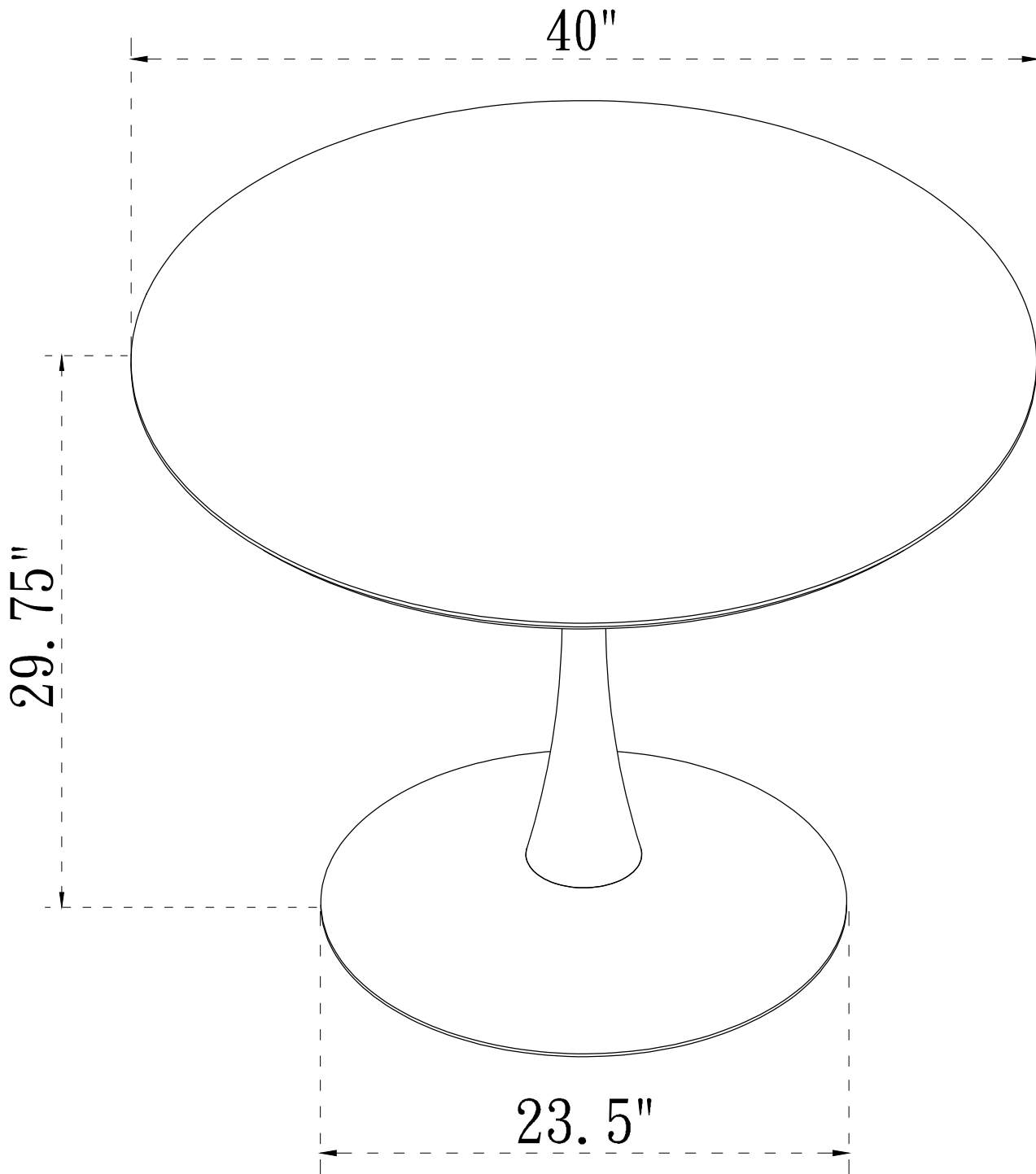

Note: Dimension tolerance $\pm 5\%$