

INSTALLATION MANUAL

WOOD FRAME MIRROR

ACCESSORIES LIST

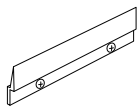

Bracket

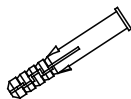

Wall Anchor-A



Wall Anchor-B



Short Screw



Long Screw

TOOLS REQUIRED

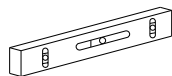

Level Ruler



Marker



Hammer



Tape Measure

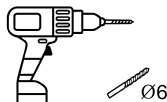

Electric Drill

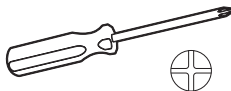

Phillips Screwdriver



Safety Goggles

INSTRUCTIONS

1. Confirm the locations of four drill holes with the positioning ruler provided, and mark them on the wall.

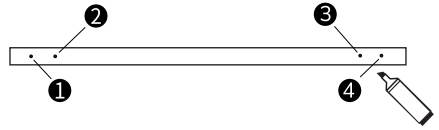

2. Use an electric drill to punch holes at the marked spots, and then apply wall anchors with a hammer.

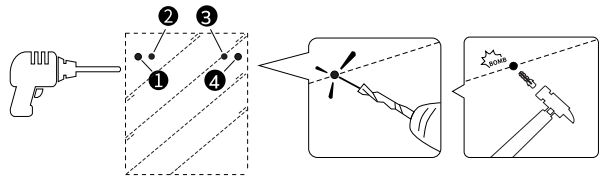

Thickness of Wall

Recommended Drill Bit

> 16mm



1/4" (6mm) drill bit, drilling depth in 1 31/32" (50mm)

8 ~ 16mm



25/64" (10mm) drill bit

< 8mm

Unapplicable

Note: Please wear goggles and pay attention to safety.

3. Screw the two brackets to the wall.

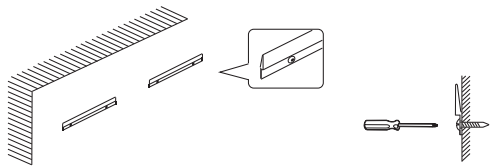

4. Place the mirror against the wall, align the hook with the mounted bracket, slowly lower the mirror down, and make sure that it slots into the right position and hangs securely.

