

WARNING

WARNING: To avoid fire, shock and serious personal injury, please read the following instructions carefully.

Important Safety Instructions

- 1: Read all instructions and safety information before installing your new fan. Review the accompanying assembly diagrams.
- 2: Before installing the fan, disconnect the power by removing fuses or turning off circuit breakers.
- 3: Make sure all electrical connections comply with local codes, ordinances, or National Electrical codes. Hire a qualified electrician or consult a do-it-yourself wiring handbook if you are unfamiliar with installing electrical wiring.
- 4: Make sure the installation site you choose allows the fan blades to rotate without any obstructions. Allow a minimum clearance of 7 feet from the floor to the trailing edge of the blades.
- 5: If you are mounting the fan on a ceiling outlet box, use a metal outlet box. Secure the box directly to the building structure. The outlet box and its support must be able to support the moving weight of the fan (at least 50 lbs). Do not use a plastic outlet box. Attach the mounting bracket by using the hardware supplied with the ceiling outlet box.
- 6: If you are mounting the fan to a joist, make sure it is strong enough to support the moving weight of the fan (at least 50 lbs.).
- 7: After installing the fan, make sure all the connections are secured. This will prevent the fan from falling.
- 8: Do not insert anything into the fan blades while the fan is operating.
- 9: Turn the fan off and wait for it to stop before reversing fan direction.
- 10: To reduce risk of electrical shock and personal injury, do not install the fan on a sloped ceiling.
- 11: To reduce the risk of electrical shock and personal injury, do not use this fan with any solid-state.
- 12: To reduce risk of personal injury, use only the two steel screws and lock washers provided with the fan for mounting the outlet box.

PART AND ACCESSORIES

Ref. #	Parts List	Part #
1	Hanging board	1
2	Canopy	1
3	Fan body	1
4	Lamp panel	1
5	LED	1
6	Blade	3
7	Shade	1
8	Screw Pack	2
9	Remote Control	1

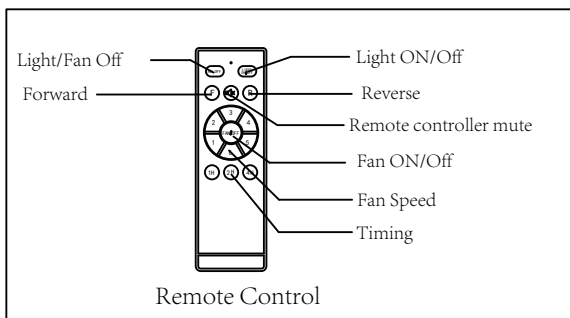
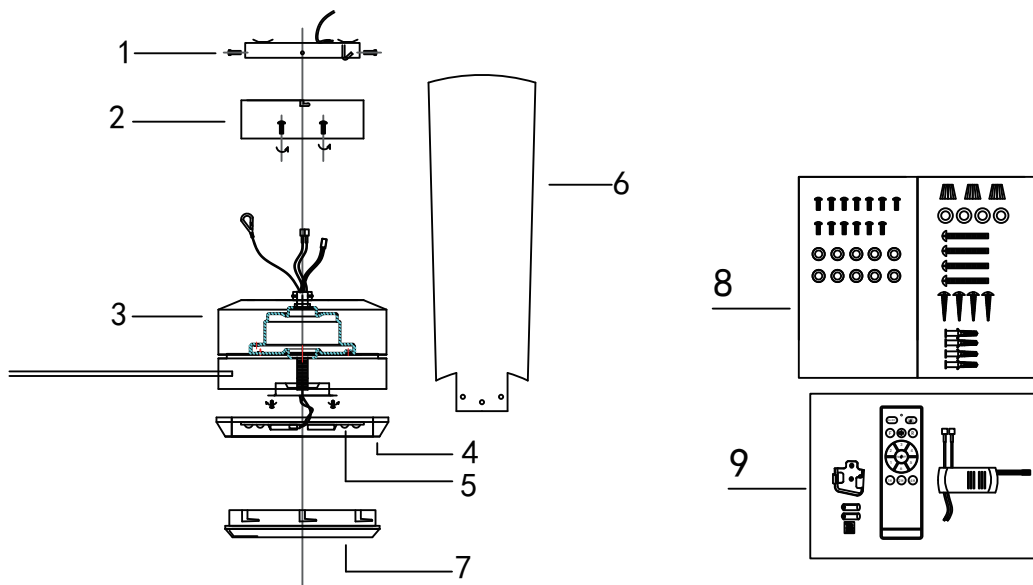

Installation Procedure

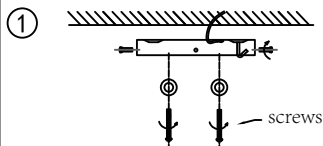

Lock the hanging board on the ceiling

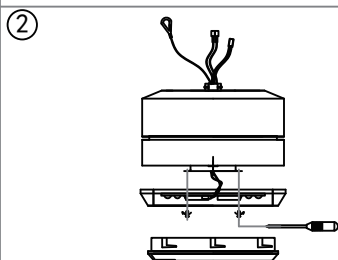

Remove the lampshade and light panel first

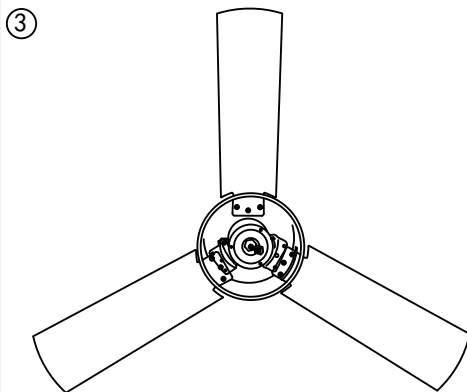

Lock the fan blades onto the corresponding blade forks using screws and red washers

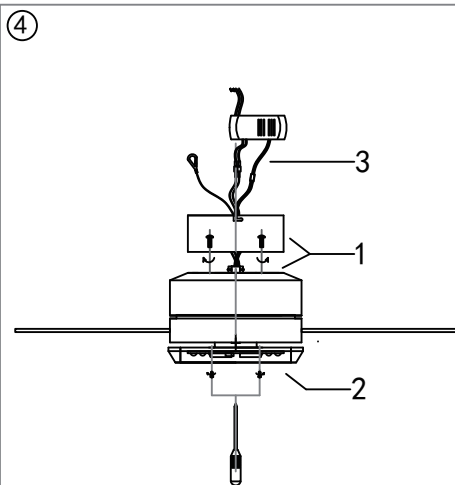

- 1: Lock the suction tray
- 2: Locking the light panel
- 3: Connect the receiver properly

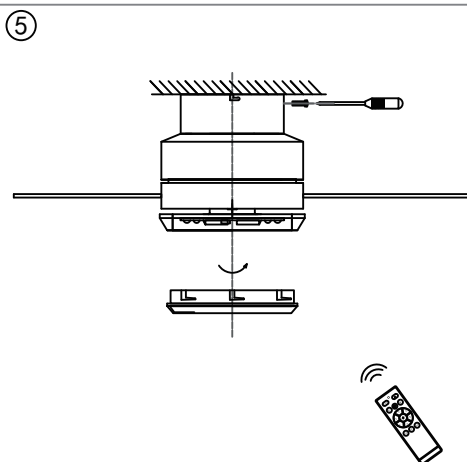

- 1: Tighten the screws on the suction tray and secure the lampshade
- 2: Thank you for using our product