

ASSEMBLY & INSTALLATION INSTRUCTIONS

A708

Mobius Mini Pendant 184530

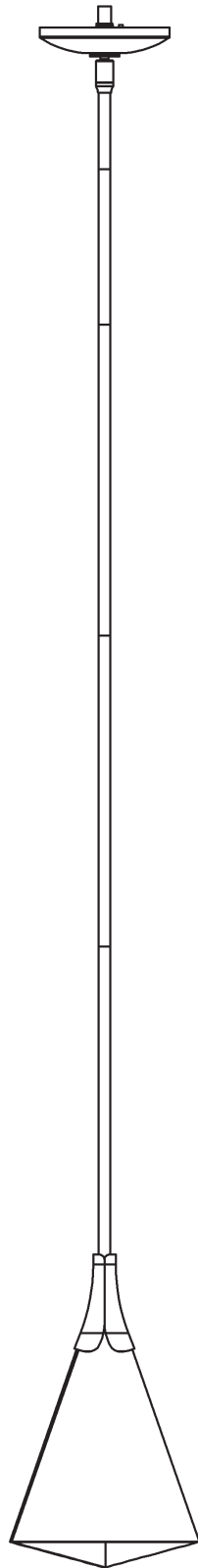

HUBBARDTON FORGE.

MODERN AMERICAN BLACKSMITHS | FINE, HAND CRAFTED LIGHTING
CASTLETON, VERMONT USA | HUBBARDTONFORGE.COM

Component Parts

- A Fixture**
- B Fixture Coupling**
- C Crossbar**
- D Jam Nut**
- E Threaded Nipple**
- F Ground Screw**
- G Canopy Ring**
- H Canopy**
- I Swivel**
- J 3" Fixture Pipe (1)**
- K 6" Fixture Pipe (1)**
- L 12" Fixture Pipe (3)**
- M Stem Nipple (5)**
- N Socket**
- O Bulb (not included)**
- P Flat Shade Panel (1)**
- Q Male End Plastic Button (4)**
- R Female End Plastic Button (4)**
- S Shade Assembly**
- T Retaining Ring**
- U Spacer**



ASSEMBLY & INSTALLATION INSTRUCTIONS

A708

Mobius Mini Pendant 184530

CAUTION: FAILURE TO INSTALL THIS FIXTURE PROPERLY MAY RESULT IN SERIOUS PERSONAL INJURY OR DEATH AND PROPERTY DAMAGE. We recommend installation by a licensed electrician. This product must be installed in accordance with applicable installation code(s), by a person familiar with the construction and operation of the product and the hazards involved.*

Caution: Do not exceed maximum wattage noted on fixture. Use only recommended bulbs with fixture.

Please Note: After installation extra hardware and accessories are possible due to our kits are used on multiple products and options.

To Install Fixture (Figure 1) on following page

CAUTION: BE SURE POWER IS OFF AT THE MAIN BREAKER BOX PRIOR TO INSTALLATION.

1. Carefully unpack fixture (A) from the carton.
2. Thread jam nut (D) and crossbar (C) onto threaded nipple (E) with ground screw (F) facing towards swivel (I); leave both parts loose.
3. Using two machine screws (not provided), temporarily fasten crossbar (C) to the electric box.

NOTE: A NEW ELECTRIC BOX COMES WITH SCREWS. WHEN REPLACING A FIXTURE, RETAIN THE EXISTING SCREWS FOR USE WITH THE NEW FIXTURE.

4. Adjust the length of threaded nipple (E) in crossbar (C) so that canopy ring (G) will hold canopy (H) against the ceiling with no threads showing for best appearance. When the correct adjustment is established, tighten jam nut (D) against crossbar (C) to secure the adjustment.
5. Remove crossbar (C) from the electrical box and proceed with the assembly instructions.
6. Locate fixture pipes (J, K, L), fixture (A) and stem nipples (M). Nipples (M) can be found in the kit bag.
7. Provided are multiple fixture pipes in three different lengths. Choose the combination that will achieve the overall height desired. Refer to the table below to determine the pipes required to reach the desired overall height. Once you have determined the components necessary, feed the wires that exit fixture coupling (B) through the individual components and thread pipes and couplings together. Wires will slip easier through loose components than through pipes and couplings that are pre-assembled. Once wires are run, apply thread locking compound to all the connection points and assemble the pipes and nipples.

		Overall Height of Fixture															
		14.5	17.5	20.5	23.5	26.5	29.5	32.5	35.5	38.5	41.5	44.5	47.5	50.5	53.5	56.5	59.5
# of Pipes Required	3" Pipe (J)		1		1		1		1		1		1		1		1
	6" Pipe (K)			1	1			1	1			1	1			1	1
	12" Pipe (L)					1	1	1	1	2	2	2	2	3	3	3	3

NOTE: APPLICATION OF THE THREAD LOCKING COMPOUND IS NECESSARY TO PREVENT THE PIPE FROM LOOSENING DURING REGULAR MAINTENANCE AND CLEANING OF THE FIXTURE. BE CERTAIN TO APPLY THE COMPOUND.

8. Carefully slide canopy ring (G) and canopy (H) over wires and fixture pipes (J, K, L) until they rest on fixture (A).
9. Slip wires from the fixture (A) through assembled swivel (I) and thread swivel onto final pipe. It may be necessary to remove a nipple (M) for this to work on shorter overall fixture heights.
10. Refer to instructions on next page to continue installation.

ASSEMBLY & INSTALLATION INSTRUCTIONS

A708

Mobius Mini Pendant 184530

- Using two machine screws (not provided), fasten crossbar (C) to the electric box.
- Using suitable wire connectors (not provided) connect fixture wires to supply (white/ribbed to white and black/smooth to black). Attach a pigtail lead to crossbar ground screw (F). Hold canopy (H) close, connect all ground wires (bare copper or green to bare copper or green).

CAUTION: MAKE SURE WIRE CONNECTORS ARE TWISTED ON SECURELY, AND NO BARE WIRE IS EXPOSED.

- Slide canopy (H) against ceiling, and secure with canopy ring (G).

CAUTION: BE SURE NO WIRES ARE PINCHED BETWEEN CANOPY (H) AND THE CEILING.

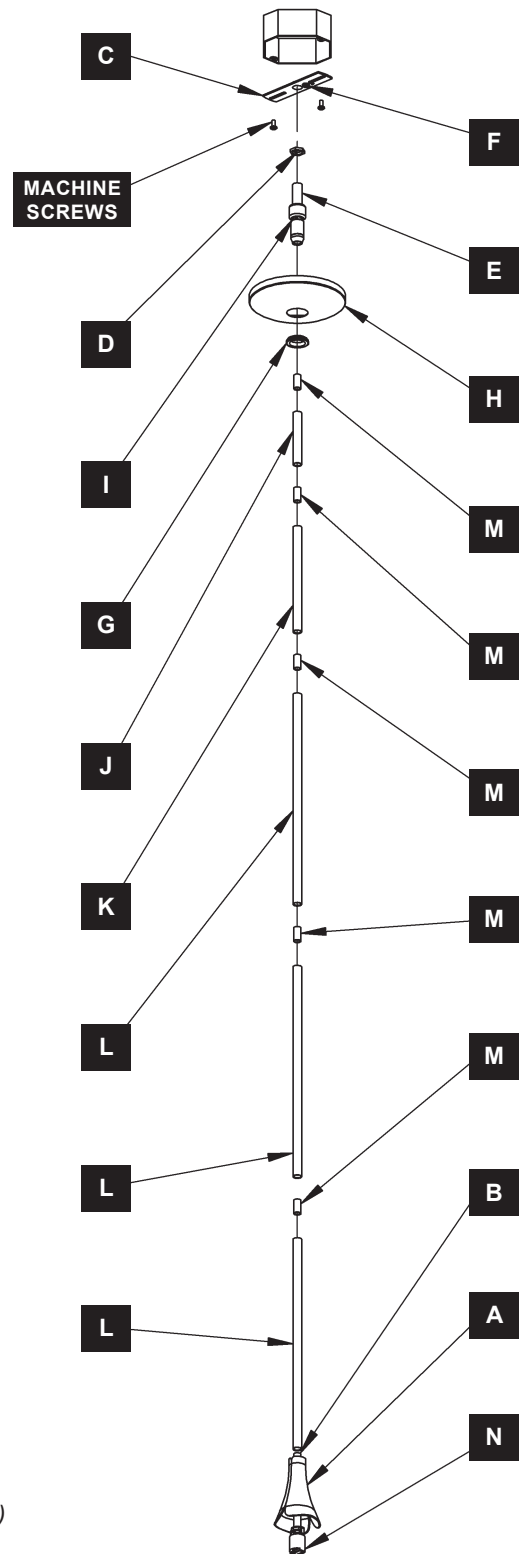

(Figure 1)

Mobius Mini Pendant 184530

To Install Shade (Figure 2)

1. Refer to last pages for instructions on how to assemble the shade.
2. Install light bulb (Q) into socket (N). Be careful not to touch bulb with bare hands; oil from the hands will dramatically reduce bulb life.
3. Slip shade assembly (S) followed by spacer (U) over socket (N).
4. Thread retaining ring (T) onto socket (N).
5. Restore electricity at the main breaker.

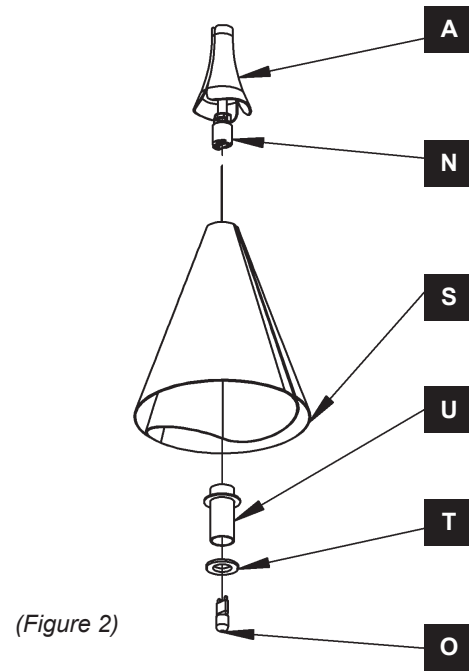

(Figure 2)

Mobius Mini Pendant 184530

Shade Assembly

YouTube To see a video on how to assemble the Mobius shade, go to:
<http://www.youtube.com/user/HubbardtonForge?v=IfoOT34FMQ8>

Step 1 Identify all parts needed.

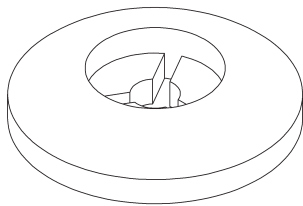

(R) Female End Plastic

Buttons (4)

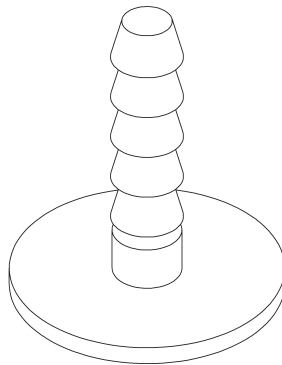

(Q) Male End Plastic

Buttons (4)

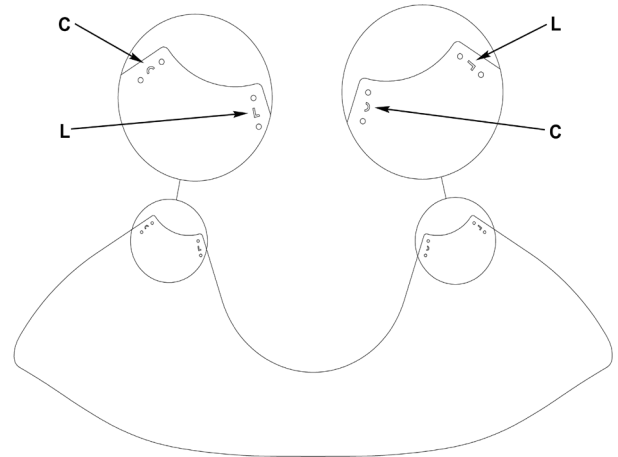

(P) Flat Shade Panel (1)

Step 2 Fold shade panel (R) over and align letter designations "L"
Note: Top letter "L" should be oriented the same as the bottom letter "L".

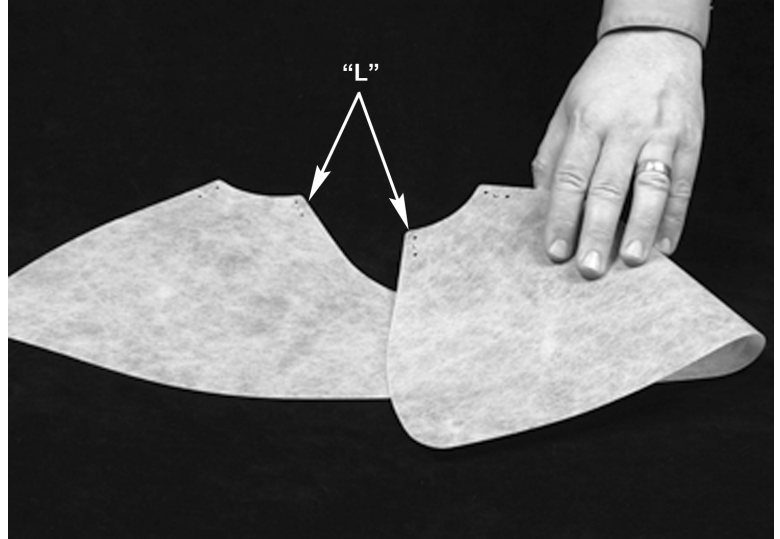

HUBBARDTON FORGE.

MODERN AMERICAN BLACKSMITHS | FINE, HAND CRAFTED LIGHTING
CASTLETON, VERMONT USA | HUBBARDTONFORGE.COM

ASSEMBLY & INSTALLATION INSTRUCTIONS

A708

Mobius Mini Pendant 184530

Step 3 Slip male end of plastic button up through bottom of shade panel as shown.

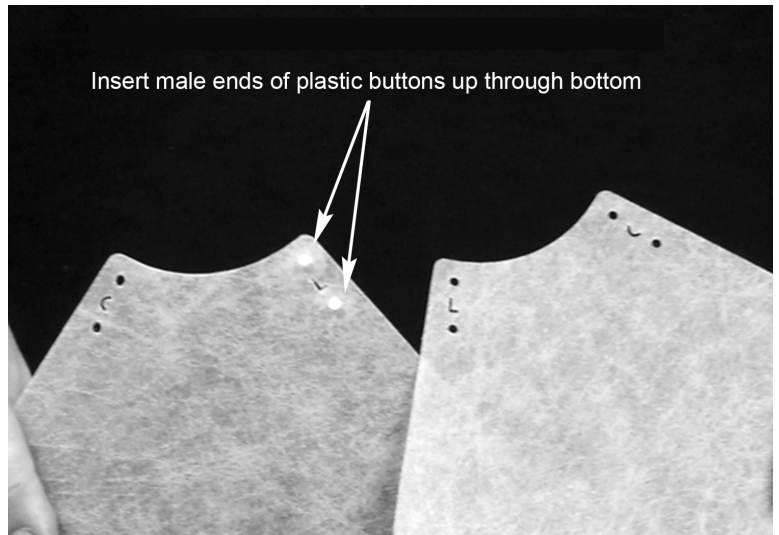

Step 4 Align "L" holes and mount the other side of the shade panel (R) onto the two male end plastic buttons (S). Install two female end plastic buttons (T) and press firmly to snap into place. Clip excess length of the male button off after installing female plastic buttons.

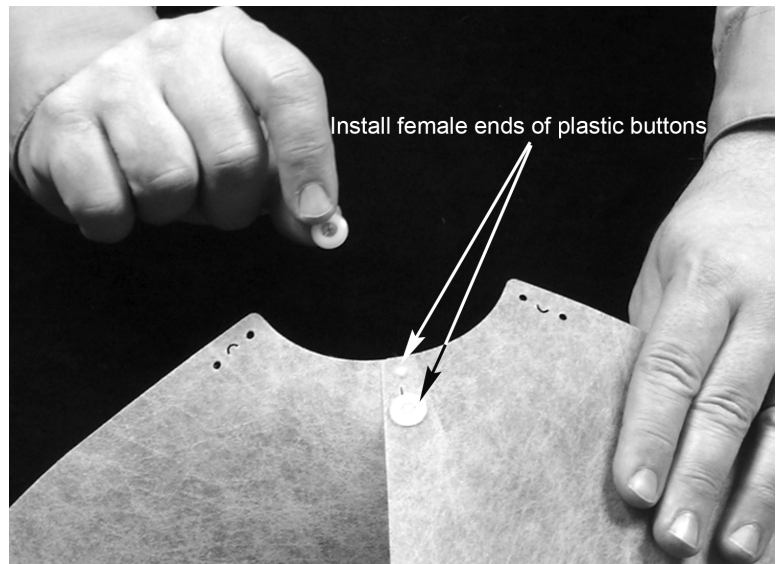

HUBBARDTON FORGE.

MODERN AMERICAN BLACKSMITHS | FINE, HAND CRAFTED LIGHTING
CASTLETON, VERMONT USA | HUBBARDTONFORGE.COM

48289

7 OF 9

ASSEMBLY & INSTALLATION INSTRUCTIONS

A708

Mobius Mini Pendant 184530

Step 5

Slip male end plastic buttons (S) through the “C” side of the shade panel (R). Note: Letter “C” should read the same as shown (this indicates the outside of the shade).

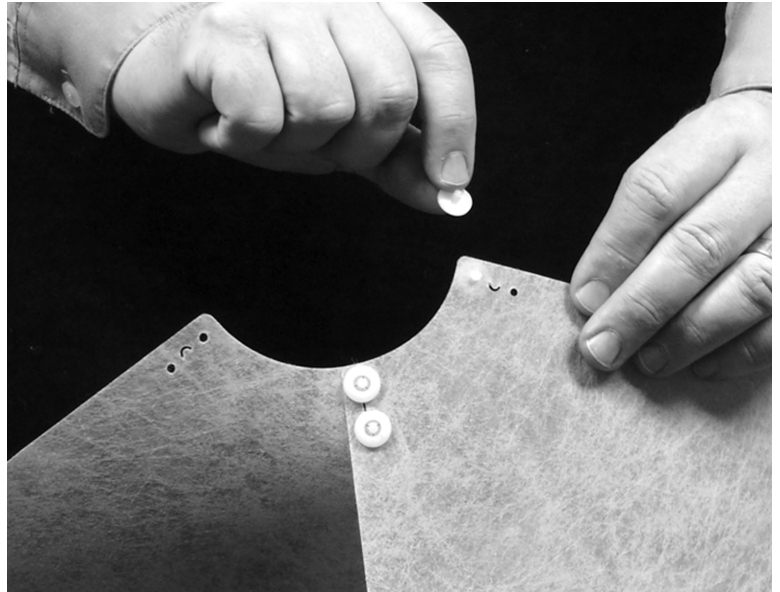

Step 6

Fold the shade panel (R) as shown to match the “C” sides. Insert the other side of the shade panel (R) onto the two male end plastic buttons (S).

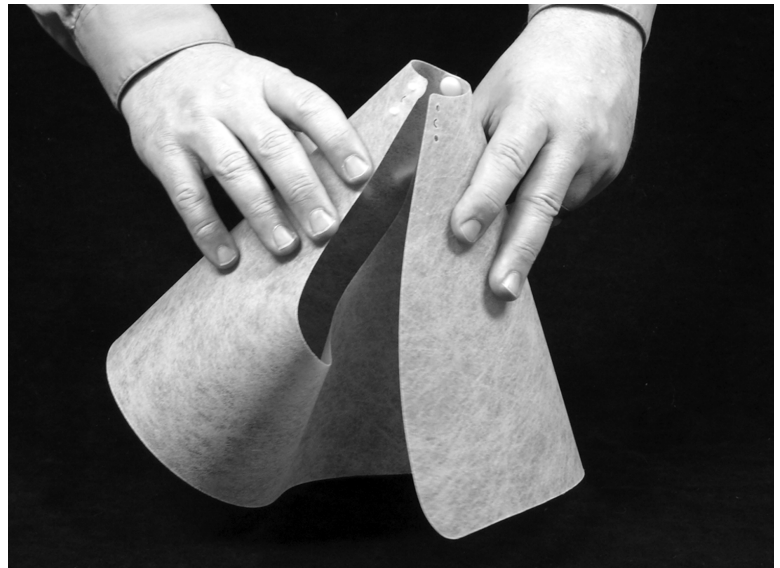

HUBBARDTON FORGE.

MODERN AMERICAN BLACKSMITHS | FINE, HAND CRAFTED LIGHTING
CASTLETON, VERMONT USA | HUBBARDTONFORGE.COM

48289

8 OF 9

ASSEMBLY & INSTALLATION INSTRUCTIONS

A708

Mobius Mini Pendant 184530

- Step 7 Install two female end plastic buttons (T) and press firmly to snap into place. Clip excess length of the male button off after installing female plastic buttons.



Bottom View of Assembled Shade



If you need further assistance, or find that you are missing any parts, please contact the dealer from which you purchased this product. We hope you enjoy your fixture!

*** Hubbardton Forge will not be liable for injury or damage caused by improper installation, lamping or use of this fixture.**