

ASSEMBLY INSTRUCTIONS

Parts and Hardware

Please check to make sure you have all parts and hardware before starting assembly process.

(A)

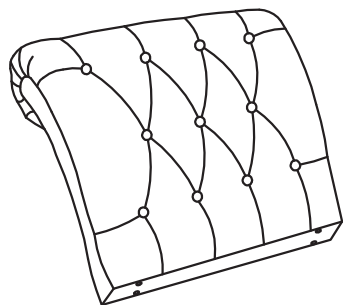

Back Cushion (1)

(B)

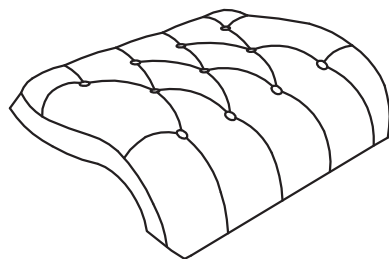

Seat Cushion (1)

(C1)

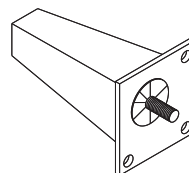

(C2)

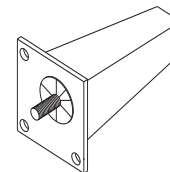

Front Legs (2)

(D1)

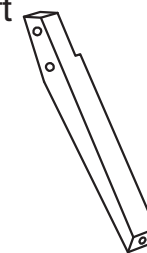

(D2)



Right

Left

Back Legs (2)

(E)



Allen Head Bolts
5/16*60mm (9)

(F)



Spring Washers
M8 (9)

(G)



Flat Washers
8*22*2 (9)

(H)



Allen Head Bolts
1/4*20mm (6)

(I)



Flat Washers
6*18*1.5 (6)

(J)



Allen Wrench (1)

ASSEMBLY INSTRUCTIONS

Assembly Instructions

Please read and understand all assembly instructions before beginning assembly process.
Do not tighten any single bolt until all bolts in holes on each step

STEP 1:

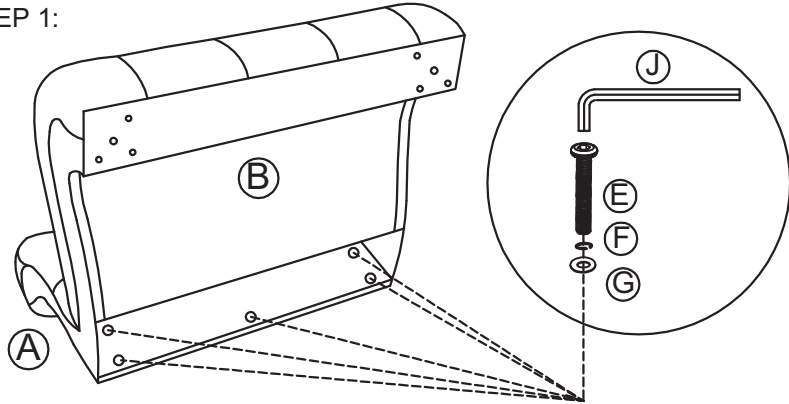

STEP 2:

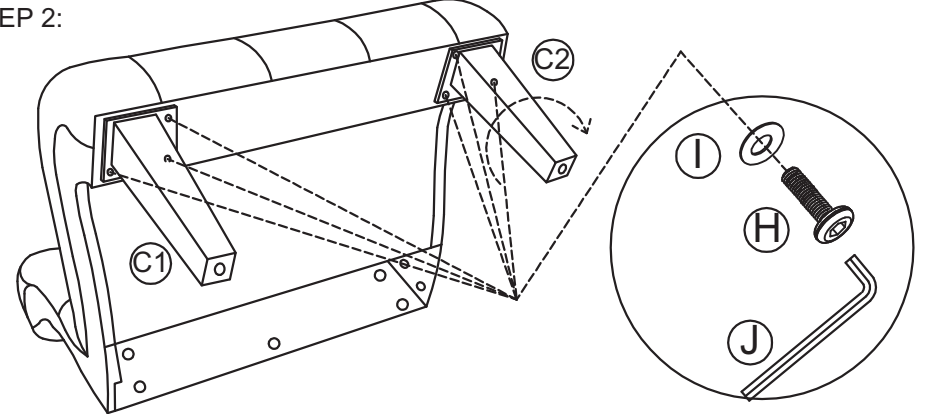

STEP 3:

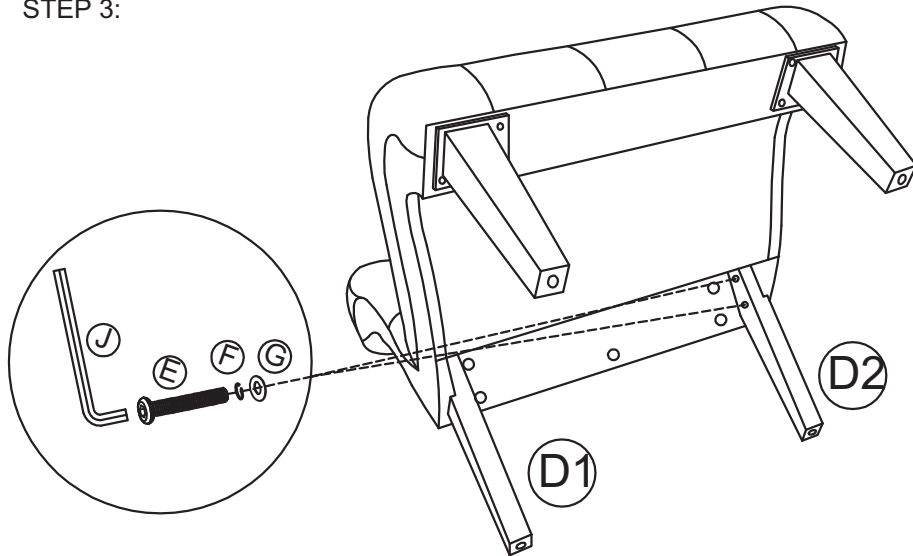

STEP 4:

