

# THE COUCH

## INSTRUCTION MANUAL

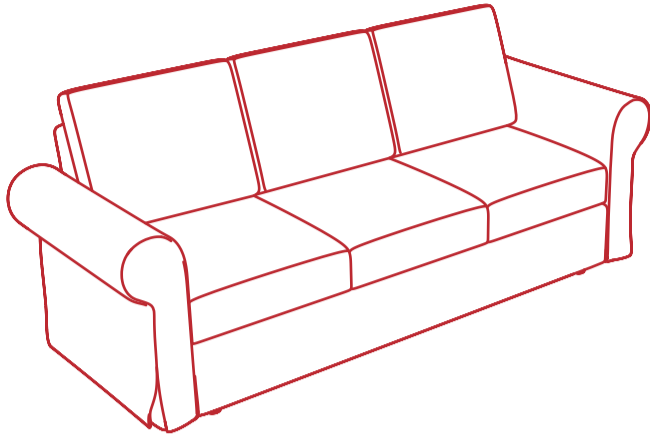

### TIPS & PREP

Your new couch comes with an easy tool-free assembly that you can do at home using the provided instructions. But before we dive in, here are some key tips and prep steps to make the assembly process as smooth as possible.

#### Get a buddy or family member

Even though the assembly is completely tool-free, it involves lifting and aligning various parts. To make assembly easier, we suggest having at least two people there throughout the process.

#### Left or right matters!

Throughout assembly, we'll mention the Left and Right Arm Panels and movements to the left and right. We'll be using 'left' and 'right' based on the perspective of standing in front of your couch.

#### Don't overlook the glossary!

We've included a glossary with these instructions to help you identify every part and piece of hardware. If you run into any issues, consult the glossary to ensure you're using the right components.

#### Unbox and check your hardware

The hardware pack for your sofa is in the seat base. Open it up, lay out each piece, and double-check with the checklist to make sure you have everything you need. If anything's missing, reach out to customer service before moving forward.

#### Have your scissors handy!

Make sure you have scissors nearby. The cushions and seat pads are in compression bags. Carefully open them to prevent any damage or injury while unpacking.

#### Clear the space!

We recommend putting your couch together in a roomy, clutter-free area, away from pets and little ones. Lay down a sheet to keep the couch components clean and free of debris during assembly.

### PRODUCT LIST

Complete parts list for your couch. The couch ships in two boxes—Box 1 and Box 2. Confirm both boxes arrived and use this list to check all parts.

#### Box 1 and Box 2

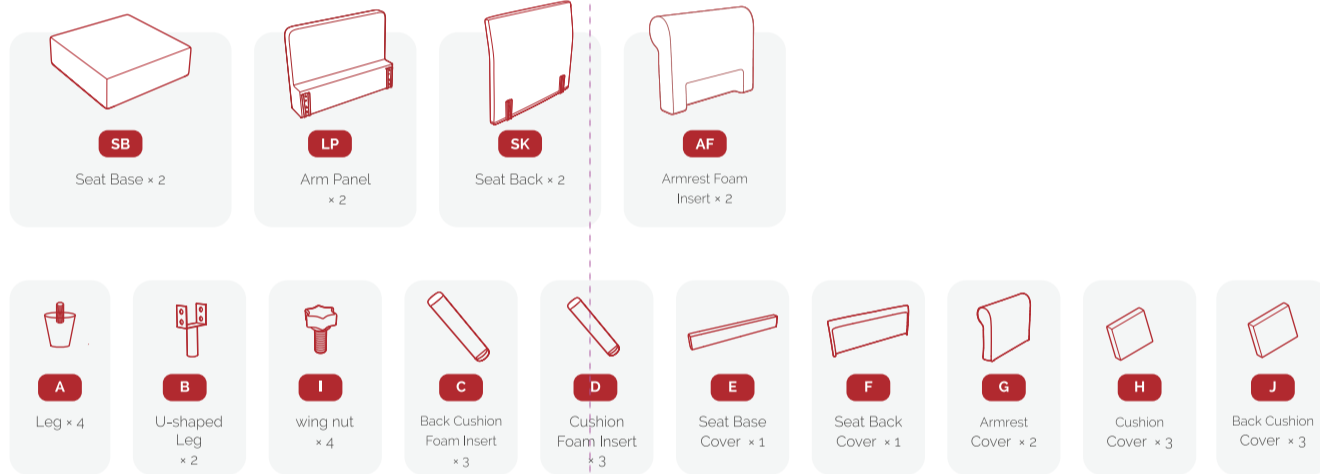
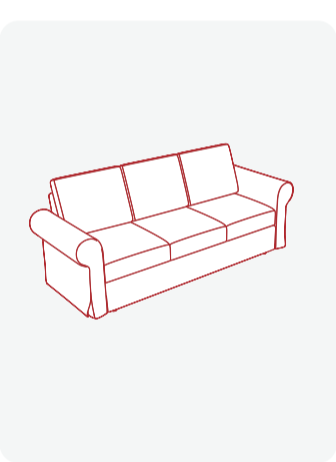

### COUCH ASSEMBLY INSTRUCTIONS

### NOTICE:

Don't worry, it may take at least 72 hours for all compressed foam to fully regain its shape after decompression.

### STEPS

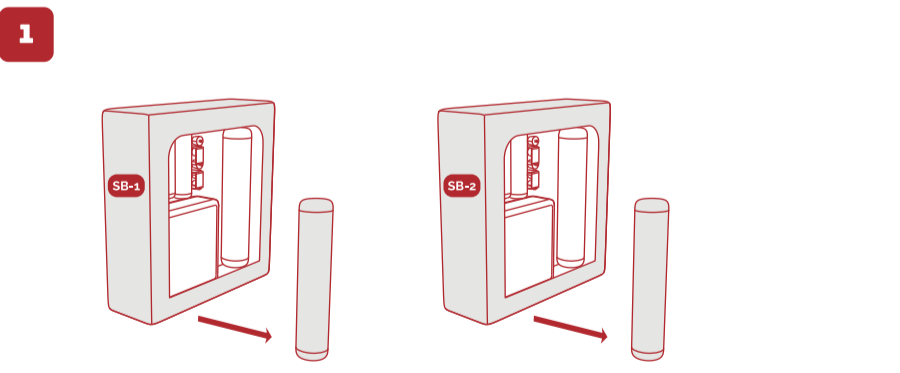

Unzip the Seat Base(SB-1 and SB-2), remove the necessary components.

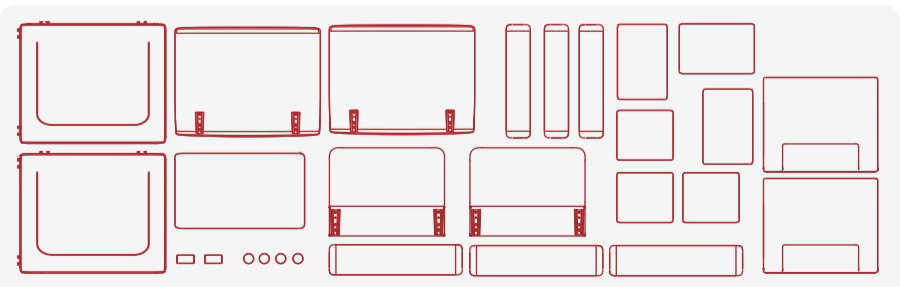

Proceed to check the quantity.

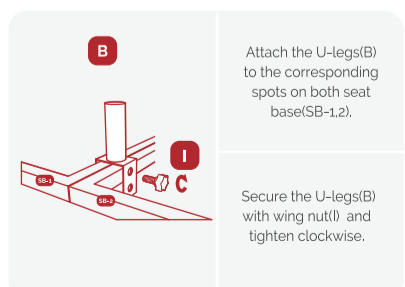
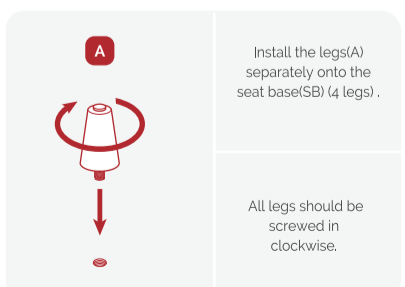
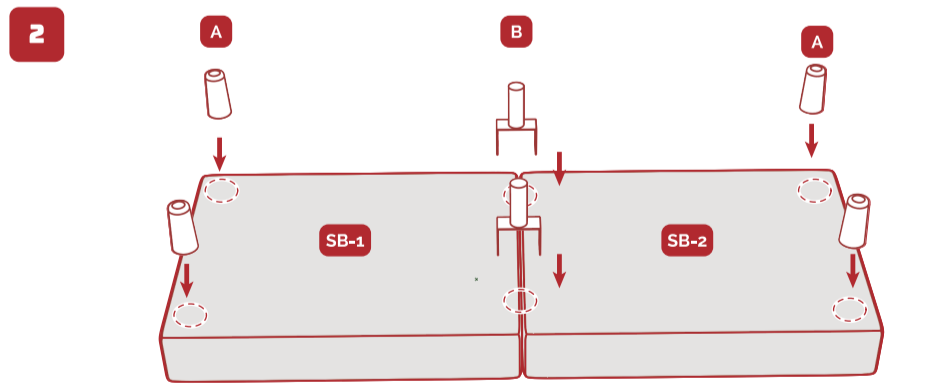

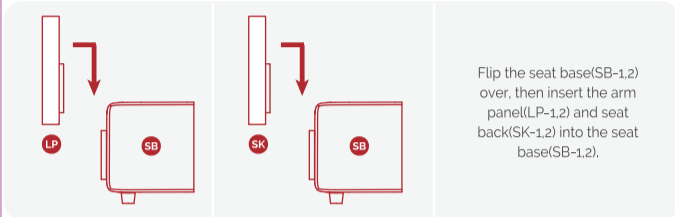
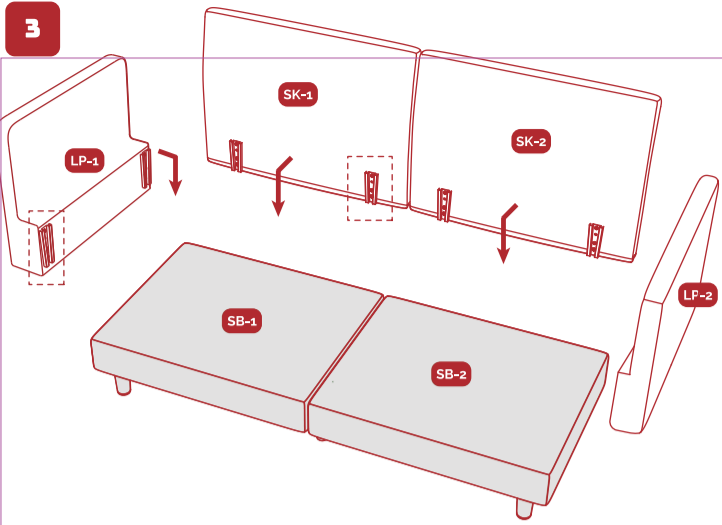

Flip the seat base(SB-1,2) over, then insert the arm panel(LP-1,2) and seat back(SK-1,2) into the seat base(SB-1,2).

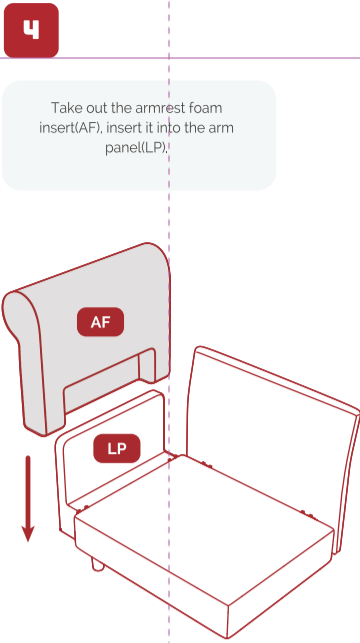

4 Take out the armrest foam insert(AF), insert it into the arm panel(LP).

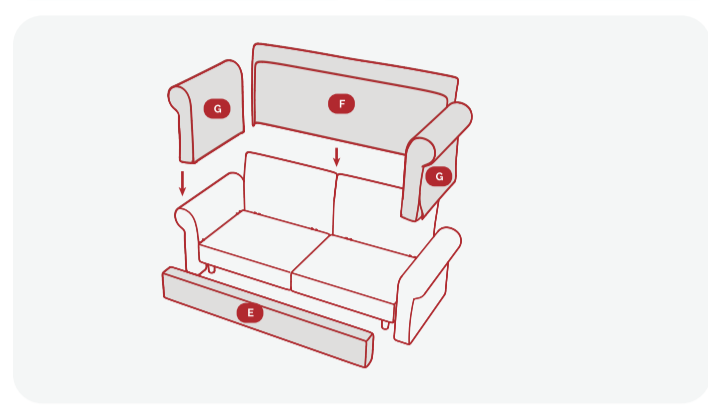
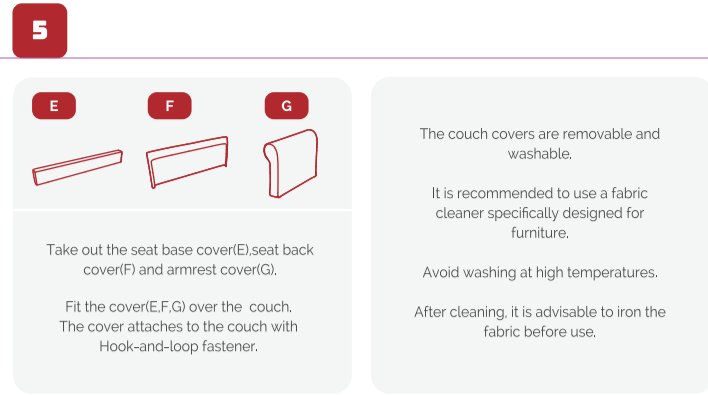

5 Take out the seat base cover(E), seat back cover(F) and armrest cover(G).  
Fit the cover(E,F,G) over the couch. The cover attaches to the couch with Hook-and-loop fastener.

The couch covers are removable and washable.  
It is recommended to use a fabric cleaner specifically designed for furniture.  
Avoid washing at high temperatures.  
After cleaning, it is advisable to iron the fabric before use.

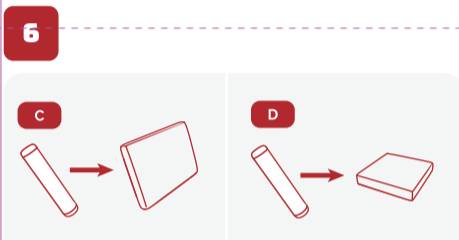

6 Take out the back cushion(C) and cushion(D) foam inserts for natural decompression.

Help the foam regain its shape by gently patting it repeatedly.

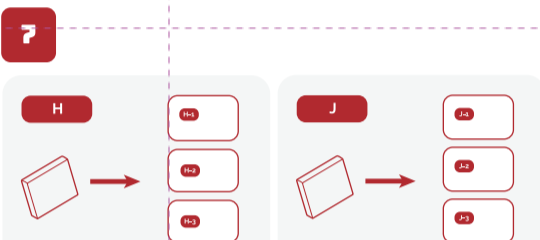

7 Take out the cushion cover(H), Take out the back cushion cover(J).

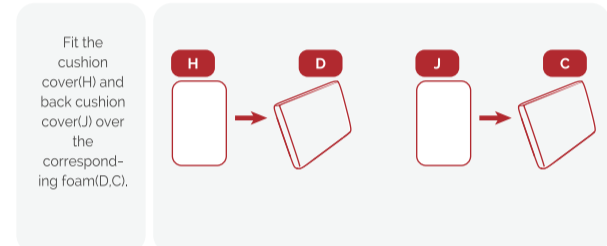

Fit the cushion cover(H) and back cushion cover(J) over the corresponding foam(D,C).

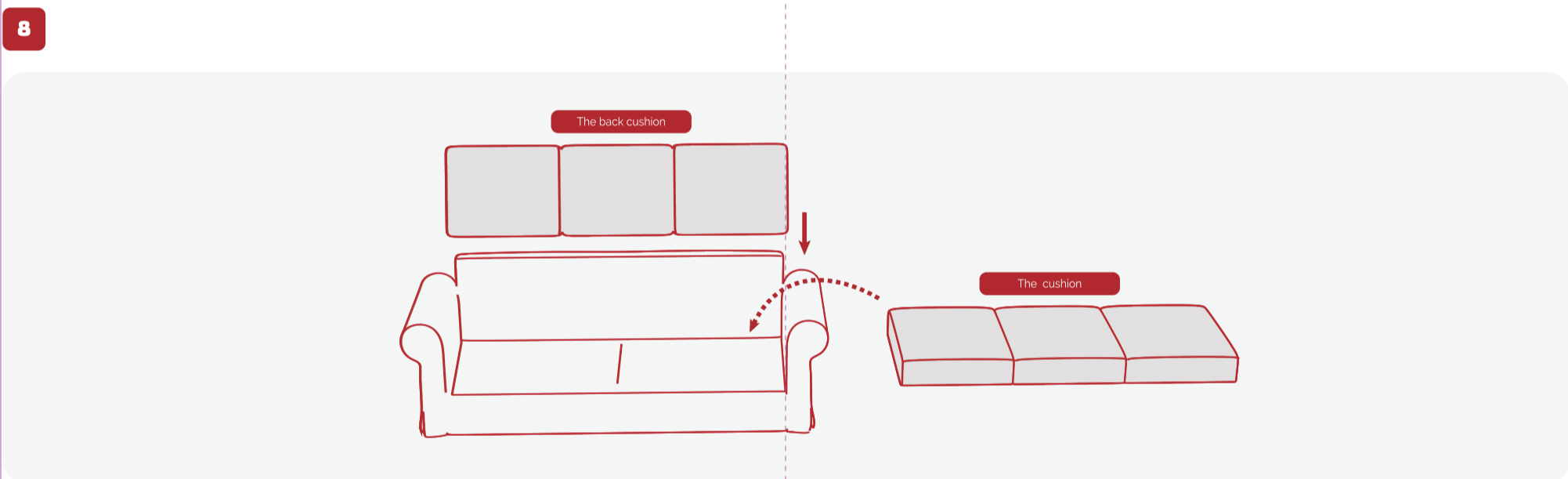

9 Complete the installation.