

USER MANUAL #CL-4SL6KL23
42" 6000 LUMEN LED SHOP LIGHT - LINKABLE

CARE FOR YOUR PRODUCT:

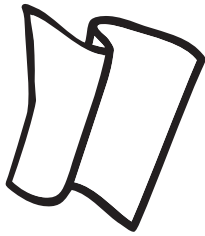

Your product will last for many years with minimum care. Therefore, it is essential to clean the product periodically. Use a soft, non-abrasive cloth or a mild, non-abrasive glass cleaner. It is essential NOT to use any solvents or harsh cleaning agents. **When cleaning, make sure the power is OFF.** Do not spray liquid directly onto the product or wiring. Instead, spray or pour a small amount into the cloth and clean the product.

TROUBLESHOOTING:

Problem	Possible Cause	Solution
The product does not turn on	The power is off	Check the power supply and make sure it is ON
	There is a bad wire connection	Check the wiring
	The switch is defective	Test and/or replace the switch
Flickering	The light is not operating correctly	Disconnect and call the manufacturer

EYES:



- **DO NOT look directly at the LED lights.**
- **DO NOT remove the LED lights protective covering.**

CARE FOR YOUR PRODUCT:



This product has a **two-year limited warranty** from the date of purchase—this guarantees against failure due to factory defects, whether caused by materials or workmanship. The warranty is non-transferable and only pertains to the original purchaser. **Proof of purchase** is required for any repair or replacement, so please keep your proof of purchase receipt. This warranty does not cover normal wear and tear or damage due to misuse. Misuse of this product includes but is not limited to:

- Using outdoors in extreme weather conditions.
- Opening the product's housing.
- Any attempts to update, remodel or fix the unit yourself.

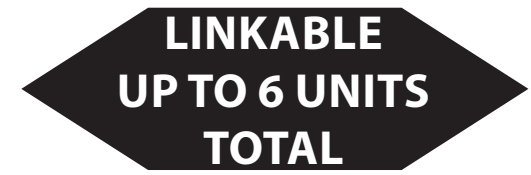

USER MANUAL #CL-4SL6KL23
42" 6000 LUMEN LED SHOP LIGHT - LINKABLE



LED LINKABLE SHOP LIGHT	
Lumen	6000
Watts	75
CCT	4000K Bright White
Power Supply	5 ft. Power Cord

WARNING:

YOU SHOULD ALWAYS FOLLOW BASIC PRECAUTIONS.



Read, follow, and understand all instructions and warnings before beginning any installation of this product. Failure to do so can result in electric shock, fire, or other injuries, including death. Save this user manual for instructions and warnings for possible future relocation and installation.

CAUTION:



- This product is not waterproof and is designed for dry and damp use only.
- Avoid environments with extreme dust and/or humidity.
- Avoid areas with temperatures higher than 104 Fahrenheit.
- Avoid using this product near flammable materials and/or gas.
- DO NOT use on radiant-heating type of ceilings.
- Always shut off the main power supply at the circuit breaker before removing or relocating this product from any area.

USER MANUAL #CL-4SL6KL23 42" 6000 LUMEN LED SHOP LIGHT - LINKABLE

PRE-INSTALLATION INSTRUCTIONS (HANGING CHAIN):

Before beginning any installation, select your location. Measure the distance between the two Triangle Hook attachment holes on top of the light to determine the distance between each hanging chain. Next, determine your mounting method.

If you or a professional electrician is mounting into wood, it is recommended to use Screw Hooks (C) as in **Diagram 1**.

If mounting into drywall, it is recommended to use Screw Hooks (C) and Anchors (D). Screw the Screw Hook into the Anchor. Then drill a 1/4" hole into the drywall. Pinch the butterfly ends flat and push through the drywall hole. The Anchor will expand behind the drywall as shown in **Diagram 2**. Repeat for the other side.

It is up to the purchaser or a professional electrician to determine the best area to install. The manufacturer is NOT responsible for improper installations.

HARDWARE INCLUDED:

Part	Description	Quantity
A	Triangle Hook	2
B	Hanging Chain	2
C	Screw Hook	2
D	Anchor	2
E	Screws	2

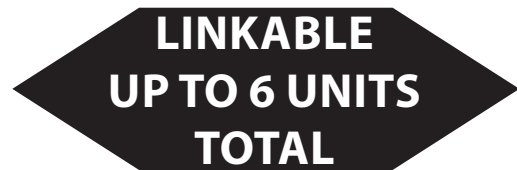
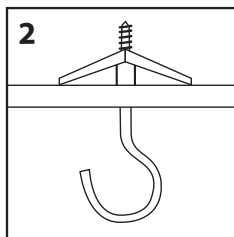
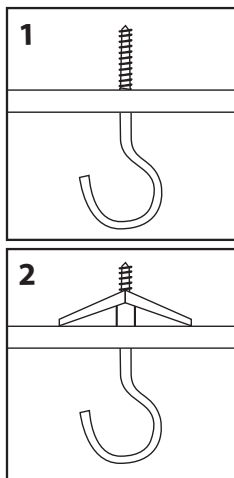
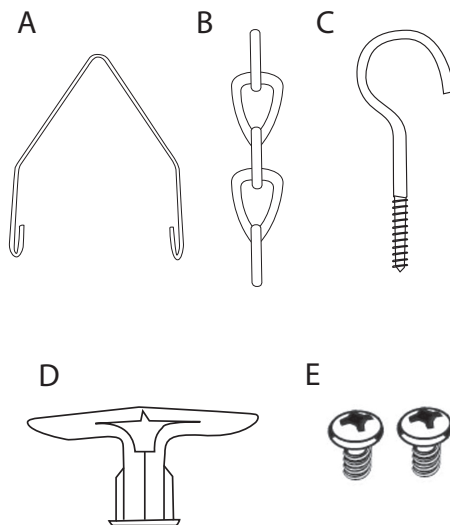

USER MANUAL #CL-4SL6KL23 42" 6000 LUMEN LED SHOP LIGHT - LINKABLE

PRODUCT INSTALLATION INSTRUCTIONS (HANGING CHAIN):

1. Attach the Triangle Hook (A) to the Shop light (**Fig. A**). Repeat this on the other side.
2. Attach the Hanging Chain (B) to the Triangle Hook (**Fig. B**). Repeat this step on the other side.
3. Hang the Hanging Chain on the pre-installed Screw Hook (C). Adjust to the desired height and make sure the product is level.
4. For this product, you can link up to **6 UNITS TOTAL**. Simply plug the power cord directly into the adjacent unit(s).
5. Plug the main light's AC power cord into the AC outlet. Turn the light on and off from the pull chain.

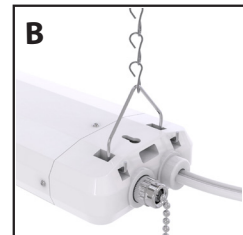
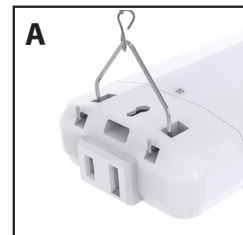

PRODUCT INSTALLATION INSTRUCTIONS (FLUSH MOUNT):

1. Locate the holes and screws to flush mount the fixture (**Fig. 1 and 2**).
2. Measure the distance between the screw holes, and with a pencil, mark the desired installation areas. Secure the screws into the marked places, leaving 1/8 inch for the fixture to grip (**Fig. 2A**).
3. Align the screw holes on the fixture with the screws. Push the Shop light over the screw heads, then slide the fixture slightly to the side to secure the light to the screws (**Fig. 3**).
4. If the fixture is loose, remove it and tighten each screw 1/4 turn and re-attach. Repeat until the fixture is secure.

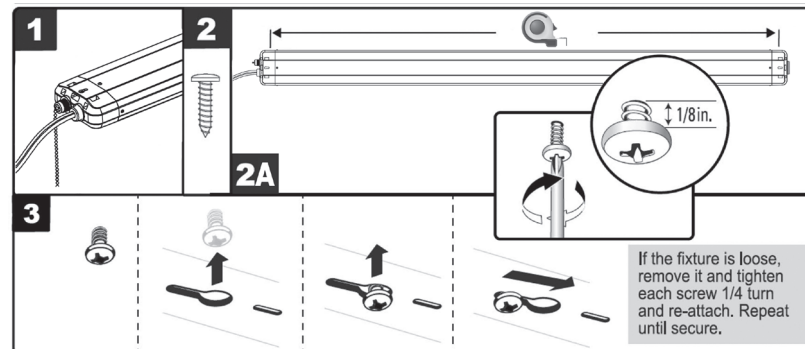

If the fixture is loose, remove it and tighten each screw 1/4 turn and re-attach. Repeat until secure.