

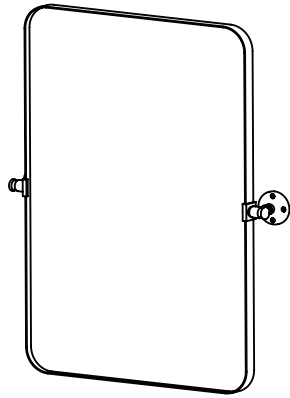

TEEBARN

MOUNTING INSTRUCTIONS

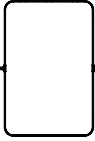
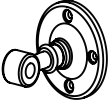
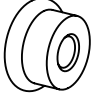

Contents:

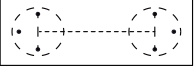
					
Mirror X1	Bracket X2	Ball Finial X2	Screw X6	Anchor X6	position map X1

Questions, problems, missing parts?

The hardware included with this item is meant for dry wall mounting only. If other wall types, please consult your local hardware store for assistance

1



MOUNTING TEMPLATE

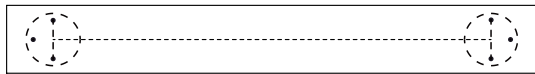

Paste the **position map** horizontally on the position to be installed and mark it with a pencil.

2



Drill six 1/8" pilot holes in wall for each **Plate**.
Screw the plastic **Anchors** into the holes until flush.

3

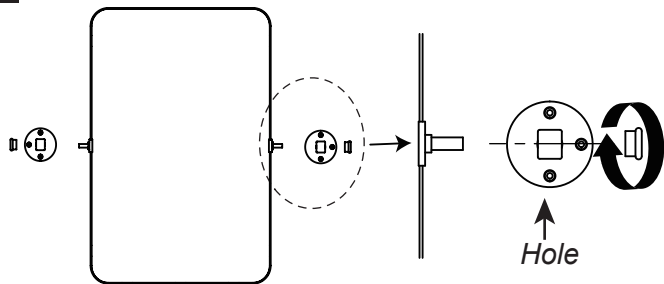

Attach **Brackets** to **Mirror** with **Ball Finials**, with the small holes in the **Brackets** facing down.

4

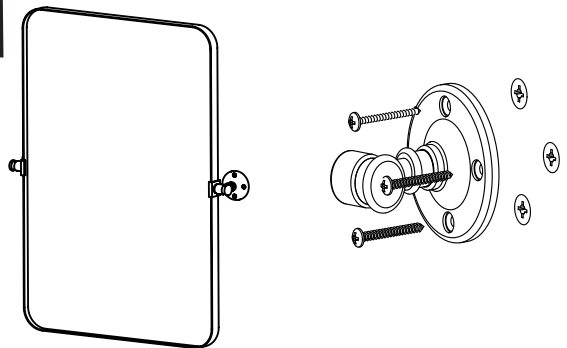

Secure the **Plates** onto the anchors with the **Screws**.

Cleaning

Avoid using commercial or abrasive cleaners. Using only a soft damp cloth will preserve the finish.