

ASSEMBLY INSTRUCTION

NO	ITEM	QTY
A	HEADBOARD	1 PC
B	FOOTBOARD	1 PC
C	SIDE RAILS (C1) (C2)	4 PCS
D	SLAT 1397 mm	2 PCS
E	LEG	2 PCS
F	LEG 700*70*25mm 110x80x35mm	2 PCS
G	SIDE RAIL LEG 20*65*230mm	2 PCS
H	CENTER RAIL 800 mm	2 PCS
I	SUPPORT LEG 265 mm	4 PCS
J	Bolt 1/4" x3-1/2"	2PCS
K	JCBC 1/4" x 1"	8PCS
L	JCBC 1/4" x 2-1/4"	4PCS
M	JCBC 1/4" x 1-1/2"	8PCS
N	M6 FLAT WASHER	22PCS
O	M6 SPRING WASHER	22PCS
P	1/4"x70x70mm	1PC
Q	FLAT HEAD CHIPBOARD SCREW M4 x 25mm	32PCS
R	WOODEN DOWEL ø10*35mm	2PCS

Step 1: Fix the headboard with legs as shown.

The height of headboard can be adjusted to accommodate different thickness of mattresses.

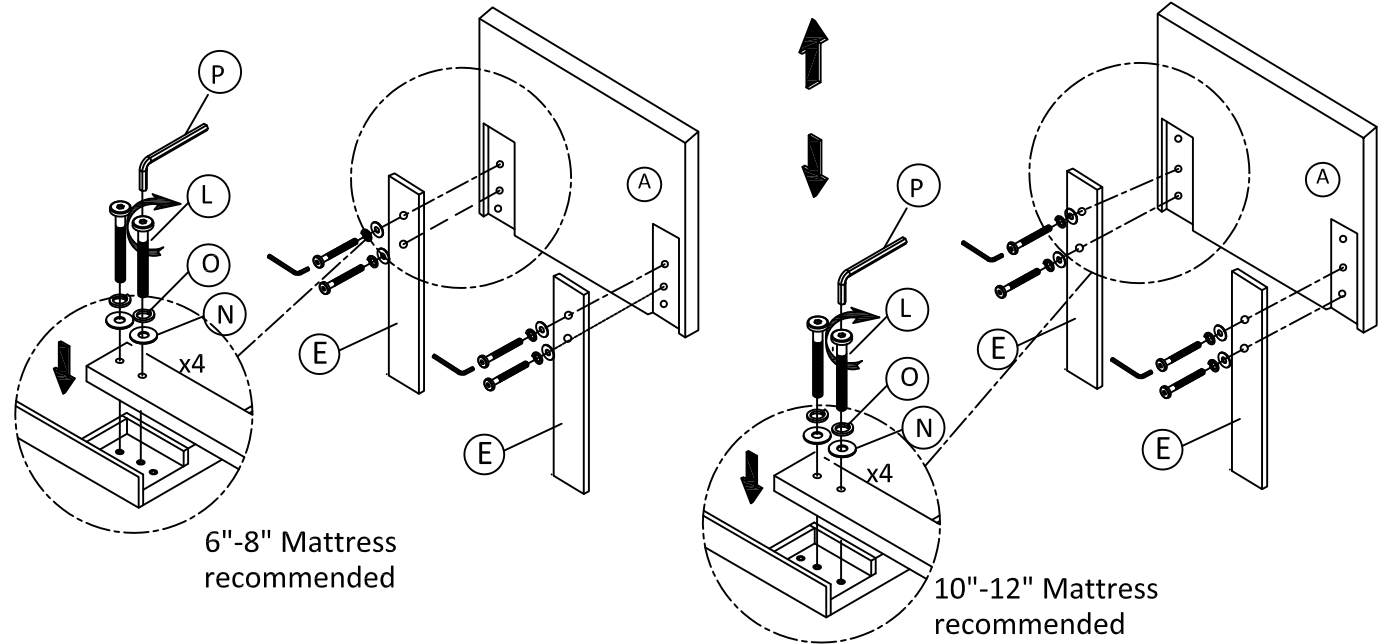
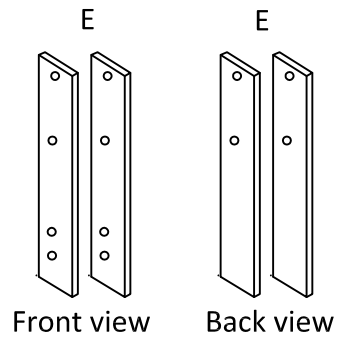

Step 2: Tighten the Legs (F) to the footboard (B) as shown.

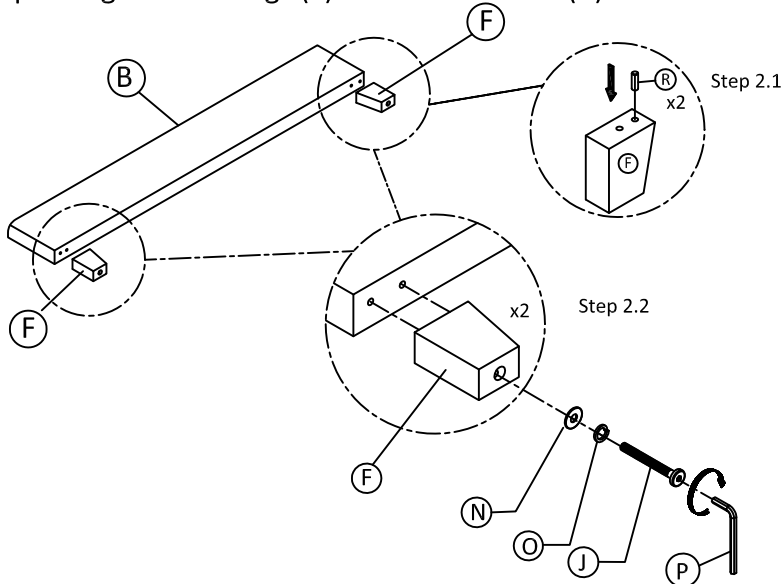

Step 3: Attach the JCBC Bolt(K) to the headboard and footboard.

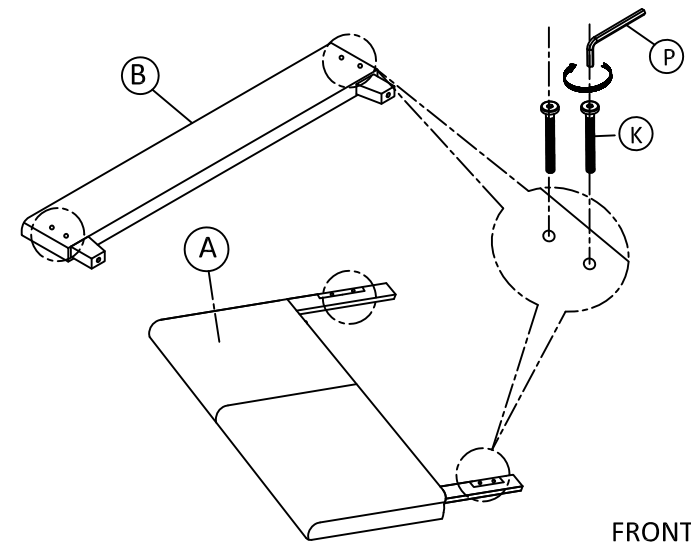

Step 4: Attach the side rail leg (G) to the side rail (C).

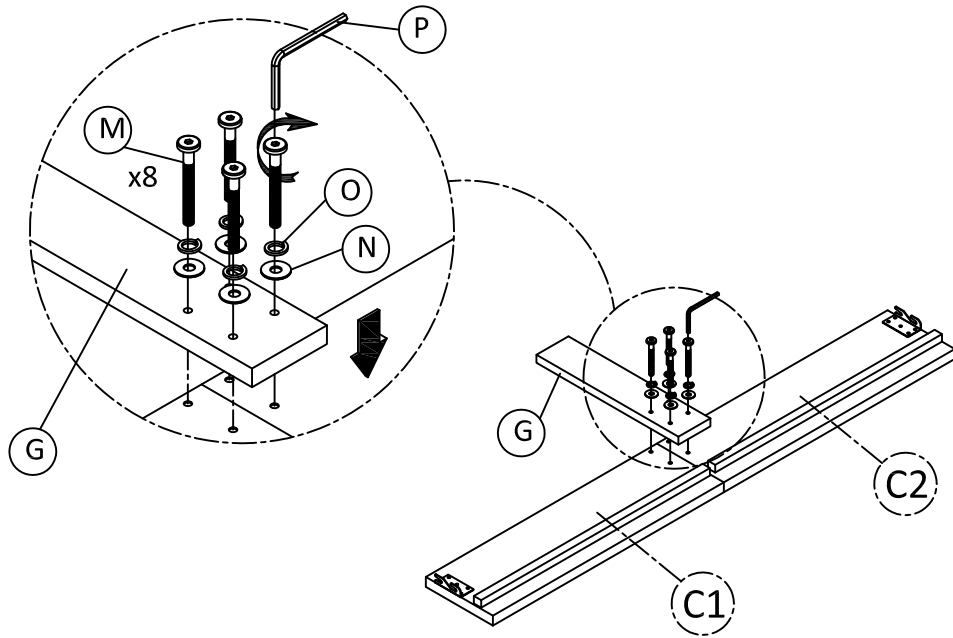

Step 5: Attach side rail (C) to headboard (A) and footboard (B) by pushing the bracket down to fit it.

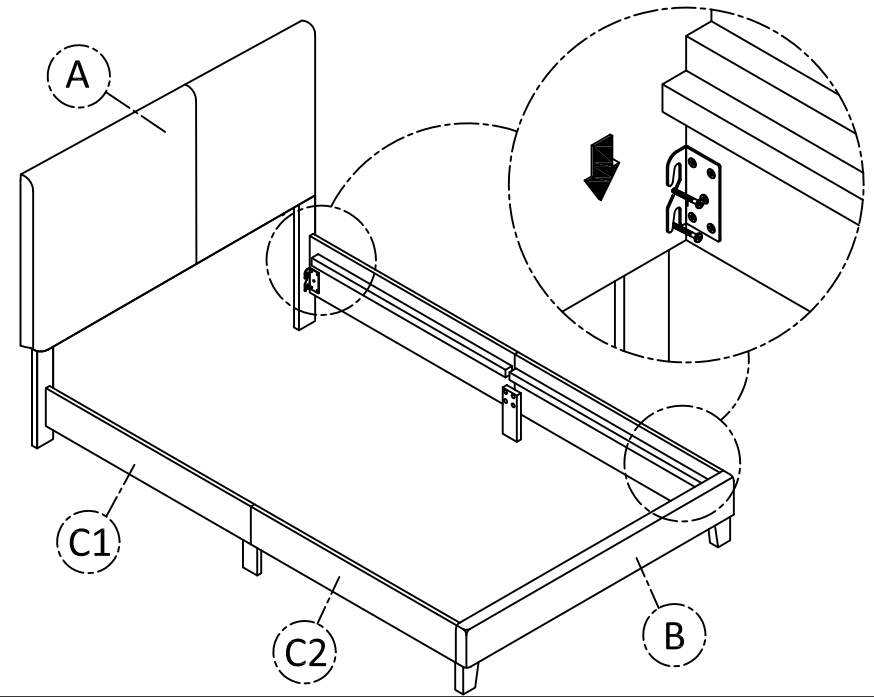

Step 6: Attach the support leg (I) to the center rail (H) of the bed as shown.

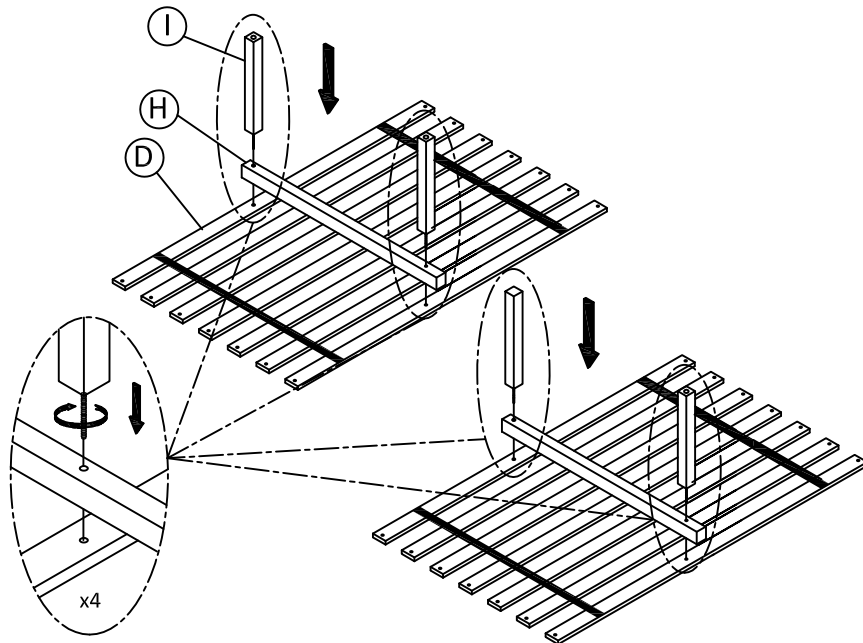

Step 7: Tighten the 4 Corner with Allen (P). Install the bed slats to side rail. Tighten the slats with CSK screw. The distance of the slats should be sufficient to obtain desirable bed stability.

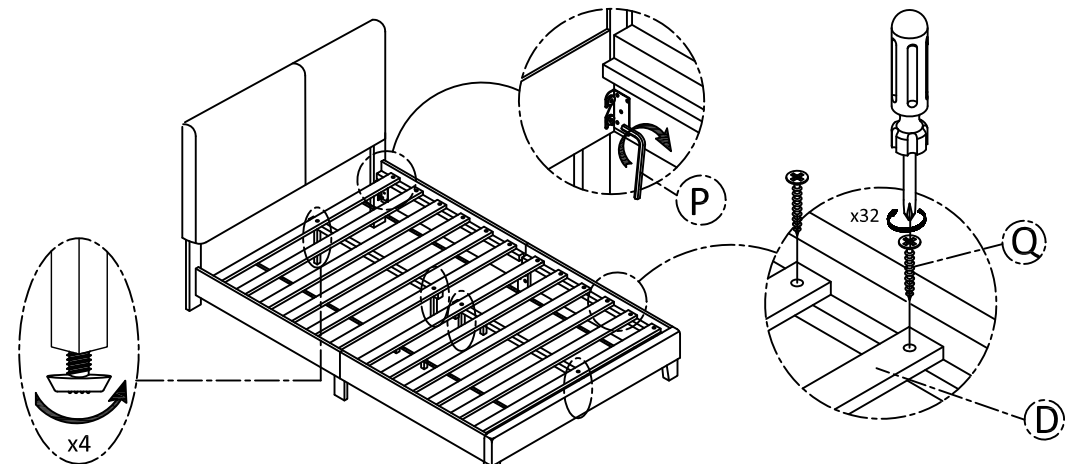

ATTENTION
Please keep the adjuster around 3 to 5 mm
distant away from the floor

ASSEMBLY INSTRUCTION

NO	ITEM	QTY
A	HEADBOARD	1 PC
B	FOOTBOARD	1 PC
C	SIDE RAILS	4 PCS
D	SLAT	2 PCS
E	LEG	2 PCS
F	LEG 700*70*25mm 110x80x35mm	2 PCS
G	SIDE RAIL LEG 20*65*230mm	2 PCS
H	CENTER RAIL 800 mm	2 PCS
I	SUPPORT LEG 265 mm	4 PCS
J	Bolt 1/4" x3-1/2"	2PCS
K	JCBC 1/4" x 1"	8PCS
L	JCBC 1/4" x 2-1/4"	4PCS
M	JCBC 1/4" x 1-1/2"	8PCS
N	M6 FLAT WASHER	22PCS
O	M6 SPRING WASHER	22PCS
P	1/4"x70x70mm	1PC
Q	FLAT HEAD CHIPBOARD SCREW M4 x 25mm	32PCS
R	WOODEN DOWEL ø10*35mm	2PCS

Step 1: Fix the headboard with legs as shown.

The height of headboard can be adjusted to accommodate different thickness of mattresses.

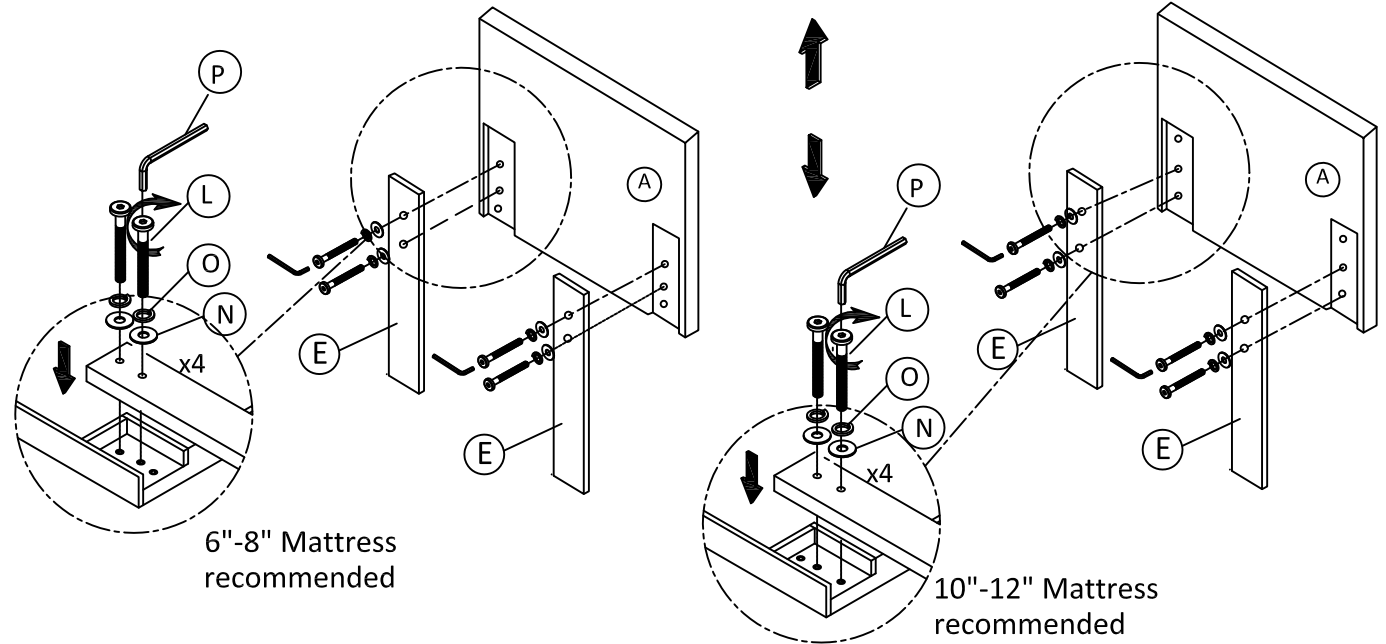
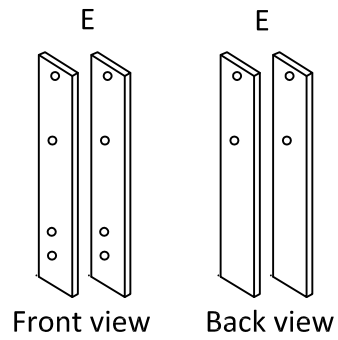

Step 2: Tighten the Legs (F) to the footboard (B) as shown.

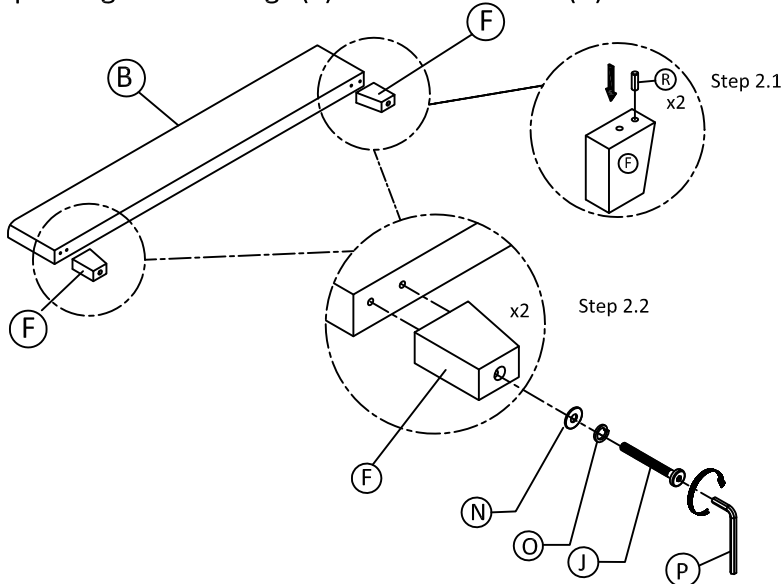

Step 3: Attach the JCBC Bolt(K) to the headboard and footboard.

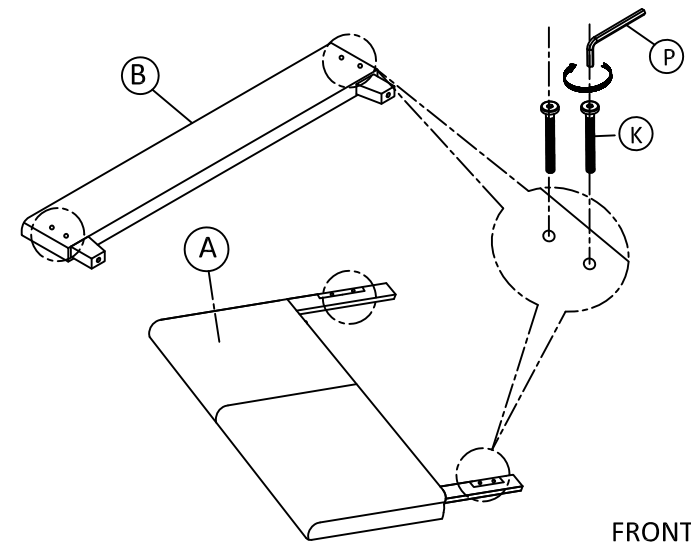

Step 4: Attach the side rail leg (G) to the side rail (C).

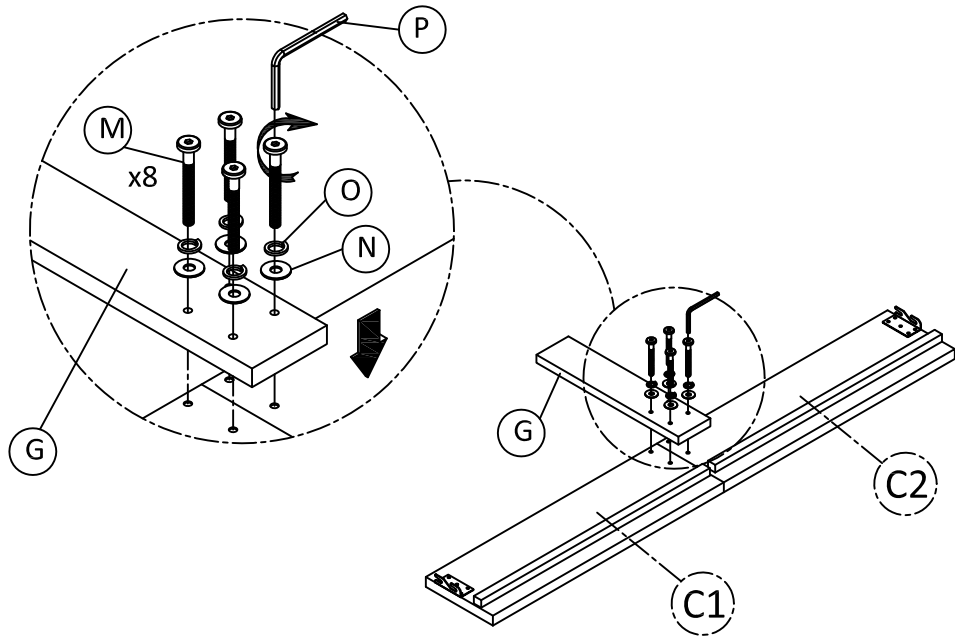

Step 5: Attach side rail (C) to headboard (A) and footboard (B) by pushing the bracket down to fit it.

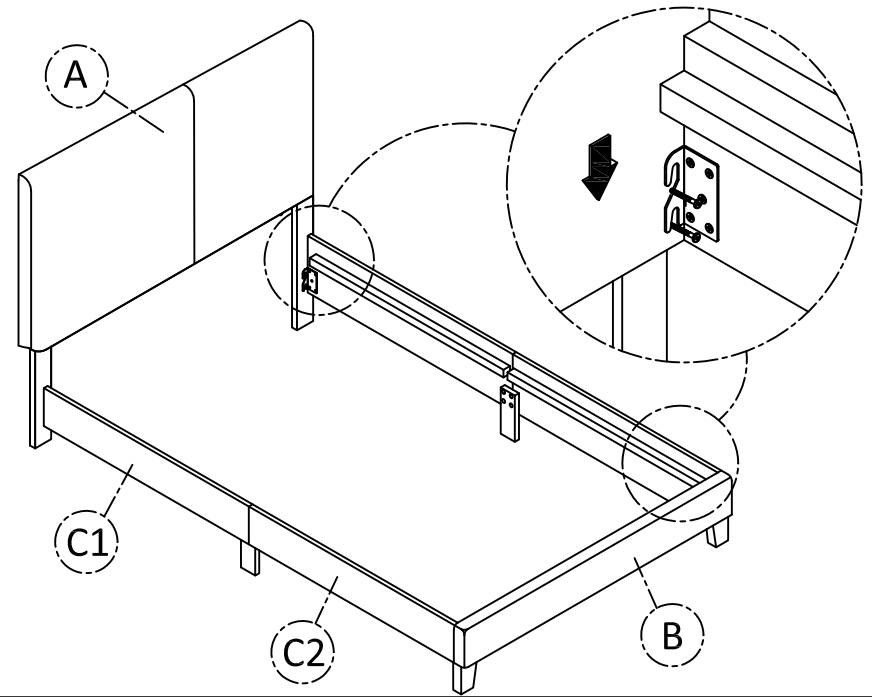

Step 6: Attach the support leg (I) to the center rail (H) of the bed as shown.

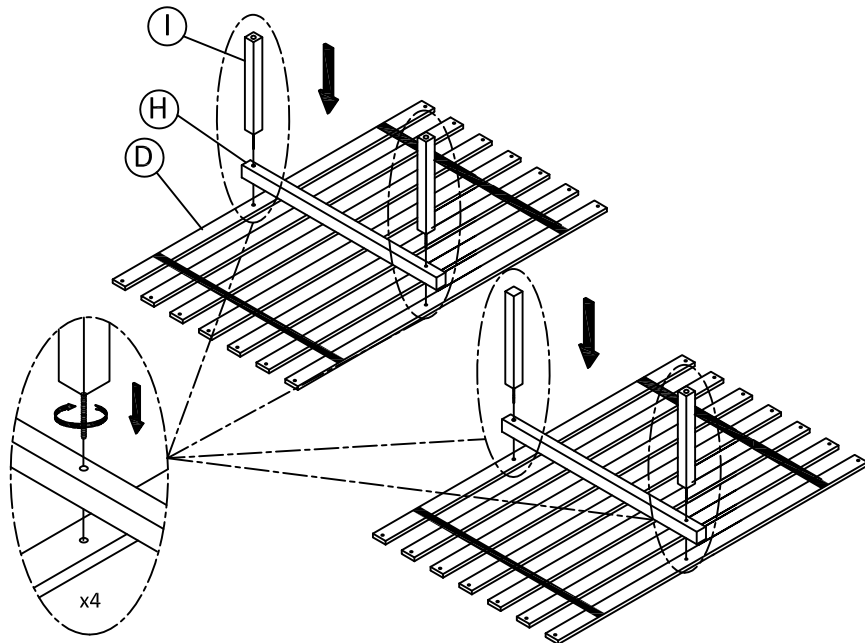

Step 7: Tighten the 4 Corner with Allen (P). Install the bed slats to side rail. Tighten the slats with CSK screw. The distance of the slats should be sufficient to obtain desirable bed stability.

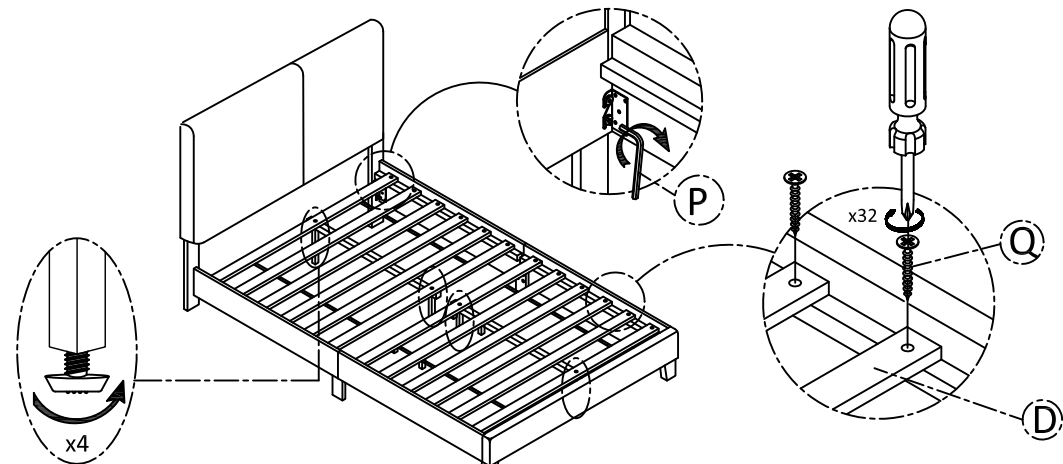

ATTENTION
Please keep the adjuster around 3 to 5 mm
distant away from the floor