

LED SQUARE FIXTURE

INSTRUCTIONS PERTAINING TO RISK OF FIRE OR INJURY TO PERSONS
READ ALL INSTRUCTIONS

**IMPORTANT SAFETY
INSTRUCTIONS**

SAVE THESE INSTRUCTIONS



TOOLS AND MATERIALS REQUIRED:

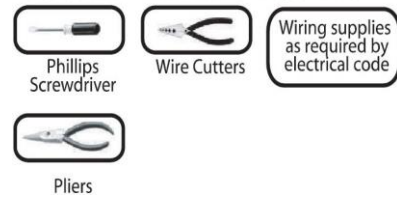

SAFETY PRECAUTIONS:

1. **TURN OFF ELECTRICAL POWER BEFORE STARTING INSTALLATION OF LIGHT FIXTURE.**
2. **THIS PRODUCT MUST BE INSTALLED IN ACCORDANCE WITH THE APPLICABLE INSTALLATION CODE BY A PERSON FAMILIAR WITH THE CONSTRUCTION AND OPERATION OF THE PRODUCT AND THE HAZARDS INVOLVED.**
3. **CAUTION - RISK OF ELECTRIC SHOCK. CONSULT A QUALIFIED ELECTRICIAN TO ENSURE CORRECT BRANCH CIRCUIT CONDUCTOR.**
4. **WARNING, THIS IS A LINE VOLTAGE MODEL AND DOES NOT AND CANNOT USE A DRIVER.**
5. **LINE VOLTAGE MODELS ALREADY HAVE A POWER SUPPLY CHIP BUILT INTO THE LED ARRAY.**

INSTALLATION

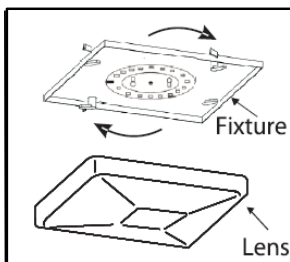

1. Remove plastic lens by unlocking the latches (4pcs).

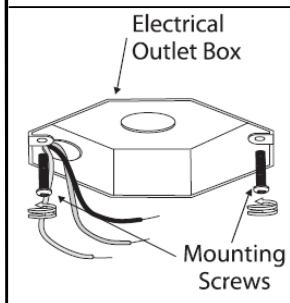

2. Place mounting screws (included) in electrical box screwing in halfway.

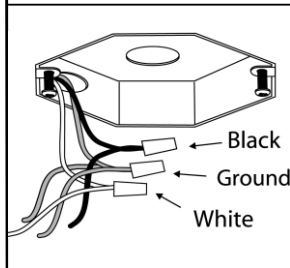

3. Using wire nuts to connect ground wire (green) from fixture and LED board to ground wire from electrical box. Connect black wire from fixture to black wire from electrical box. Connect white wire from fixture to white wire from electrical box.

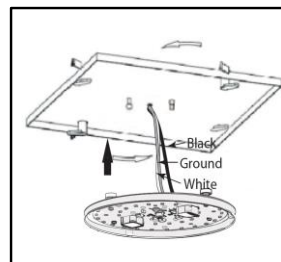

4. Line up magnetic PCB board with mounting holes on metal pan. Attach fixture to mounting screws, turn fixture counter-clockwise to lock.

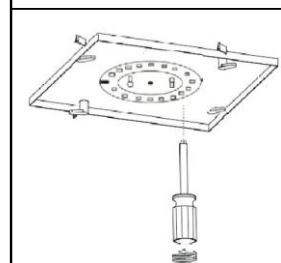

5. Secure fixture by tightening mounting screws.

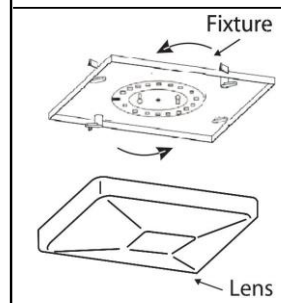

6. To install the plastic lens, hold the lens up to the fixture, lock the latches.

MAGNETIC PCB BOARD MAY SHIFT OR MOVE DURING SHIPPING
PLEASE ADJUST AND OR CENTER THE PCB BOARD