

## Specifications:

<b>Installation:</b>	vanity-top
<b>Exterior Dimensions:</b>	36 1/2" w x 22" d x 6 1/2" h
<b>Material:</b>	Solid surface
<b>Weight:</b>	48 lbs
<b>Overflow:</b>	Yes
<b>Finishes:</b>	M - Matte white G - Gloss white
<b>Faucet Holes:</b>	00 - no hole 01 - one centered hole 02 - two hole - center and right, 4" spread 03 - three hole, 8" spread
<b>Faucet Hole Size:</b>	Ø 1 3/8"
<b>Drain Hole Size:</b>	Ø 1 3/4"
<b>Cutout Size:</b>	21" x 19 1/4" (templates available upon request)

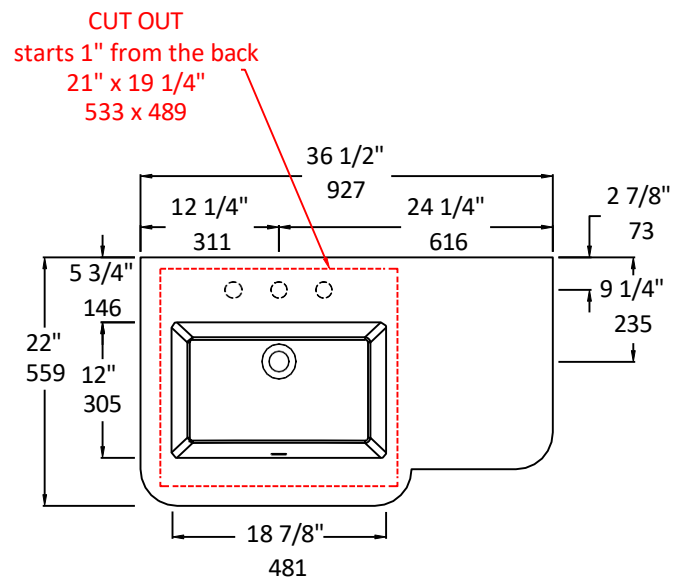

## Features:

- Stain, scratch, chemical, impact resistant
- Optional backsplash available
- K36L-ELE - sink on the left
- K36R-ELE - sink on the right

## Codes + Standards:

- Meets and exceeds applicable national codes and standards



compliant when installed to specific requirements of this regulation

## Recommended Items:

- BKS - 6" Backsplash G - gloss, M - matte
- Furniture for K36L-ELE with sink on the left
  - ELE-W-36L - Floor-standing or wall mounted vanity with three drawers and optional legs
- Furniture for K36R-ELE with sink on the right
  - ELE-W-36R - Floor-standing or wall mounted vanity with three drawers and optional legs
- Drain with overflow
  - 7100-17
  - 7100-16OF
  - 7100-13OF

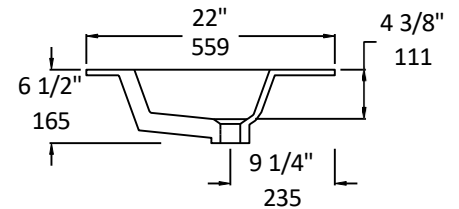
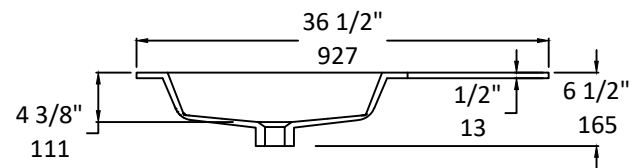

## Care + Maintenance:

To prevent damage to the solid surface material, hot objects and open flame should not be placed in direct contact with the surface

[Click Here](#) to find out more about proper care and maintenance

LACAVA reserves the right to revise any dimension or information on this sheet without notice. Dimensions are nominal and may vary within an industry accepted tolerance of 1/4". Drawings provided herein are meant to give the user an idea of the product and are not made to scale.

Revised: 03/18/26