

**IMPORTANT!!PLEASE READ ENTIRE
INSTRUCTION SHEET BEFORE ASSEMBLY!!**

Tabletop Fountain



Step 1:
Take the fountain out of the box. Plug the LED light into the adaptor that is connected to the pump.

Step 2:
Connect the pump to the tubing on in the fountain.

Step 3:
Put water (700 ml approx.) in the basin of the fountain (about ½ way full) take all cords and pump and place it in the water, be sure to make sure there is enough water in the bottom of the fountain so that the pump will be completely submersed.

Step 4:
Connect the adaptor to the pump cable.

Step 5:
Plug the pump in and enjoy.

PARTSLIST					
A	Fountain	1pc	B	Water pump	1pc
C	Adaptor	1pc			

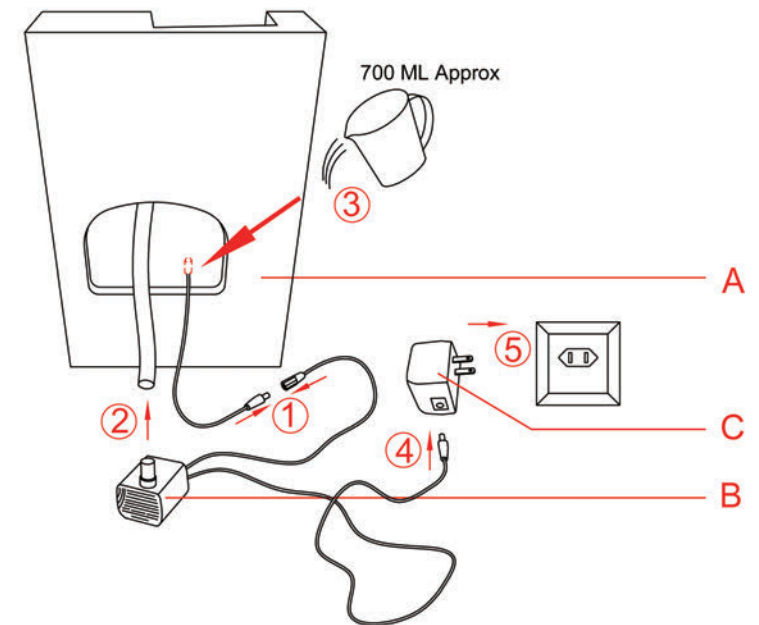

**Be careful not to spill water onto the plug of the pump.
DO NOT allow the pump to run dry!**