

Mantel Shelf INSTRUCTION MANUAL

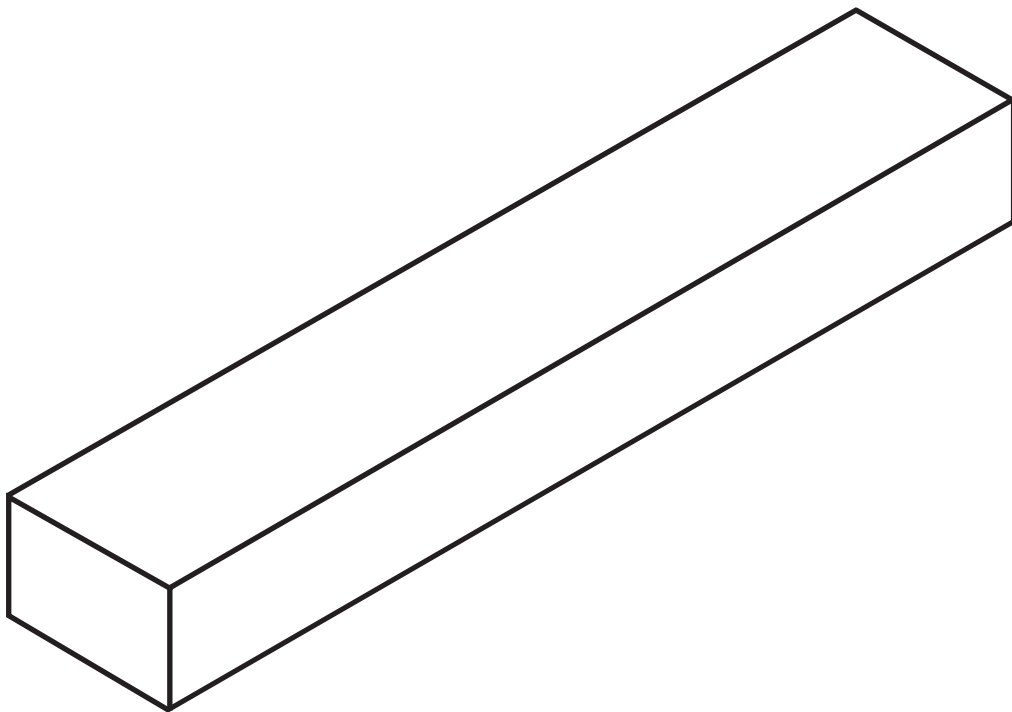

Dear Customer,

Thank you for choosing our product. Please read this manual carefully before assembling or using this product. If there are parts missing, please kindly send us messages to let us know the name of missing part regarding to the Part List parts list of instructions. We will send replacement to you asap.

⚠ NOTICE

- Please do not exceed the weight limitations of this item.
- Do not stand on or use any part of this item as a step ladder. Firmly secure all bolts, screws before use.
- Do not use or store this item in the proximity of open flame or flammable/combustible chemicals.
- Be aware that some parts are heavy and have sharp edges.
- If any parts are missing, broken, damaged, or worn, stop using this product until repairs are made and/or factory replacement parts are installed.

TOOLS RECOMMENDED



POWERDRILL



LEVEL



PENCIL



HAMMER



2-PERSON
ASSEMBLY



UP TO 20 MIN.
ASSEMBLY

***Please make sure the quantity of Mantel Shelf, Screw, Anchor is correct according to the purchased size.**

***PLEASE NOTE:** The following steps are an installation example for a 48-inch mantel shelf. For the 72-inch and 60-inch sizes, you only need to adjust the Mounting Board to 2 pieces and use 6 screws/anchors. All other installation steps remain the same.

72-IN / 60-IN PARTS LIST

a

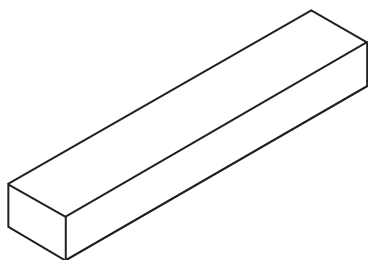

MANTEL SHELF 1 PC

b

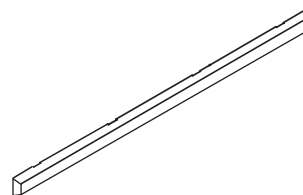

MANTEL SHELF 2 PCS

c

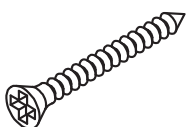

SCREW 6 PCS

d



ANCHOR 6 CS

NOTE: FOR WOOD WALL: NO NEED TO USE PARTS D - ANCHOR

48-IN PARTS LIST

a

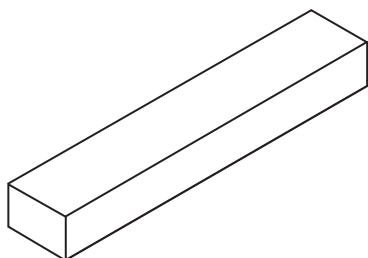

MANTEL SHELF 1 PC

b

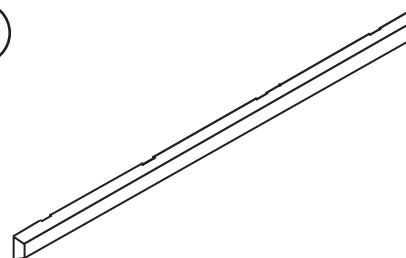

MANTEL SHELF 1 PC

c

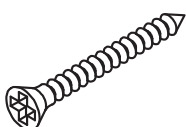

SCREW 4 PCS

d



ANCHOR 4 PCS

NOTE: FOR WOOD WALL: NO NEED TO USE PARTS D - ANCHOR

STEP 1: Place the Level on the wall where you want to install, and mark all holes with a pen or pencil.
(For the 48 in., you need to mark 4 holes For the 60 in. and 72 in., you need to mark 6 holes.)

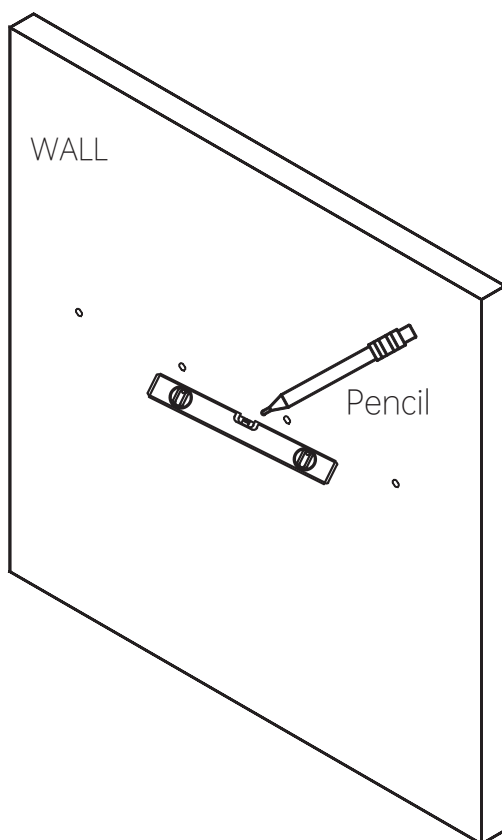

STEP 2: Use a powerdrill to drill the holes you marked in Step 1.

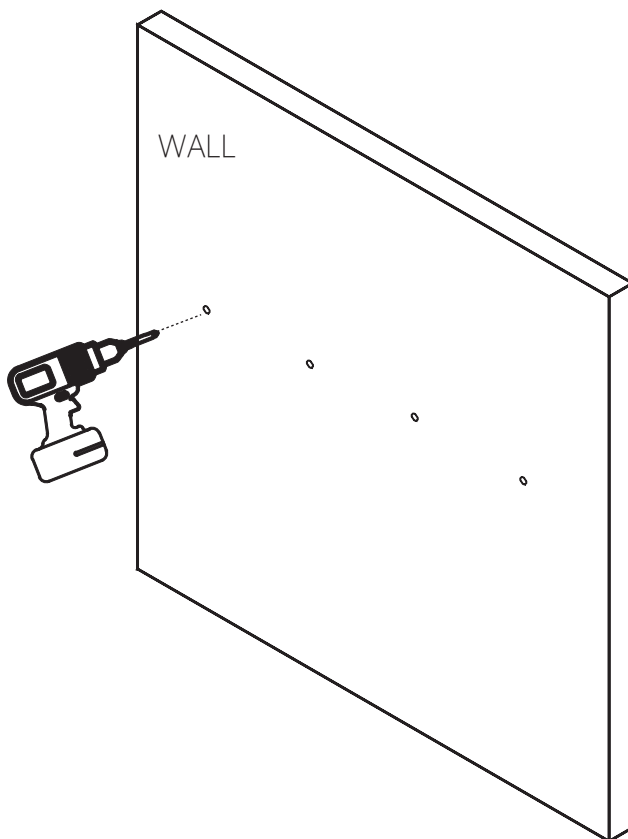

STEP 3: For Wood Wall: Please skip this step and go directly to step 4. Hammer the Anchors (Part d) into place.

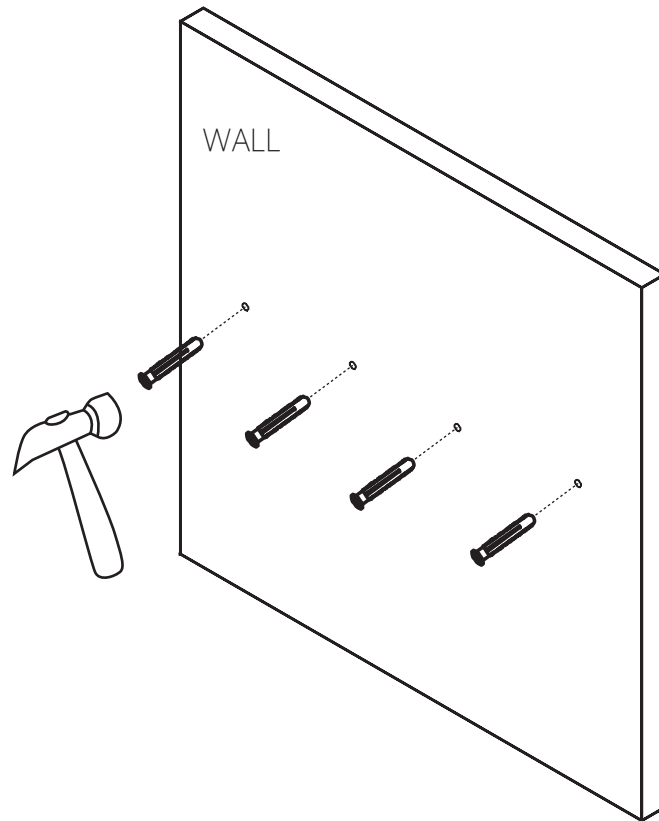

STEP 4: Place the Mounting Board (Part b) vertically under the hammered anchor hole from step 3 and mark the exact hole position with a pencil or pen against the vertical position.

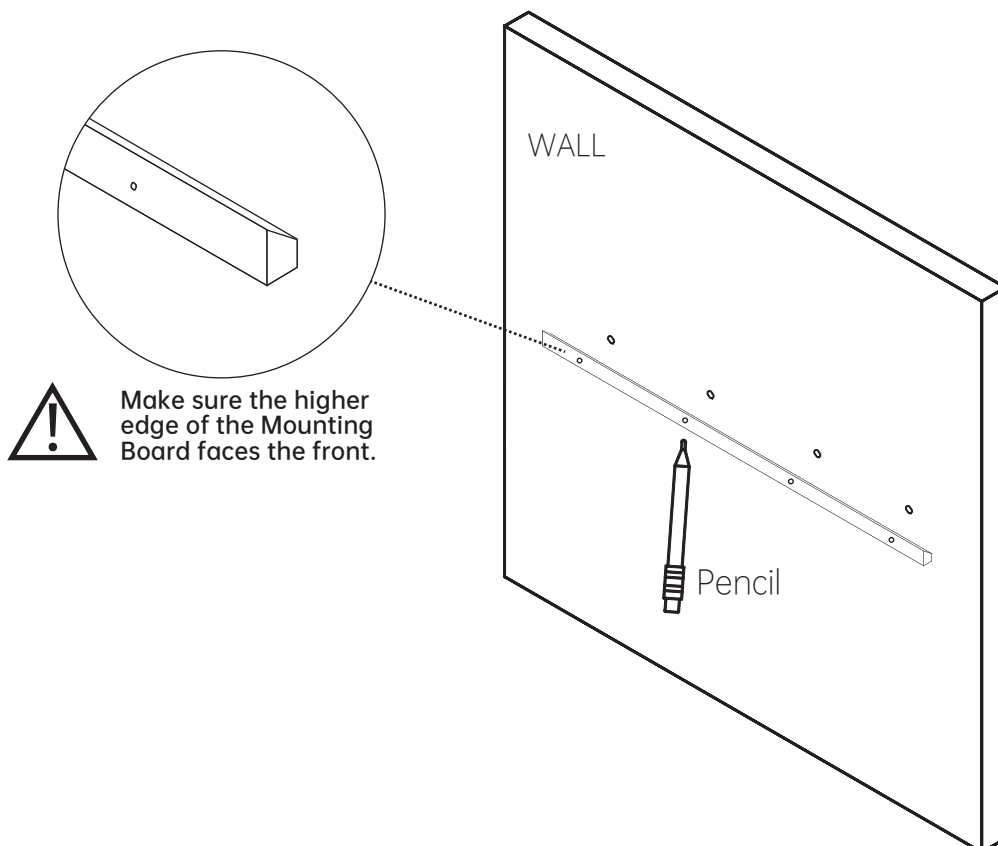

STEP 5: Use a Powerdrill to drill the holes you marked in Step 4.

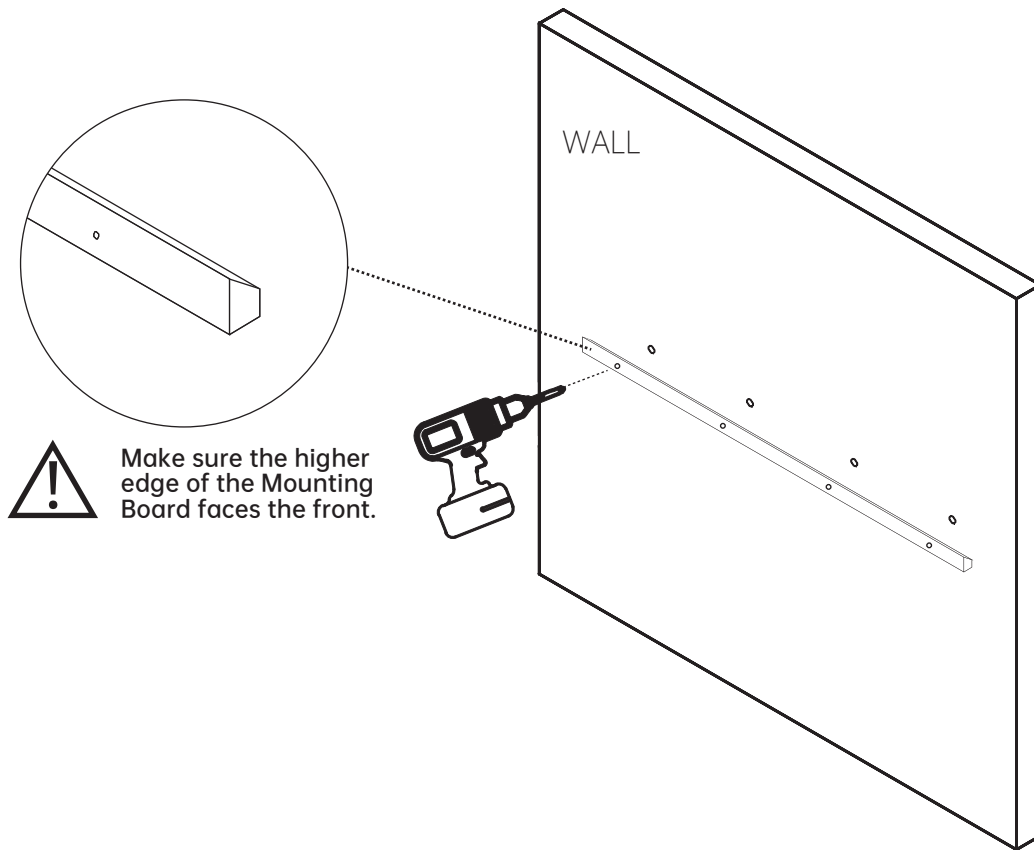

STEP 6: Align the holes on the Mounting Board from Step 5 with the anchor holes from Step 3, then use a power drill to screw in the screws (Part c) into the Mounting Board.

 Partially screw in the screws first, then check the alignment.

 Drill one screw first, and ensure the Mounting Board is level.

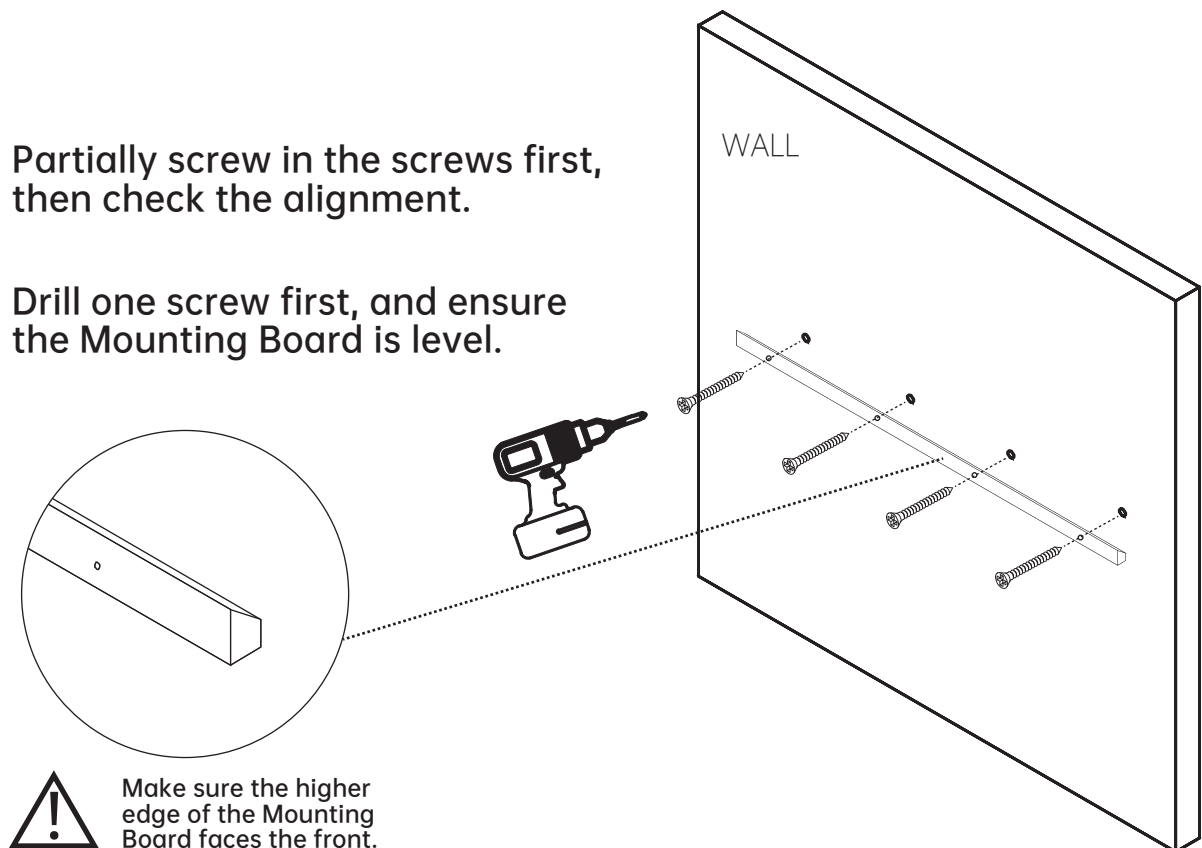

STEP 7: Insert the Mantel Shelf (Part a) to the Mounting Board, push down until the shelf is tight against the wall.

