

MODEL: V QUILTING QUEEN BED

ASSEMBLY INSTRUCTION

STEP 1

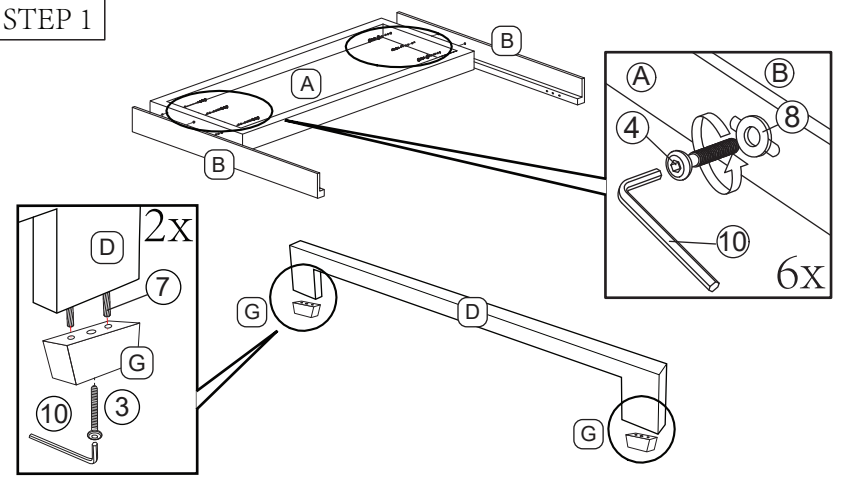

STEP 2

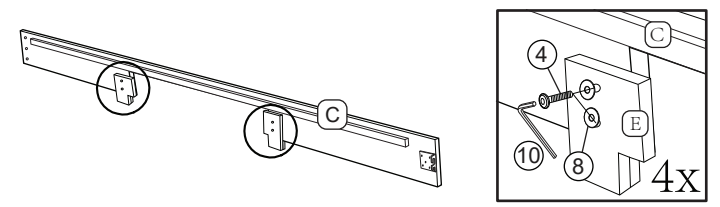

STEP 3

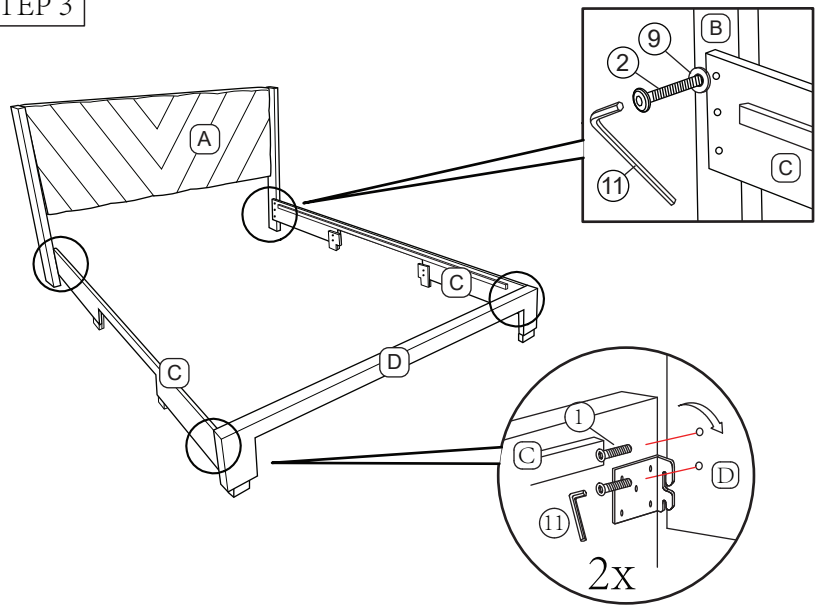

STEP 4

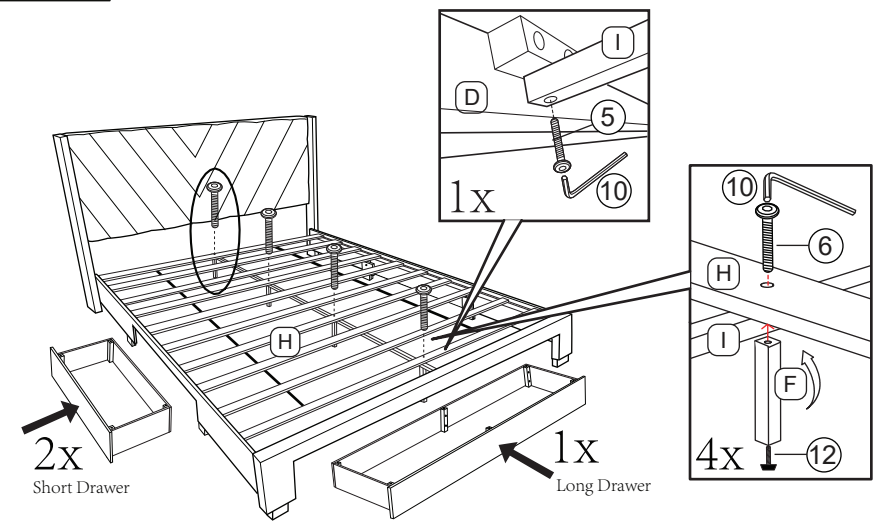

STEP 5

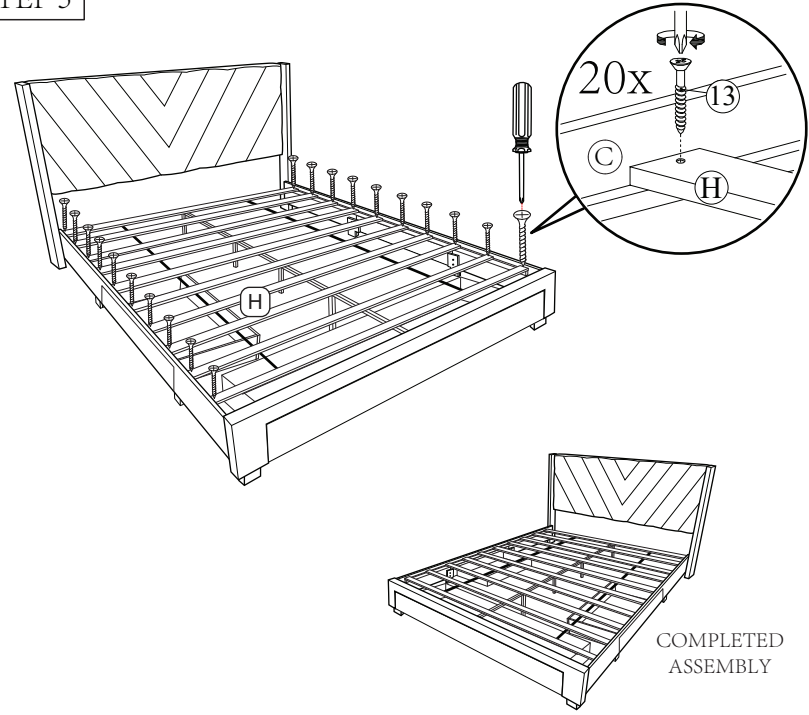

NO	PART LIST	QTY
A	Headboard	1 pc
B	Wing	2 pcs
C	Side Rail	2 pcs
D	Footboard	1 pc
E	Side Rail Support Leg	4 pcs
F	Center Support Leg	4 pcs
G	Bed Leg	2 pcs
H	Bed Slat	10 pcs
I	Center Support Rail	1 pc

NO	HARDWARE LIST	QTY
1	JCBB M8 x 20mm	4 pcs
2	JCBB M8 x 50mm	6 pcs
3	JCBC M6 x 70mm	2 pcs
4	JCBC M6 x 30mm	14 pcs
5	JCBC M6 x 35mm	1 pc
6	JCBC M6 x 60mm	4 pcs
7	Dowel M8	4 pcs
8	Flat Washer M6	14 pcs
9	Flat Washer M8	6 pcs
10	Allen Key M4	1 pc
11	Allen Key M5	1 pc
12	Adjuster M6	4 pcs
13	CSK M4 x 30mm	20 pcs

Read this instruction carefully. Remove all wrapping material, staples and straps from the carton. See hardware and furniture part list for guidance. Be sure you have all wooden furniture parts on a clean and flat soft surface, such as a carpet or rug, to prevent from being scratched.

CAUTION:

1. Do not FULLY - TIGHTEN the nut or screw until all ready to assemble.
2. Do not OVER - TIGHTEN the nut or screw to avoid causing damages to the thread.
3. Keep all hardware part out reach of children.



COMPLETED ASSEMBLY

MODEL: V QUILTING QUEEN BED (DRAWER PART)

ASSEMBLY INSTRUCTION

STEP 1

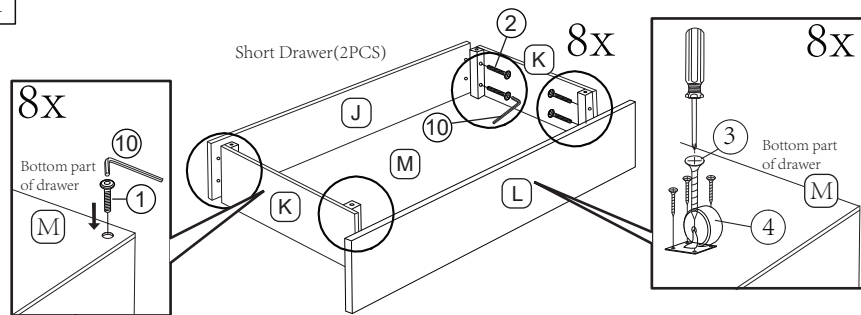

STEP 2

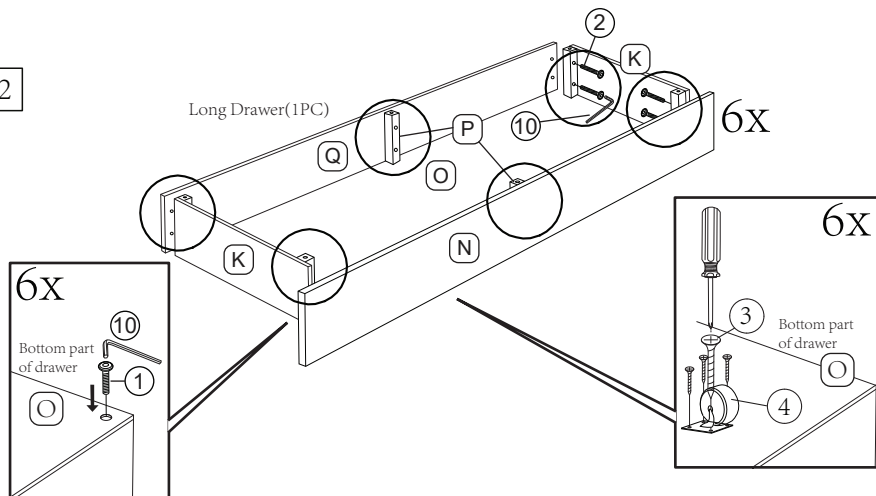

NO	HARDWARE LIST	QTY
1	JCBC M6 x 30mm	14 pcs
2	JCBC M6 x 35mm	28 pcs
3	CSK M3.5 x 12mm	56 pcs
4	Wheel	14 pcs

NO	PART LIST	QTY
J	Short Drawer Panel	2 pcs
K	Drawer Side Panel	6 pcs
L	Short Drawer Front Panel	2 pcs
M	Short Bottom Panel	2 pcs
N	Long Drawer Front Panel	1 pc
O	Long Bottom Panel	1 pc
P	Support Cube	2 pcs
Q	Long Drawer Panel	1 pc

Read this instruction carefully. Remove all wrapping material, staples and straps from the carton. See hardware and furniture part list for guidance. Be sure you have all wooden furniture parts on a clean and flat soft surface, such as a carpet or rug, to prevent from being scratched.

CAUTION :

1. Do not FULLY - TIGHTEN the nut or screw until all ready to as semble.
2. Do not OVER - TIGHTEN the nut or screw to avoid causing damages to the thread.
3. Keep all hardware part out reach of children.

