

INSTALLATION INSTRUCTIONS

LED FLUSH MOUNT LIGHT

STEP1

Turn off the power.

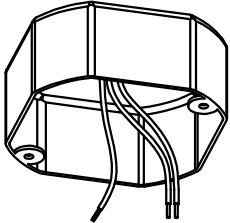

STEP2

Install connector "I"(supplied) onto stripped wire ends of supply wire adapter. Be sure to align black wire with black strip on connector. Push wires into connector until firmly. Pull lightly on wires to confirm they are locked into the connector.

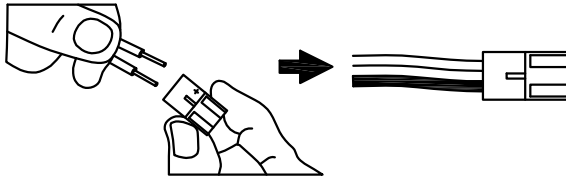

STEP3

Remove the Mounting Plate from the back of the fixture.

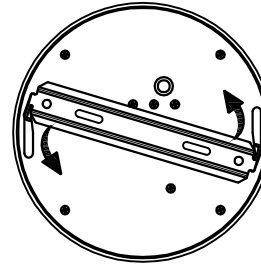

STEP4

Attach the Mounting Plate to Outlet box using the two screws(provided)-pull the AC cable with connector through the bracket center hole.

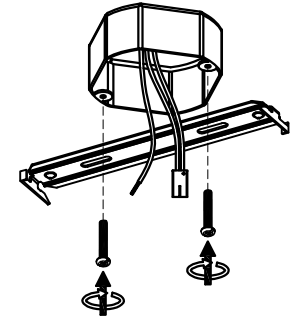

STEP4

Connect the electrical wires as shown in, making sure that all wire connectors are secured. If your outlet box has a green or bare copper ground wire, connect the fixture's ground wire to it. After wires are connected, As shown in the figure, Push and feed all wires up into outlet box.

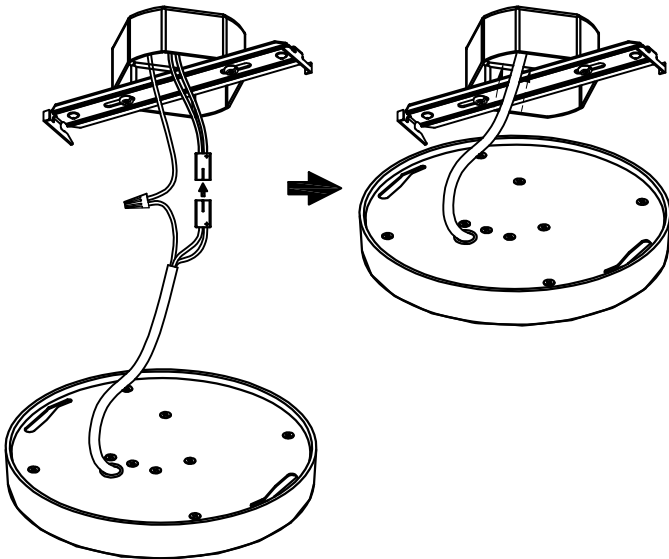

STEP6

As shown in the figure, Use the arrowhead label on the lamp as a guide, align the bracket of the mounting plate to one end, Slip this side of the fixture into this end, and attach the other side of the bracket to the fixture carefully.

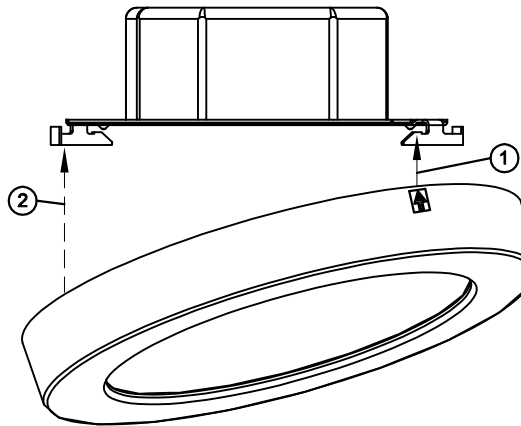

STEP7

Rotate the lamp in a clockwise direction, The mounting plate the bracket into the lamp.

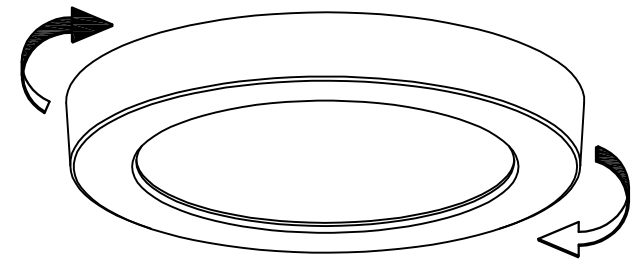

SAVE THESE INSTRUCTIONS AND WARNINGS.

This product is designed for dimming with many 120V Leading Edge(LE)and Trailing Edge(TE)phase control dimmers. compatible with most residential type dimmers available on the market. The dimming performance will depend on kinds of dimmer and dimmer settings.(not provided).