

# Assembly Instructions

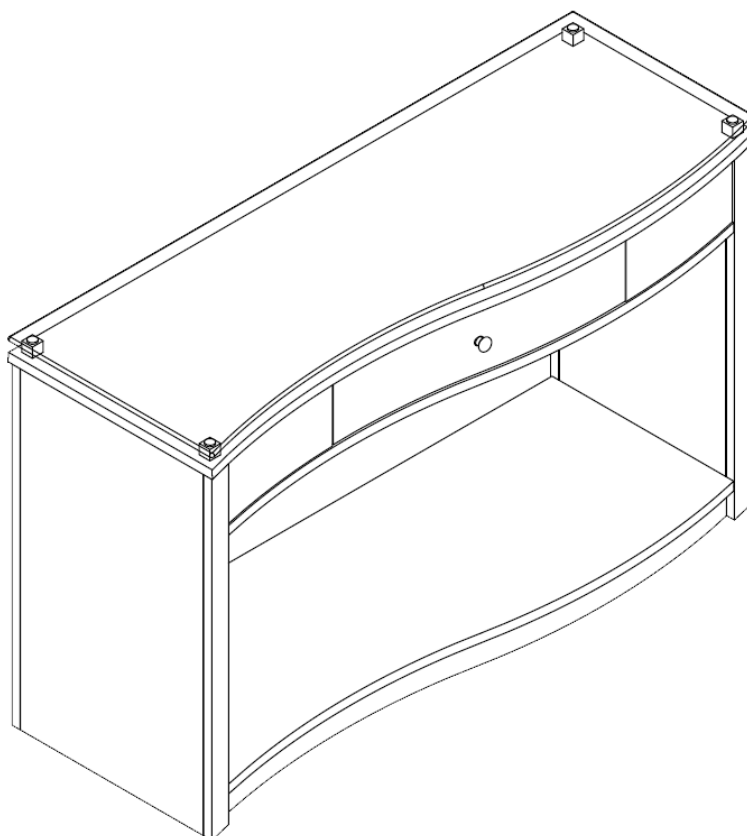

## ASSEMBLY RATING

The Assembly Rating is a 5-point system that shows the degree of effort needed in assembling a specific product (with 1 being easy and 5 being difficult). For some products, two persons are recommended.

EASY  DIFFICULT

## Tools Required for Assembly:

Allen Wrench



(Included)

Phillips Screwdriver



(Not Included)

# ASSEMBLY & CARE ADVICE

FOR YOUR FURNITURE TO LAST, CORRECT ASSEMBLY AND PROPER MAINTENANCE ARE NECESSARY.  
PLEASE FOLLOW THE INFORMATION PROVIDED BELOW TO FULLY ENJOY YOUR FURNITURE.

## BASIC ASSEMBLY TECHNIQUES

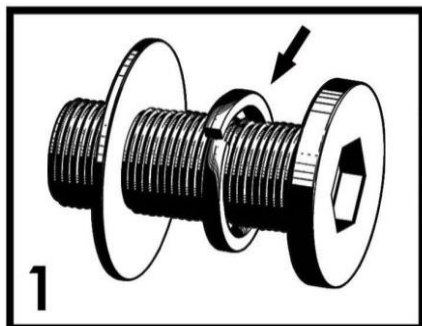

When lock or spring washer is used in an assembly, please make sure the lock or spring washer is placed between the larger flat washer and the head of the screw or bolt.

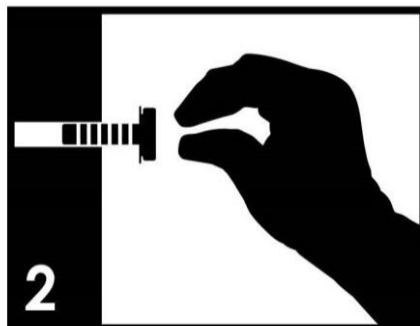

Position each part correctly and insert screws or bolts into their respective holes by hand tighten or using the proper hand tool. Only tighten when step is completed or when instructed to do so.

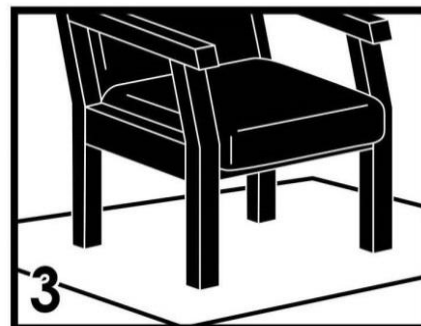

Use cardboard or carpet area when assembling furniture to prevent scratches. Make sure the furniture rests on a flat and level surface with each leg evenly touching the floor.

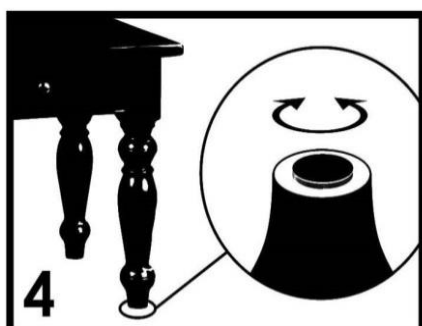

Some furniture comes with height adjustment knobs underneath each leg. To lower or to raise each leg, you need to turn clockwise or counterclockwise, respectively.

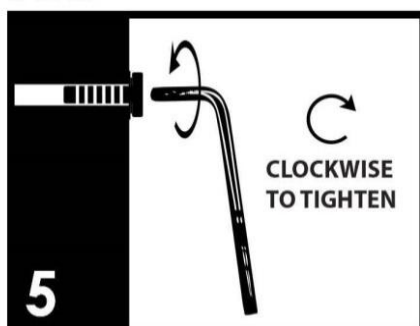

Make sure all parts are properly aligned, then use the appropriate hand tool to completely tighten the bolts or screws. Do not use power tools and do not overtighten.

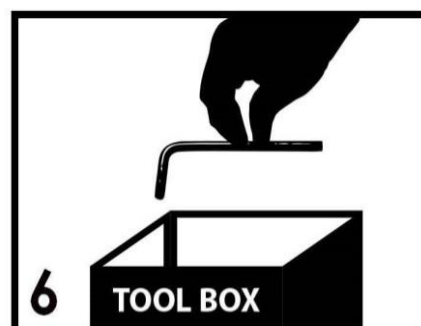

Save the instructions and store the Allen wrench or any supplied tool for later maintenance. After two weeks, check and tighten any loose hardware and repeat again every six months thereafter.

IT IS THE USER'S RESPONSIBILITY TO MAINTAIN THE FURNITURE. THE HARDWARE MAY LOOSEN OVER TIME AND MAY CAUSE THE FURNITURE TO BE WOBBLY AND UNABLE TO SUPPORT ITS INTENDED WEIGHT CAPACITY. THIS MAY LEAD TO COLLAPSE AND MAY CAUSE SERIOUS INJURY.



FAILURE TO FOLLOW THE GUIDELINES ABOVE MAY  
RESULT IN INJURY AND/OR PROPERTY DAMAGE.



Before you begin, please read Page 2 of "Assembly and Care Advice".

And remember, do not tighten until each step is completed or instructed.

MD

### Parts List



#1 x 1 pc  
Table Top



#2 x 1 pc  
Left Panel



#3 x 1 pc  
Right Panel



#4 x 1 pc  
Base



#5 x 1 pc  
Glass Top

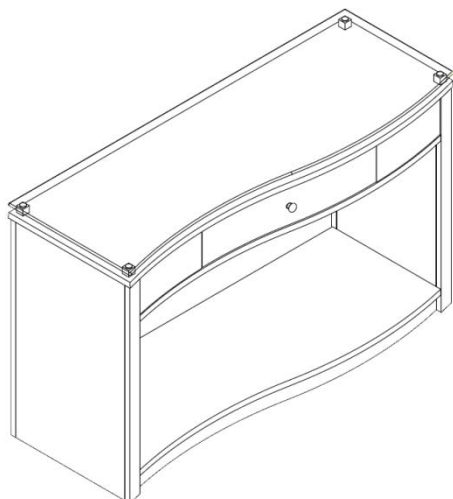

### Hardware List



#A x 12 pcs  
Bolt 1/4"x1-1/2"



#B x 12 pcs  
Lock Washer



#C x 12 pcs  
Flat Washer



#D x 4 pcs  
Spacer



#E x 4 pcs  
Bumper



#F x 4 pcs  
Screw



#G x 1 pc  
Allen Wrench



#H x 8 pcs  
Wood Dowel



- I. Insert 4 wood dowels (#H) into the right panel (#3).
- II. Align the right panel (#3) with the pre-drilled holes of the table top (#1) AND the base (#4).
- III. Prepare 6 bolt assemblies by inserting FIRST the lock washer (#B) onto the bolt (#A) and the flat washer (#C) onto the SAME bolt (#A), in that order.
- IV. Insert 4 bolt assemblies through the pre-drilled holes on the inside of the table top (#1) AND two bolt assemblies through the pre-drilled holes on the inside of the base (#4) and secure those bolts using the Allen wrench (#G) to lock them in with the right panel (#3).
- V. Repeat process I through IV above to assemble the left panel (#2) onto the table top (#1) AND the base (#4).

#A x 12 pcs  
#B x 12 pcs  
#C x 12 pcs  
#H x 8 pcs

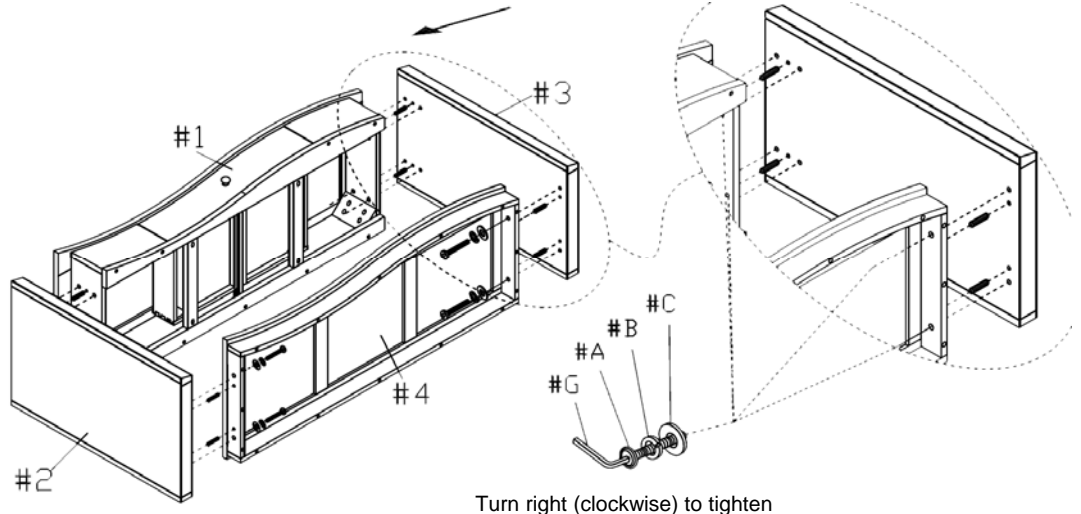

Note: Right and left are determined by standing in FRONT of the table in its upright position.



- I. Align the 4 spacers (#D) with the pre-drilled holes on the top of the table top (#1).
- II. Insert a screw (#F) through the spacer (#D) and secure that screw using the Phillip screwdriver to lock it in with the table top (#1).
- III. Repeat the process for the remaining 3 spacers (#D).
- IV. Insert the 4 bumpers (#E) over the screws (#F).

#D x 4 pcs  
#E x 4 pcs  
#F x 4 pcs

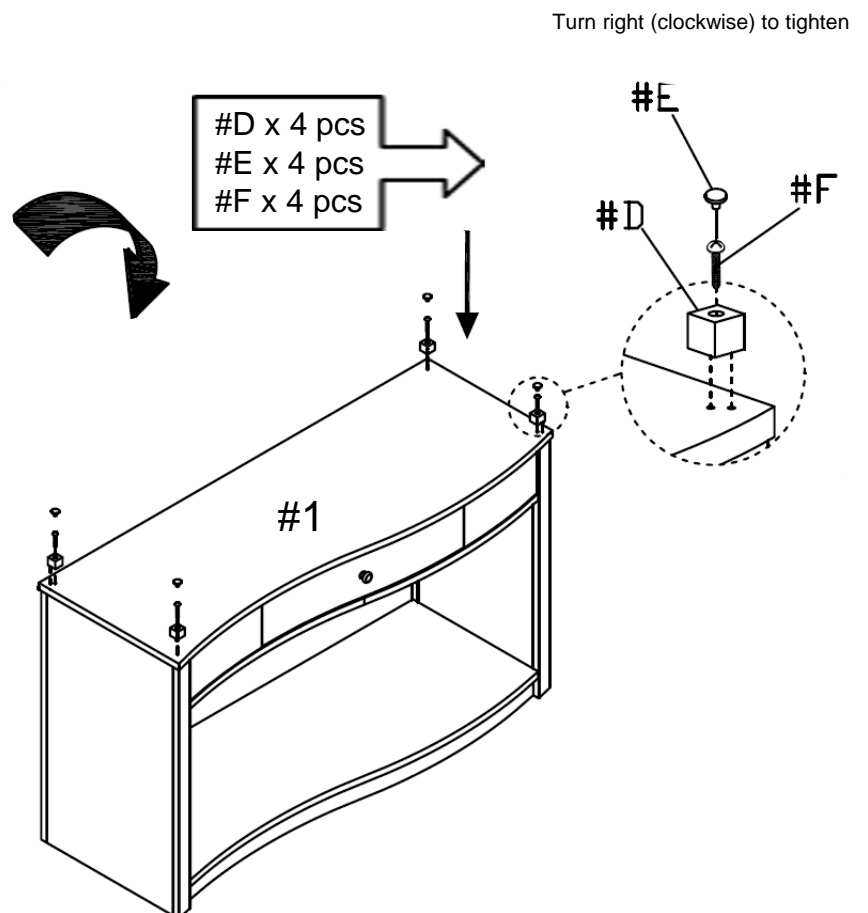



- I. Carefully place the glass top (#5) over the table top (#1) and let it rest on the 4 bumpers (#E). Align the glass top (#5) if necessary.
- II. Make sure the table is rested on a flat surface and it does not feel loose or wobbly. If it does, double check that the bolts are secured and properly tighten.

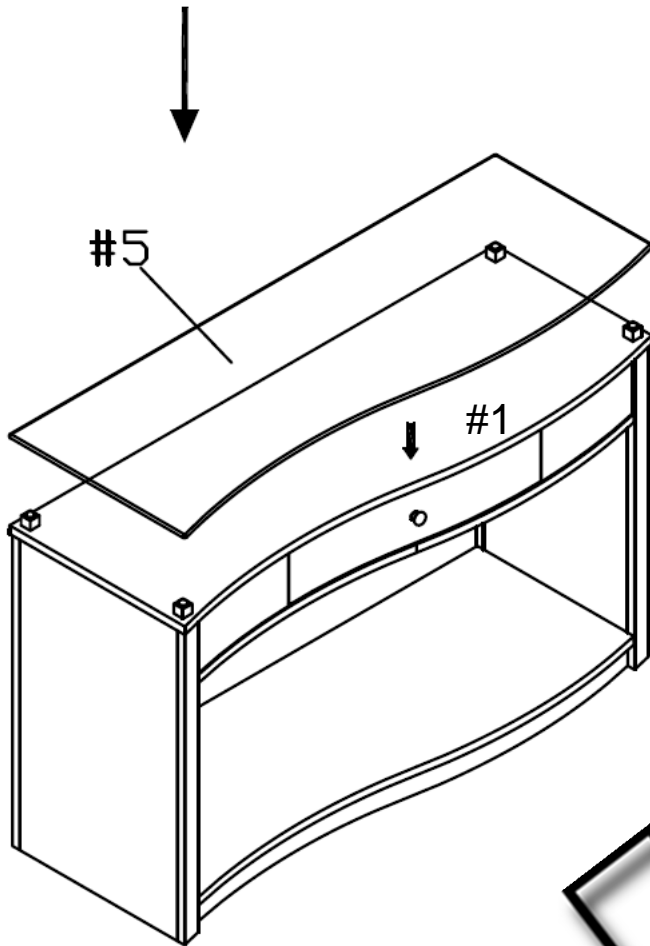

ASSEMBLY IS COMPLETED