

Safety Instructions

- ❗ Please read the instruction carefully before using.
- ❗ Before assembly compare the contents with list to make sure the package includes all the parts.
- ❗ Make sure the wall can bear the weight of the mirror.
- ❗ Do not use string or chain to hang the products.
- ❗ Please keep your property away during the installation to avoid any damage.
- ❗ Intended for residential use only.

Parts list

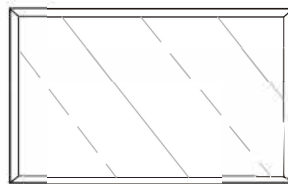

Mirror
#11 pic



Bolt
#AX2 pic



screw
#AX2 pic

Tools Required (Not Provided)



pen



tape



Hammer



Screwdriver

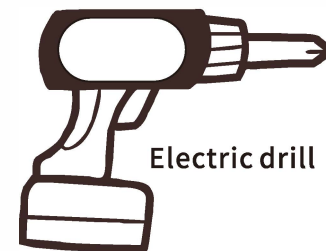

Electric drill

Care Advice

- Before using, wipe with a dry and clean cloth.
- Check all the screws and bolts are tight every three months or as needed.
- Clean with glass cleaner or detergent.

Standing mirror

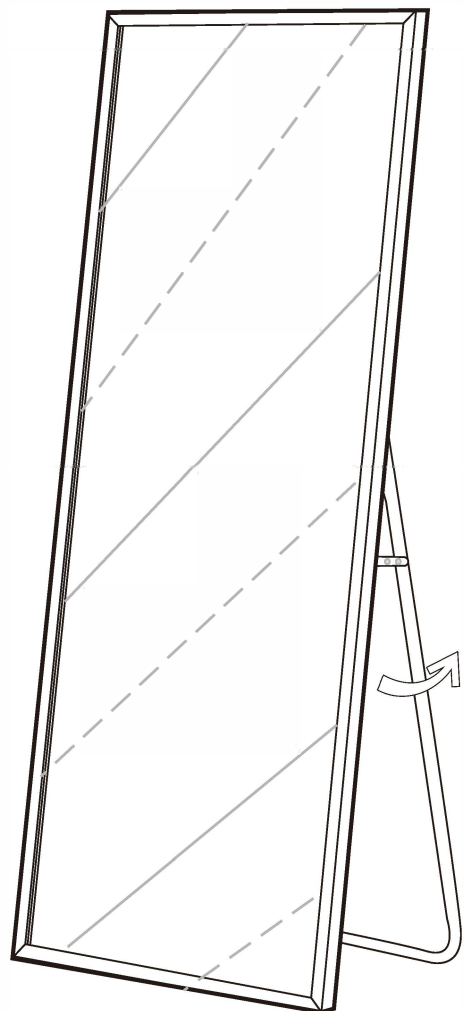

STANDING

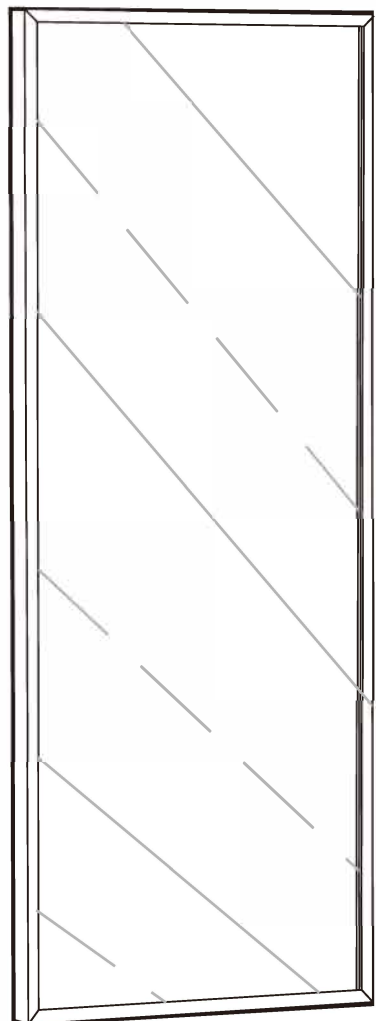

LEANING

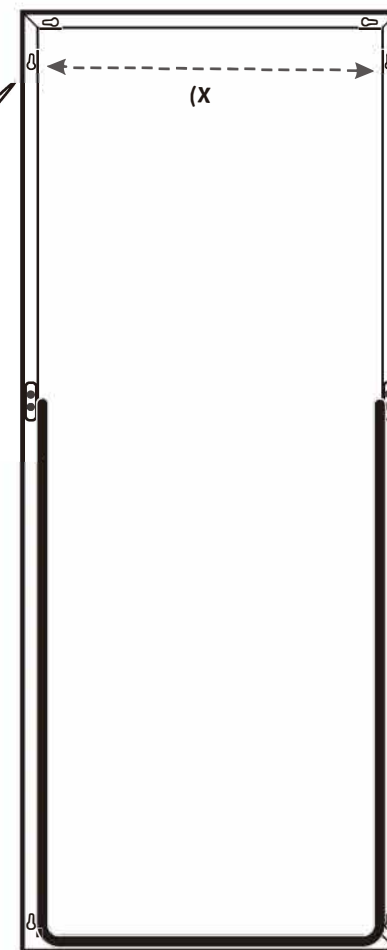
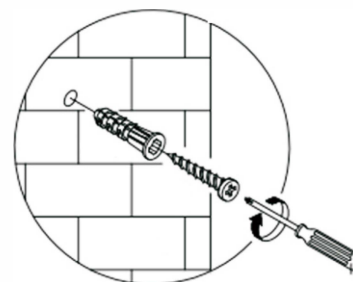
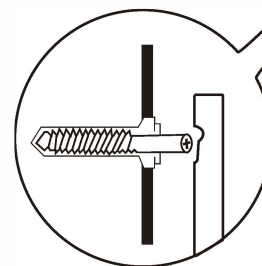
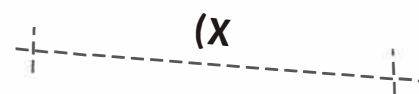

Measure the distance between the hole on the mirror frame and measure the same size on the wall. Then use a tool to punch holes in the wall and install screws. Finally, after confirming that the wall can bear the weight of the mirror, you can hang the mirror on the wall