

INSTRUCTION MANUAL

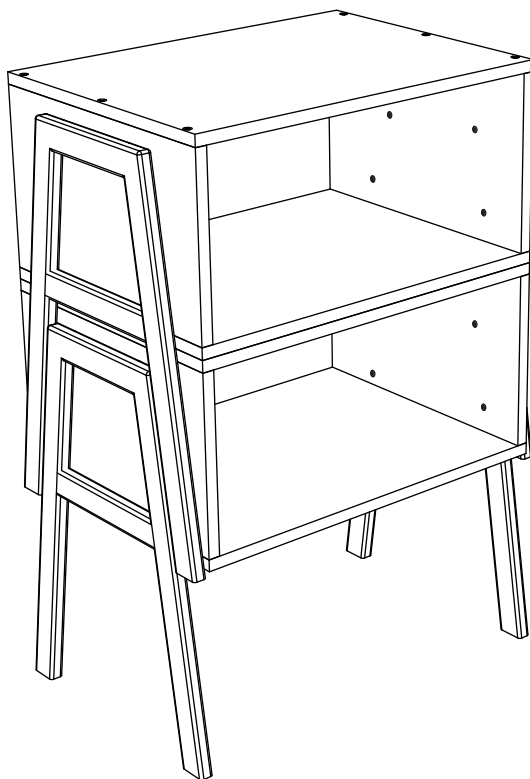

End Table

Tools Needed (NOT Included)



Phillips Screwdriver

Supplied Parts and Hardware

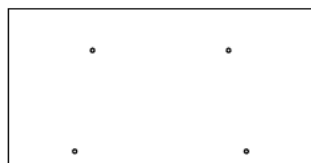

Side Panel
[01] x 4



Panel
[02] x 4

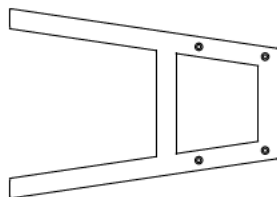

Leg
[03] x 4



Screw
M4 x 25mm
[A] x 24



Bolt
M6 x 18mm
[B] x 16



Foot Pad
[C] x 8

Step 1

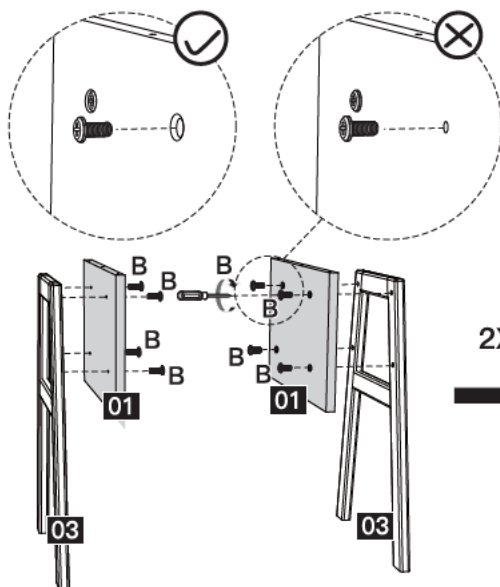

NOTE: Attach the side panels [01] to the legs [03] with larger predrilled holes facing out.

01 x 4
03 x 4

B x 16

Tip: Align and loosely thread all bolts into the corresponding holes before fully tightening each bolt.

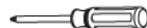

Phillips Screwdriver
(Not included)

Step 2

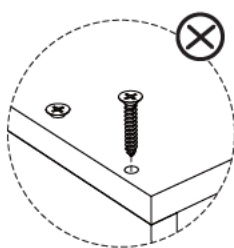
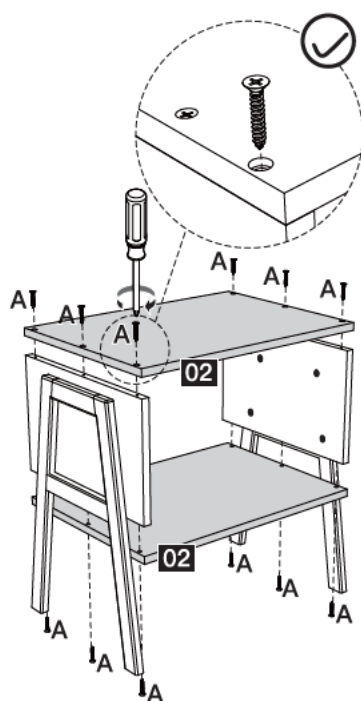

NOTE: Attach the panels [02] to the assembled sections with larger predrilled holes facing out.

02 x 4

A x 24

C x 8

2X

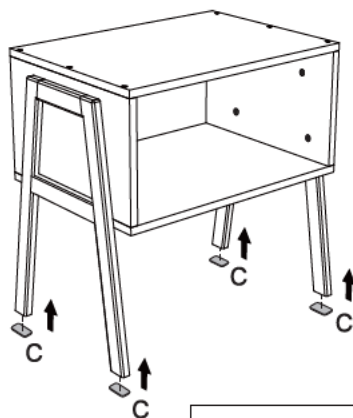

Tip: Align and loosely thread all screws into the corresponding holes before fully tightening each screw.

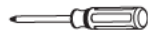

Phillips Screwdriver
(Not included)

Step 3

Option A

