

## INSTALLTION GUIDE FOR CAFÉ ROD SET

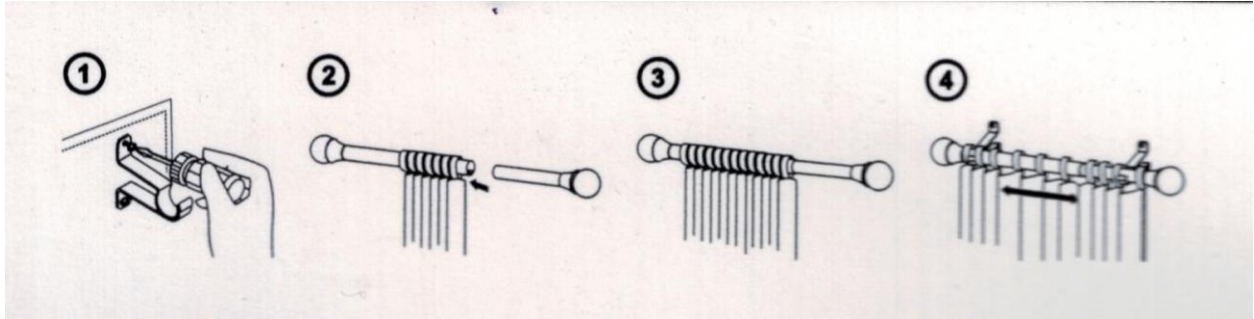

1. Place brackets against wall at desired locations. Mark screw holes with pencil. Be sure marks are level across opening. Screw in brackets directly to the wall.
2. Assemble rod and sheer drapery treatment onto rod.
3. Extend rod to desired width. Lift rod with drapery and drop into brackets.
4. Adjust draperies to desired position.