

EL901HT

6" New Construction
Super Sloped Housing, Non IC

PROJECT INFORMATION:

Project Name: _____

Fixture Type: _____

Date: _____

DIMENSIONS

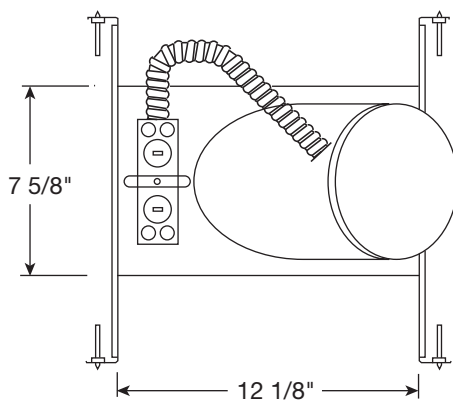
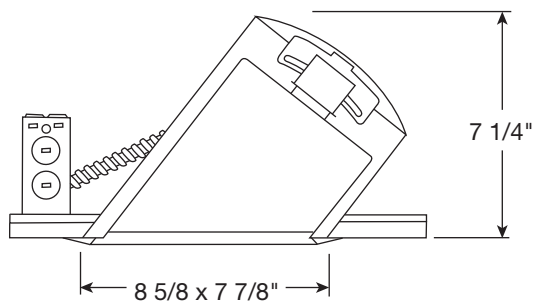

PRODUCT SPECIFICATIONS

Housing Features: For use in existing insulated ceilings. Integral thermal protector guards against improper lamping. Single wall construction. Adjustable socket bracket on trims allow the use of different lamp types and sizes as well as proper and consistent lamp positioning.

Lamp: 120V, 85W max, AR30 / PAR38 150W, R30.

Lamp Holder: Medium base socket.

Trim Ring: Polycarbonate trim ring, metal trim ring or flanged design to conceal ceiling cut-out. See trim page for trim railing selections.

For use in 7/12 to 12/12 ceiling.

INSTALLATION

Junction Box: Pre-wired junction box provided with 1/2" and 3/4" knockout through branch wiring, maximum (8) NO. 12AWG branch circuit conductors (4 in, 4 out). Junction box provided with removable access plates.

Mounting: Hanger bars expand 25".

Mounting Frame: Stamped steel for corrosion resistance.

Labels: • U.L. listed for feed through

CATALOG NUMBER

Example: EL901HT - EL602W

See trims page for variety of trims available.

2042 East Vernon Avenue, Vernon, CA 90058 • Tel: (323) 231-2600 Fax: (323) 231-3200 • www.elcolighting.com

© ELCO LIGHTING 2012 All Rights Reserved. Rev. July 2012. ELCO Lighting reserves the right to make specification and design changes without notice.

ELCO
LIGHTING

