

# SUBMITTAL SHEET

K Series Convection Baseboard Heaters

500 to 2500 Watts

120, 208/240, 277 Volts



DATE: \_\_\_\_\_

JOB NAME: \_\_\_\_\_

LOCATION: \_\_\_\_\_

ARCHITECT: \_\_\_\_\_

ENGINEER: \_\_\_\_\_

CONTRACTOR: \_\_\_\_\_

SUBMITTED BY: \_\_\_\_\_

SELECTION								
ITEM	QTY	CATALOG NUMBER	TAG	WATTS	VOLTS	PHASE $\phi$	AMPS	AVAILABLE CONTROLS

ACCESSORIES AND CONTROLS				
ITEM	QTY	CATALOG NUMBER	TAG	DESCRIPTION

REV. 09.03.14

## STANDARD DENSITY: 250 WATTS PER FOOT

WATT S	120 V		208 V		240 V		277 V		LENGTH	WT. (lbs.)
	*MODEL	UPC# 093319	MODEL	UPC# 093319	MODEL	UPC# 093319	MODEL	UPC# 093319		
500	2K1205BW	11364	2K2005BW	11384	2K2405BW	11412	2K2403BW	11444	27"	6.5
750	3K1207BW	11368	3K2007BW	11388	3K2407BW	11416	3K2405BW	11448	3 ft.	8
1000	4K1210BW	11372	4K2010BW	11392	4K2410BW	11420	4K2407BW	11454	4 ft.	10.5
1250	5K1212BW	11374	5K2012BW	11396	5K2412BW	11424	5K2410BW	11458	5 ft.	13
1500	6K1215BW	11376	6K2015BW	11400	6K2415BW	11428	6K2412BW	11462	6 ft.	15
1750					7K2418BW	11432			7 ft.	19
2000			8K2020BW	11404	8K2420BW	11436	8K2415BW	11466	8 ft.	19

## MODEL CODE

4K2410BW

4	Length
K	Series
240	Volts
1000	Watts
	A-Almond
BW	BW-Bright White

Standard Color: (-BW) Bright White

Optional Color: (-A) Almond

## LOW DENSITY: 187 WATTS PER FOOT

WATTAGE	208 V		240 V		LENGTH	WT. (lbs.)
	*MODEL	UPC# 093319	*MODEL	UPC# 093319		
375	2K2405BW	11412	2K2403BW	11444	27"	6.5
563	3K2407BW	11416	3K2405BW	11448	3 FT.	8
750	4K2410BW	11420	4K2407BW	11454	4 FT.	10.5
938	5K2412BW	11424	5K2410BW	11458	5 FT.	13
1125	6K2415BW	11428	6K2412BW	11462	6 FT.	15
1313	7K2418BW	11432			7 FT.	19
1500	8K2420BW	11436	8K2415BW	11466	8 FT.	19

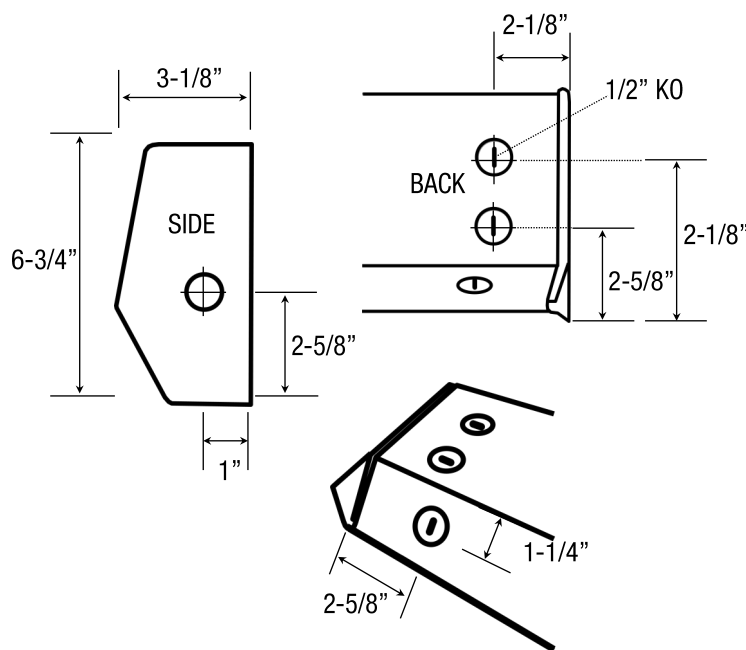

## ENGINEERING SPECIFICATIONS

Contractor shall supply and install K Series electric convection baseboard heaters manufactured by King Electrical Mfg. Co. of the wattage, voltage and length indicated on the plans.

### Construction:

- The heater shall take room air in the bottom (lower front) and discharge it through the top front.
- The heater back, bottom, and top shall be fabricated from electro galvanized 22 gauge steel. Front panels shall be fabricated from 20 gauge electro galvanized steel, ribbed longitudinally for extra strength and have center support to resist impact loads.
- The heater casing shall have modern rounded ends and corners to provide a smooth appearance, finished with a baked enamel.
- The heater shall be provided with a continuous capillary sensor tube for thermal protection, extending the full length of the heating element, rated at 175° F, and be a fail-safe type.

- The heater shall have a 44 cubic inch junction box at both ends, furnished with 5 1/2" knockouts located on the back, bottom and side.
- Heater elements shall consist of high quality 80% Nickel and 20% Chromium alloy resistant wire completely surrounded by Magnesium Oxide and enclosed in a rust-resistant sheath. Ribbon aluminum fining shall be compression welded to the sheathed element to provide chimney-type flue for heat transfer.
- Heaters shall be supplied with a one year limited warranty.

### Rating and Approval:

- The heaters shall be available in ratings from 375 to 1,500 Watts at 120 Volts and 375 to 2,500 Watts at 208/240 and 277 Volts.
- The heaters shall be available in 178 or 250 Watts per lineal foot.
- UL (E29778), cCSAus (43323)

## ACCESSORIES

MODEL	DESCRIPTION	UPC# 093319	WT. (lbs.)
BKC	Corner Connector	11472	1
BKR120	Duplex receptacle cover plate (requires separate circuit)	11492	1
BKLT120	Load transfer cover plate (Heat/Cool/Off) 120V	11480	1.5
BKLT240	Load transfer cover plate (Heat/Cool/Off) 240V	11482	1.5
BKHCT240	Heat/Cool switch 240 V double pole thermostat—junction box cover	11478	1.5
BKCB1	4" relay control box (relays not included)	11518	1.5
BKCB2	8" dual relay control box (relays not included)	11490	3
BKT1	Built-in single pole single throw thermostat kit	11496	1
BKT2	Built-in double pole single throw thermostat kit	11502	1
BKT1-TP	Built-in tamperproof thermostat kit single pole single throw	11528	1
BKT2-TP	Built-in tamperproof thermostat kit double pole single throw	11530	1
	12 oz. can spray paint—bright white	19565	.75
	12 oz. can spray paint—almond	19568	.75

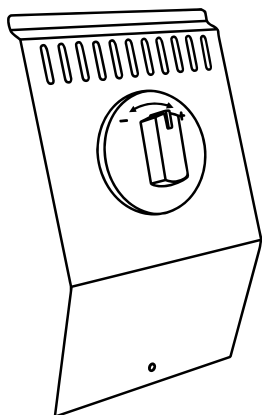

BKT1/BKT2—Built-in  
Thermostat Kit—SPST/DPST

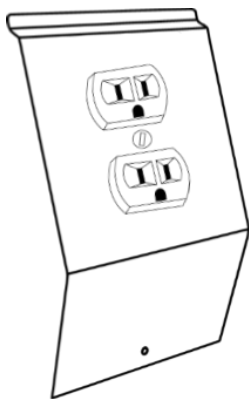

BKR120—Duplex Receptacle  
Cover Plate (requires separate  
circuit.)



Baseboard 18 Gauge Cover Adder (NON-CANCELLABLE  
NON-RETURNABLE ITEM) (NCNR)

BKHCT240

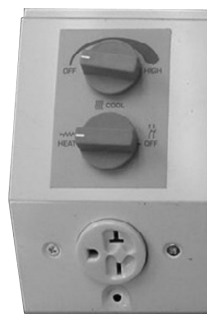

K-Series Heater Shield  
(Made to order)

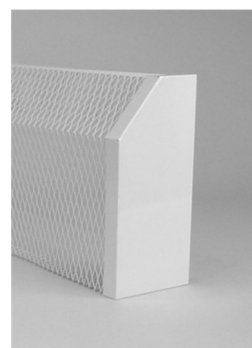

BKLT240

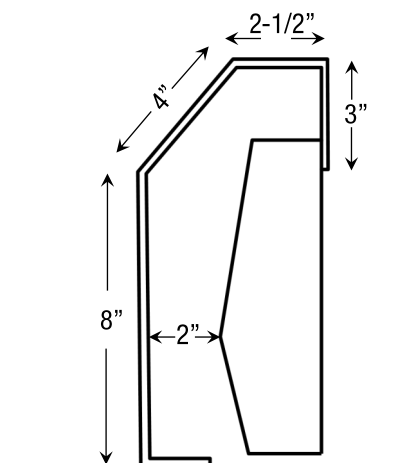

MODEL	SHIELD (specify color—Almond or White) Non Cancellable Non Returnable Item (NCNR)	UPC# 093319	WT. (lbs.)
SHIELD-33"	K-Series Heater Shield for 27" Baseboard	10290	6
SHIELD-42"	K-Series Heater Shield for 3' Baseboard	10291	7
SHIELD-54"	K-Series Heater Shield for 4' Baseboard	10292	8.5
SHIELD-66"	K-Series Heater Shield for 5' Baseboard	10293	10
SHIELD-78"	K-Series Heater Shield for 6' Baseboard	10294	11
SHIELD-102"	K-Series Heater Shield for 8' Baseboard	10295	14

MODEL	COVER (specify color—Almond or White)	UPC# 093319	WT. (lbs.)
BB-18ga Cover 2'	18 Gauge Cover for 27" Baseboard	52054	1.5
BB-18ga Cover 3'	18 Gauge Cover for 3' Baseboard	52056	2
BB-18ga Cover 4'	18 Gauge Cover for 4' Baseboard	52058	2.6
BB-18ga Cover 5'	18 Gauge Cover for 5' Baseboard	52060	3.7
BB-18ga Cover 6'	18 Gauge Cover for 6' Baseboard	52062	4
BB-18ga Cover 8'	18 Gauge Cover for 8' Baseboard	52064	5.3