

Please check that all fittings are available and in good condition before assembly.
If you have any questions, please contact us , we will solve your problem in the first time.

PARTS LIST

Ax1



Bx1



Cx1

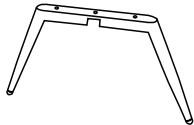

Dx1



Ex6



M6x20MM

Fx2



M6x25MM

Gx1

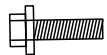

M6x30MM

Hx1



M6

ASSEMBLE INSTRUCTION

①

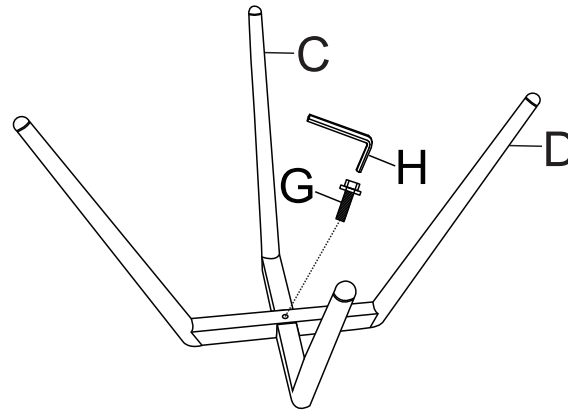

②

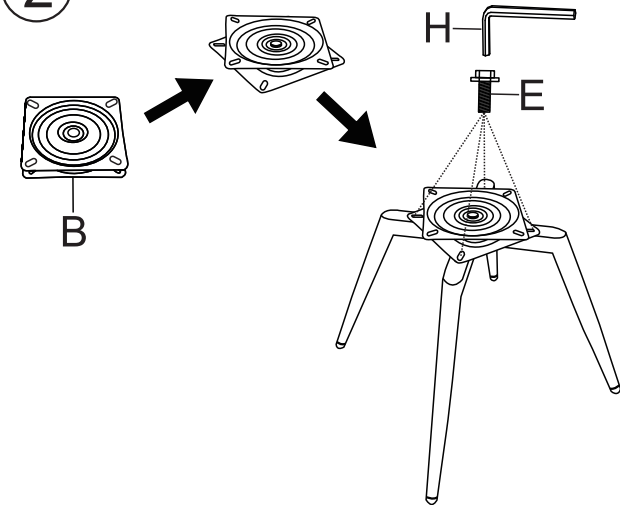

③

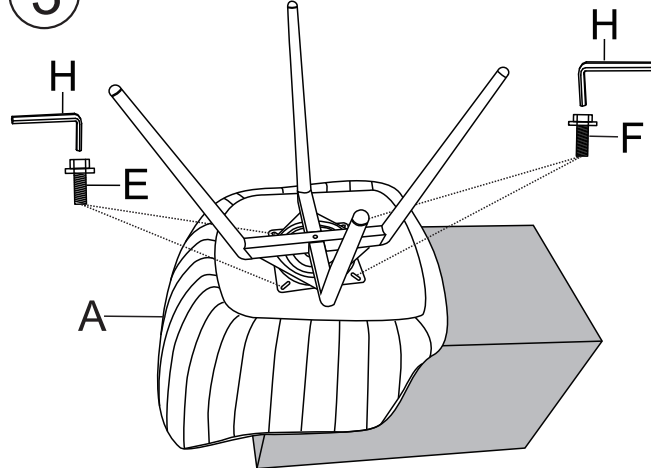

④

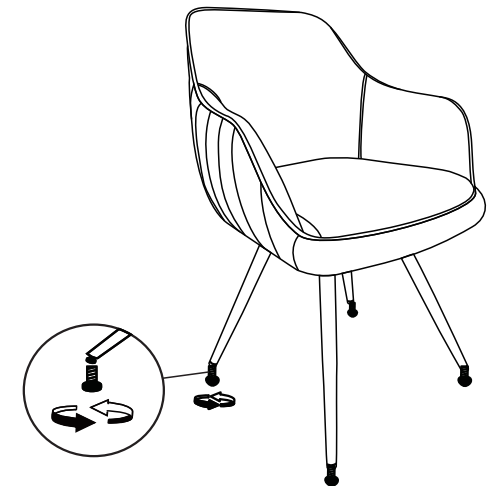

Adjust foot nails to make chair stable.