

3-SHELF ALUMINUM SERVICE CART - SCA3-2848

APPROX WEIGHT: 157.55 lbs.
DOES NOT INCLUDE WEIGHT OF POWER OR PACKAGING!!!

*** ANY ADDITIONS, DELETIONS, OR OMISSIONS MUST BE CORRECTED ON THIS DRAWING AS THIS DRAWING WILL BE CONSIDERED ALL INCLUSIVE ***
ALL GRAPHICS PROVIDED ARE FOR REFERENCE ONLY. IF CERTAIN DIMENSIONS ARE CRITICAL PLEASE VERIFY THOSE DIMENSIONS WITH YOUR SALESPERSON

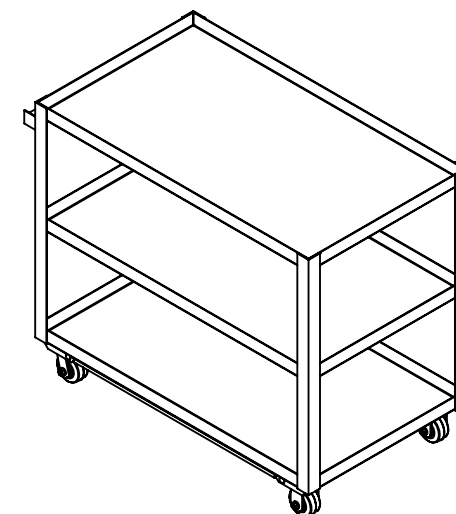
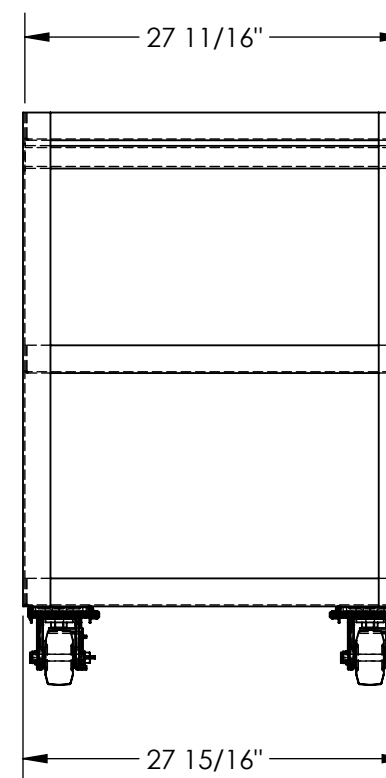
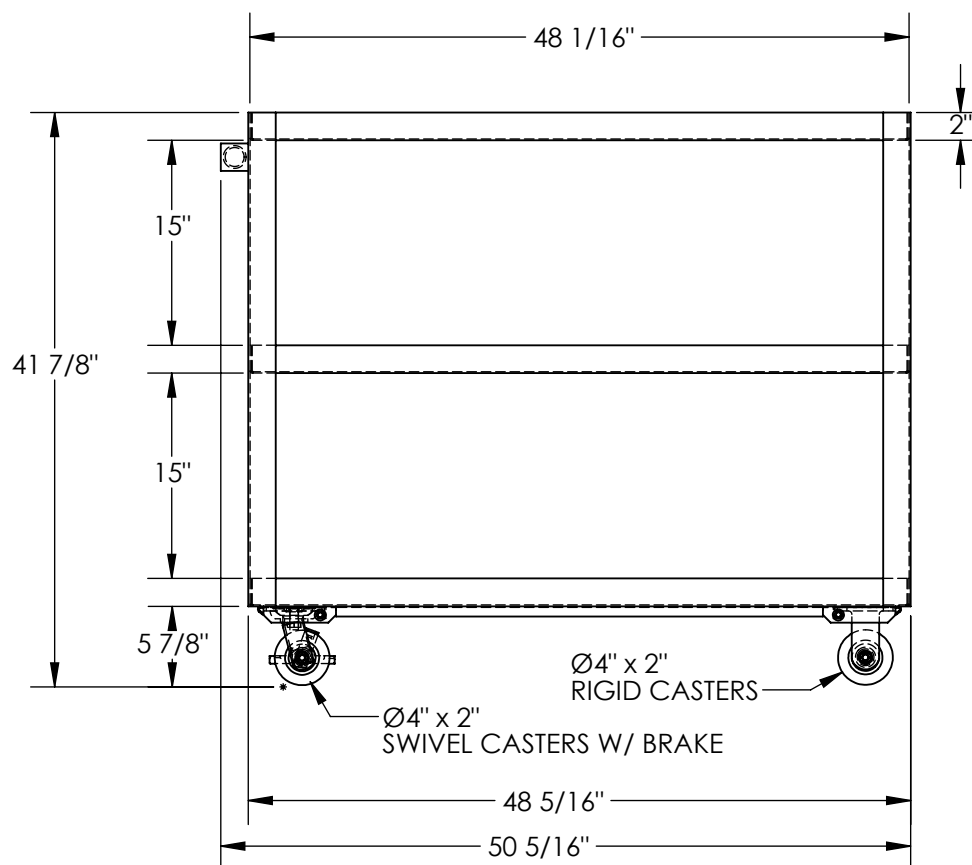

DIMENSION TOLERANCE $\pm 1/4"$

STANDARD FEATURES

MODEL NUMBER IS SCA3-2848
CAPACITY IS 660 LBS. (330 LBS. PER SHELF)
OVERALL WIDTH IS 27 15/16"
OVERALL LENGTH IS 50 5/16"
USABLE LENGTH IS 48 1/16"
OVERALL HEIGHT IS 41 7/8"
SHELF SIZE IS 27 11/16" X 48 1/16" X 2"
SHELF CLEARANCE IS 15"
Ø4" X 2" MOLD-ON-RUBBER CASTERS
2- RIGID CASTERS
2- SWIVEL CASTERS W/ BRAKE
ALUMINUM FRAME CONSTRUCTION

SPECIAL FEATURES

NONE

APPROVAL

I, THE UNDERSIGNED, AGREE THAT THE PRODUCT AS REPRESENTED SATISFIES DESIGN AND DIMENSION REQUIREMENTS. I ALSO ACKNOWLEDGE MY DUTY TO CONFIRM PRODUCT AND INSTALLATION COMPLIANCE WITH ALL APPLICABLE FEDERAL, STATE AND LOCAL REGULATIONS AND STANDARDS.

ANY MODIFIED UNITS ARE NON-RETURNABLE

[] As drawn [] As marked

Signed: _____ Date: _____

Printed Name: _____

LEAD TIME WILL START UPON RECEIPT OF SIGNED APPROVAL DRAWING

FOR INTERNAL USE ONLY
PROJECT SIGN OFF

SALES	
ENG.	
FAB.	
POWER	

DISTRIBUTOR'S NAME:

VESTIL MANUFACTURING

P.O.#

X

W.O.#

X

DRAWN BY: CA

DATE: 3/30/2015

SALES: X

REFERENCE: X

SCALE: 1:14

FILE NAME:

QUOTED LEAD TIME: X

QUOTE #

X

32-007-006