

Safety Instructions

1. Please read the instructions carefully before use.
2. Handle with care during installation of the product.
3. Voltage applied should match the rated voltage of this appliance.
4. Always try to keep mirror dry to have a better sensitivity of the buttons.
5. Do not expose the product to direct rinsing.
6. It is advisable that you employ plug cover for your power cord or power socket if your bathroom is susceptible to water vapour accumulation.
7. Disconnect the product from the power supply before cleaning.
8. After cleaning, ensure that the glass is completely dry before you turn it on for safety concerns.
9. Disconnect the product from the power supply and store the product if you don't need to use it for a long time. Keep it away from direct sunlight.
10. Children can operate this product only under the supervision of adults.
11. Keep it away from fire or heating source.
12. Stop using it immediately if light malfunctions or power cord is broken.
13. For daily maintenance, apply specialized mirror cleaner to clean the mirror.

Specifications

Overall Dimensions (L x W x H)	23 5/8" x 31 1/2" x 1 5/8" (60 x 80 x 4.2 cm)
Voltage	110 V
Power	50 W
Each LED Bead Luminous Flux	22 to 24 Lm
Net Weight	16 Lbs (7.05 kg)

Package Contents

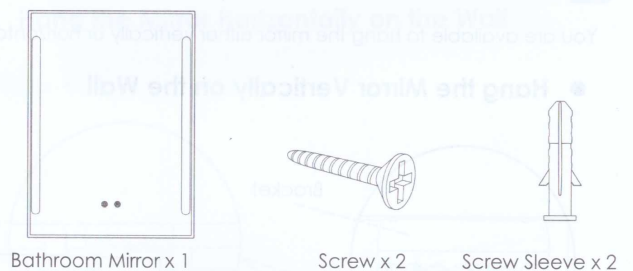

Installation Instructions

1 Install Screw Kits on the Wall



According to the position of the 2 brackets on the back of the mirror and the location of your power supply, drill 2 holes on the wall. Install the screw sleeves and screws on the wall correspondingly.

2 Hang Mirror on the Wall

You are available to hang the mirror either vertically or horizontally.

● Hang the Mirror Vertically on the Wall

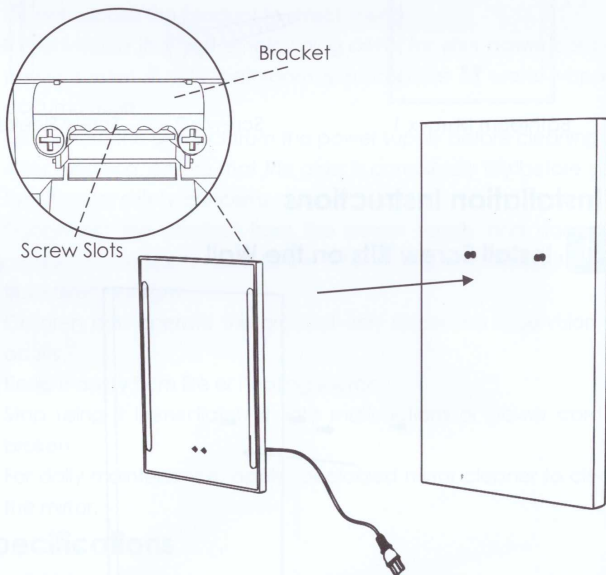

Hang the mirror onto the 2 screws and make sure that the screws match with the screw slots on the brackets properly.

Please note that there are 5 slots on the brackets, you can fine-tune the position of the mirror to obtain proper slots to hang mirror.

● Hang the Mirror Horizontally on the Wall

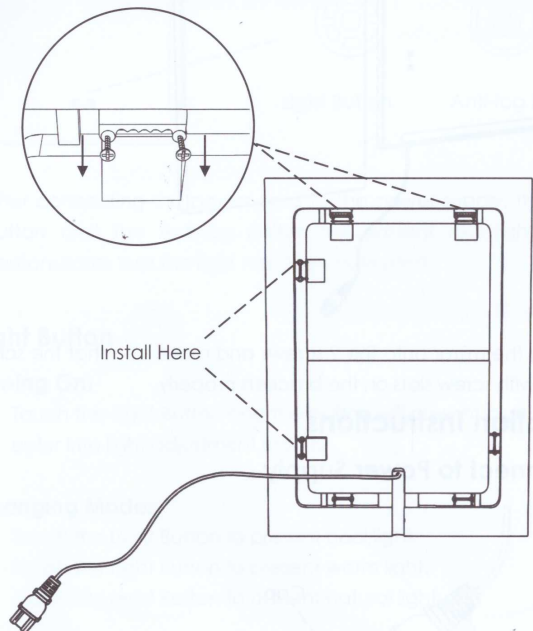

1. Unscrew 2 brackets on the vertical side with electric driller(not included) or other proper tool and install them onto the screw slots on the horizontal side of mirror.

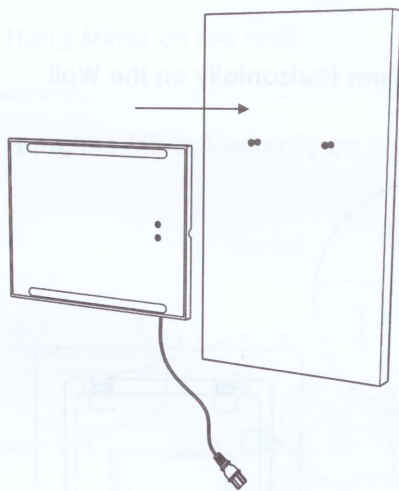

2. Hang the mirror onto the 2 screws and make sure that the screws match with screw slots on the brackets properly.

Operation Instructions

● Connect to Power Supply

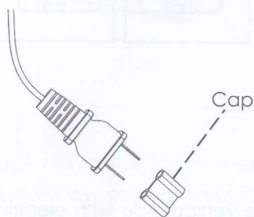

Take off the cap on the plug and connect the power cord to your power supply.



Light Button

Anti-fog Button

After connecting the power cord to the power supply, the mode button and the Anti-fog Button will present red light, which demonstrates that the light has been activated.

Light Button

Turning On:

- Touch the Light Button and the button will present blue light to enter into light adjustment mode.

Changing Modes:

- Touch the Light Button to present cool light.
- Touch the Light Button to present warm light.
- Touch the Light Button to present natural light.

Adjusting Brightness:

- Long press the Light Button in any of these 3 modes to adjust to your desired brightness.
- The lighting effects will get dimmed first and then become brighter.

Turning Off:

- Touch the Light Button again to turn it off.

Please note the product has memory function to record the brightness of the lighting modes. It will present the same brightness next time it enters into these modes.

Anti-fog Button



- Touch the Anti-fog Button and the button will present blue light to defog.
- Touch again to exit the defogging mode.

Daily Maintenance

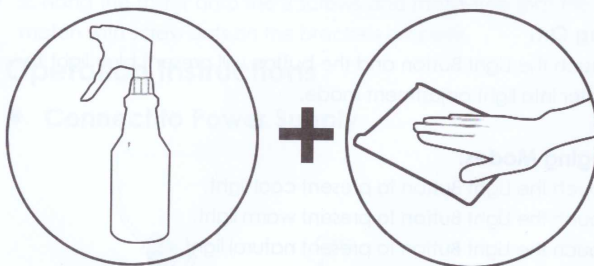

Clean the surface of the product with a piece of cloth and specialized mirror cleaner at regular intervals.

For more information about our products, please visit:
www.aquaterior.com