

To deodorize the leather  
Leave your chair in the  
shade for 1-2 days.

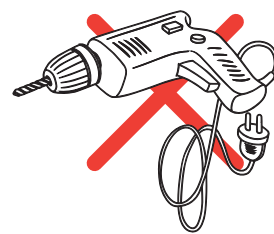

### For longer use

Re-tighten bolts every 6 months by using  
the enclosed allen-key.  
\*Using an electric drill can damage the chair.  
Please re-tighten bolts manually.

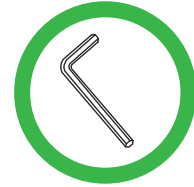

## • Cautions



This product is for  
one person only.



DO NOT use the chair unless  
all bolts, screws, and knobs  
are fully tightened.



DO NOT use the chair if  
any of the parts is  
missing or damaged.



DO NOT stand on the chair to  
use as a step stool or ladder.

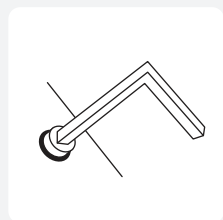

Regularly check if all  
bolts, screws, and knobs  
are fully tightened.

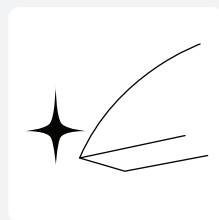

Please be careful.  
Some of the parts are  
sharp and heavy.

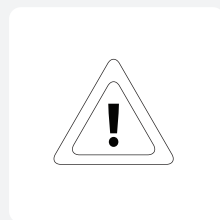

Failure to follow these warnings  
and instructions could  
result in serious injury.

## Enjoy your new favorite chair

Our goal is to create a perfect customer experience.  
Let us know if you have any feedback.  
Your comment motivates us to become a better team.

# OFFICE CHAIR

## ASSEMBLY INSTRUCTION

### Contents

- Instructions
- Cautions

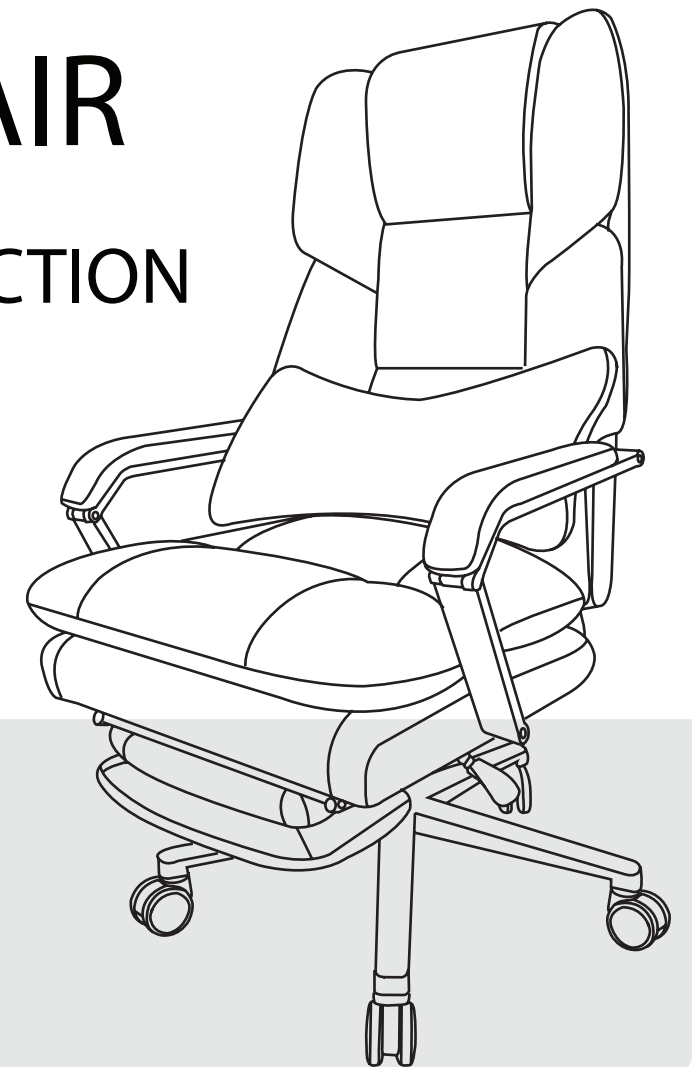

Please make sure all the parts are included.



Ax5

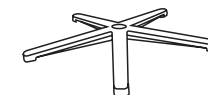

Bx1

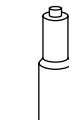

Cx1

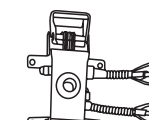

Dx1



Ex1



Fx2



Gx1



Hx1



Jx1



Kx1

- |  |     |
|--|-----|
|  | Lx4 |
|  | Mx8 |
|  | Nx3 |
|  | Ox4 |
|  | Px2 |
|  | Qx2 |
|  | Rx2 |
|  | Sx4 |

Read the instructions carefully.



Follow the assembly steps.

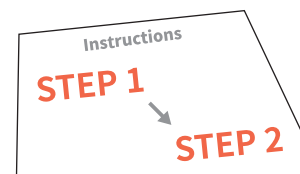

• Instructions

✖ NOTICE

Please use the allen key included instead of an electric drill.

TIPS!

Use the box for an easier assembly.

We recommend two people for the assembly process.

STEP 1

STEP 2

STEP 3

STEP 4

STEP 5

STEP 6

STEP 7

STEP 8