

Electric Standing Desk

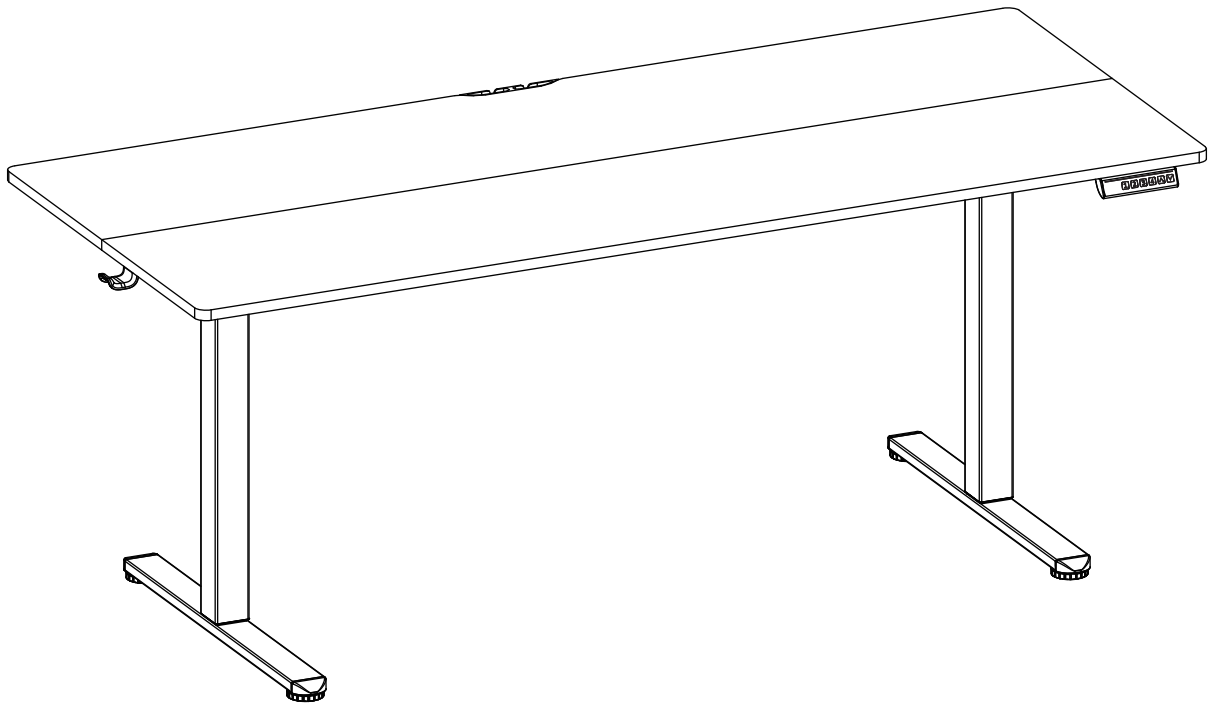

Specifications



Height Adjustment Range
28.3–46.5" (72–118cm)



Power Input
100V–240V



Max. Speed
20mm/s

Tools Needed (Not Included)

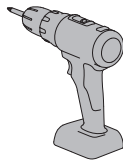

Drill

OR



Phillips Screwdriver

Step 1

Supplied Parts and Hardware

A x 12



Bolt
M6 x 11mm

B x 8

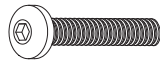

Bolt
M6 x 35mm

C x 4



Bolt
M8 x 12mm

I x 1



Allen Key
3/16" (5mm)

01 x 1

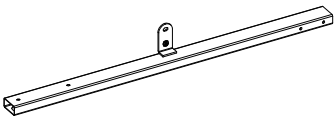

Crossbar

02 x 1

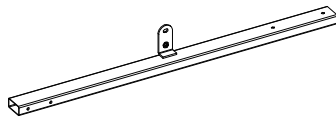

Crossbar

03 x 1

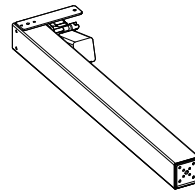

Leg with Motor

04 x 1

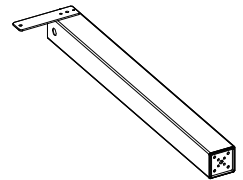

Leg

05 x 2

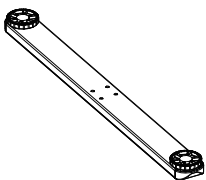

Leg Base

06 x 2

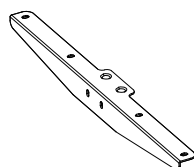

Side Plate

07 x 1

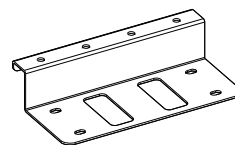

Crossbar Connector

Step 2 **Supplied Parts and Hardware**

H x 1



Allen Key
5/64" (2mm)

08 x 1



Transmission Rod

Step 3 **Supplied Parts and Hardware**

E x 4



Cam Bolt

F x 4



Cam Lock

G x 4

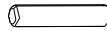

Wood Dowel Pin

09 x 1

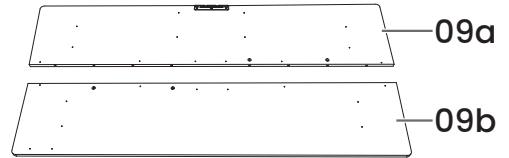

Desktop

Step 4 **Supplied Parts and Hardware**

D x 26

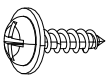

Screw
M5 x 15mm

J x 2

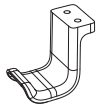

Storage Hook

10 x 1

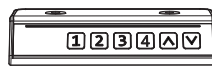

Controller

11 x 1

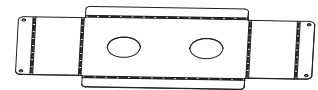

Cable
Management Tray

Step 5

Supplied Parts and Hardware

K x 6



Cable Clip

12 x 1



Power Cable

Not all hardware included in this package will be used.

Contact Us

If you receive parts that are damaged, defective, or are missing parts, please contact us.

 support@bsqworld.com

Step 1 Assembling the Frame



Important: Note the position of the mounting tabs.

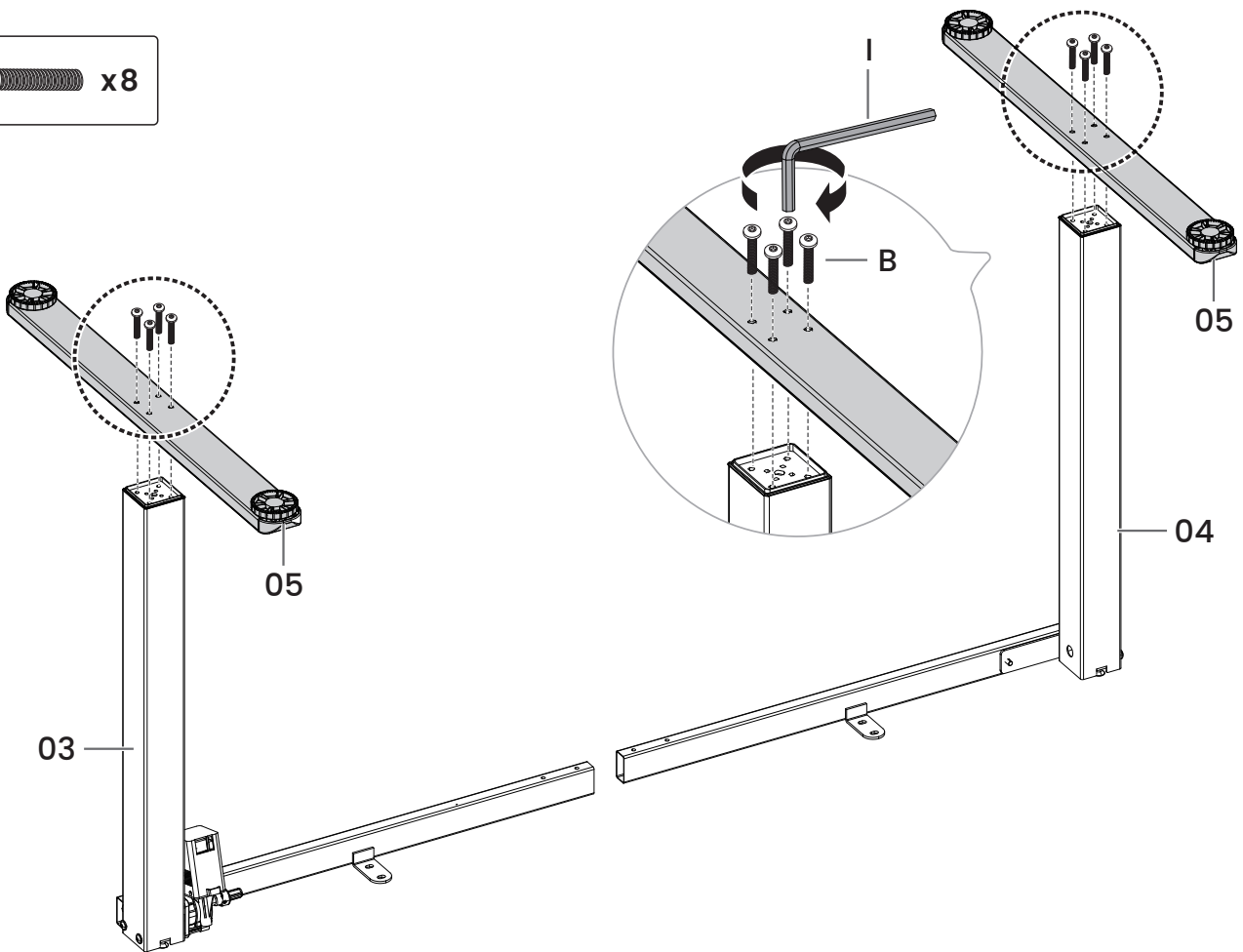
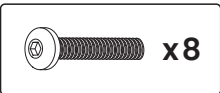
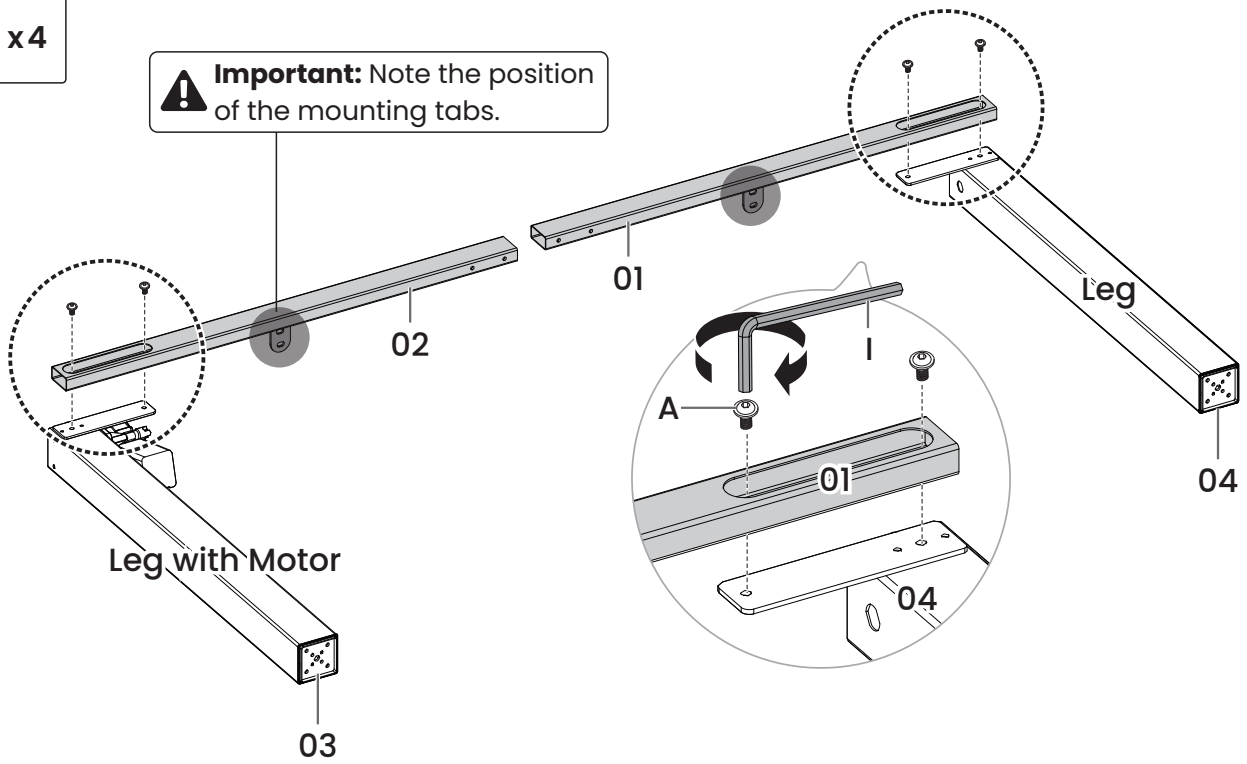

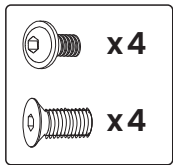

Note: Tighten the bolts on the top first, then tighten the remaining bolts.

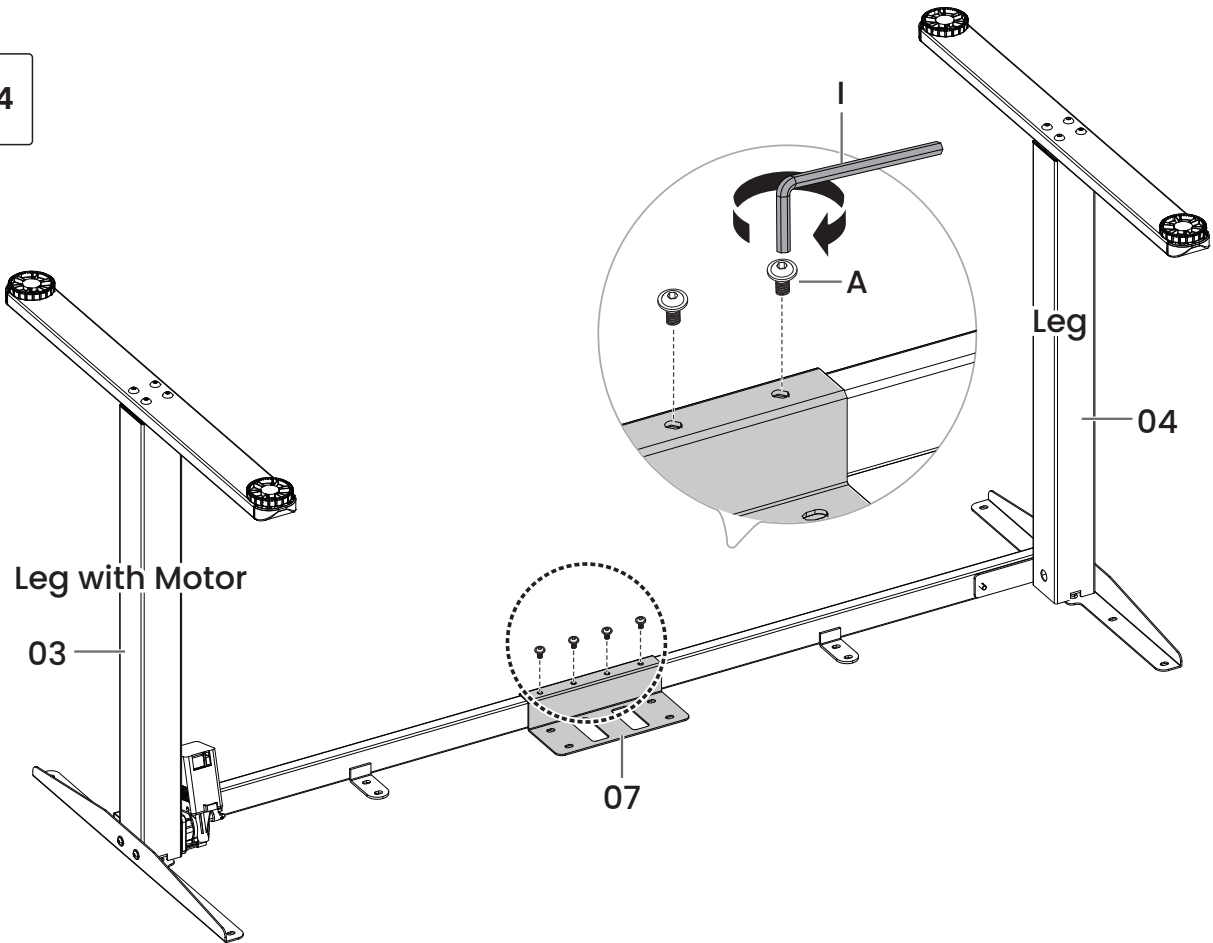
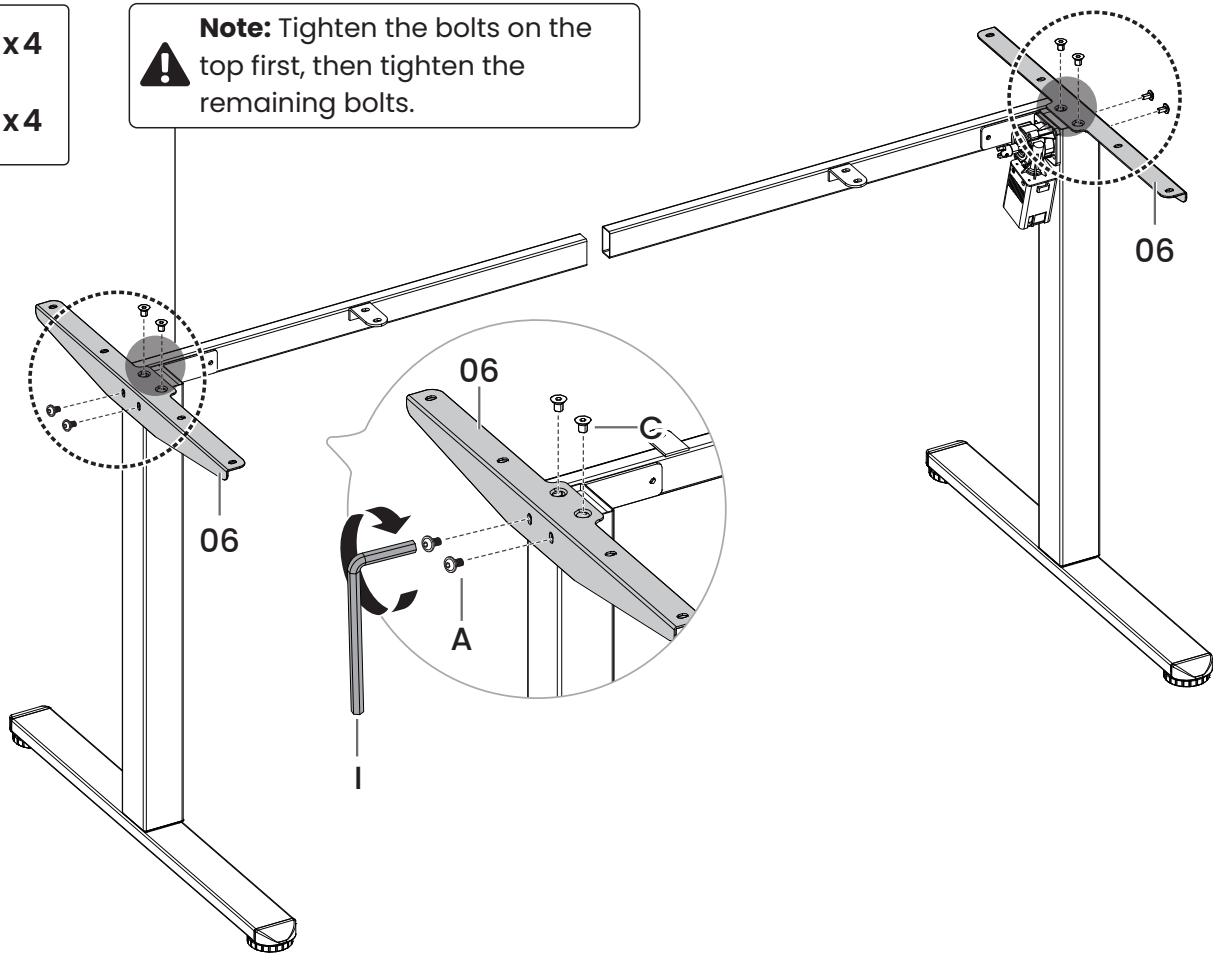

Step 2 Attaching the Transmission Rod

Loosen the coupling nut to adjust the rod length.

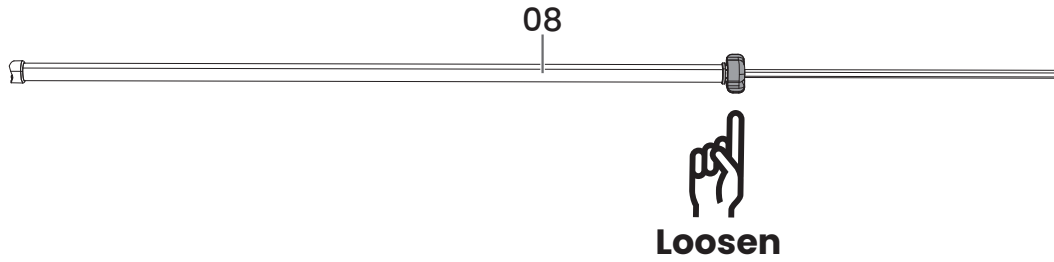

Fully insert the transmission rod into the leg.

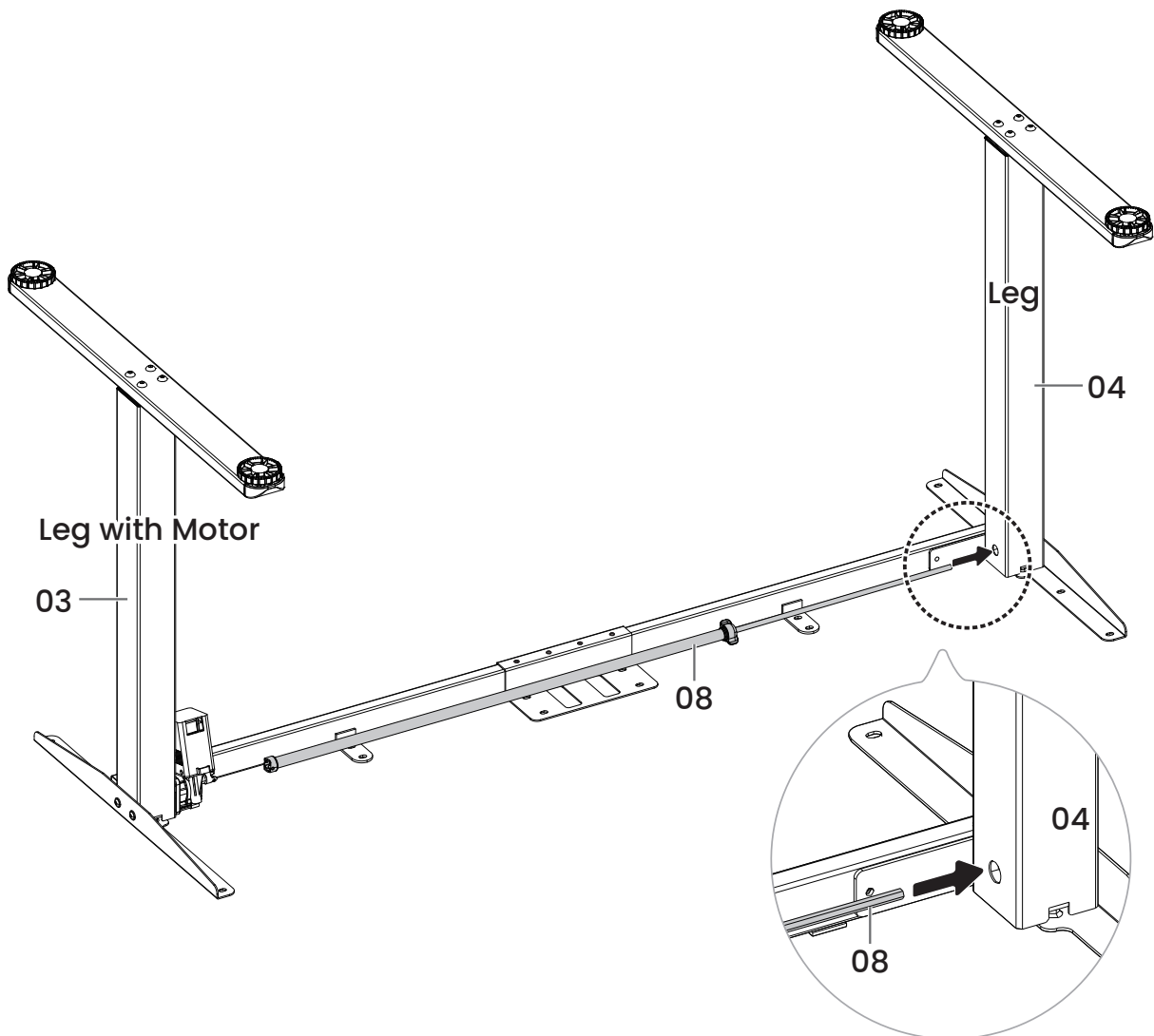

Adjust uneven desk legs if needed:

Measure the height of each leg to see if they are set at the same level. If not, turn the rod to raise or lower the leg until it's level with the leg with motor.

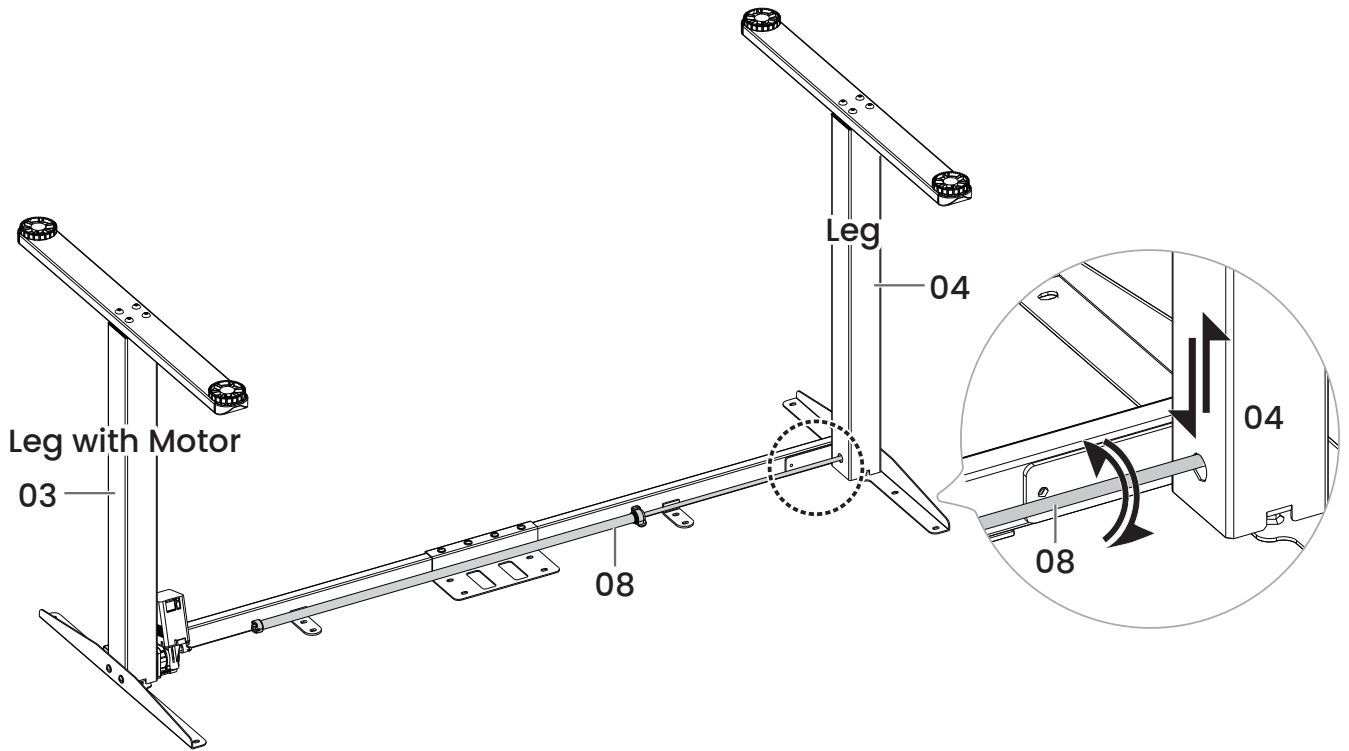

Connect the rod's other end to the motor drive shaft on the leg with motor, then tighten the set screw to secure.

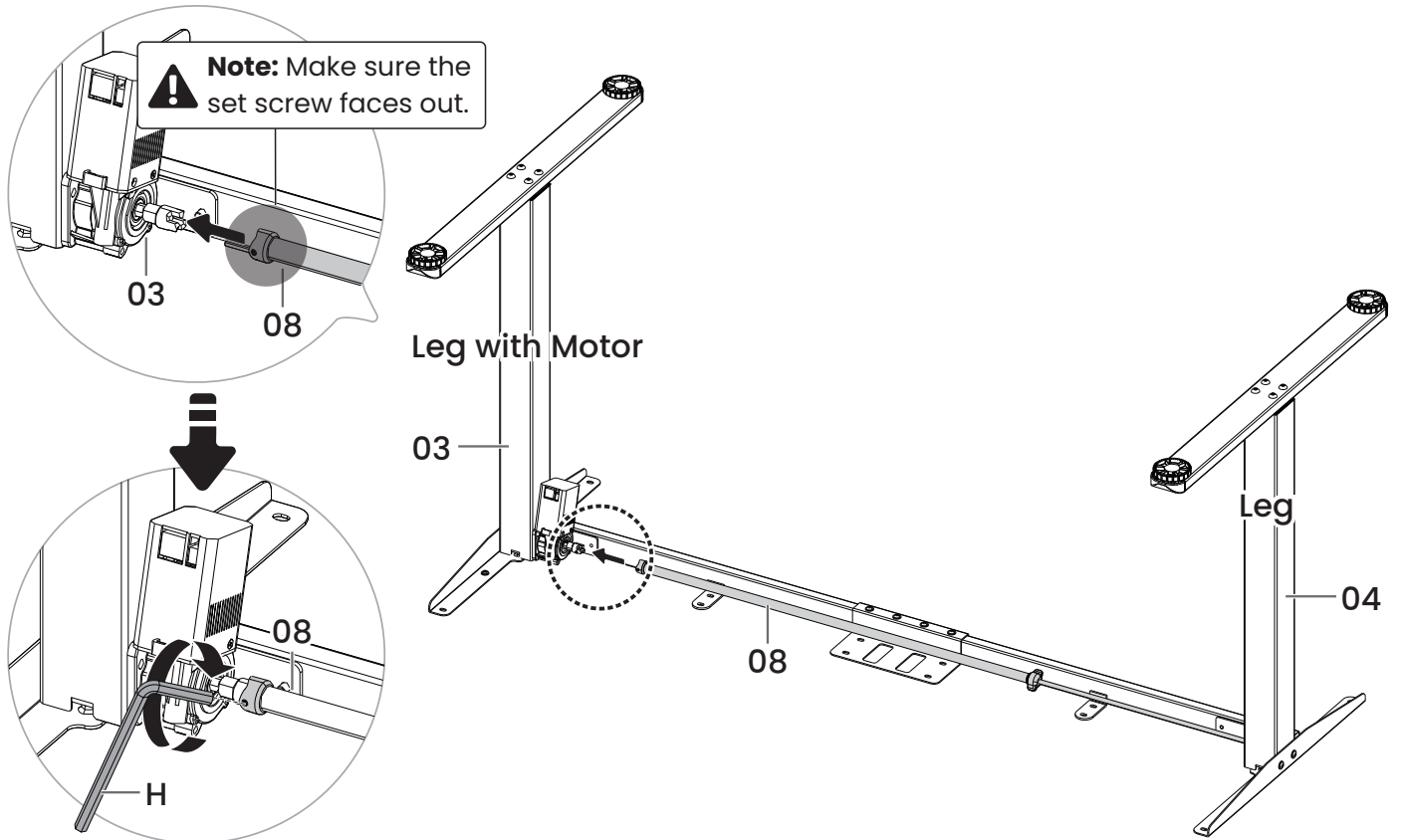

Tighten the coupling nut.

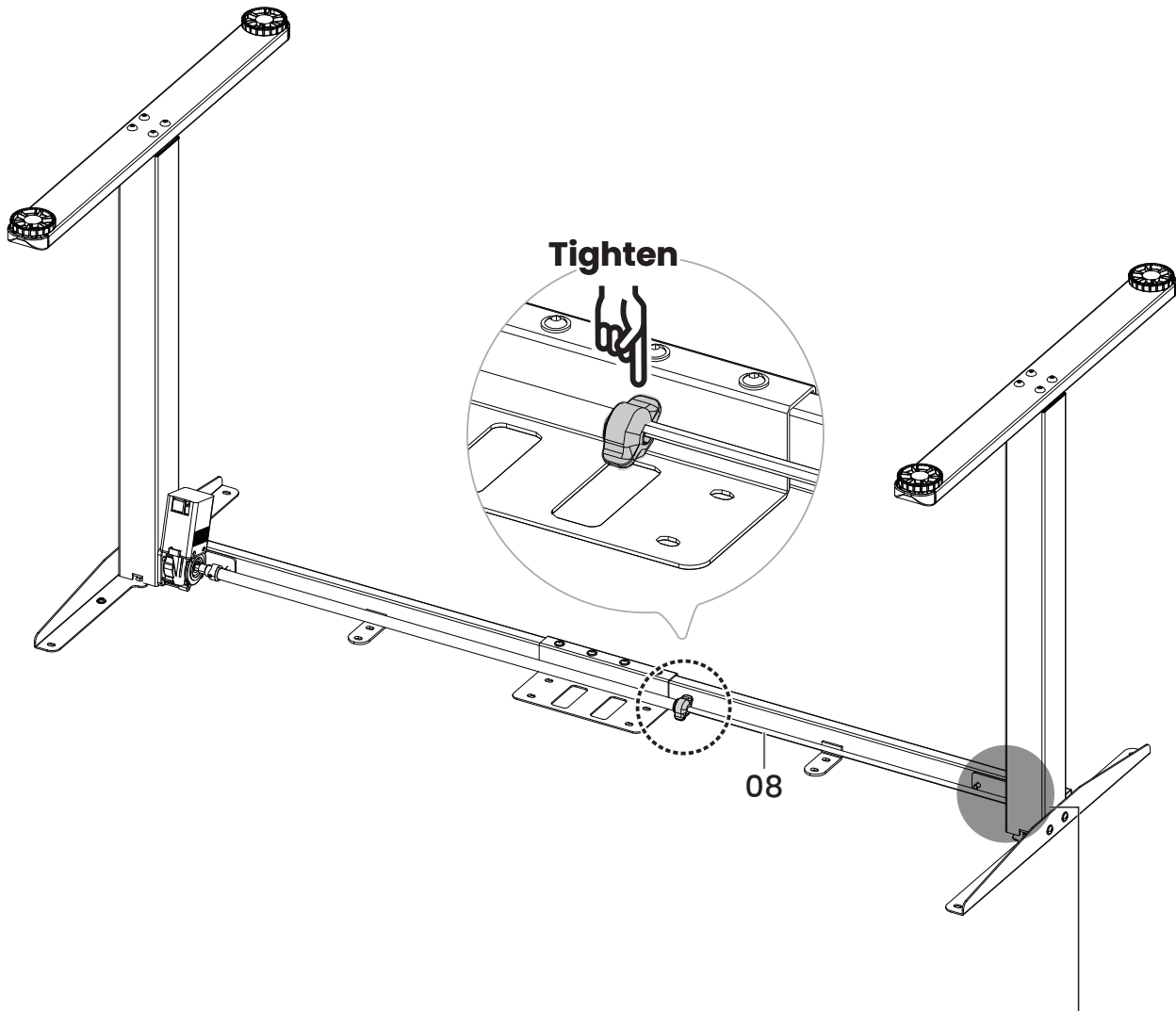



Note: Before tightening the coupling nut, ensure the rod end is fully inserted into the leg.

Step 3

Assembling the Desktop

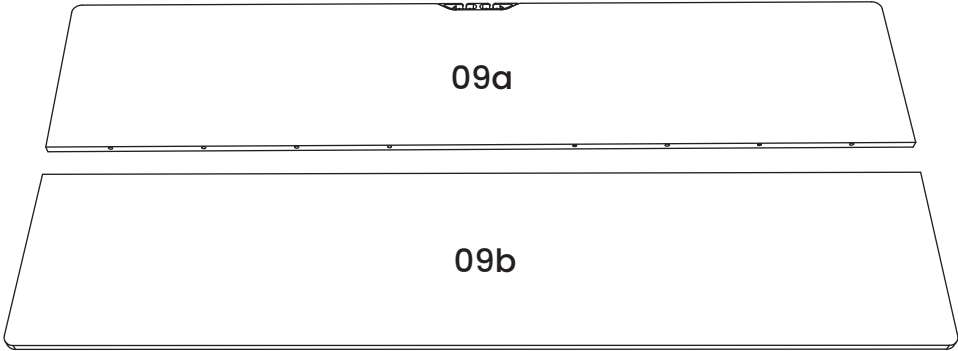
Top



 **Tip:** The dots below indicate pre-drilled hole locations.

Bottom

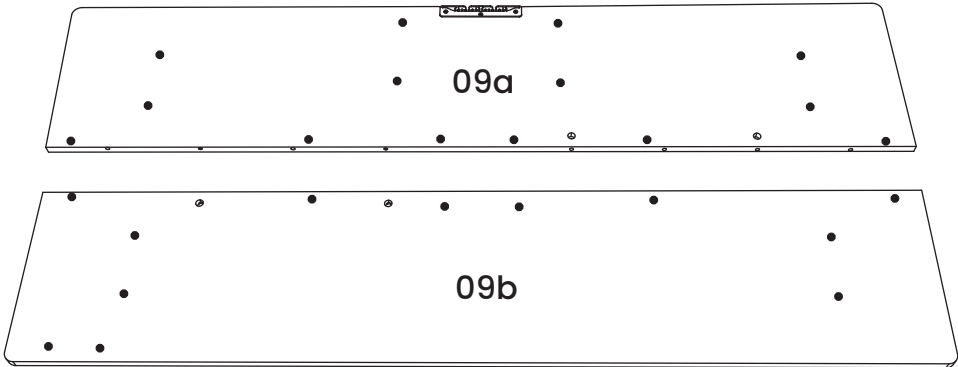

 **Tip:** Start to thread the bolts in by hand before using a tool to tighten.

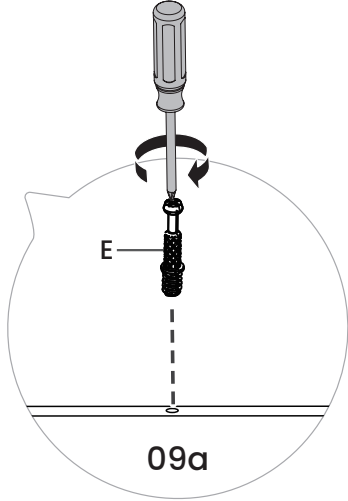
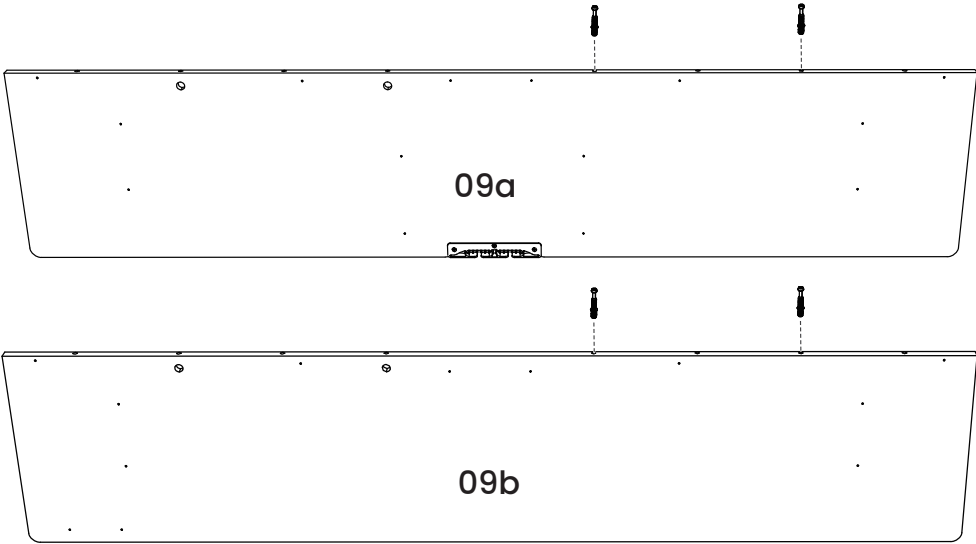
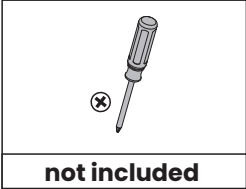

Assemble the desktop with the bottom of the panels facing up.

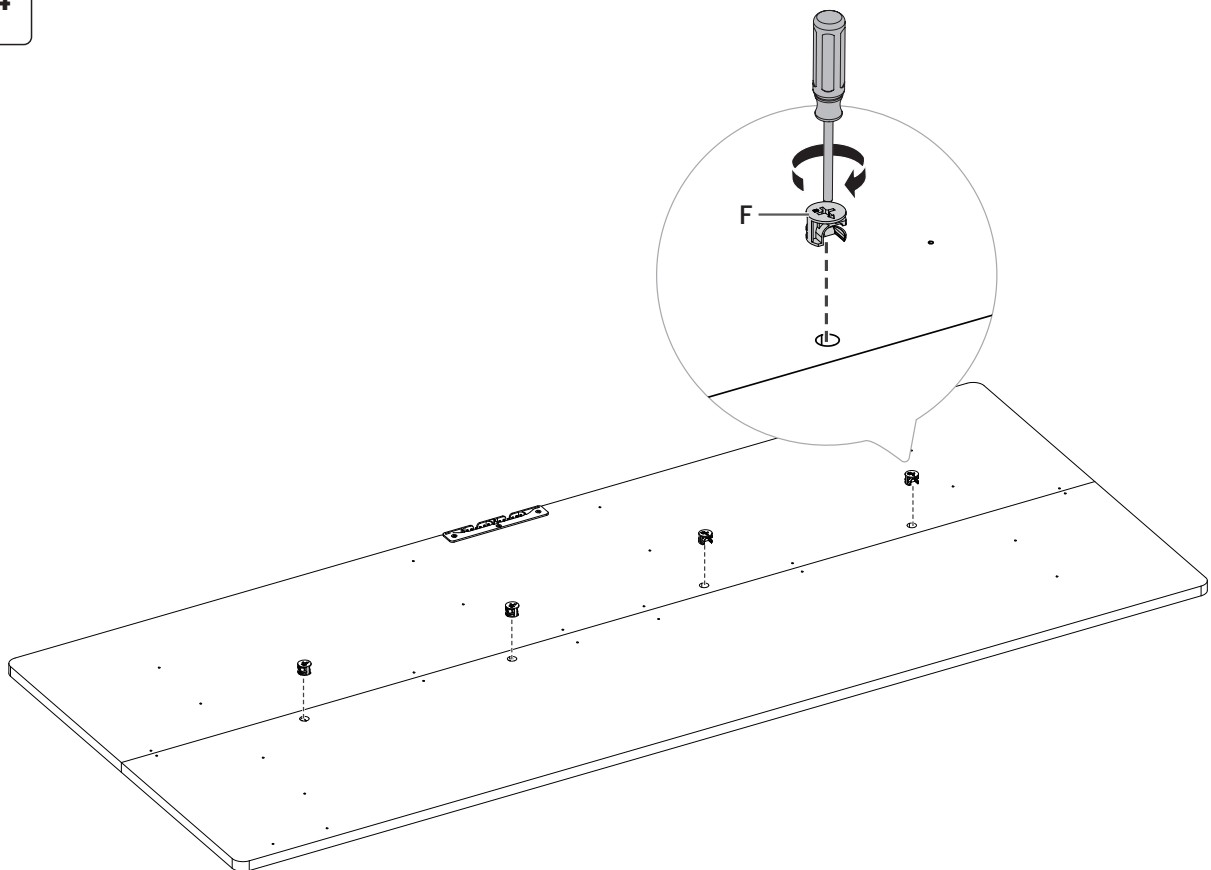
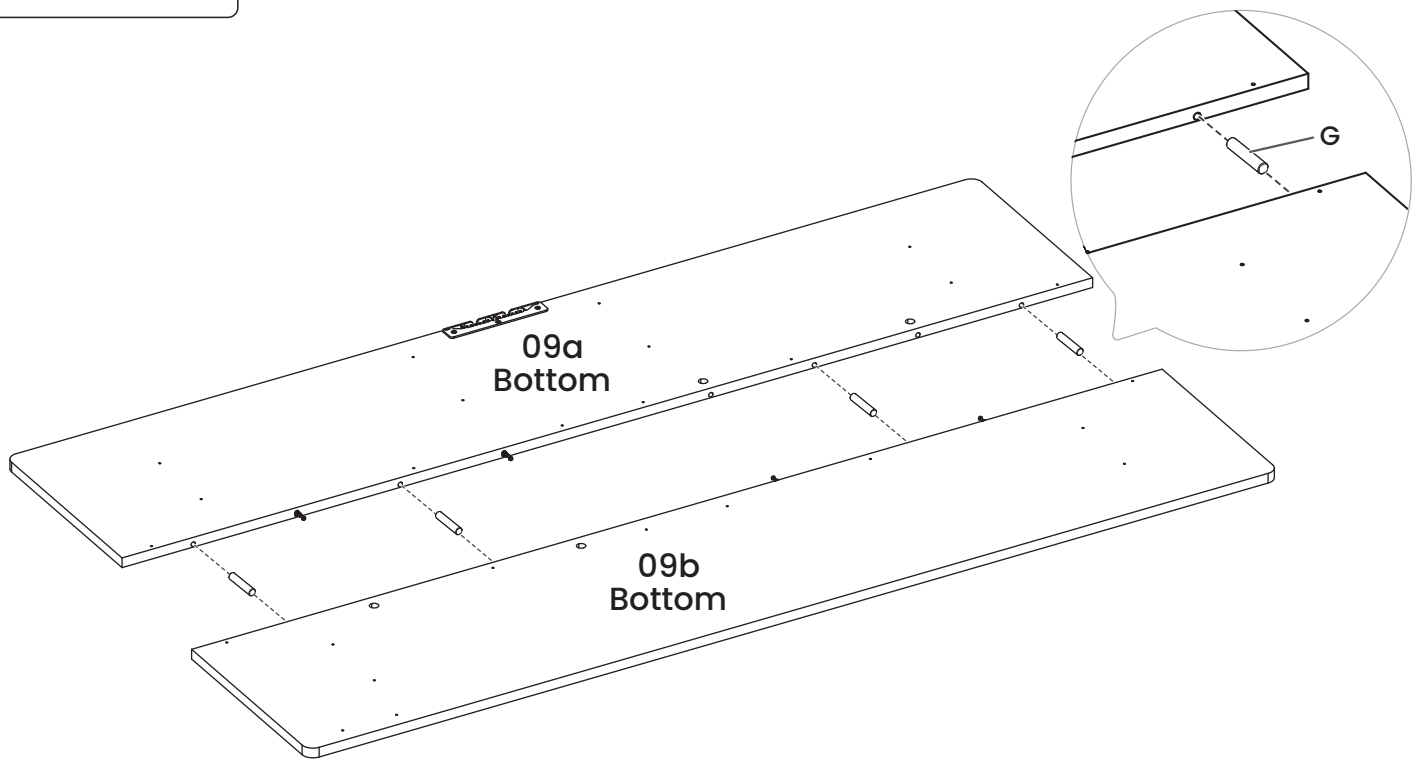
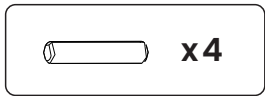

Step 4 Attaching the Desktop and Other Parts

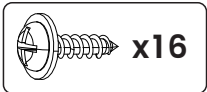

You may need assistance with this step.

Drill with suitable torque and speed **OR** 
not included

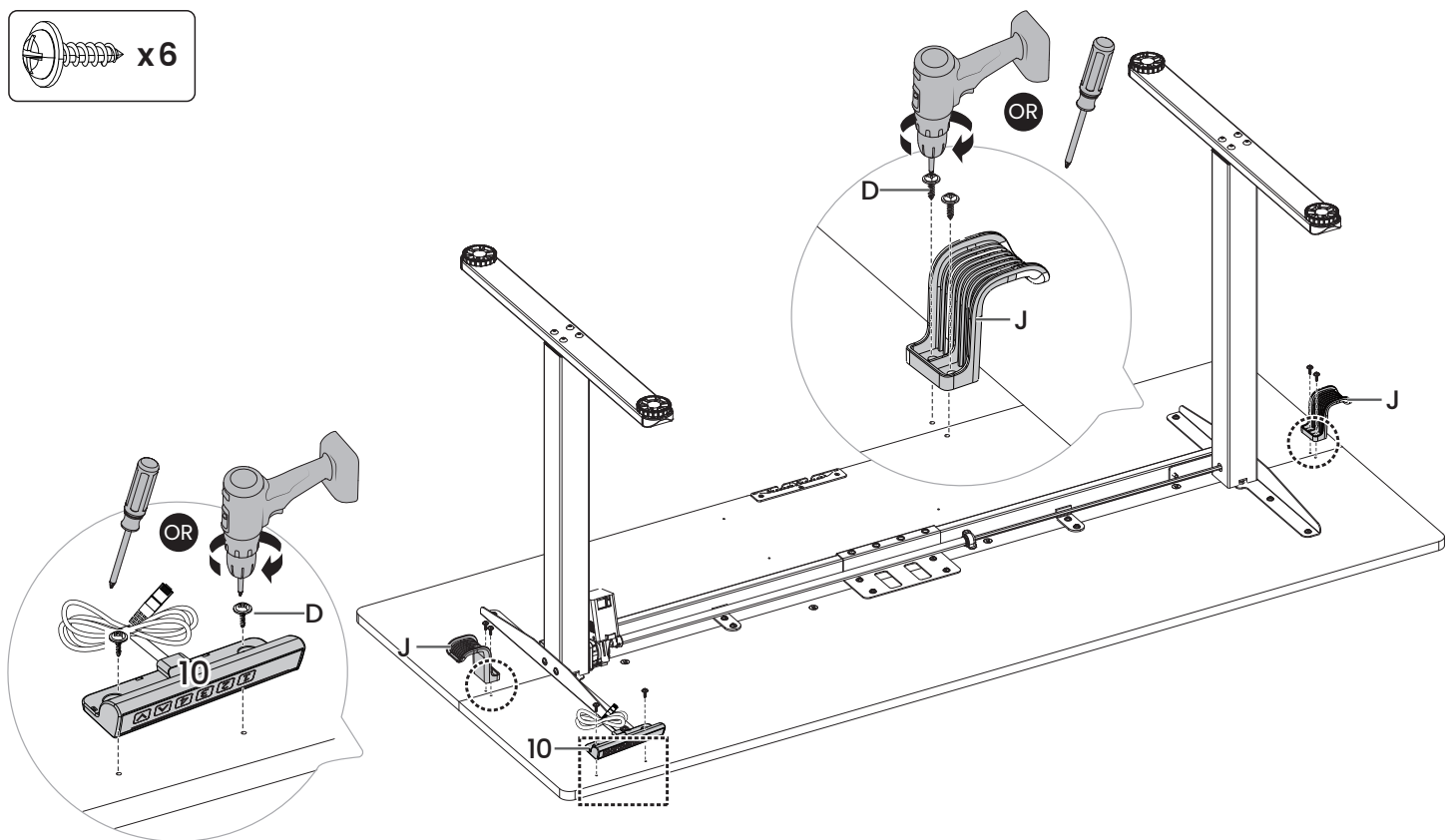
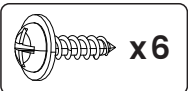
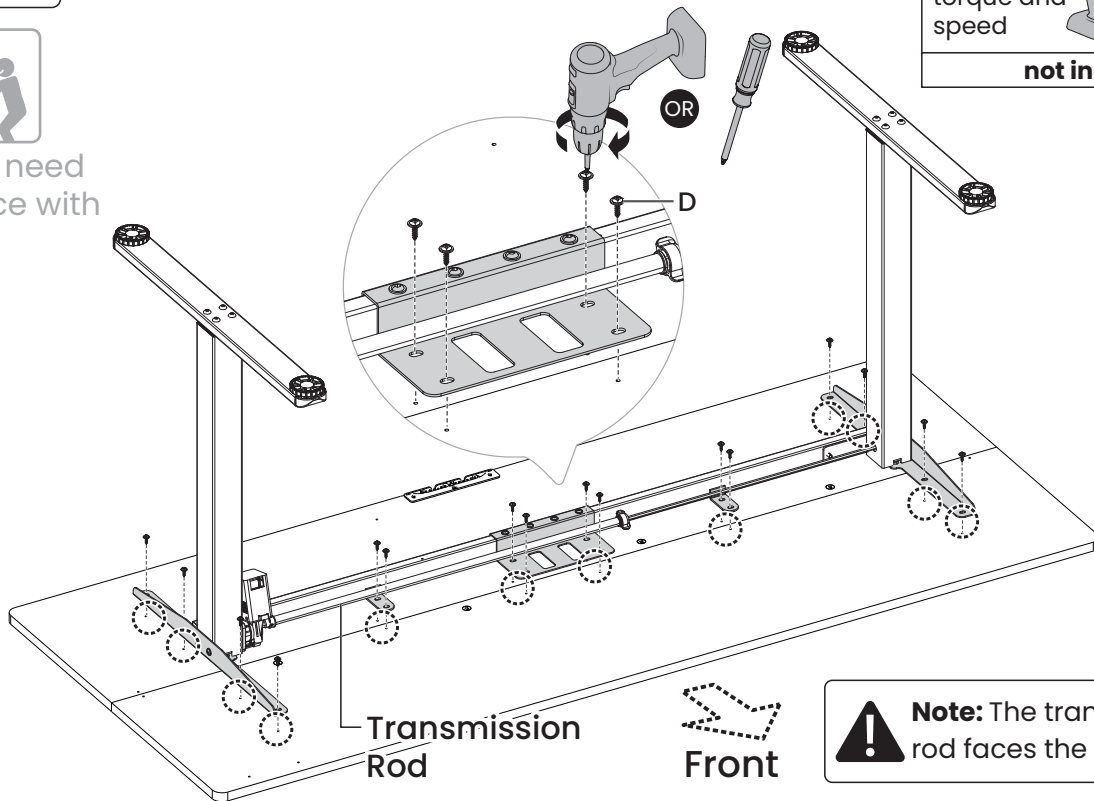

Fold the cable management tray into shape.

 **Note:** Be careful not to cut your fingers.

01

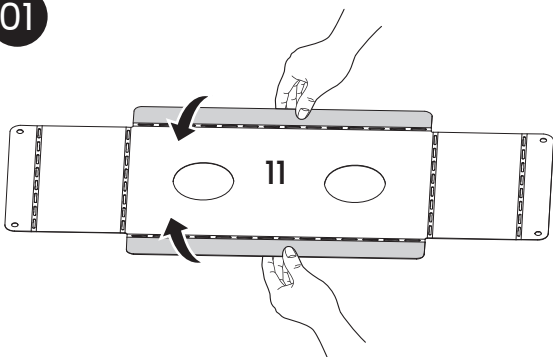

02

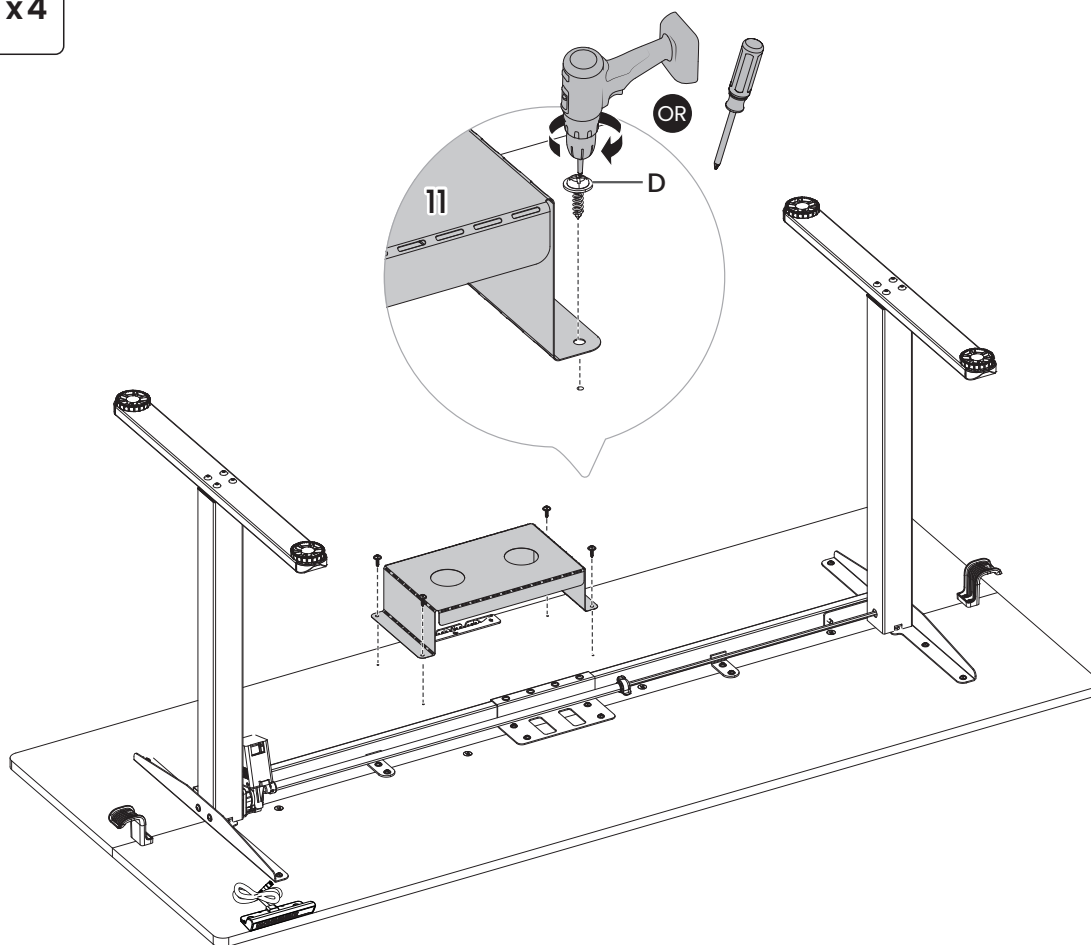
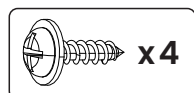
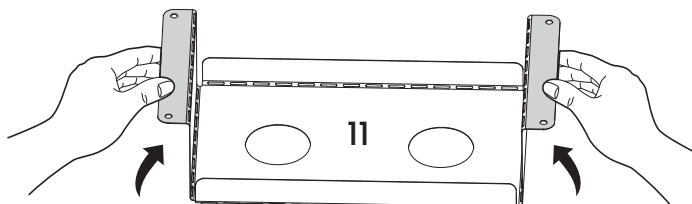

Step 5 Connecting the Cables



Tip: An example of a cable clip layout is indicated below. However, the cable clips can be arranged according to your needs.

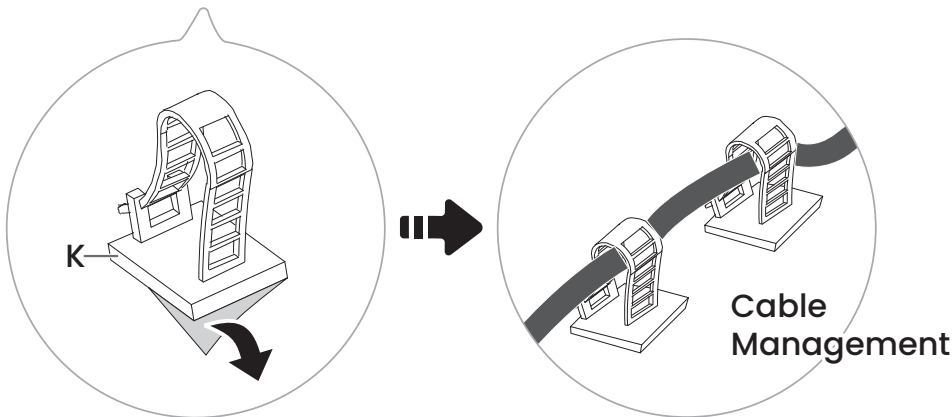
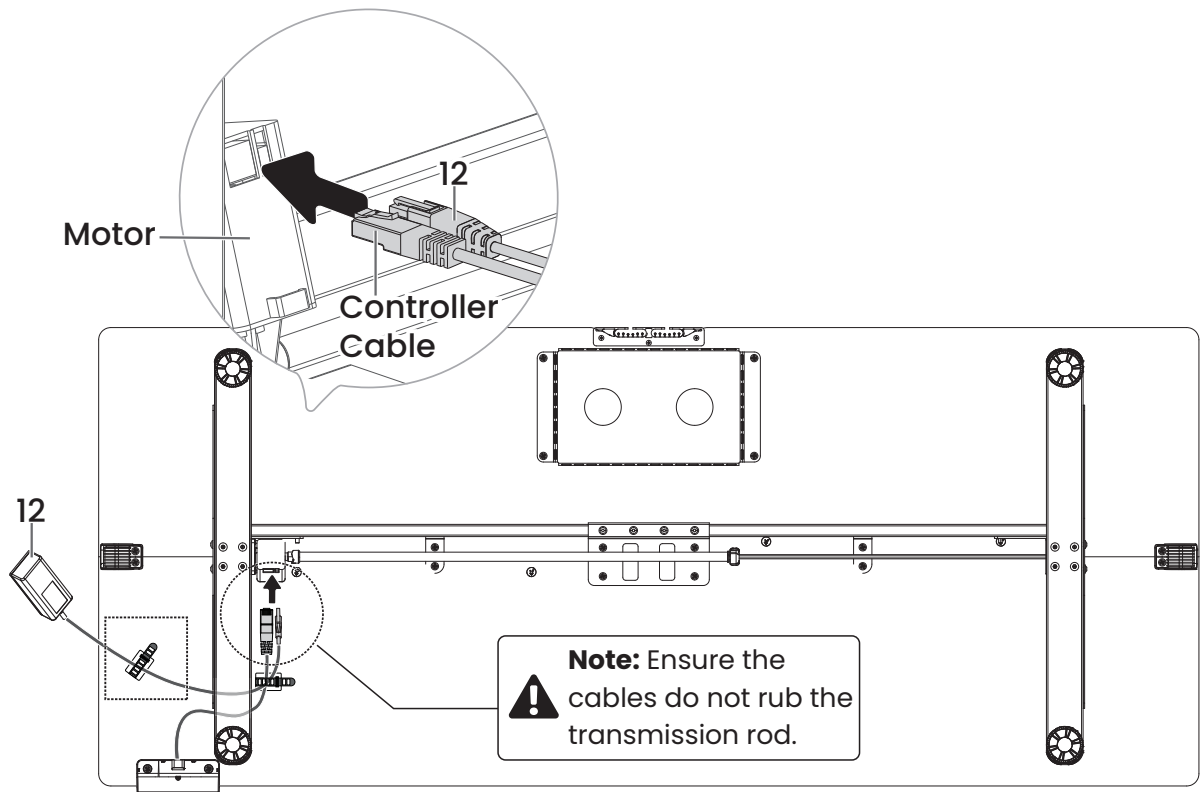

When flipping the desk over, make sure the controller does not hit the ground, which could cause damage.

Using the Controller

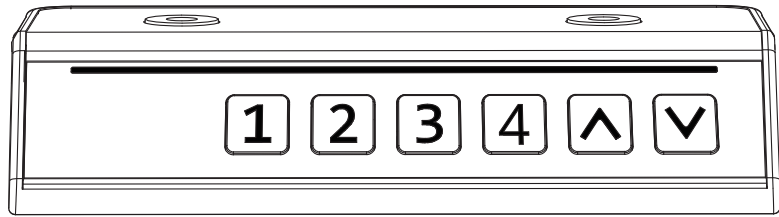
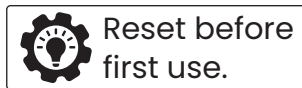

Note: Ensure that there are no obstacles when using the desk, that the desktop is not too close to the wall, and that all cables are long enough for the desk to move up and down freely. When the controller screen is off (power-saving mode), press any button to wake it before operation.

Raise Desk (Max height: 46.5"/118cm)

Lower Desk (Min height: 28.3"/72cm)

• Save Current Height Setting

Four heights can be saved. Press and hold the **1**, **2**, **3**, or **4** button for 5 seconds until 'H1,' 'H2,' 'H3,' or 'H4' is displayed. The current height will be saved to that button.

• Select Height Setting

Press the **1** / **2** / **3** / **4** button. The desk will move to the height that was previously set for that button.

Settings

Reset

'RES' displays as on the screen.

1. Press and hold the button until the desk goes down to its lowest level, then release the button.
2. Press and hold the button for 5 seconds, and the screen will display 'RES.' Continue holding until the desk comes back up slightly. Reset is complete.

Protection Mode Error Codes

Hot	Overheating Protection: When the motor has been working continuously for 5 minutes, it will stop operating to prevent damage from overheating. Wait for at least 15 minutes before making any further height adjustment.
E02	Operation Status Warning: The desk stops moving if vibration, impact, or incline are detected. If this detection is incorrect, follow the reset instructions before continuing use.
E10	Sensor Malfunction Warning: Motor safety sensor cannot be detected. Power off, disconnect the cables, reconnect the cables, then power back on and perform a reset.
E20	Overload Warning: Max load exceeded. If raising the desk, remove all items from the desk and try again. If lowering the desk, power off, remove all items from the desk, power back on, then try again. If error code persists, follow the reset instructions.
E31	Undervoltage Protection: Input voltage too low. If the correct AC adapter is being used, power off, disconnect the cables, reconnect the cables, then power back on and perform a reset.
E32	Overvoltage Protection: Input voltage too high. If the correct AC adapter is being used, power off, disconnect the cables, reconnect the cables, then power back on and perform a reset.
	Cable Disconnection Warning: Ensure all cables are properly connected and the controller is plugged in before use.