

# Instructions for the use of LED Moon Light

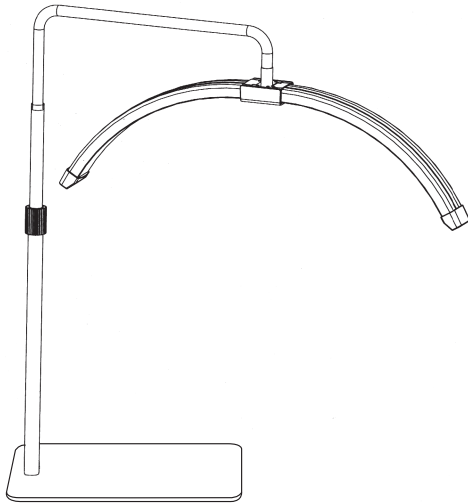

## 1. Technical

Input power	110V/240V 50Hz/60Hz
Output power	40W (20V 2.5A)
Adjustment range	10 levels for each mode
CCT	3200K~5600K
CRI	RA>90
Lumen	3300LM
Size	535*240*100mm
Weight	4kg

## 2. Detail

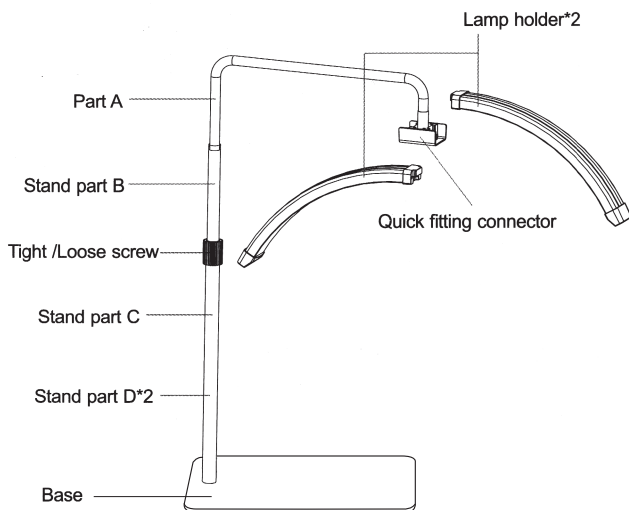

## 3. Assembly instructions

3.2 Connect base, stand part C and stand part D\*2.

- ① Rotate stand part D to connect with base.
- ② Rotate stand part C to connect with stand part D (2pcs iron pipe ).

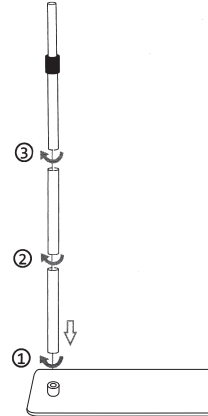

3.4 Connect the stand and lamp. Connect power cable and DC cable

- ① Release the tight/loose screw and take out stand part B from part C. then rotate stand part B to connect it with part A, and then tighten the tight /loose screw.
- ② Mount two lamp holder to quick fitting connector.
- ③ Connect power cable with DC cable port, and rotate it to fix.

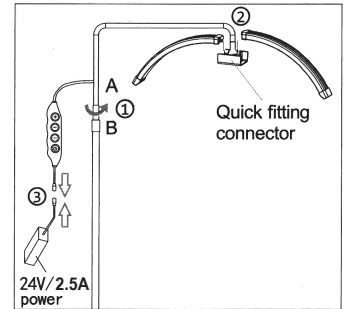

- Note: Please set the lamp and base on same direction for safe use.

## 4. Controller

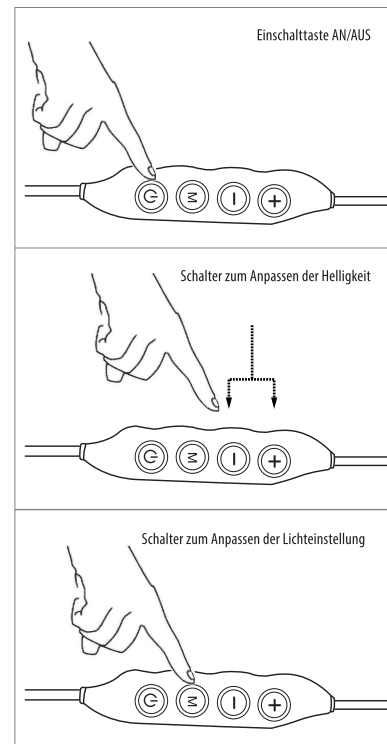

## 5. Cautions:

1. Please read the manual carefully and install the lighting according to the instruction sheet before using.
2. Please fix the lighting on the bracket.
3. The lighting shall be used within the normal voltage.
4. Don't pull the cable to turn off the power and don't touch the plug with wet hand.
5. The ring lighting shall be kept in a dry and ventilated place.
6. When stop using please cut off the power to avoid the short circuit.