

# ASSEMBLY INSTRUCTIONS

---

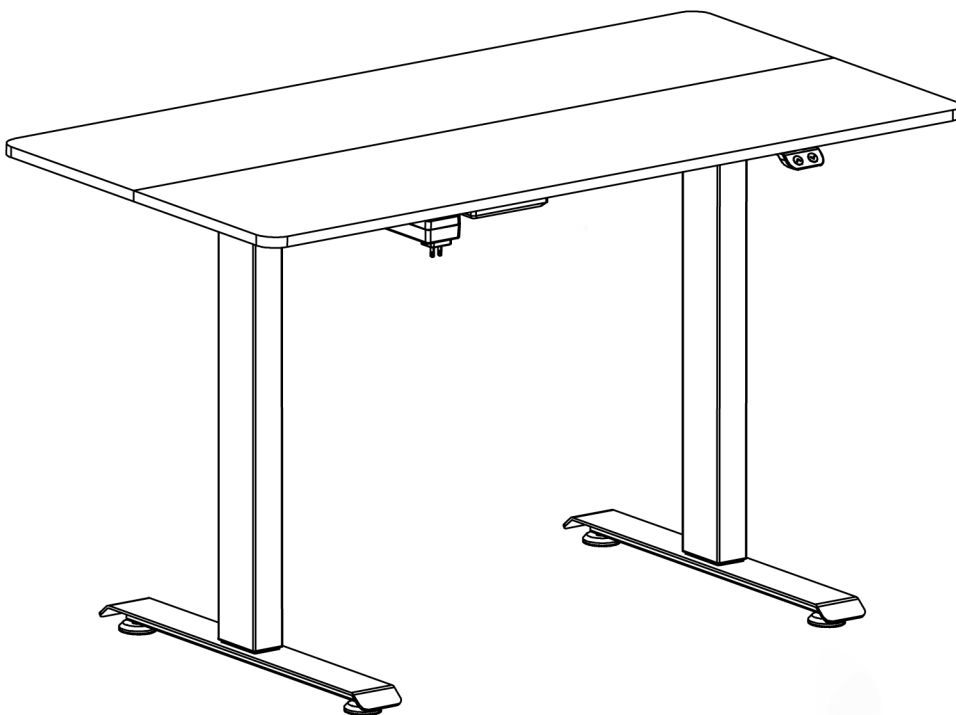

## TOOLS REQUIRED

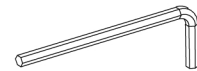

Allen Wrench M5  
(Included)

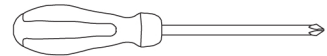

Screwdriver  
(Not Included)

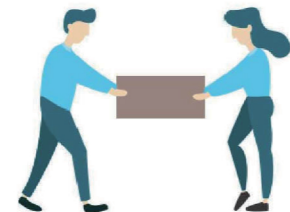

**2 - People  
Recommended**

## ASSEMBLY RATING



EASY —————> DIFFICULT

The Assembly Rating is a 5-point system showing the level of effort needed to assemble a specific product.



## **CHECK BEFORE STARTING**

☐

### **Are you missing anything?**

Double-check all parts, hardware and accessories listed on Page 6 are accounted for.

☐

### **Should we send any replacements?**

Are there any irregularities or flaws in the parts? We can send replacements!

☐

### **Check out our Quick Tips!**

We recommend reviewing the pre-assembly handouts. Even experts need a refresher now and then!

☐

### **Prep Time!**

Please review the assembly instructions and all diagrams prior to assembling. Position parts in order and group identical hardware together for an easier assembly experience.

# PRE ASSEMBLY INTRODUCTION

We understand building ready-to-assemble furniture can be a challenging experience for some. To help avoid confusion, we have provided some helpful tips that may speed up the process.



## Teamwork

ALWAYS have at least two people to help with transporting and assembling the product to avoid potential injury and/or damage.

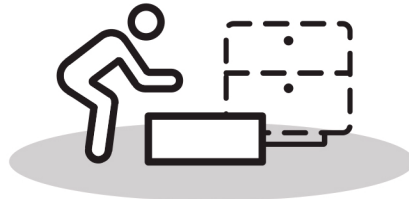

## Suitable Location

Assembling near the area of the intended location is highly recommended.



## Sufficient Space

Make sure you have enough space to move around during the assembly.



## Avoid Scratches

Use cardboard, blankets or a carpeted area while assembling furniture to prevent scratches.



## Flat Surface

Make sure the furniture rests on a flat and level surface with each leg evenly touching the floor.

# ASSEMBLY AND CARE ADVICE



**FAILURE TO FOLLOW THE GUIDELINES BELOW MAY  
RESULT IN INJURY AND/OR PROPERTY DAMAGE.**



Position each part correctly  
and insert screws or bolts into  
their respective holes.

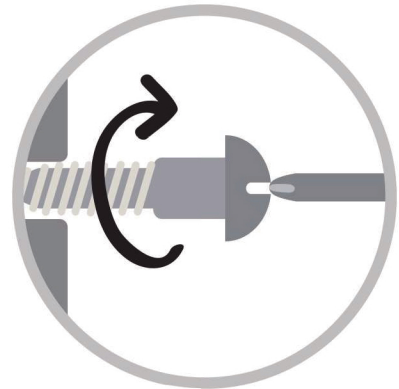

Turn clockwise to tighten and  
only tighten when step is  
completed or when instructed  
to do so.



Use the appropriate hand tools  
or power tools for assembly.  
Select steps, such as tightening  
screws and/or bolts, may require  
hand tools to avoid causing  
damage during assembly.



Save the instructions and store  
any supplied tools for later  
maintenance.

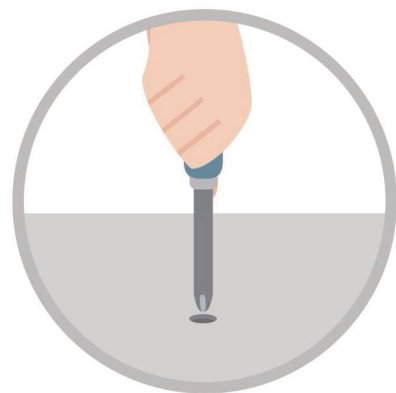

After two weeks, check and  
tighten any loose hardware and  
repeat again every six months  
thereafter.

**IT IS THE USER'S RESPONSIBILITY TO MAINTAIN THE FURNITURE. THE HARDWARE MAY LOOSEN OVER TIME AND MAY CAUSE THE FURNITURE TO BE WOBBLY AND UNABLE TO SUPPORT ITS INTENDED WEIGHT CAPACITY. THIS MAY LEAD TO COLLAPSE AND MAY CAUSE SERIOUS INJURY.**



# HEIGHT ADJUSTABLE DESK



- Please keep instructions for future reference.
- Check the quantity and irregularity of parts and hardware before you start.

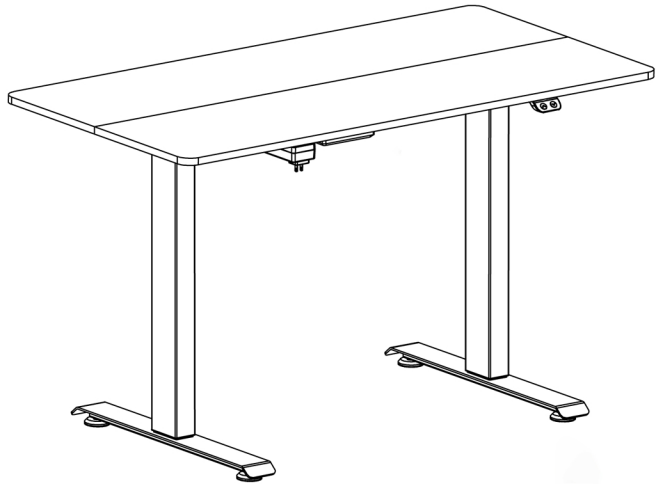

## PARTS

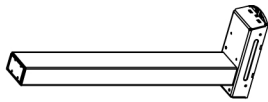

A-Column×2

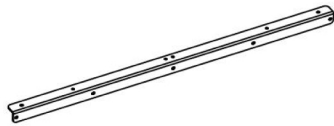

B-Long beam×1



C-Short beam×2



D-Strut ×2

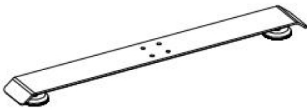

E-Foot×2

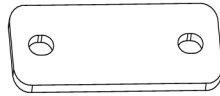

F-Connection board×4

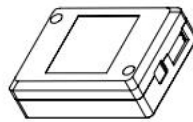

G-Control box×1

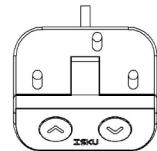

H-Handset×1

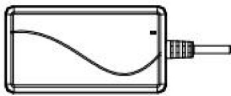

I-Adapter×1



J-Cable clip×6

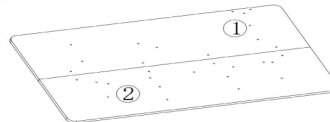

K-Table board 1/2

## PARTS



L-M4.8×19 screw×2



M-M6×15 screw×20



N-ST4×12 screw×3



O-ST4.8×15 screw×25



P-M5 Allen Key×1

# ASSEMBLY INSTRUCTIONS

## Step 1

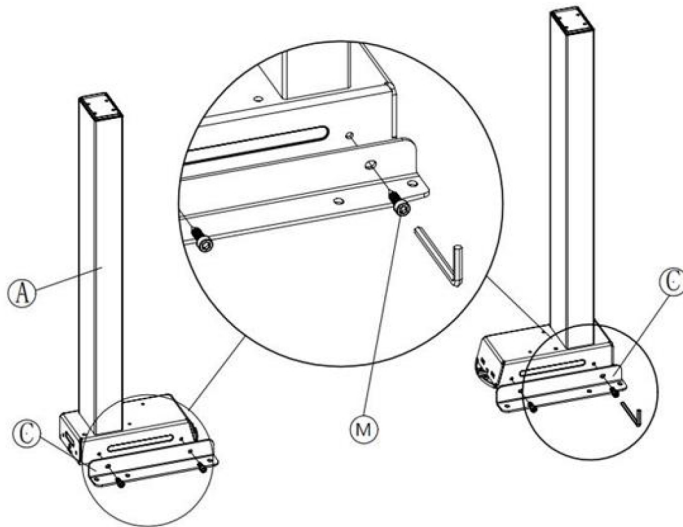

### Checklist

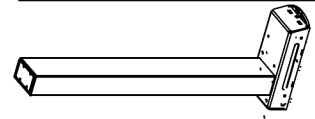

A- Column ×2



C-Short beam×2



M - M6×15 Screw ×4



P-M5

Align short beams (#C) to the columns (#A), then secure by using screws (#M).

## Step 2

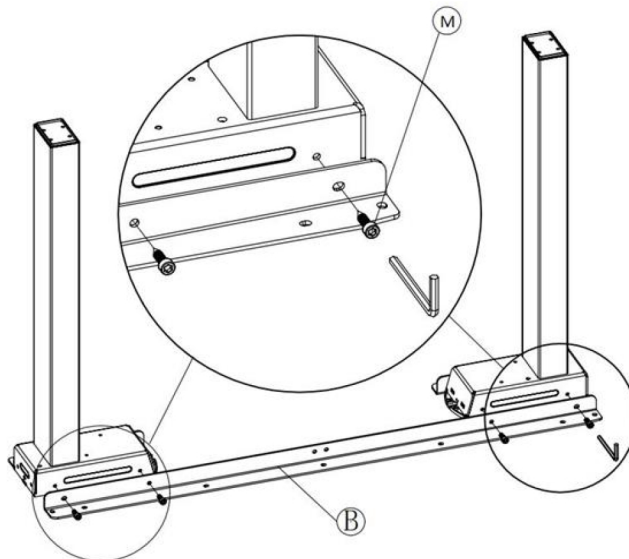

### Checklist

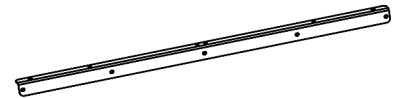

B- Long beam ×1



M - M6×15 Screw ×4



P-M5

Align long beam (#B) to the column (#A), then secure by using screws (#M).

## Step 3

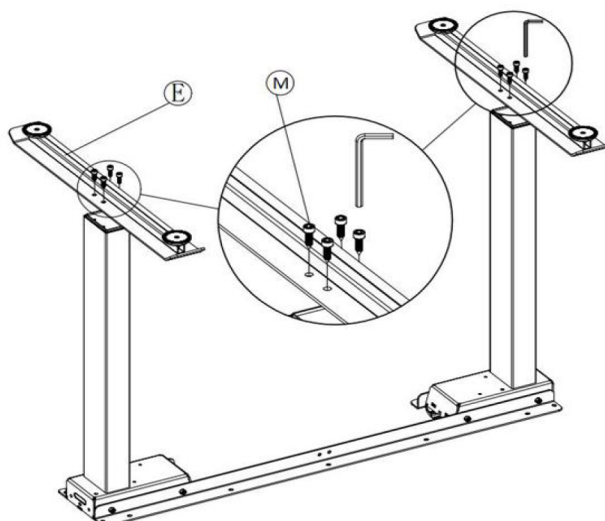

### Checklist

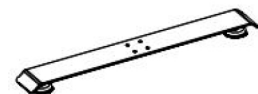

E - Foot ×2



M - M6×15 Screw ×8



P-M5

Align feet (#E) to the column (#A), then secure by using screws (#M).

## Step 4

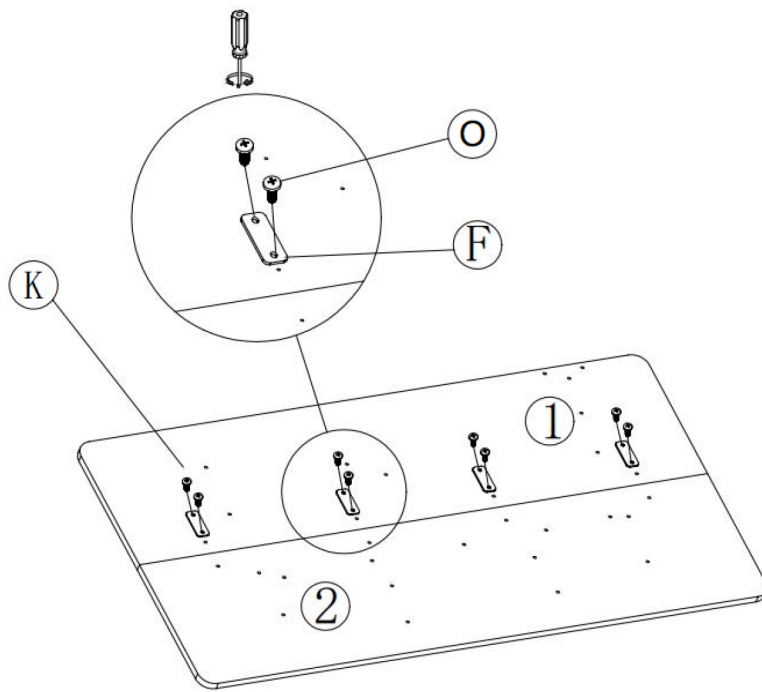

### Checklist

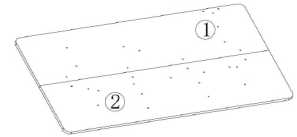

K- Table board 1/2



F - Connecting board x4



O - ST4.8x15 Screw x8

Align table boards (#K1/2) together, then align connecting boards (#F) to table boards (#K1/2). Secure by using screws (#O).

## Step 5

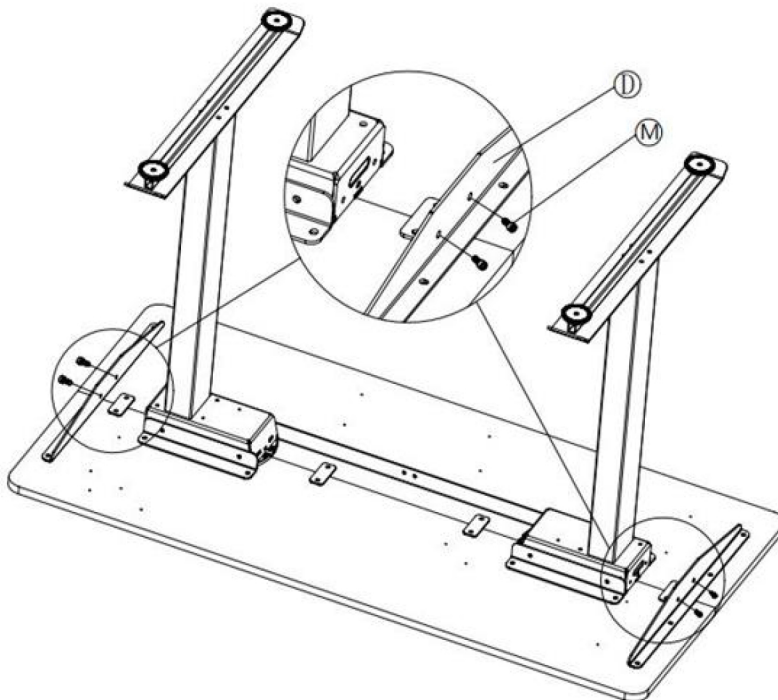

### Checklist



D - Strut x2



M - M6x15 Screw x4



P-M5

Align struts (#D) to the columns (#A), then secure by using screws (#M).

## Step 6

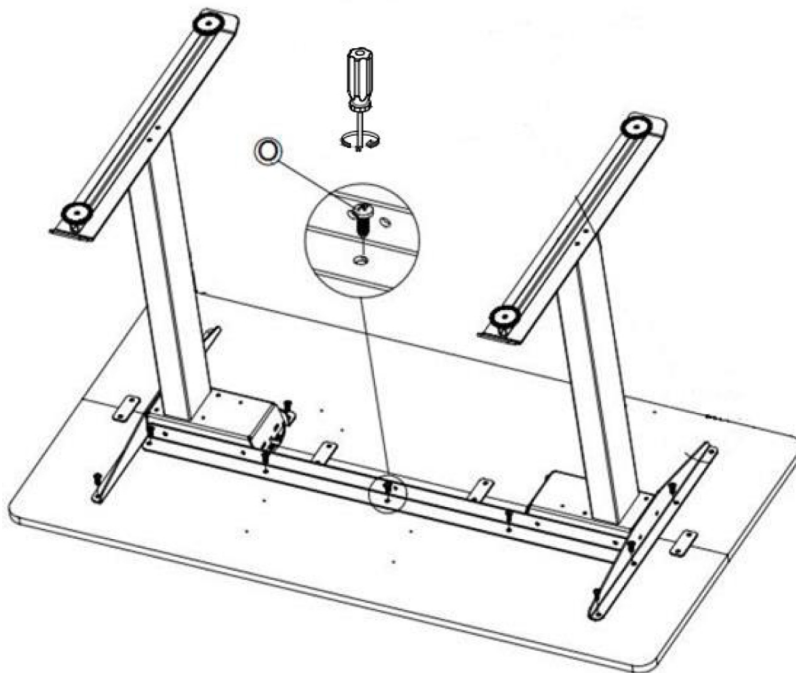

Secure struts (#D) and long beam (#B) to the table board (#K) by using screws (#O).

## Checklist



O- ST4.8×15 Screw x17

## Step 7

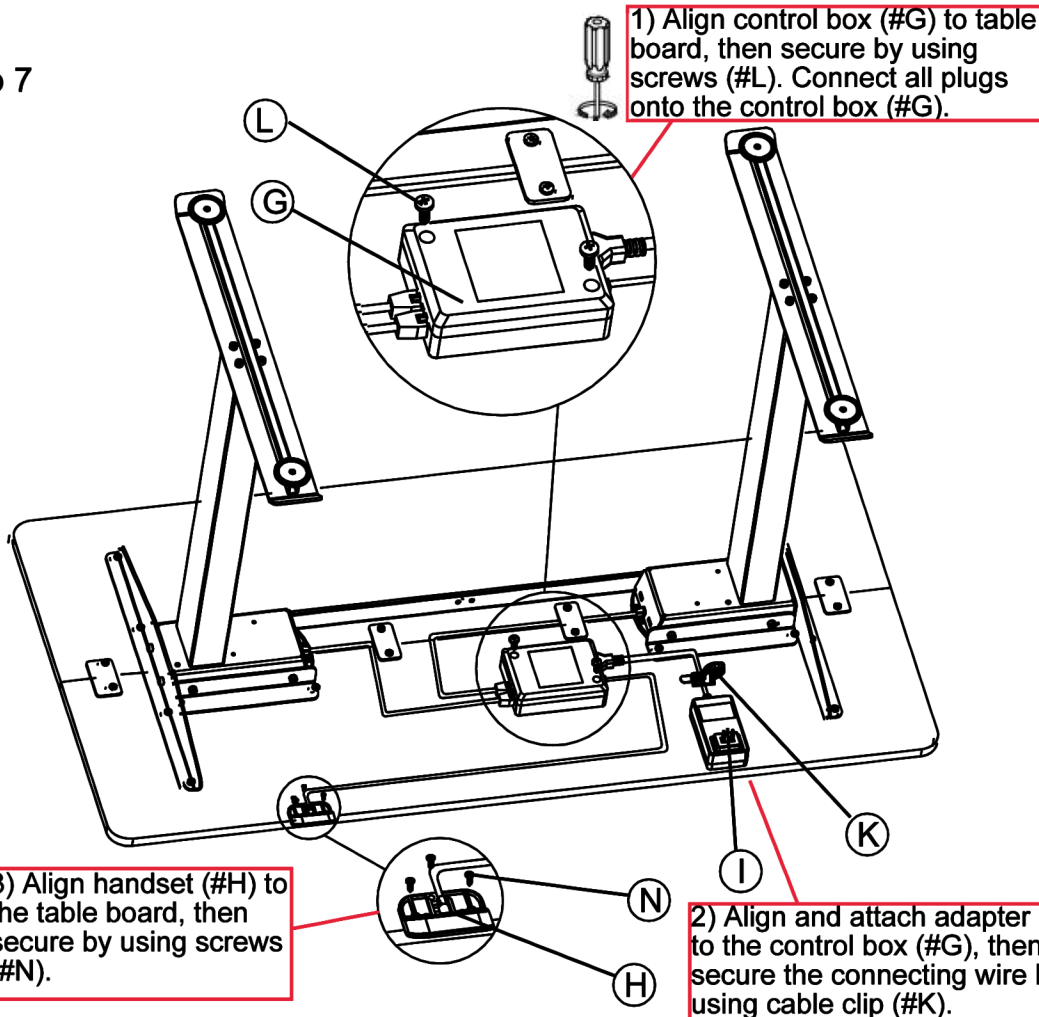

## Checklist

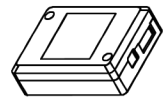

G-Control box x1

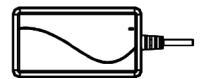

I-Adapter x1

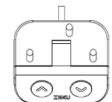

H-Handset x1



L-ST4.8x19 Screw x2



N-ST4x12 Screw x3



K-Cable clip x6

## ASSEMBLY COMPLETED



Please ensure the furniture rests on an even and flat surface. If the product wobbles or feels loose, double-check all bolts and or screws are properly tightened and secured.



**Keep this handy!**

Please retain this instruction manual and any order-related information for future reference.



**Lift, don't drag!**

To avoid damage to product when transporting, please lift instead of dragging the product.