

Assembly Instructions

⚠ Before you throw the carton, please ensure that you have all the parts needed for the assembly.

⚠ **Hardware Note:**

1. For each step please don't fully tighten all the screws at first, when they all align to the holes you can fully tighten them.

2. All the bolts should be assembled **vertically** to the holes.

⚠ Arms can be found in the **bottom** of the seat. We attached velcro on the black fabric.

⚠ **Spare parts** can be found in the hardware box if you do not have enough bolts for assembly.

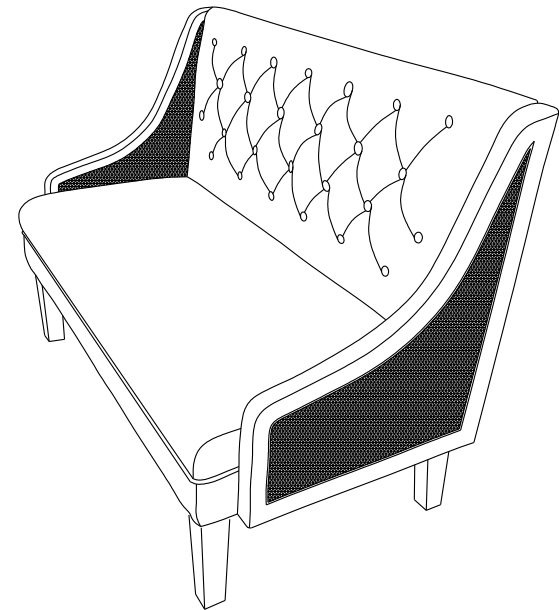

⚠ THIS INSTRUCTION BOOKLET CONTAINS IMPORTANT SAFETY INFORMATION. PLEASE READ AND KEEP FOR FUTURE REFERENCE.

Assembly Instructions

Parts and Hardware

Please check to make sure you have all parts and hardware before starting assembly process.

Ⓐ

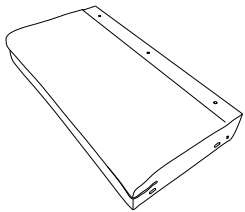

Seat 1pc

Ⓑ

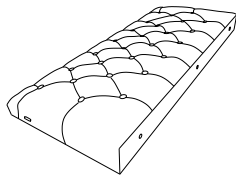

Back 1pc

Ⓒ1

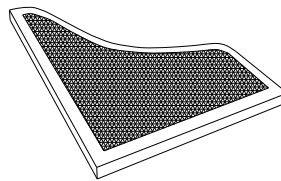

Right arm 1pc

Ⓒ2

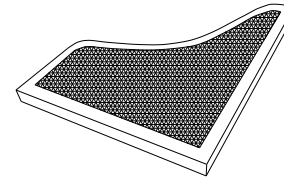

Left arm 1pc

Ⓓ

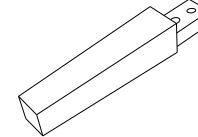

Front leg 2pcs

Ⓕ

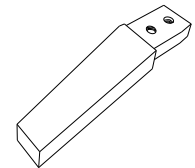

Back leg 2pcs

①

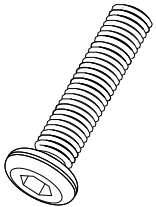

Long bolt
11pcs

②



Short bolt
6pcs

③

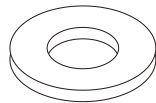

Big flat washer
11pcs

④

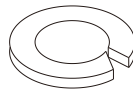

Big spring washer
11pcs

⑤

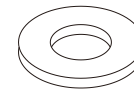

Small flat washer
6pcs

⑥



Small spring washer
6pcs

⑦

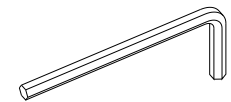

Wrench
1pc

Assembly Instructions

Assembly Instruction

Step 1: Put seat on back and using the longer bolts to assemble.

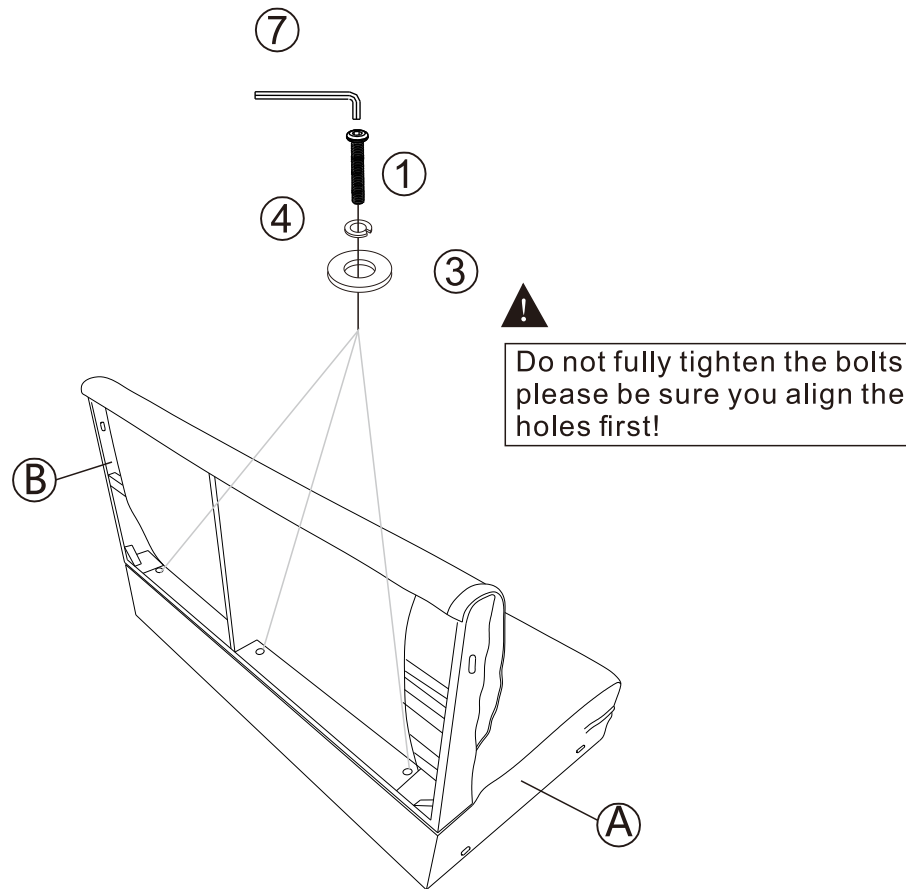

Step 2: Assemble arms to the back and seat using the short bolts. Half tighten all the bolts until they are align to the holes then fully tighten them by the short side of wrench. (include step 1)

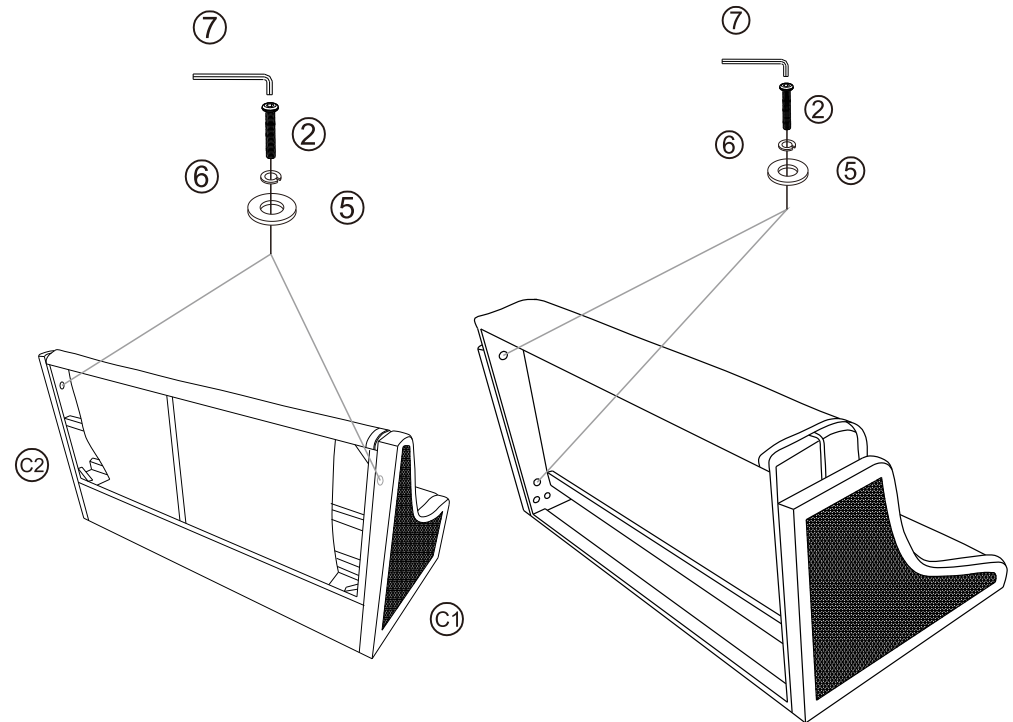

Assembly Instructions

Assembly Instruction

Step 3: Assemble legs to the inner side of seat bottom.

Half tighten all the bolts until they are align to the holes then fully tighten them by the short side of wrench.

