

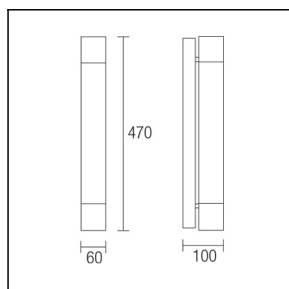

The photograph may not match the reference exactly. Please read the product description to identify the finish.

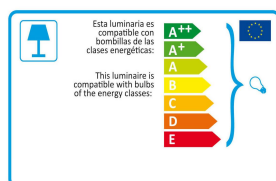

[Download photometric file .ldt / .ies](#)



[Click on image to download energy label](#)

TECHNICAL CHARACTERISTICS

Type:	Wall fixture
IP Protection degrees:	IP44
Light source 1:	1 x 2G11 24W
Voltage / Frequency:	220-240V/50Hz
Units per box:	6
Net Weight (Kg):	1.135



MATERIALS / FINISHES

Structure material:	Steel	Diffuser material:	Polycarbonate
Structure finish:	Chrome	Diffuser finish:	Opal

GEAR

Gear included: Yes, electronic

Luminaire		Measur.		Lamp	
Name	Aplique DRESDE 1x24W PL-L 2G11	Name	Aplique DRESDE 1x24W PL-L 2G11	Code	PL-L24W/830/4P
Line	Eulumdat			Number	1
				Position	
Efficiency	54.67%	Coordinate system	CG	Total Flux	1800.00 lm
Maximum value	155.87 cd	Position	C=0.00 G=45.00	Double Symmetrical	
Rectangular Luminaire	Length 470 mm	Width	26 mm	Height	100 mm
Rectangular Luminous Area	Length 350 mm	Width	60 mm	Height	60 mm
Horizontal Luminous Area	0.021000 m2	Emitting area on Plane 180°	0.021000 m2		
Emitting area on Plane 0°	0.021000 m2	Emitting area on Plane 270°	0.003600 m2		
Emitting area on Plane 90°	0.003600 m2	Glare area at 76°	0.025457 m2		
Symmetry Type	Double Symmetrical	Maximum Gamma Angle	180		
Measurement Distance	0.00	Measurement Flux	1800.00 lm		
Operator	Asselum	Source voltage			
Temperature	25.00 °C	Source current			
Humidity	60.00 %	Photocell			
Notes					

Luminaire Lamps						
Line	Code	Name	Flux [lm]	Pow. [W]	Q.ty	
Eulumdat	PL-L24W/830/4P	PL-L24W/830/4P - 24.00 W	1800.00	24.00	1	
C.I.E.	30 58 81 69 55	D DIN 5040				
F UTE	0.38 H + 0.17 T	B NBN				
		B11				
		BZ 7				

470mm x 26mm

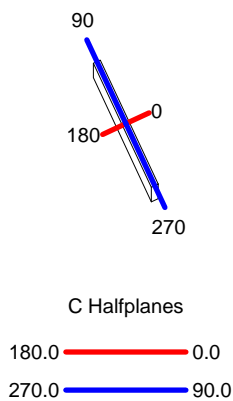

ULOR 16.93 %
DLOR 37.73 %
RN 30.98 %

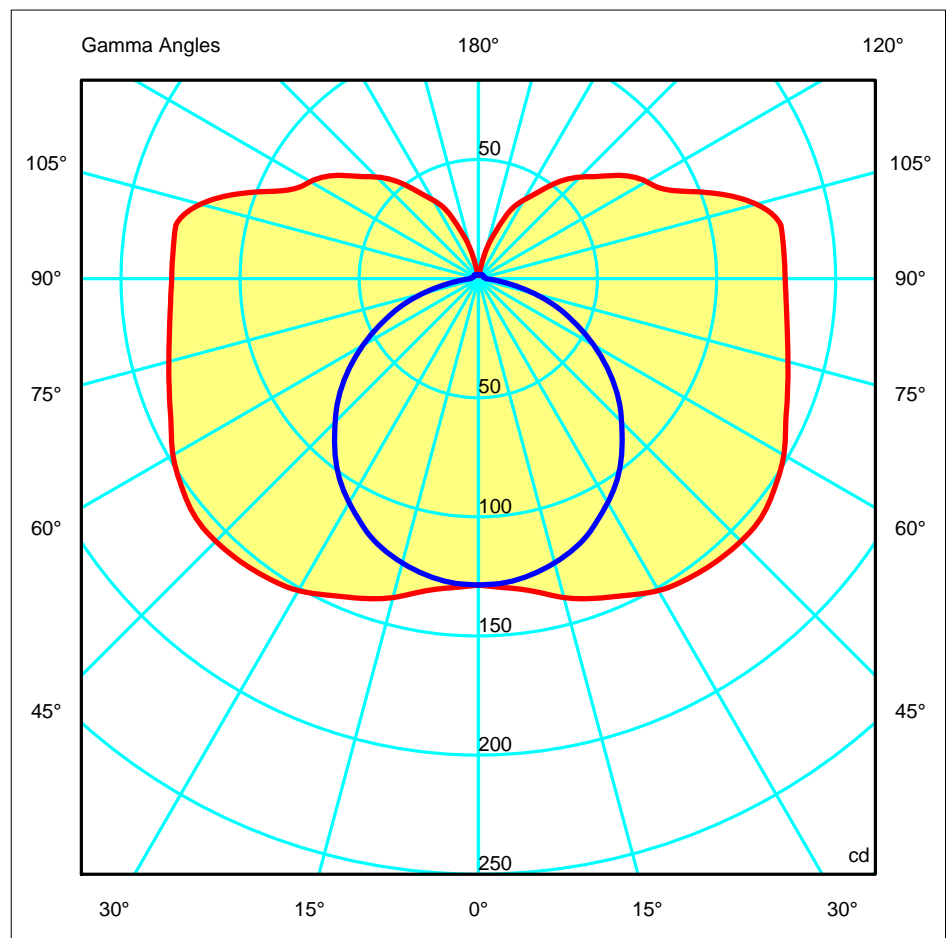

ACERO/STEEL

100

OPAL POLICARBONATE/
POLICARBONATO OPAL

60

HOLE TO ENTER
ELECTRICAL WIRES

$\phi 6,5$

$\phi 16$

470

90

450

145

180

80

30

$\phi 60$

ACERO/STEEL

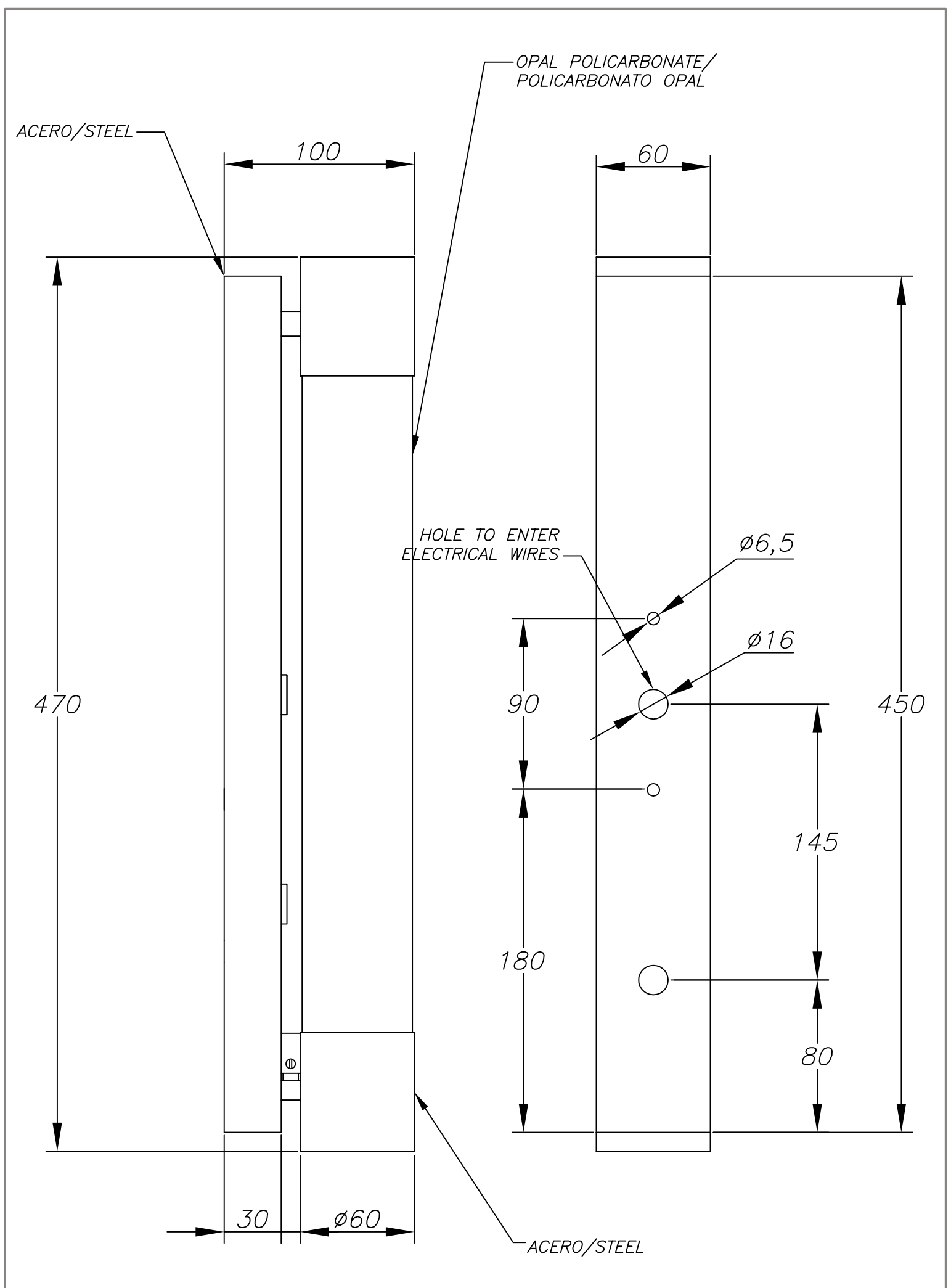

1

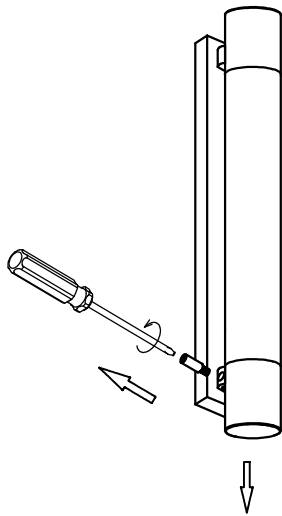
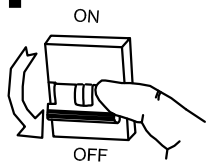

2

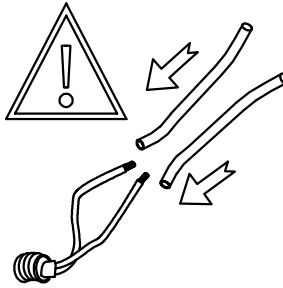

X2

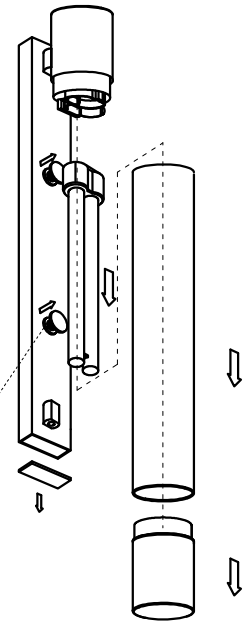

3

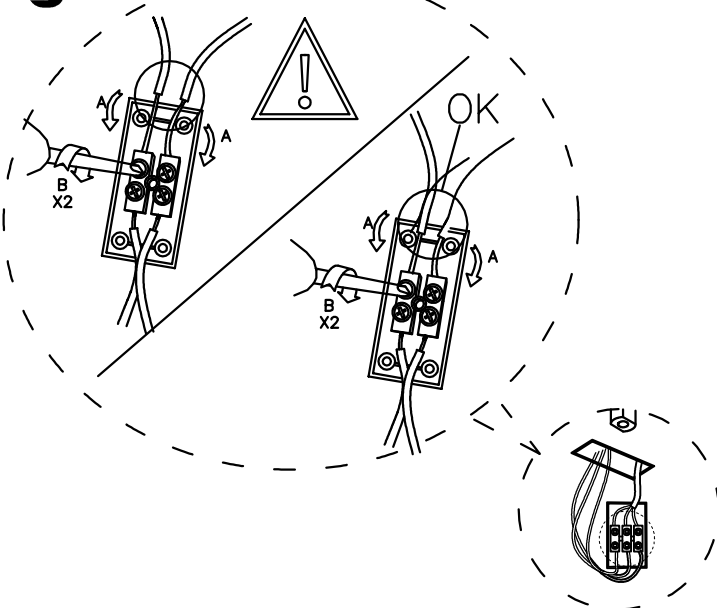

4

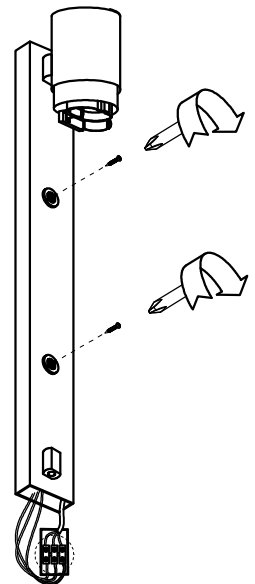

5

X2

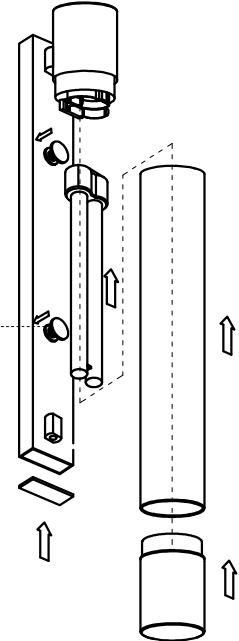

6

