



User Manual

SMART TOILET



Smart+Series

Getting Started with Your Smart Toilet



Thank you for choosing ERIDANUS

To ensure proper operation, it's highly recommended to follow these instructions to inspect the unit received is in sound condition prior to installation.

Basic Connections

- Plug the power cord into a grounded AC 110V outlet.
- Check if the indicator lights up to confirm power is connected.
- Connect supply lines to water supply using an angle valve.
- Open the valve.

Pre-Use Checks



NOTE Place your hand on the sensor area to activate the seat sensor for testing functions that require such.

Keep your hand in front of the nozzle during washing test to prevent splashing.

- Inspect the wand nozzle and supply lines for any leaks.
- Test the washing, drying, flushing functions* to ensure they function properly.
- Ensure the soft-closing mechanism for the seat and cover functions properly.
* Actual functions may vary from models.

Safeguards & Precautions



When using electrical products, especially when children, the elderly, or invalids are present, basic safety precautions should always be followed, including the following:

DANGER

Risk of Electric Shock

- This appliance **MUST** be grounded. Connect only to a circuit protected by a Ground-Fault Circuit-Interrupter(GFCI) or Residual Current Device(RCD).
- Do not install or store this appliance where it will be exposed to the weather or to temperature below freezing.
- Use this appliance only for its intended use.
- Disconnect the power before servicing.

WARNING

Risk of Personal Injury

- The temperature of the heated seat should be set to low or off for children, the elderly, or invalids to prevent low-temperature burns.
- Do not stand on the toilet or the lid.

Risk of Product Damage

- Keep flammable materials, such as drapes, or any open flame, such as lighted candles or cigarettes, away from this appliance.

CAUTION

Water Hazards

- Do not pour water or liquid cleaners into any part of this appliance.

- Never operate this appliance if it has a damaged cord or plug, if it is not working properly, or if it has been dropped or damaged.
- Do not install this appliance in a location exposed to excessive moisture. Provide adequate ventilation to prevent damage to the electronic components due to high humidity levels.

Structural Integrity

- Avoid excessive force when opening or closing the lid.
- Do not apply excessive force to the wand nozzle.
- Do not modify or attempt to repair the appliance yourself, except as specifically instructed in the user manual.

GENERAL USE

- Unplug the product if it will not be used for an extended period of time.
- Avoid dropping any non-flushable items into the bowl.
- Avoid harsh cleaning agents and abrasives that could damage plastic components, or the toilet surface. Use gentle, non-abrasive cleaners recommended for electronics or bathroom fixtures.

SAVE THESE INSTRUCTIONS

Parts List :

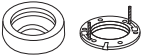
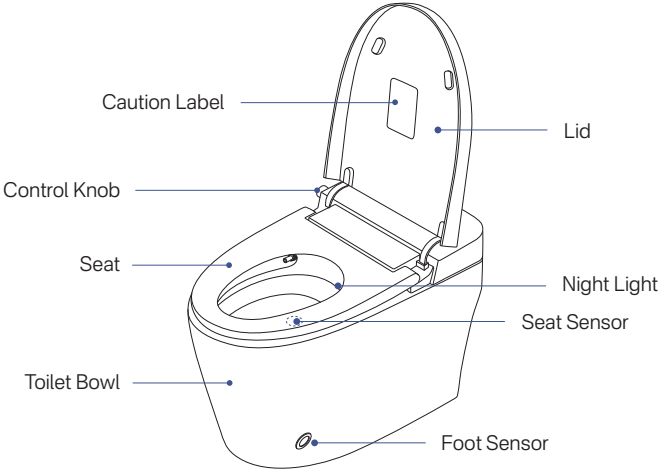

Flange & Wax Ring



User Manual

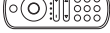

Remote Control



Angle Valve with Adapter



Battery Box with Connector



Fill Valve Adapter (3/4" to 7/8")



Mounting Bolts

Technical Data :

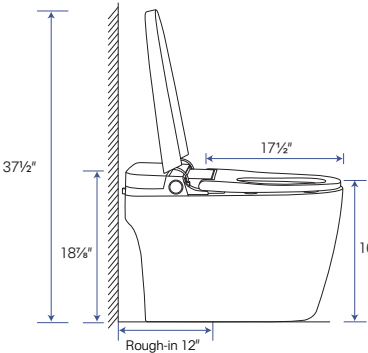

Side View

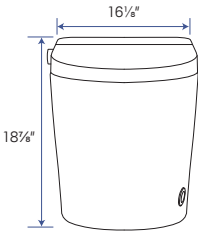

Front View

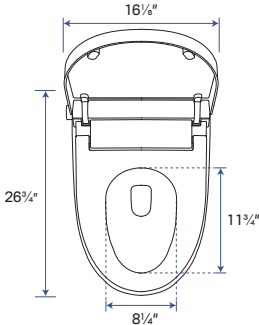

Top View

| Parameter | | Specifications | | | | |
|----------------------------|--------------------|--|--------------------|------|-------|-------|
| Rated Voltage | | AC 110V, 60 Hz | | | | |
| Rated Power | | 1400W | | | | |
| Washing Function | Flow Rate | Bidet Wash | 14-22 oz/min | | | |
| | | Rear Wash | 15-23 oz/min | | | |
| | Water Temp | | Room temp | 93°F | 99°F | 104°F |
| | Heating Mode | | Instant Heat | | | |
| | Heating Power | | 1400W (max) | | | |
| Seat Heating | Seat Temp | | Room temp | 93°F | 99°F | 104°F |
| | Heating Power | | 104°F | | 40W | |
| Air Drying | Air Temp | | Room temp | 95°F | 113°F | 131°F |
| Water Pressure Requirement | | 20-100 psi (static) | | | | |
| Safety Device | | Temp controller, thermal fuse, & leakage protector | | | | |
| Toilet | Overall Dimensions | | 26¾" x 16⅞" x 18⅞" | | | |
| | Net Weight | | 94.2 lbs | | | |
| | Seat Height | | 16½" | | | |
| | Rough-in | | 12" | | | |

Wash Features

| | |
|---------------------------|--|
| Bidet Wash | Features adjustable water pressure, adjustable water temperature, and an oscillating mode for front washing. Lasts 2 minutes by default. |
| Rear Wash | Features adjustable water pressure, adjustable water temperature, and an oscillating mode for posterior washing. Lasts 2 minutes by default. |
| Oscillating Mode | Provides a consistent back-and-forth motion for the targeted washing area for an enhanced cleaning. |
| Hot/Cold Massage | The washing water switches alternately between high and low temperature while rear or bidet washing mode is on. |
| High/Low Massage | The washing water switches alternately between high and low pressure while rear or bidet washing mode is on. |
| Nozzle Position | Adjust the nozzle forward or backward while rear or bidet washing mode is on. |
| Air Drying | Features adjustable air temperature with optional air freshening for air and skin drying after washing. Lasts three minutes by default. |
| Adjustable Water Temp | Provides four levels of water temperature adjustment: room temp, 93°F (34°C), 99°F (37°C), 104°F (40°C). |
| Adjustable Water Pressure | Provides five levels of water pressure adjustment: gentle, medium, strong, extra strong, max. |
| Adjustable Air Temp | Provides four levels of air drying temperature adjustment: room temp, 95°F (35°C), 113°F (45°C), 131°F (55°C). |

Flush Features

| | |
|----------------------|--|
| Power-assisted Flush | Utilizes power to generate a forceful siphonic jet flush. |
| Auto Flush | When enabled, seat sensor triggers automatic flushing upon detecting user leaving. |
| Foot-sensor Flush | With seat unoccupied, foot sensor triggers automatic flushing upon detecting foot wave or proximity. |
| Blackout Flush | Supports power-assisted flush during power outage (battery required). |

Seat & Cover Features

| | |
|----------------------|--|
| Seat Sensor | Located on the front right side of seat as to detect a seated user. Wash features will not be activated without a seated user. |
| Heated Seat | When enabled, the seat warms up with adjustable thermostat settings. |
| Soft Close | Features a soft and silent close when powered on. |
| Adjustable Seat Temp | Provides four levels of seat temperature adjustment: room temp (off), 93°F (34°C), 99°F (37°C), 104°F (40°C). |

Light Features

| | |
|----------------|---|
| Night Light | When activated, soft light illuminates from the bowl. |
| Screen Display | When activated, screen displays current temperature based on latest mode set. |

Operation Options

| | |
|----------------|---|
| Remote Control | Operates the toilet features when paired with the unit. |
| Control Knob | Located on left side of toilet for quick access to primary toilet features. |

Other Features

| | |
|--------------------|---|
| Self Cleaning Wand | Cleaning wand/nozzle automatically rinses itself before and after each use. |
| Eco-mode | Automatically set the seat temp to the second lowest gear 12 hours after toilet last senses motion, and to the room temp gear 48 hours after toilet last senses motion. |
| Toddler Mode | Automatically run a process of washing, air drying, and flushing in sequence with medium temperature. Note: Toddler/children mode does not require a seated user to proceed. |

Remote Control



Set up

- The remote control must be charged to operate.
- Make sure two AAA batteries are correctly installed.
- Press and hold the female washing button on the remote control until the lights flash to complete setup.

Pairing with Toilet

 **NOTE** The remote control is generally paired with toilet from factory. No operation is needed except for replacement unit.

- Turn off the power to the toilet
- Press and hold the "Female Washing" button on the remote control until the indicator light starts flashing.
- Immediately power on the toilet. The toilet and the remote control will automatically begin the pairing process.
- Pairing is complete when you hear a "beep" sound from the toilet.

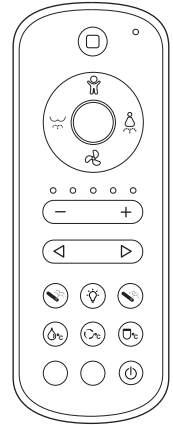

Operations



Press once to terminate current washing or drying process.



Press once to turn the power on or off.



Press once to start a 2-minute rear wash.

Press again to switch to the oscillating rear wash.



Press once to start a 2-minute bidet wash.

Press again to switch to the oscillating bidet wash.



Press once to start a 3-minute air drying session.



Press to adjust the wand nozzle position forward or backward during rear wash and bidet wash if oscillating mode is not activated.



Press to increase or decrease the water pressure, ranging from low to high across five levels.



Press once to start a power-assisted siphon flush.



Press to adjust water temp for washing.



Press to adjust seat temp.



Press to adjust air temp for drying.



Press once to run a process of washing, air drying, and flushing in sequence with medium temperature.



Press once to render the washing water switch alternately between high and low temperature.



Press once to render the washing water switch alternately between high and low pressure.



Press once to turn on/off the night light.

Knob Control

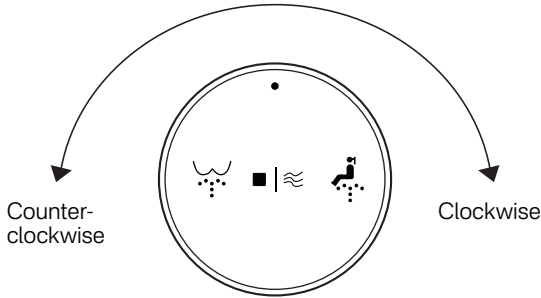

Flush, Dry, Stop



With seat unoccupied, press once to start a flushing session.
With seat occupied, press once to start a 3-minute air drying session.
With seat occupied, press once to stop any running function like washing, air drying, etc.



Bidet Wash

Turn clockwise to start bidet washing. Turn again to start oscillating mode.



Rear Wash

Turn counterclockwise to start rear washing. Turn again to start oscillating mode.



Power Status

Turn clockwise and hold for 5 seconds to turn on/off the power status.

Installation



Toilet

- Please refer to Eridanus installation guide for toilet installation.

Remote Control

- The shelf can be wall mount using the peel-and-stick or screws. It's highly recommended that the remote be installed within reach when seated.

Backup Battery

- A 9V battery (not included) is required to support power-assisted flush during outage. Followings are steps for setting up backup battery:
 - Locate the battery box that comes with the toilet. Place a new 9V battery into the box.
 - Locate the connection wire at the back of the toilet.
 - Match connectors at both ends of wire and battery box.
 - Screw the connectors together and secure the connection.

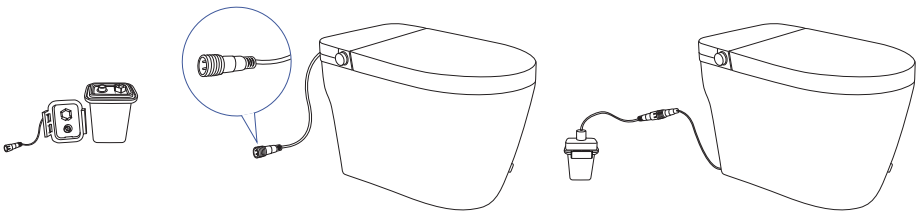

Eridanus smart toilets are meticulously crafted and have undergone strict quality inspection to ensure each unit lasts for years to come. As a combination of plumbing fixtures and appliances, Eridanus toilets would require regular care as to maintain their hygiene and functionality. Proper maintenance guarantees longevity and optimal performance.

General Maintenance

Disconnect Power Before Maintenance/Service

- Always disconnect the power supply before performing any maintenance tasks to prevent personal injury or property damage.

Avoid Water Exposure

- Do not allow water to enter the control panel or electrical components.

Avoid Excessive Moisture

- Provide adequate ventilation to prevent damage to the electronic components due to high humidity levels.

Regular Inspections

- Perform regular inspections of all components to ensure the toilet is in good working order and address any issues promptly.

Regular Maintenance

Cleaning the Toilet Bowl

- Use a non-abrasive toilet cleaner.
- Apply the cleaner to the bowl, let it sit for a few minutes, then scrub with a toilet brush.
- Avoid using harsh chemicals or abrasive pads.

Cleaning the Nozzle

- Activate the nozzle cleaning mode via the control panel or remote.

- Use a soft brush or cloth to gently clean the nozzle.
- For a deeper clean, remove the nozzle (if detachable) and rinse it with warm water.

Cleaning the Seat and Cover

- Wipe down the seat and cover with a damp cloth and mild detergent.
- Avoid using abrasive cleaners or scrubbing pads that could damage the surface.
- Dry with a soft cloth to prevent water spots.

Battery Replacement

- Locate the battery compartment at the rear of the toilet.
- Remove the old battery and replace it with a new 9V battery.
- Ensure the battery is securely connected.

Contact Information

 Email

support@eridanus.net

Power Troubleshooting

| Problems | Possible Causes | Recommended Actions |
|--------------------------|--|--|
| Toilet has no power. | <ul style="list-style-type: none"> a) Power is not switched on. b) Power cord is disconnected from or loosely connected to the electrical outlet. c) The GFCI has tripped. | <ul style="list-style-type: none"> a) Press and hold the left control knob, or "STOP" on remote control to turn on the power. b) Securely plug the power cord into a GFCI electrical outlet. c) Reset the GFCI. |
| Toilet does not respond. | <ul style="list-style-type: none"> a) Power is not switched on. b) Electrical power to the toilet is briefly interrupted. c) If responsive with control knobs but not remote control, pairing was failed. | <ul style="list-style-type: none"> a) Press "Power" on remote control to turn on the power. b) Turn OFF the power to the toilet completely, and restore the power. c) Pair the remote with toilet. Refer to "Remote Control" section. |
| Toilet beeps frequently. | <ul style="list-style-type: none"> a) Power cord is loosely connected to the electrical outlet. b) Specific functions such as adjusting seat sensor, beep as to confirm proper functioning. | <ul style="list-style-type: none"> a) Securely plug the power cord into a GFCI electrical outlet. b) No action is required. |

Flush Troubleshooting

| Problems | Possible Causes | Recommended Actions |
|------------------------------------|--|---|
| Toilet does not flush. | <ul style="list-style-type: none"> a) Supply valve is closed. b) Supply line is blocked or kinked. c) Remote control is not working. d) Toilet is clogged. | <ul style="list-style-type: none"> a) Switch on the valve. b) Repair or replace the supply line. c) Refer to "Remote Control Trouble shooting" section. d) Use a plunger or snake to clear the clogs. |
| Flushing performance is not ideal. | <ul style="list-style-type: none"> a) Local water pressure is insufficient. b) Supply line or pipe is bent or blocked. c) A filter is clogged. | <ul style="list-style-type: none"> a) Check if water pressure meets minimum requirement as specified in "Specifications" section. If not, a pump is needed. b) Replace the line or pipe. c) Check filter status and remove or replace when needed. |

| | | |
|---|---|---|
| Toilet does not flush automatically. | <ul style="list-style-type: none"> a) The automatic flush is disabled. b) Seat sensor is always deactivated. c) Seat sensor is always activated. | <ul style="list-style-type: none"> a) Refer to the "Operations" section as to enable the feature. b) Sensor is blocked by other physical objects to detect user. Clean the sensor area and remove any debris. c) Sensor is covered by other physical objects to stay in the activated status. Clean the sensor area and remove any debris. |
| Flushing is too loud or water splashes out of bowl. | <ul style="list-style-type: none"> a) Local water pressure is too high. b) Improper alignment or installation. | <ul style="list-style-type: none"> a) Adjust angle valve to an appropriate position. b) Check for any misalignment or uneven surfaces. Adjust accordingly. |
| Toilet flushes unexpectedly. | <ul style="list-style-type: none"> a) The automatic flush is enabled. | <ul style="list-style-type: none"> a) When enabled, unexpected flushes might occur due to foot sensor, accidental touch to remote control or knobs. No action is required in most cases. |

Wash & Dry Troubleshooting

| Problems | Possible Causes | Recommended Actions |
|--|---|---|
| Wash function does not work. | <ul style="list-style-type: none"> a) Supply valve is closed. b) Supply line is blocked or kinked. c) Remote control is not working. d) Seat sensor is always deactivated. e) Seat sensor is always activated. | <ul style="list-style-type: none"> a) Switch on the valve. b) Repair or replace the supply line. c) Refer to "Remote Control Trouble shooting" section. d) Sensor is blocked by other physical objects to detect user. Clean the sensor area and remove any debris. e) Sensor is covered by other physical objects to stay in the activated status. Clean the sensor area and remove any debris. |
| Wand nozzle stops spray after some time. | <ul style="list-style-type: none"> a) All wash mode stops automatically after 90 seconds by default. | <ul style="list-style-type: none"> a) No action is needed. Reactivate the function with the remote control or the control knob. |
| No water sprays from the wand nozzle. | <ul style="list-style-type: none"> a) Supply valve is close. b) Supply line is blocked or kinked. c) Nozzle is blocked. | <ul style="list-style-type: none"> a) Switch on the valve. b) Repair or replace the supply line. c) Turn on the auto-cleansing mode and manually clear any blockage on the nozzle. |

| | | |
|--------------------------|--|---|
| Water flow is not ideal. | <ul style="list-style-type: none"> a) Water pressure is set as gentle. b) Filter is clogged. | <ul style="list-style-type: none"> a) Turn up the water pressure using remote control or control knob. b) Inspect filter and clean or replace if necessary. |
| Water is not heated. | <ul style="list-style-type: none"> a) Water temp is set as room temp. | <ul style="list-style-type: none"> a) Turn up the water temp using remote control or control knob. |
| Dryer is too hot. | <ul style="list-style-type: none"> a) Air drying temp is set at a higher gear. | <ul style="list-style-type: none"> a) Turn down the air temp using remote control or control knob. |

Seat & Cover Troubleshooting

| Problems | Possible Causes | Recommended Actions |
|-------------------------------------|--|--|
| Seat is not heated. | <ul style="list-style-type: none"> a) Seat temp is set as room temp. | <ul style="list-style-type: none"> a) Turn up the seat temp using remote control or control knob. |
| Cover opens unexpectedly. | <ul style="list-style-type: none"> a) Motion sensor detects user approaching. | <ul style="list-style-type: none"> a) No action is required. Refer to "Operations" section as to adjust the sensor range if needed. |
| Cover does not opens automatically. | <ul style="list-style-type: none"> a) This model does not feature an auto open/close function. b) Auto open/close is disabled. c) Rare case caused by complex bathroom layout and sensor range. | <ul style="list-style-type: none"> a) No action is needed. b) Refer to "Operations" section as to enable the feature. c) Adjust sensor range and re-test the feature. |

Remote Control Troubleshooting

| Problems | Possible Causes | Recommended Actions |
|-----------------------------------|--|---|
| The remote control does not work. | <ul style="list-style-type: none"> a) Inproper installation of batteries. b) The batteries need to be replaced. c) Remote control does not pair with toilet. d) Remote control is distant from toilet. | <ul style="list-style-type: none"> a) Correctly reinstall the batteries. b) Replace batteries. c) Refer to "Remote Control" section as to pair remote with toilet. d) Operate remote control near toilet. |

User Manual