

# Night Stand

## IMPORTANT

Carefully remove all the parts from the carton and place them individually on a soft cloth to prevent scratches or other damage.

Carefully and strictly follow these assembly instructions to ensure a completed product as designed.

Do not use power tools above 8 volts to assemble.



## Part List

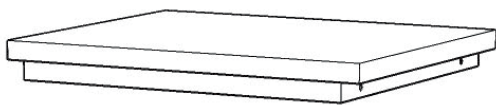

A.  
Top  
1 pc.

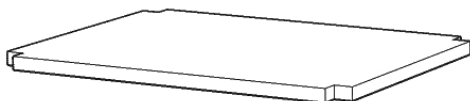

B.  
Shelf  
1 pc.

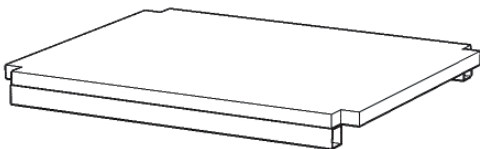

C.  
Base  
1 pc.

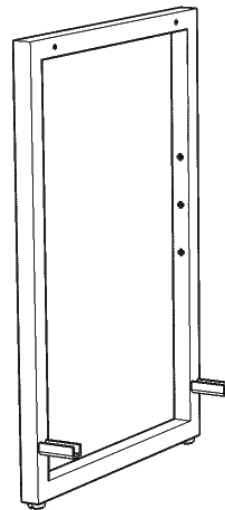

D.  
Side Frame  
2 pcs.

## Hardware List



Hex Wrench  
1 pc.



Small Hex Wrench  
1 pc.



M6x19  
Head Cap Bolt  
8 pcs. (+1 extra)



M6x38  
Head Cap Bolt (long)  
4 pcs. (+1 extra)



Spring Washer  
12 pcs. (+1 extra)



Flat Washer  
12 pcs. (+1 extra)



Adjustable Pin  
4 pcs. (+1 extra)

Tool(s) required for assembly: Level

## Assembly Instructions 2/2

### IMPORTANT

- Use a soft cloth between these parts and the floor.
- Do not use power tools above 8 volts to assemble.
- Do not tighten all the bolts until each part is properly assembled.
- The unit must be level to work properly. Use the included adjustable levelers to level.
- Keep Hex Wrench as the bolts may need to be tightened in the future.

### STEP 1

Attach Top A to Side Frame (D) with Flat Washers, Spring Washers and Head Cap Bolts (long), tightening bolts only halfway. (See Figure 1)

Attach Base (C) to unit with Flat Washers, Spring Washers and Head Cap Bolts, tightening bolts only halfway.

Attach Side Frame (D) to unit with Flat Washers, Spring Washers, Head Cap Bolts and Head Cap Bolts (long), tightening bolts only halfway.

Tighten all bolts.

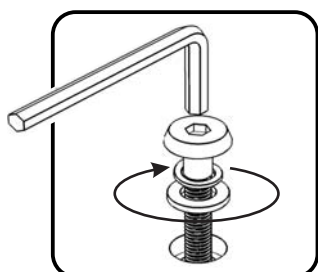
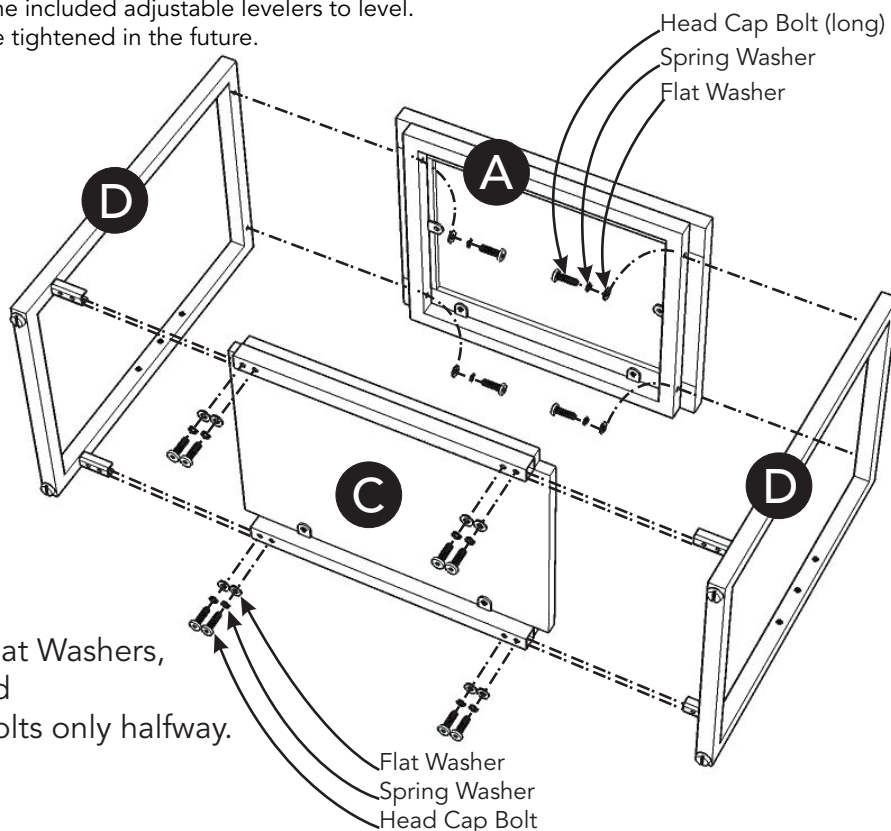

Figure 1

### STEP 2

Turn unit to its' upright position.

Insert Adjustable Pins into side frames at desired level.

Place Shelf (B) into position.

Level unit by adjusting the adjustable levelers on bottom of unit. (See Figure 2)

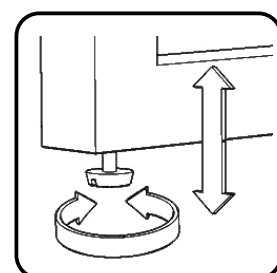
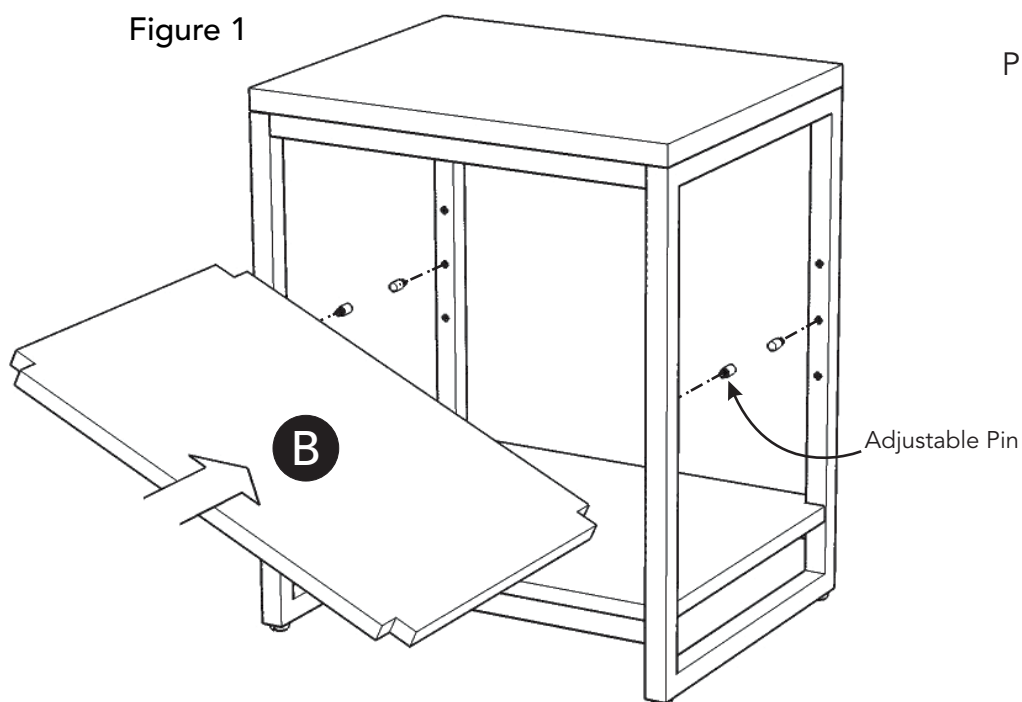

Figure 2