

Accessories List

(1) Backrest	(2) Seat Cushion	(3) Plastic Cap	(4) Central Base Tube	(5) 5 Castors
(6) Air Rod	(7) 2 Armrests	(8) Base Plate	(9) 4 Screws (M8X45mm)	(10) 4 Screws (M6X25mm)
(11) 4 Screws (M6X25mm)	(12) 3 Screws (M8X20mm)	(13) 4 Screws (M6X20mm)	(14) 5 Screws (M6X20mm)	(15) Headrest
(16) Footrest	(17) Connecting Iron	(18) 2 Rubber Trap	(19) 2 Screws (4X14mm)	(20) Hanger
(21) 2 Footrest Connector	(22) 4 Armrest Plastic Cover	(23) Wrench		

Assembly Instruction

Please assemble in a wide and flat place.

Step 1

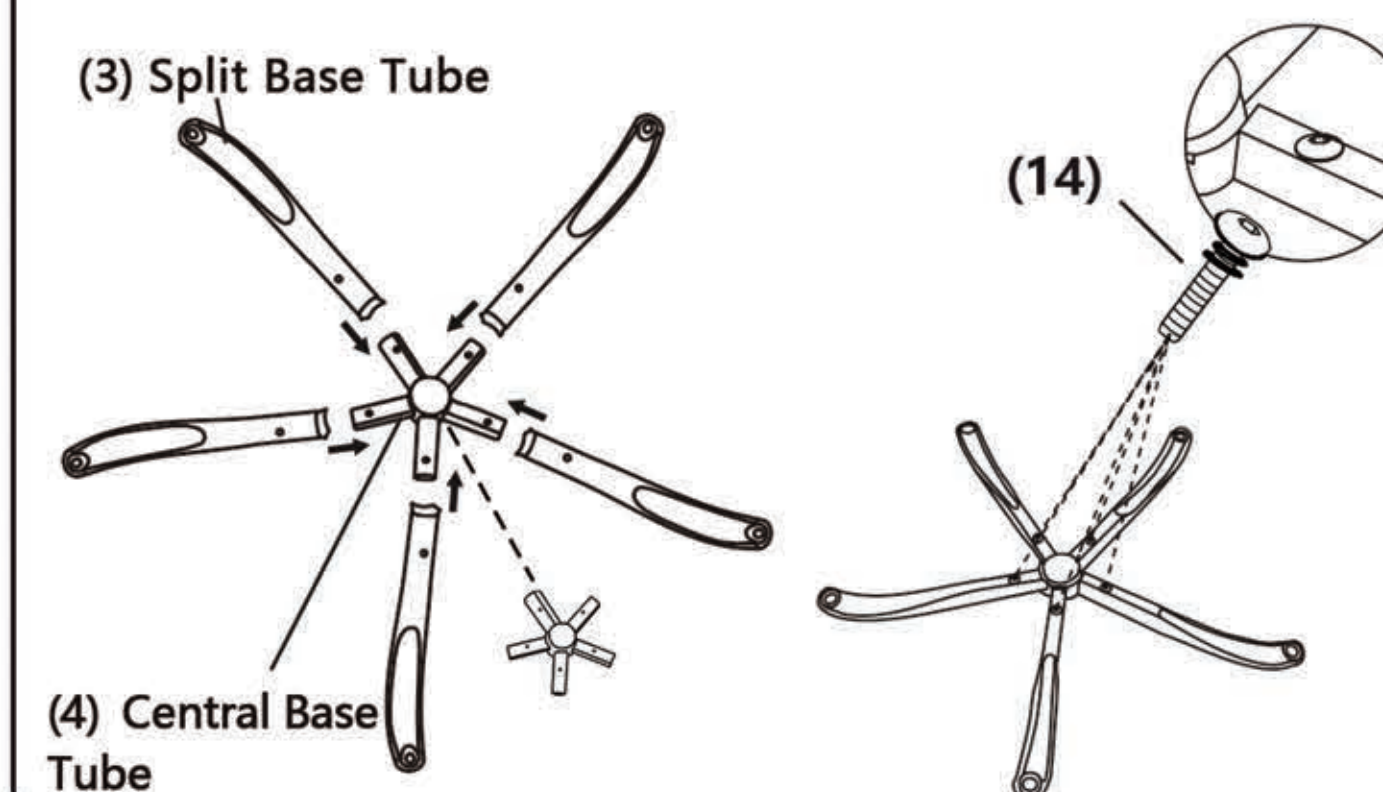

Step 2

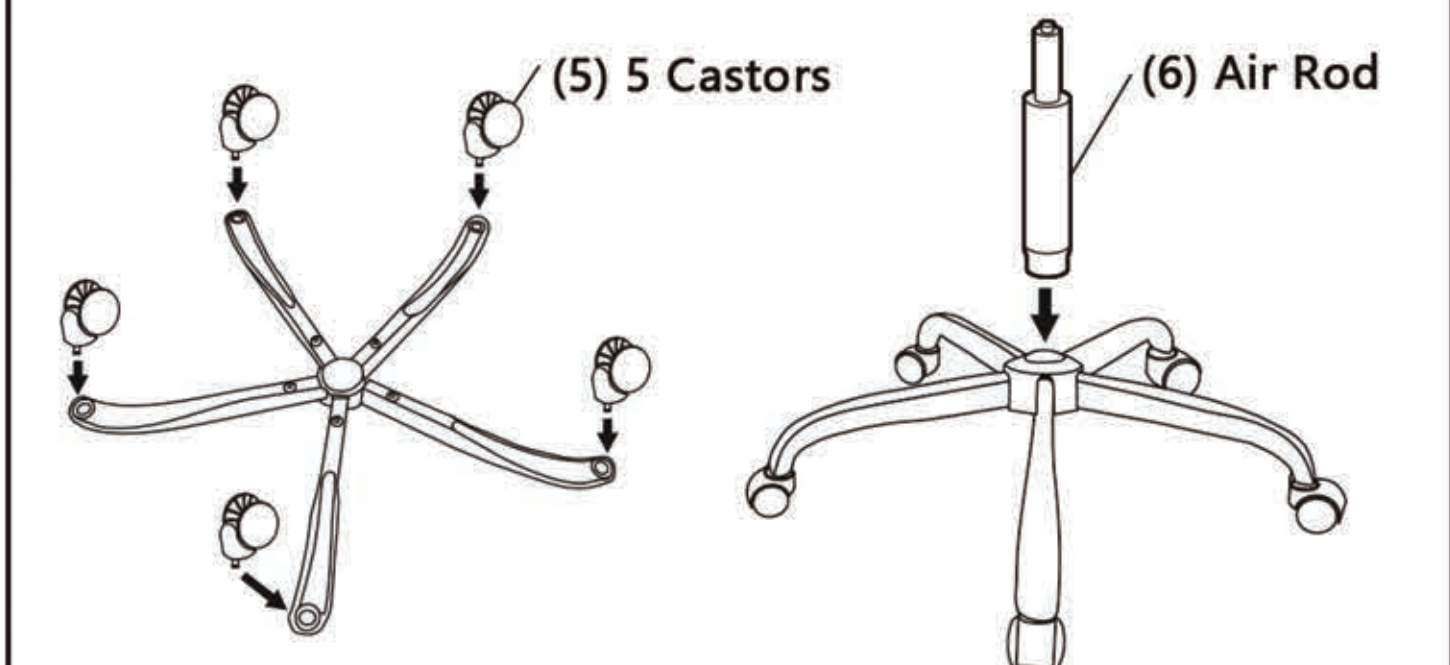

Step 3

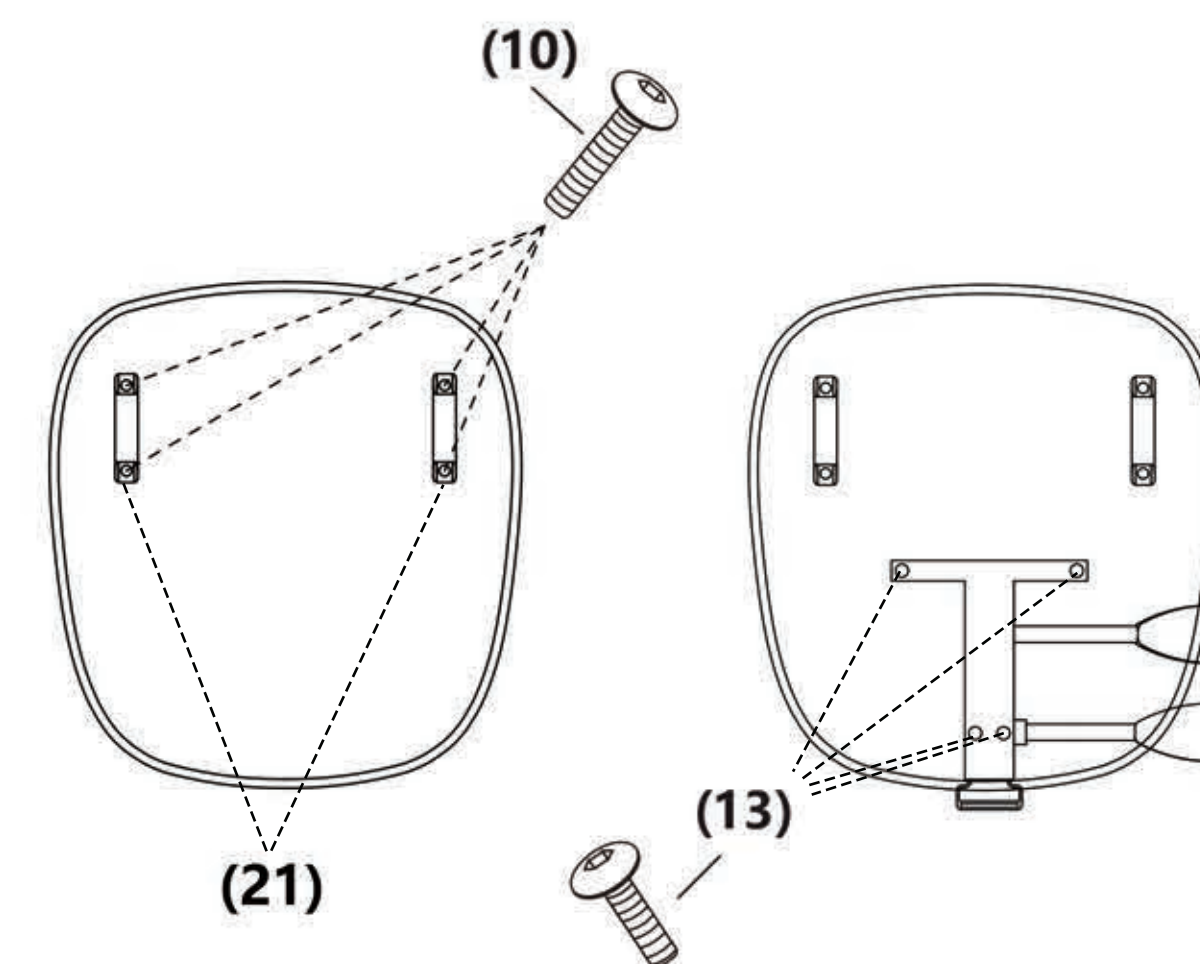

Step 4

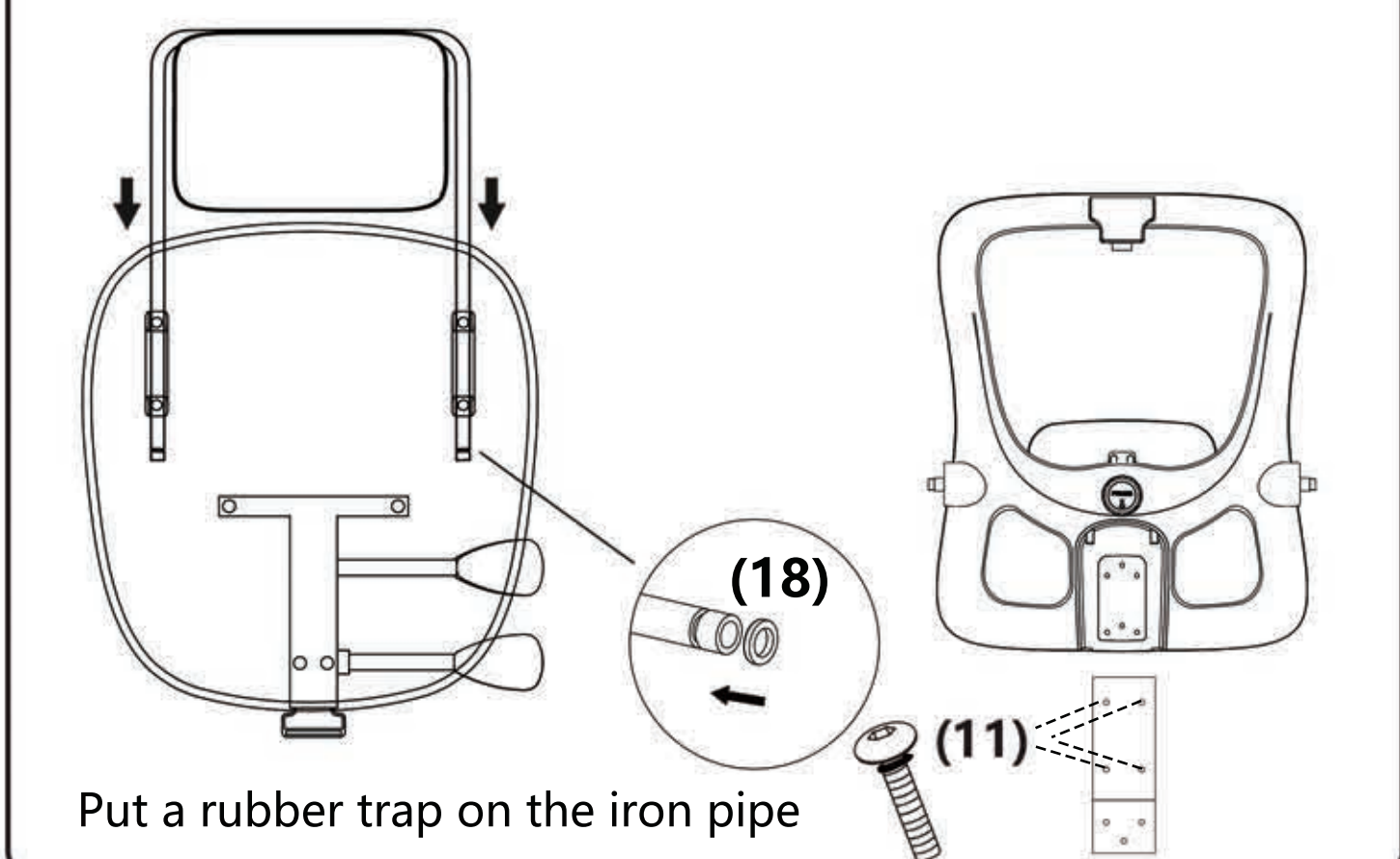

Step 5

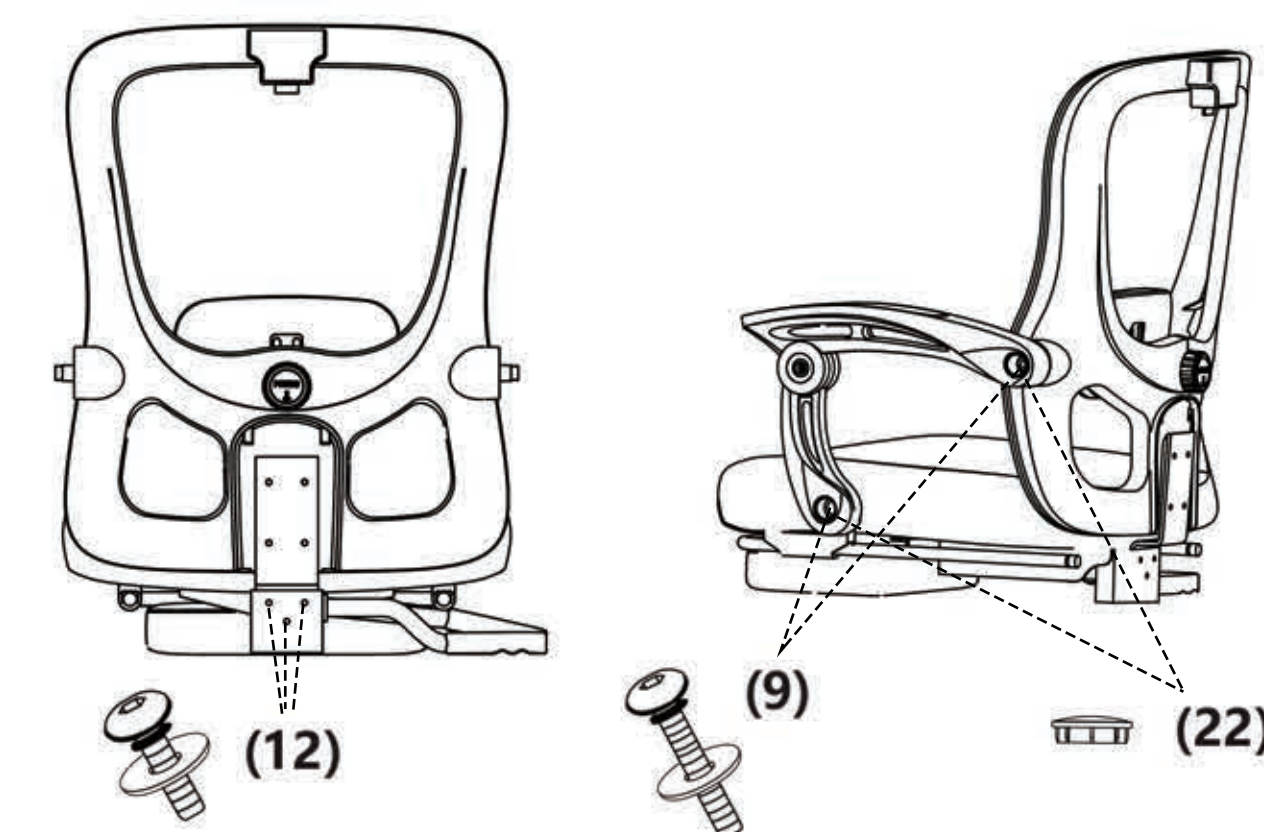

Step 6

