

**P3 Comforts Furniture washbasin asymmetric & # 2333100000**  
 / 2333100030 / 2333100060

< 41 3/8" Inch >

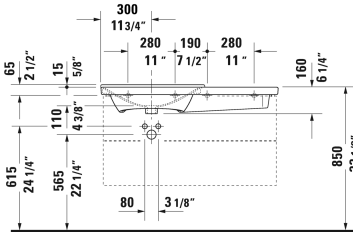
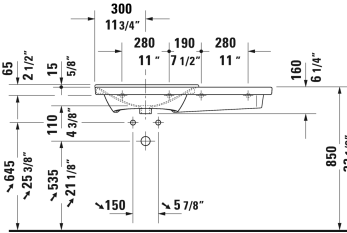
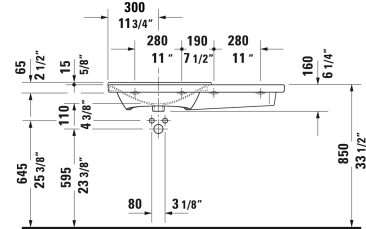
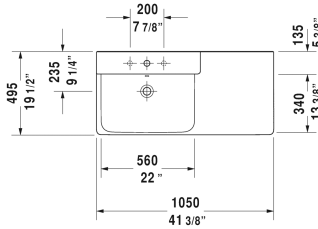

Furniture washbasin asymmetric	Dimension	Weight	Order number
with overflow, with faucet deck, overflow clip Chrome included, bowl on left side, hardware included, wall-mounted, 41 3/8" Inch			
<b>Colors</b>			
00 White			
<b>Variant</b>			
●	41 3/8" x 19 1/2" Inch	59.5 lb	2333100000
● ● ●	41 3/8" x 19 1/2" Inch	59.5 lb	2333100030
⊗	41 3/8" x 19 1/2" Inch	59.5 lb	2333100060
<b>Infobox</b>			
Washbasin is not ADA compliant in combination with pedestal, siphon cover or metal console			
Sanitary ceramics with the special WonderGliss surface finish will remain clean and attractive-looking for a long time to come. When ordering WonderGliss please add a "1" as eleventh digit to the model number.			
Space-saving siphon	1 1/4" Inch	0.9 lb	005076
<b>Suitable products</b>			
Vanity unit wall-mounted 1 pull-out compartment, for P3 Comforts # 233210, 233310, 233410, 40 1/8" x 19" Inch	40 1/8" x 19" Inch		LC6150

**P3 Comforts Furniture washbasin asymmetric & # 2333100000**  
 / 2333100030 / 2333100060

|< 41 3/8" Inch >|

Vanity unit wall-mounted 2 drawers, upper drawer including cut-out for siphon and siphon cover, for P3 Comforts # 233310 basin left, 40 1/8" x 19" Inch	40 1/8" x 19" Inch	LC6251
Vanity unit floorstanding 2 pull-out compartments, for P3 Comforts # 233210, 233310, 233410, 40 1/8" x 19" Inch	40 1/8" x 19" Inch	LC6602

*All drawings contain the necessary measurements which are subject to standard tolerances. They are stated in inch & mm and are non-binding. Exact measurements, in particular for customized installation scenarios, can only be taken from the finished ceramic piece.*