

ASSEMBLY INSTRUCTIONS

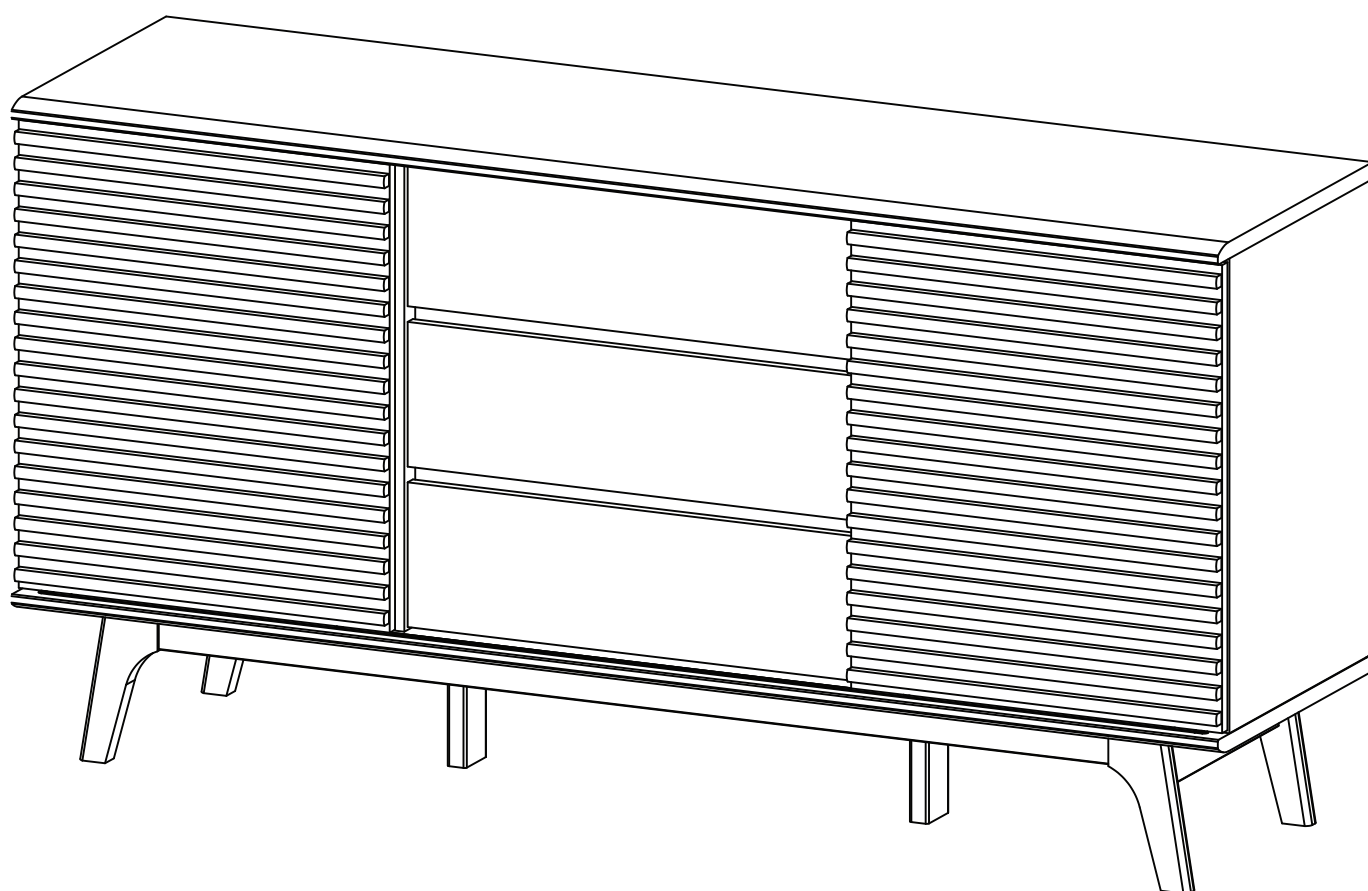

Let's get started!



Read through all of the instructions before starting



Care instructions are listed in the last step of this manual



Approx. 60 minutes assembly time



Make sure you have all parts and components before discarding any packing materials



2 people recommended for assembly

Only use hand tools to assemble this item. Do not use power tools. Do not tighten bolts or screws completely until all hardware is lined up and inserted into the holes.

Do not over-tighten screws and bolts to avoid stripping the hardware or cracking the item.

Assemble your item on a flat, carpeted area, with plenty of space to work. This will prevent damage and scratches to your floors or the item while you're assembling the product.

Keep all components and packaging out of reach of children or animals to avoid risk of choking or suffocation.

Furniture components:

1	Top Board	x1	11	Center Leg	x2
2	Bottom Board	x1	12	Frame Door	x2
3	Side Board Left	x1	13	Adjustable Shelf	x2
4	Side Board Right	x1	14	Front Skirt	x2
5	Center Board Left	x1	15	Front Drawer	x3
6	Center Board Right	x1	16	Side Drawer Left	x3
7	Assembly Leg	x2	17	Side Drawer Right	x3
8	Support Board 1	x2	18	Back Drawer	x3
9	Support Board 2	x2	19	Bottom Drawer	x3
10	Support Board 3	x2	20	Back Board 1	x2

21 Back Board 2 x2

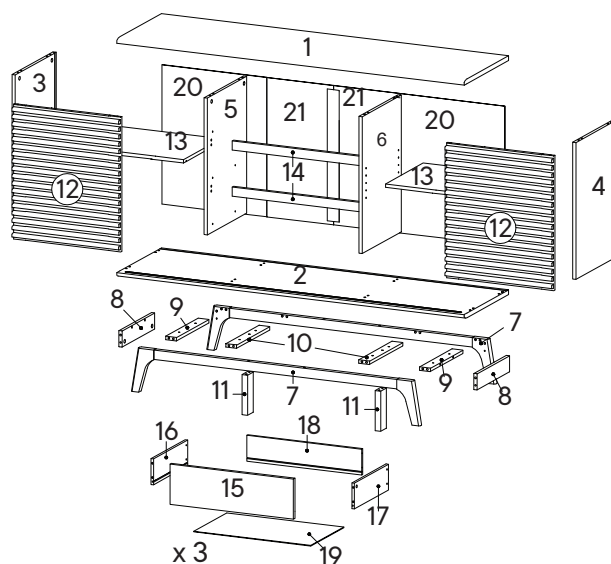

Provided hardware:

A		Cam Bolt Ø6 x 35 mm	x18	J		Allen Key	x2	S		Screw 5.5 x 35 mm	x8
B		Cam Lock Ø15 mm	x12	K		Wedge	x12	T		Screw M 3 x 17 mm	x4
C		Cam Lock Ø12 mm	x6	L		Screw M 3.5 x 15.5 mm	x12	U		Sliding Top	x4
D		Wood Dowel Ø8 x 30 mm	x58	M		Floor Protector	x6	V		Sliding Bottom	x4
E		Back Panel Holder	x4	N		Screw Cap Ø15 mm	x4	RM35A		Drawer Runner	x3
F		Screw M 6 x 10.5 mm	x12	O		Wood Dowel Ø6 x 30 mm	x6	<h2>What you need:</h2>			
G		Screw M 3.5 x 13 mm	x34	P		Screw M 8 x 39 mm	x12				
H		Silicon Bumper	x2	Q		Stopper	x6				
I		Screw M 7 x 50 mm	x10	R		Shelf Pin	x8				
									Phillips Head Screwdriver		

Step 1

HARDWARE

- | | | |
|----------|-----------------------|-----|
| A | Cam Bolt Ø6 x 35 mm | x8 |
| D | Wood Dowel Ø8 x 30 mm | x24 |

COMPONENTS

- | | | |
|-----------|--------------------|----|
| 1 | Top Board | x1 |
| 3 | Side Board Left | x1 |
| 4 | Side Board Right | x1 |
| 5 | Center Board Left | x1 |
| 6 | Center Board Right | x1 |
| 14 | Front Skirt | x2 |

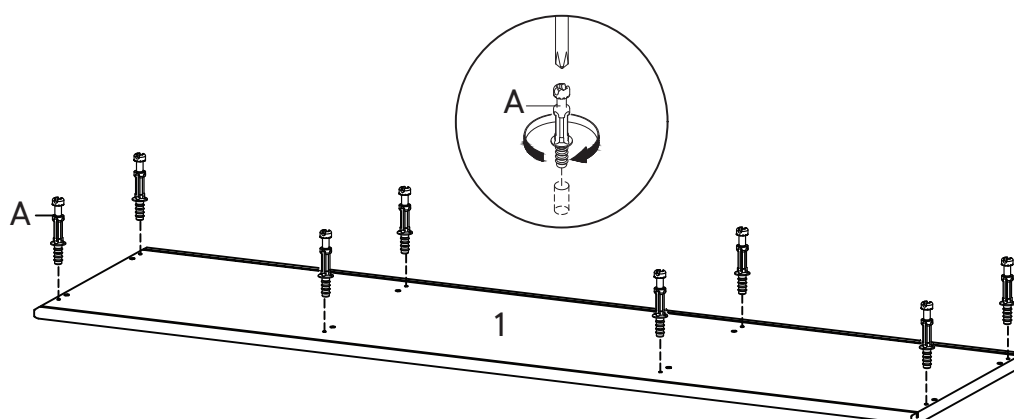
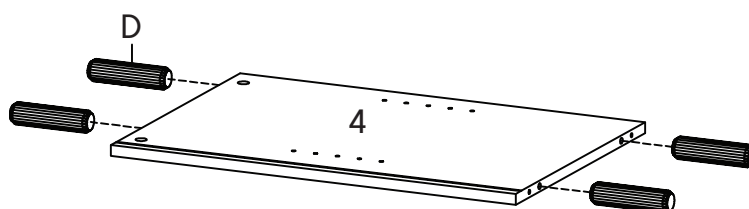
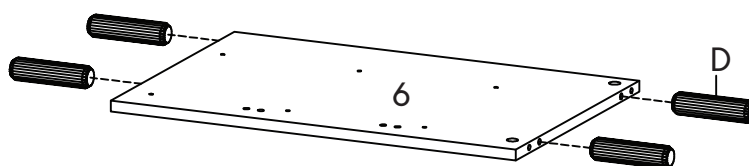
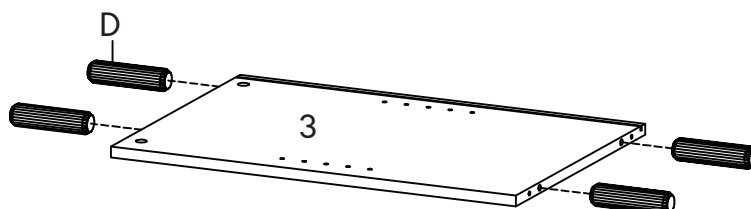
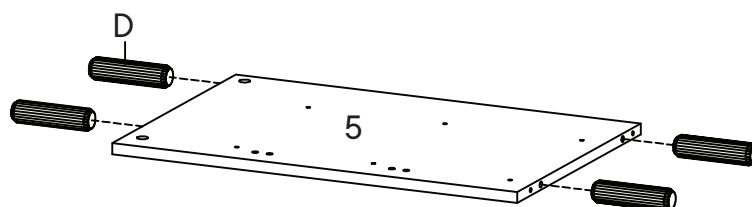
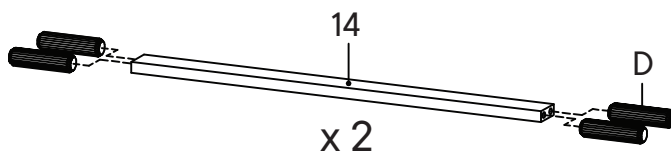

Step 2

HARDWARE

F Screw M 6 x 10.5 mm x12

RM35A Drawer Runner x3

COMPONENTS

5 Center Board Left x1

6 Center Board Right x1

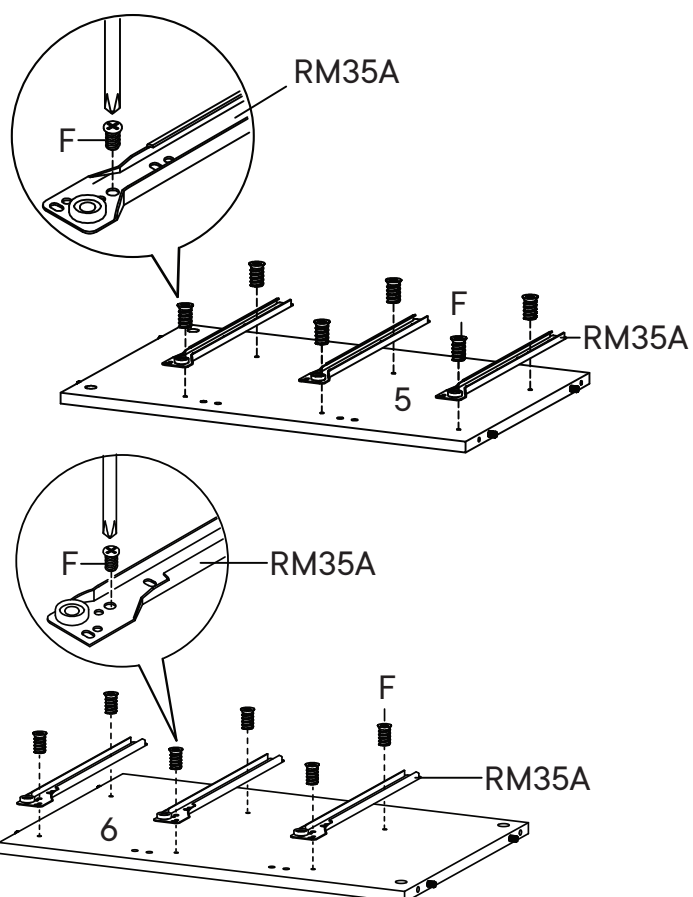

Step 3

COMPONENTS

5 Center Board Left x1

6 Center Board Right x1

14 Front Skirt x2

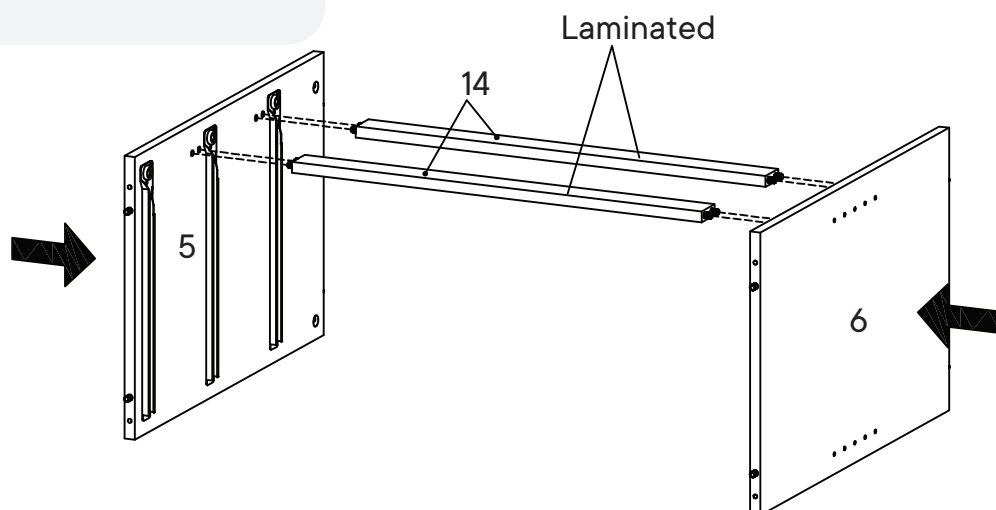

Step 4

HARDWARE

- | | | |
|---|-------------------|----|
| I | Screw M 7 x 50 mm | x4 |
| J | Allen Key | x1 |

COMPONENTS

- | | | |
|---|--------------|----|
| 2 | Bottom Board | x1 |
|---|--------------|----|

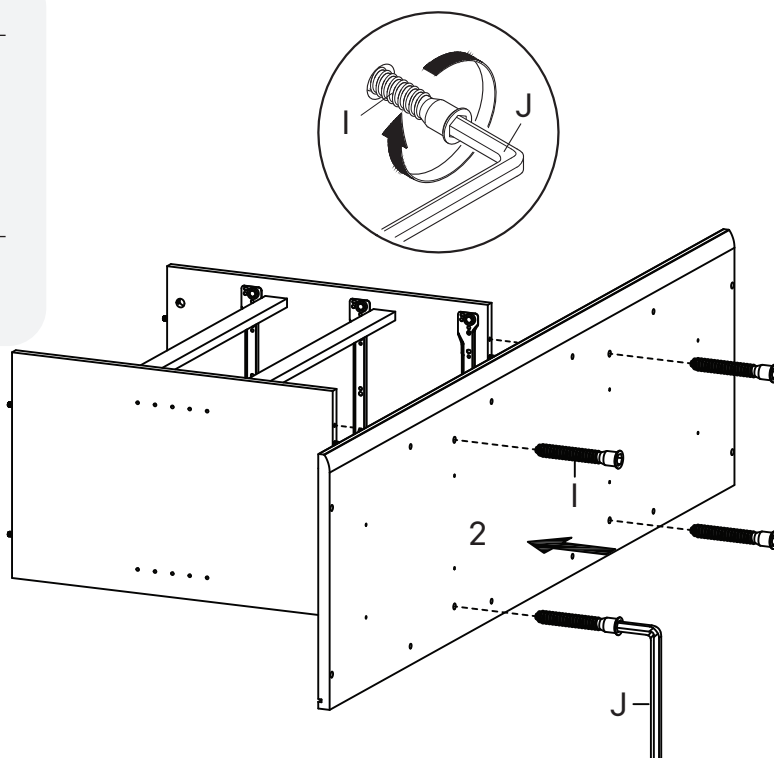

Step 5

HARDWARE

- | | | |
|---|-------------------|----|
| I | Screw M 7 x 50 mm | x4 |
| J | Allen Key | x1 |

COMPONENTS

- | | | |
|---|------------------|----|
| 3 | Side Board Left | x1 |
| 4 | Side Board Right | x1 |

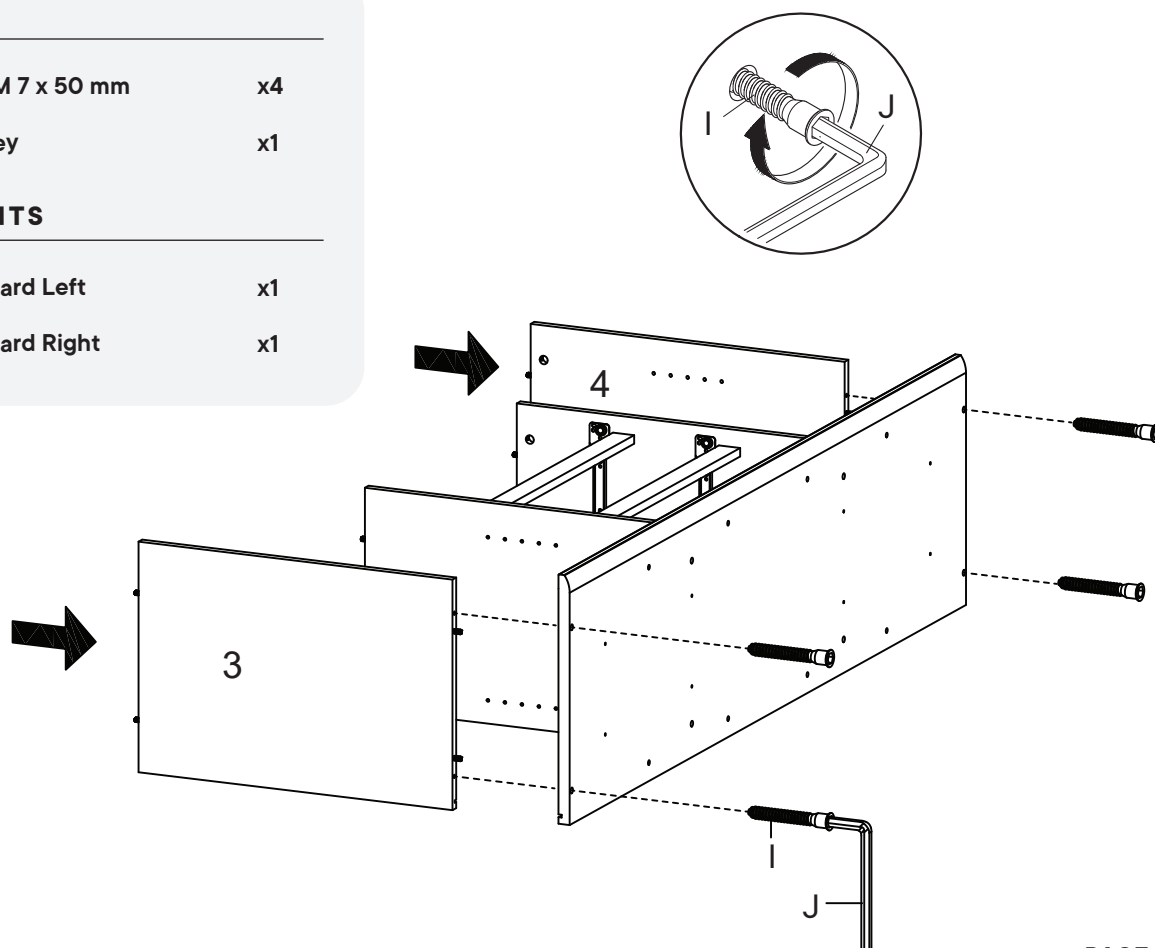

Step 6

HARDWARE

- | | | |
|----------|-----------------------|-----|
| A | Cam Bolt Ø6 x 35 mm | x4 |
| D | Wood Dowel Ø8 x 30 mm | x26 |

COMPONENTS

- | | | |
|-----------|-----------------|----|
| 7 | Assembly Leg | x2 |
| 8 | Support Board 1 | x2 |
| 9 | Support Board 2 | x2 |
| 10 | Support Board 3 | x2 |
| 11 | Center Leg | x2 |

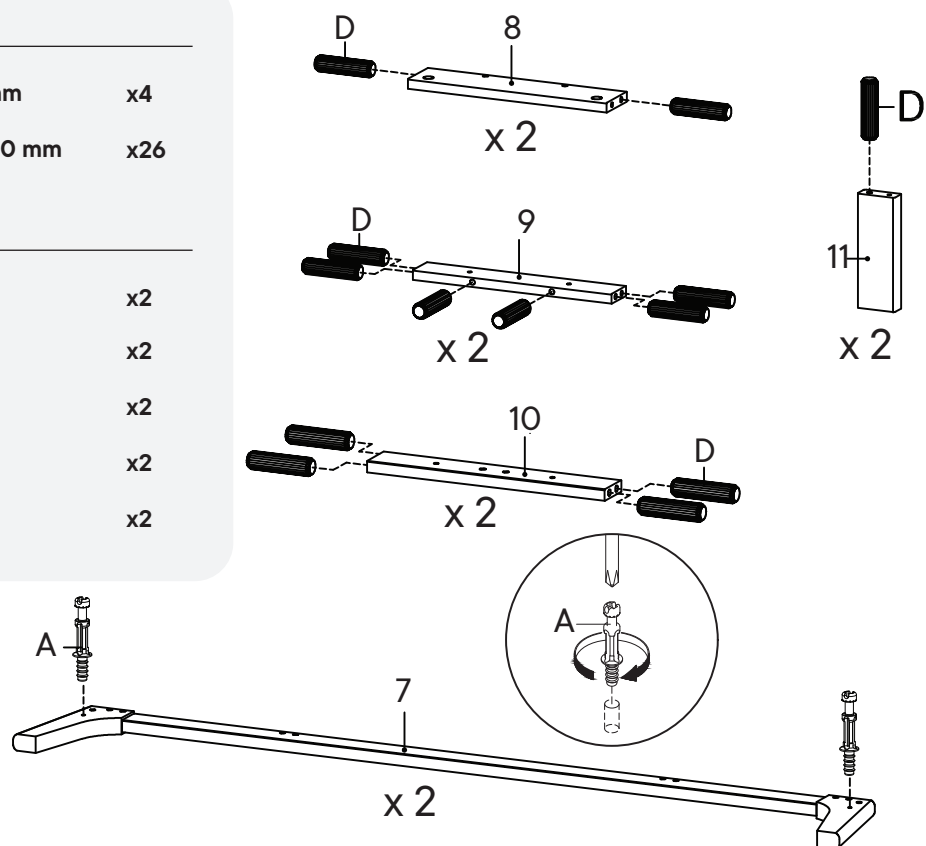

Step 7

HARDWARE

- | | | |
|----------|-------------------|----|
| I | Screw M 7 x 50 mm | x2 |
| J | Allen Key | x1 |

COMPONENTS

- | | | |
|-----------|-----------------|----|
| 10 | Support Board 3 | x2 |
| 11 | Center Leg | x2 |

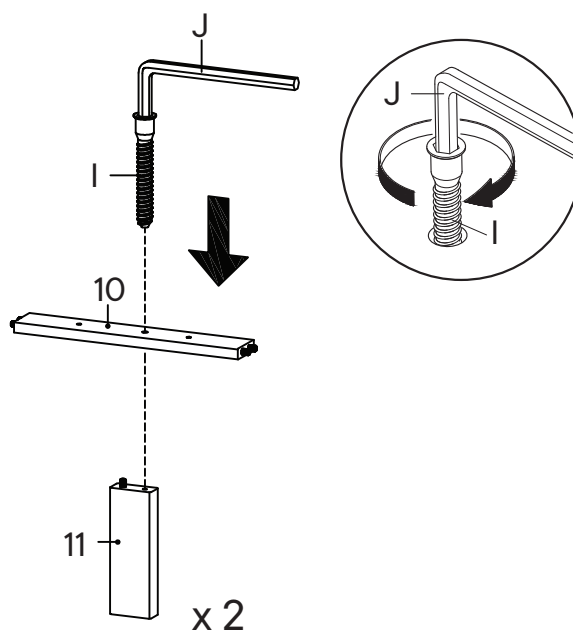

Step 8

HARDWARE

B Cam Lock Ø15 mm x4

COMPONENTS

7 Assembly Leg x2

8 Support Board 1 x2

9 Support Board 2 x2

10 Support Board 3 x2

11 Center Leg x2

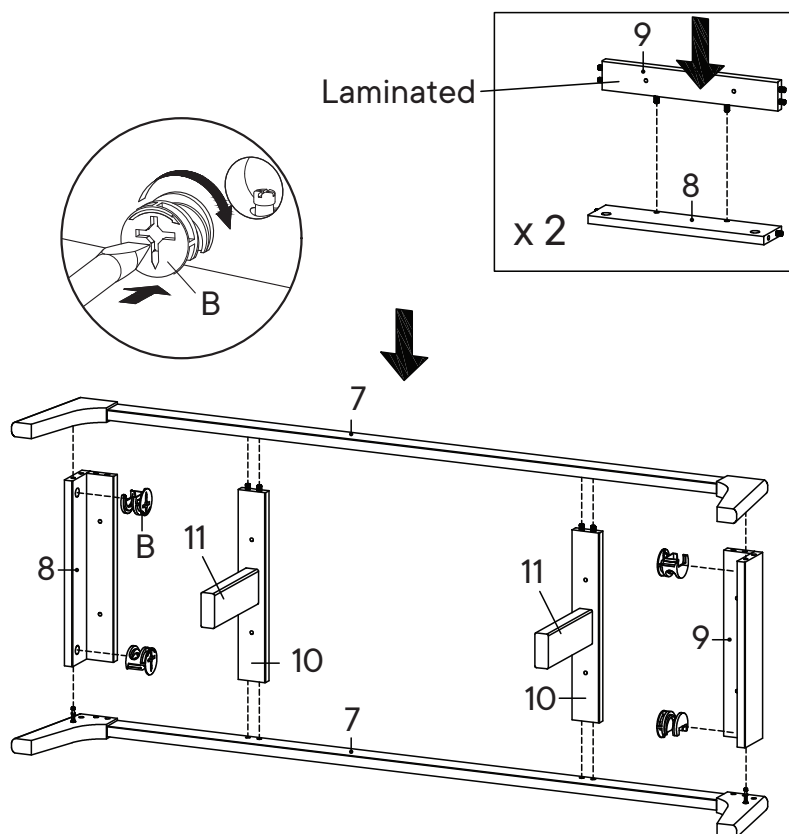

Step 9

HARDWARE

D Wood Dowel Ø8 x 30 mm x8

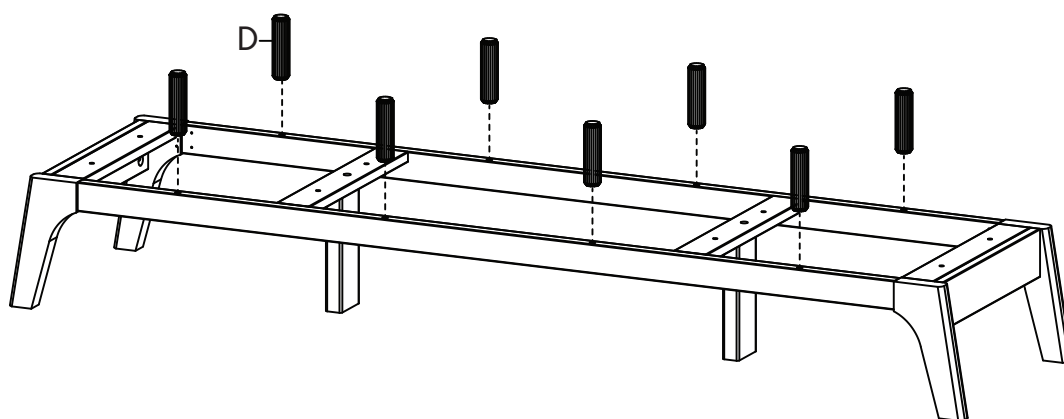

Step 10

HARDWARE

- | | | |
|----------|-------------------|----|
| M | Floor Protector | x6 |
| S | Screw 5.5 x 35 mm | x8 |

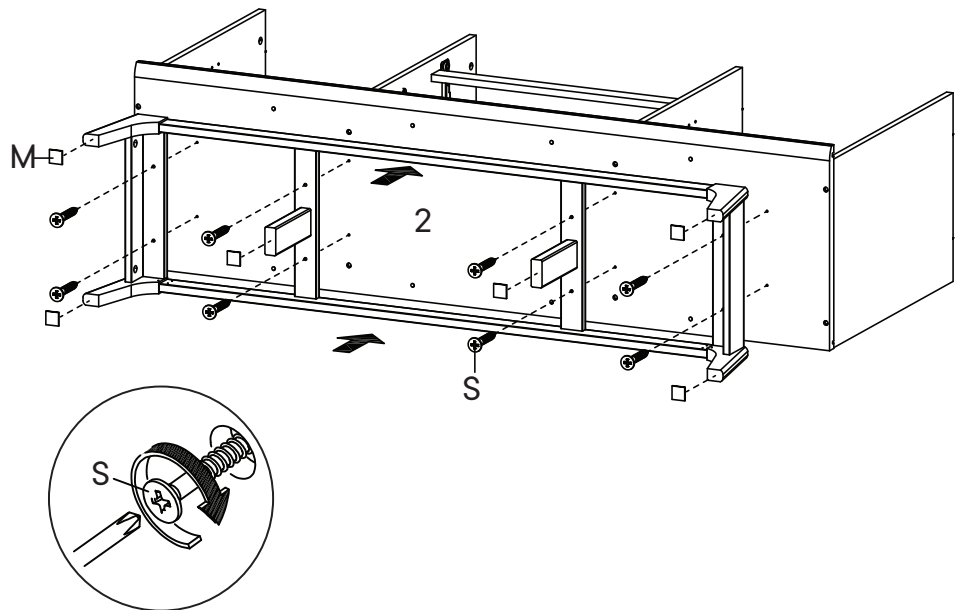
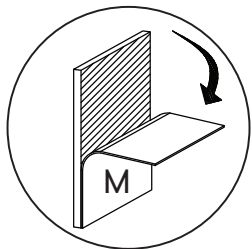

Step 11

COMPONENTS

- | | | |
|-----------|--------------|----|
| 20 | Back Board 1 | x2 |
| 21 | Back Board 2 | x2 |

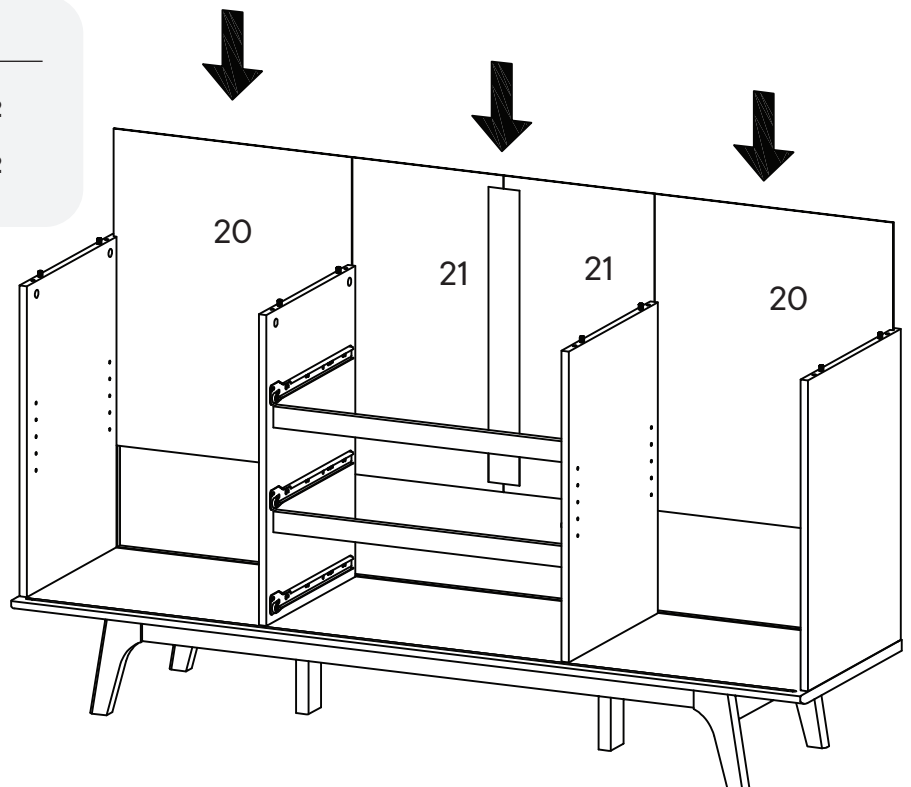

Step 12

HARDWARE

B Cam Lock Ø15 mm x8

N Screw Cap Ø15 mm x4

COMPONENTS

1 Top Board x1

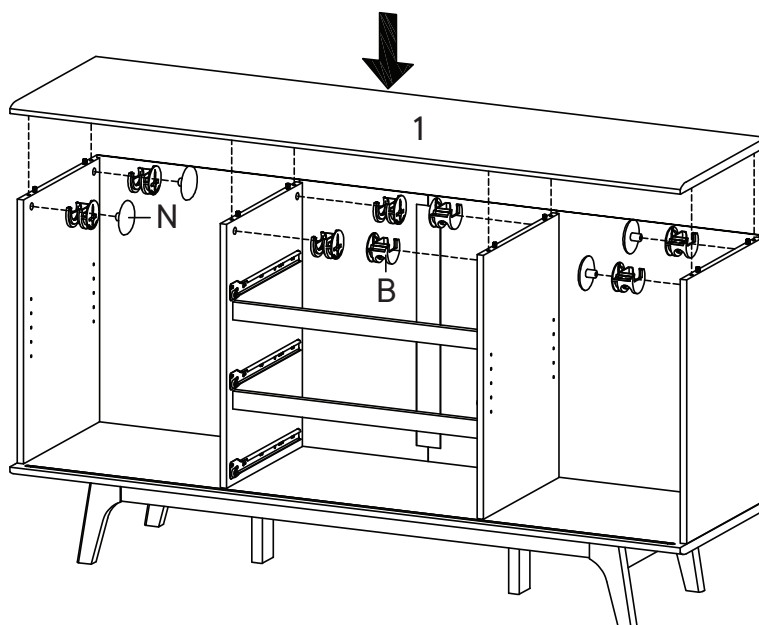
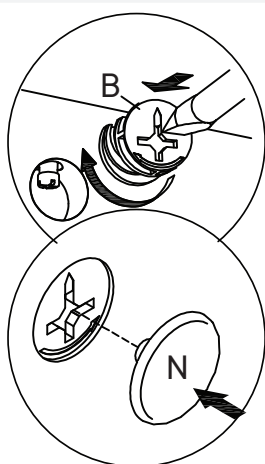

Step 13

HARDWARE

R Shelf Pin x8

COMPONENT

13 Adjustable Shelf x2

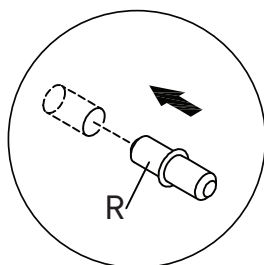

Laminated

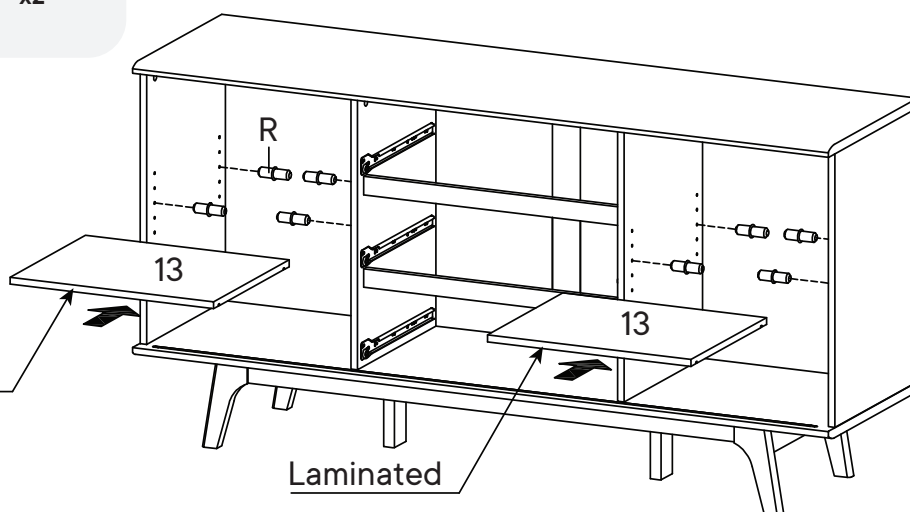

Step 14

HARDWARE

A Cam Bolt Ø6 x 35 mm x6

O Wood Dowel Ø6 x 30 mm x6

COMPONENTS

15 Front Drawer x3

16 Side Drawer Left x3

17 Side Drawer Right x3

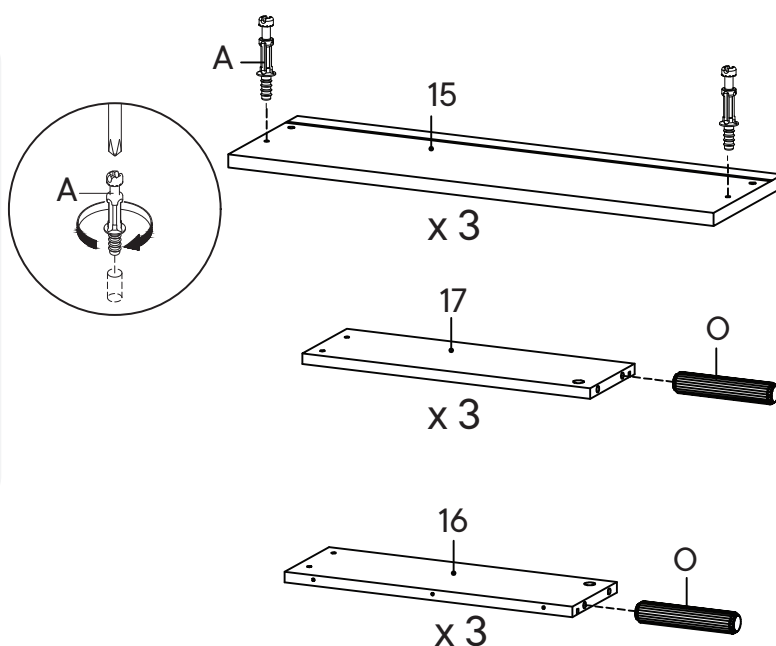

Step 15

HARDWARE

C Cam Lock Ø12 mm x6

P Screw M 8 x 39 mm x12

COMPONENTS

15 Front Drawer x3

16 Side Drawer Left x3

17 Side Drawer Right x3

18 Back Drawer x3

19 Bottom Drawer x3

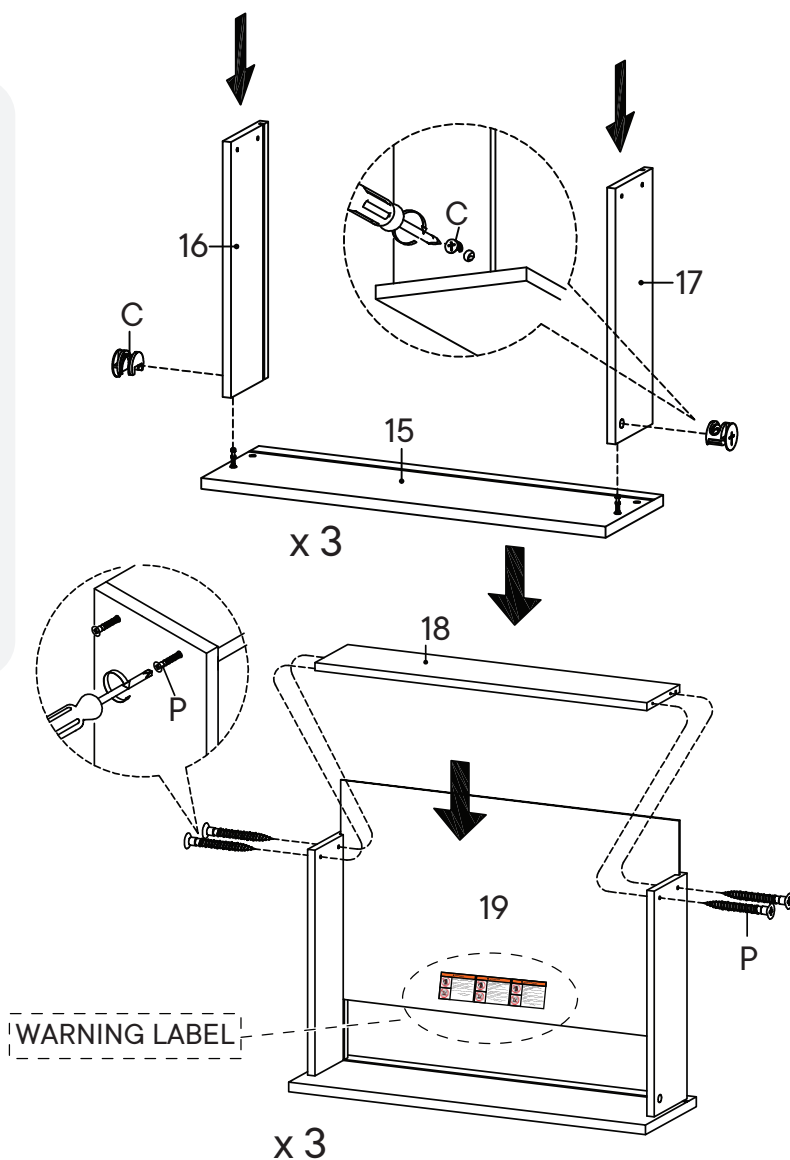

Step 16

HARDWARE

G	Screw M 3.5 x 13 mm	x18
RM35A	Drawer Runner	x3

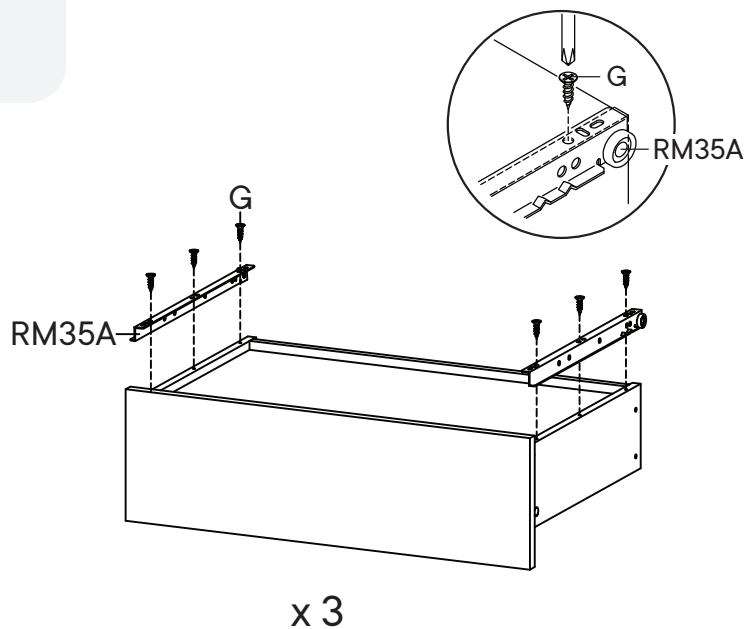

Step 17

HARDWARE

G	Screw M 3.5 x 13 mm	x16
Q	Stopper	x6
U	Sliding Top	x4
V	Sliding Bottom	x4

COMPONENTS

12	Frame Door	x2
-----------	------------	----

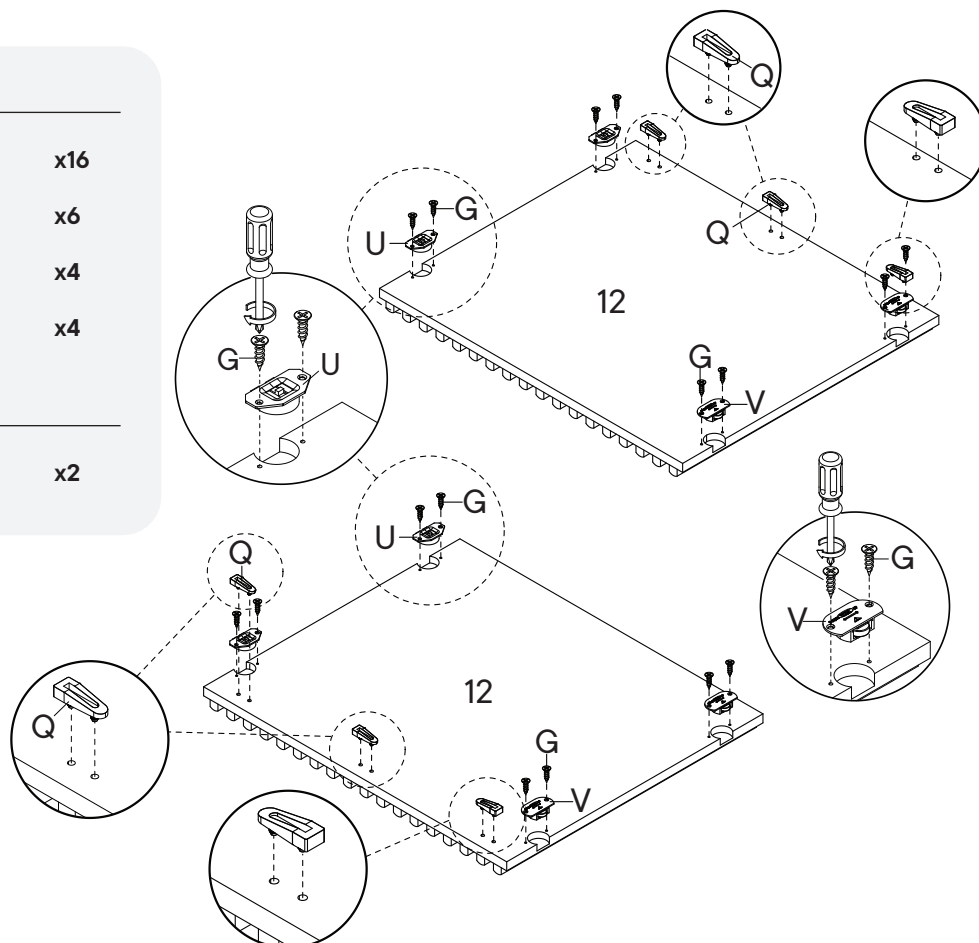

Step 18

HARDWARE

H Silicon Bumper x2

COMPONENTS

12 Frame Door x2

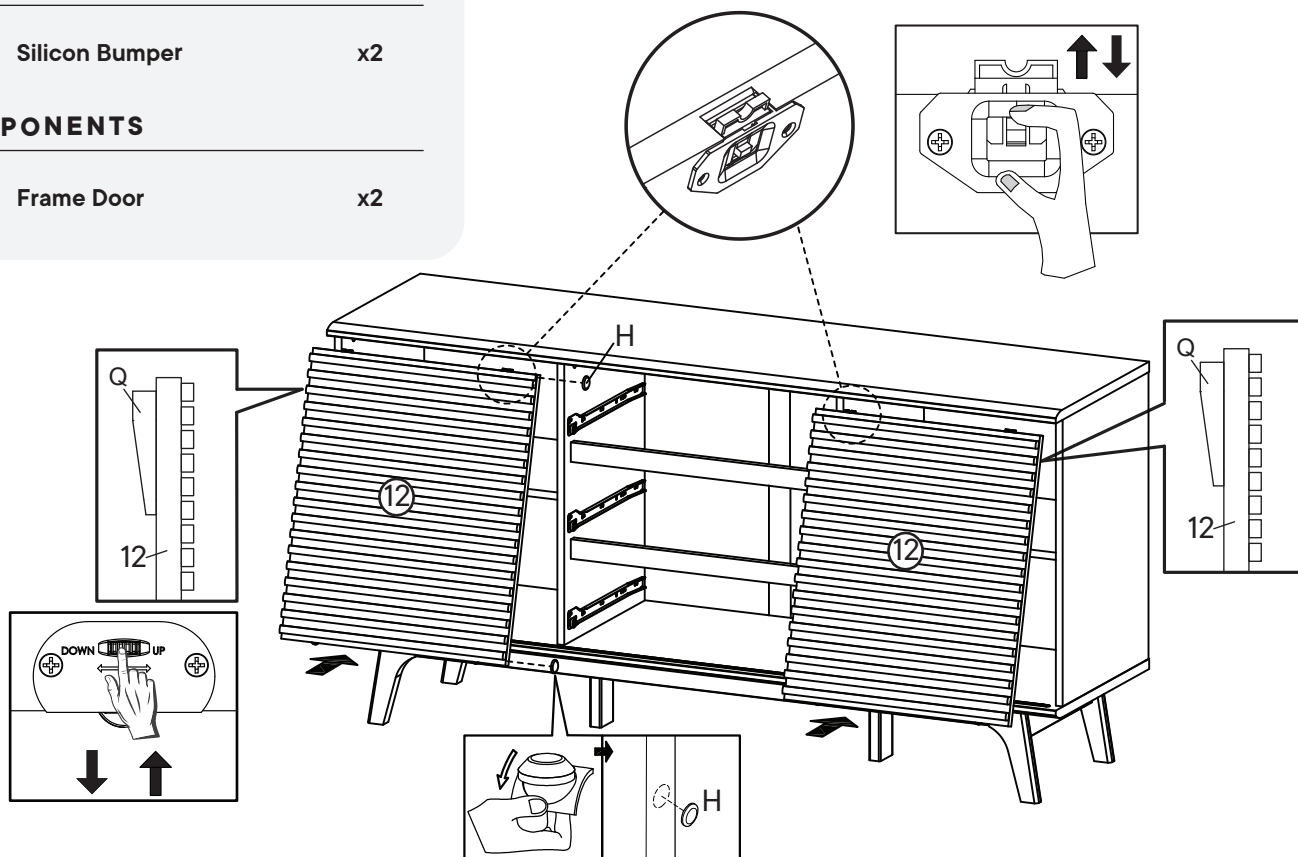

Step 19

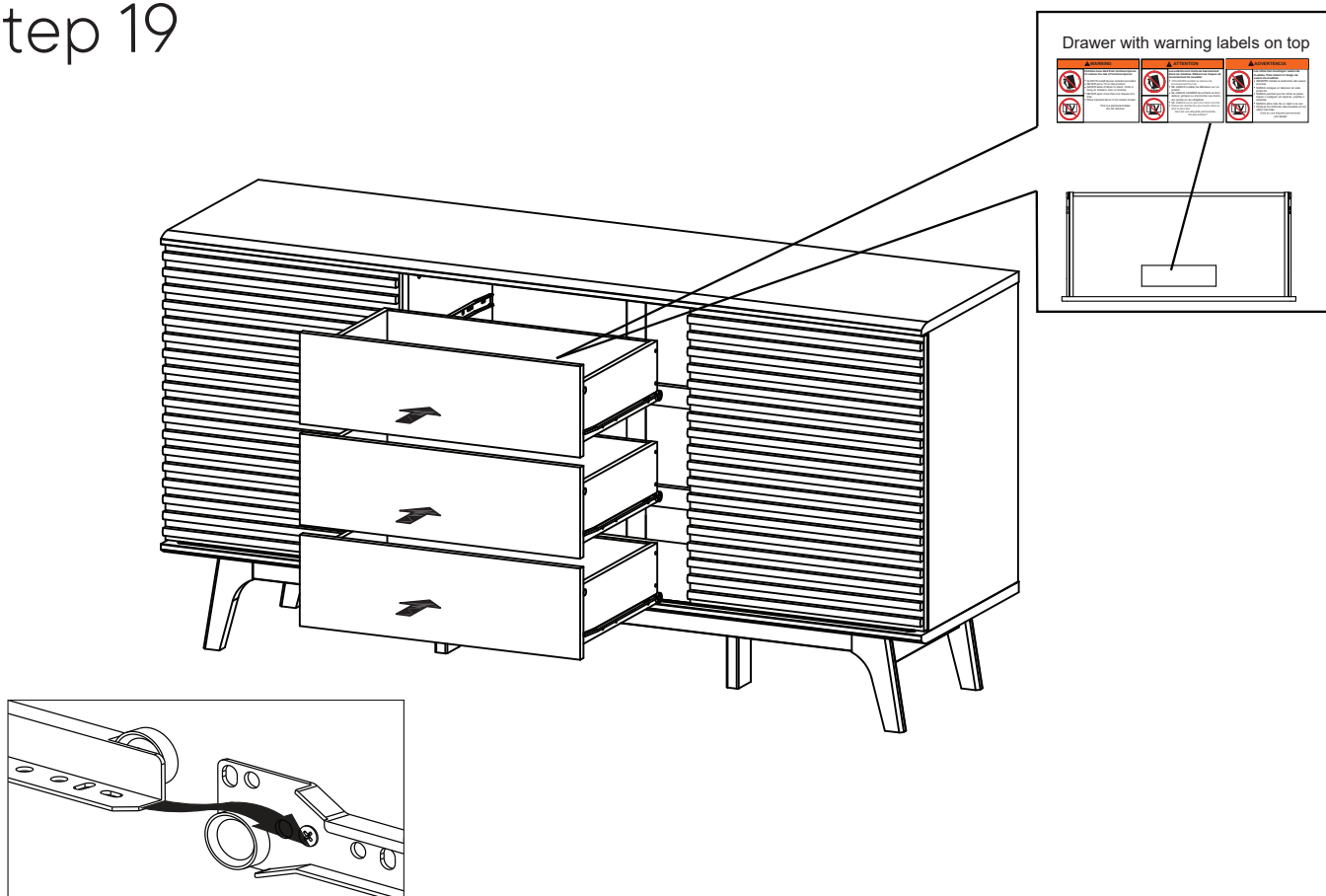

Step 20

HARDWARE

E	Back Panel Holder	x4
K	Wedge	x12
L	Screw M 3.5 x 15.5 mm	x12
T	Screw M 3 x 17 mm	x4

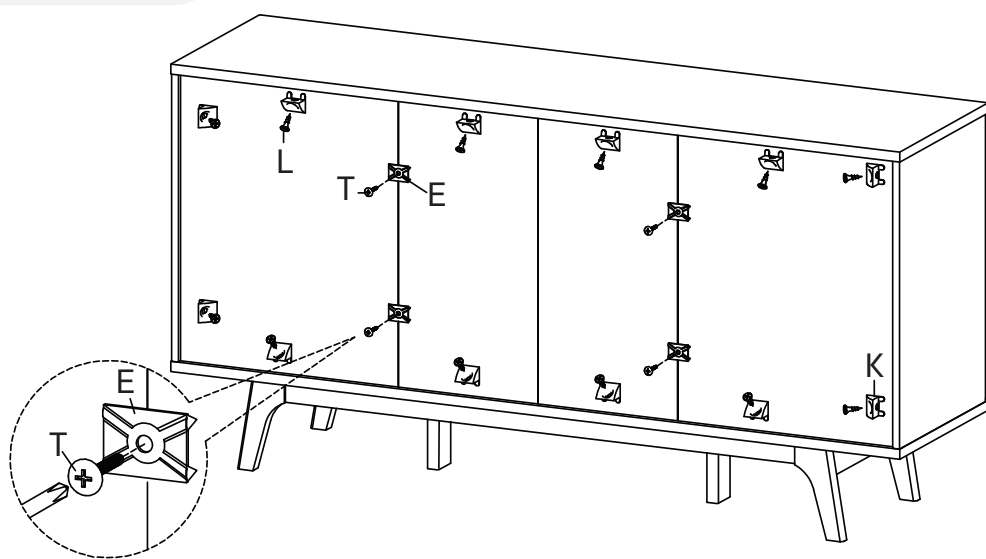
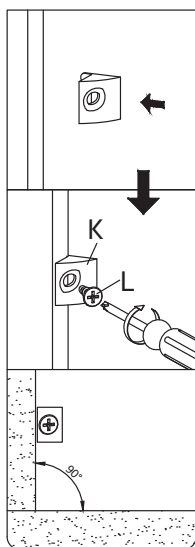

Great job!

Sideboard assembly is complete.

♥ CARING FOR YOUR ITEM

Indoor use only.

Not contract grade.

Clean using a non-abrasive cloth and a mild cleaner.

Never use harsh chemicals, as they could damage the finish or integrity of the item.

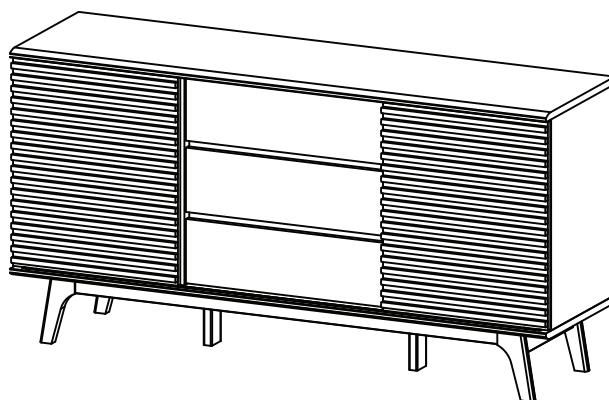

TIPPING RESTRAINTS KIT INSTALLATION GUIDANCE

Different wall materials require unique wall fasteners.

The wall plugs (AA2) and screws (AA3) are designed for fixing to concrete walls only.

Please consult your local hardware store to ensure you are using the correct hardware for your wall type.

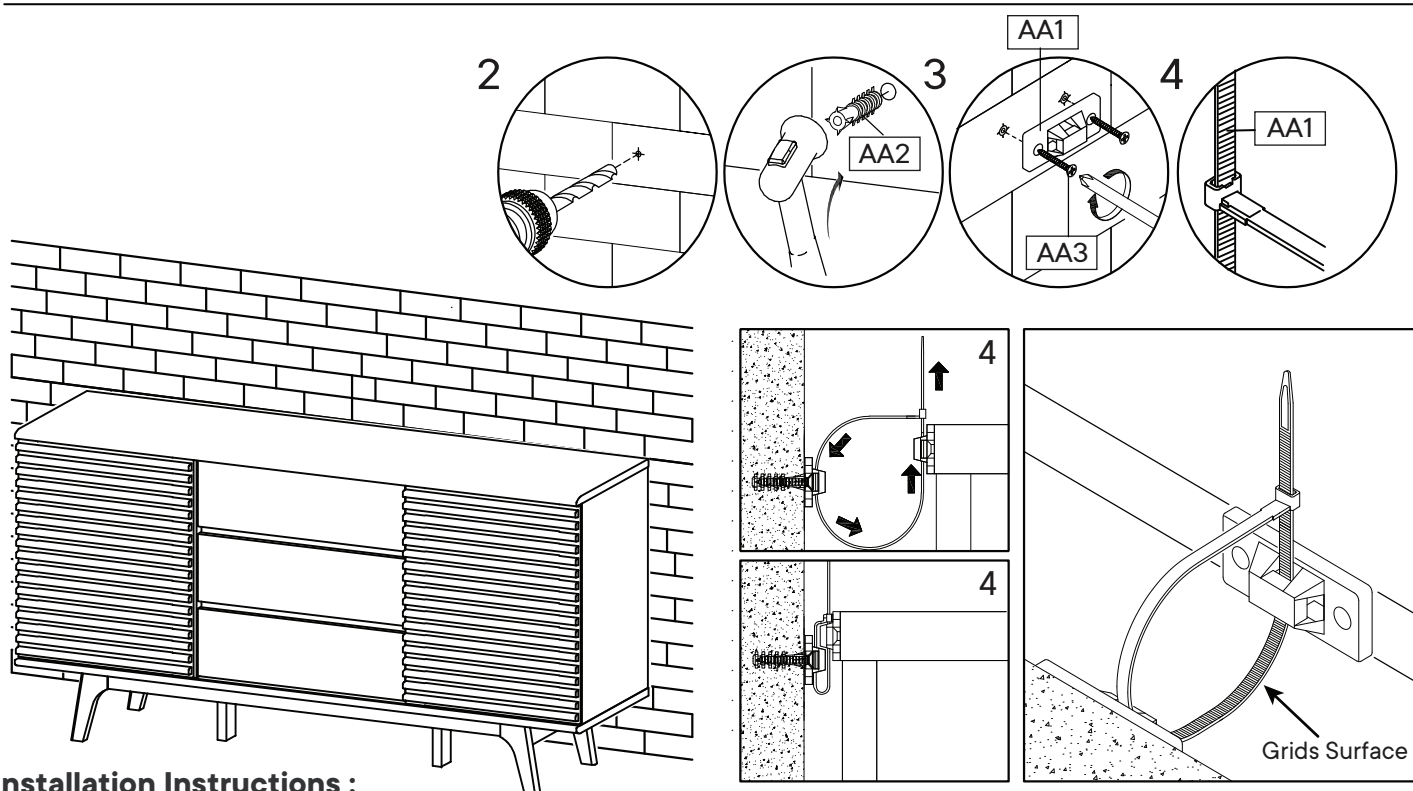
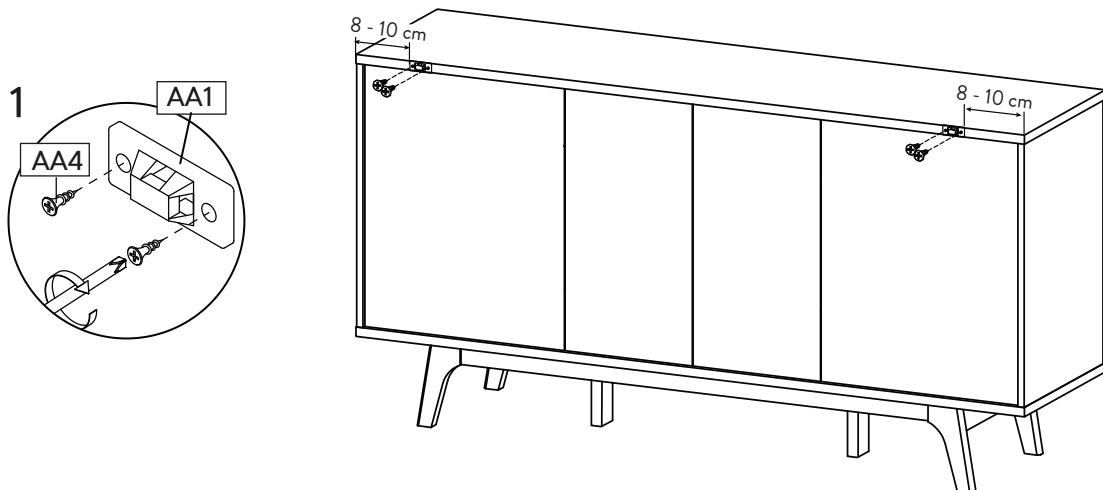
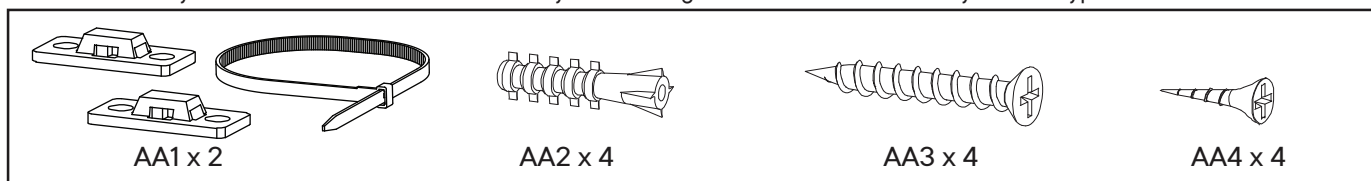

Installation Instructions :

1. Attach bracket (AA1) securely to the back top of the furniture using screw (AA4) provided. Allow 8 - 10 cm from each side.
2. Please make a hole for wall plugs position on the wall and minimum 15 mm below bracket secured to the back of unit attach the wall plugs (AA2).
3. Locate the other bracket (AA1) on the wall over wall plugs (AA2). Place furniture into position so both brackets (AA1) are vertically in the line.
4. Lace the end of the restraints strap through the larger hole in each bracket. Ensure the restraints strap with grids surface facing the inner loops. Bring both ends together and slide the flat end through the locking end and draw it through until all slack is removed.
5. Make sure that the strap is securely laced & locked.