

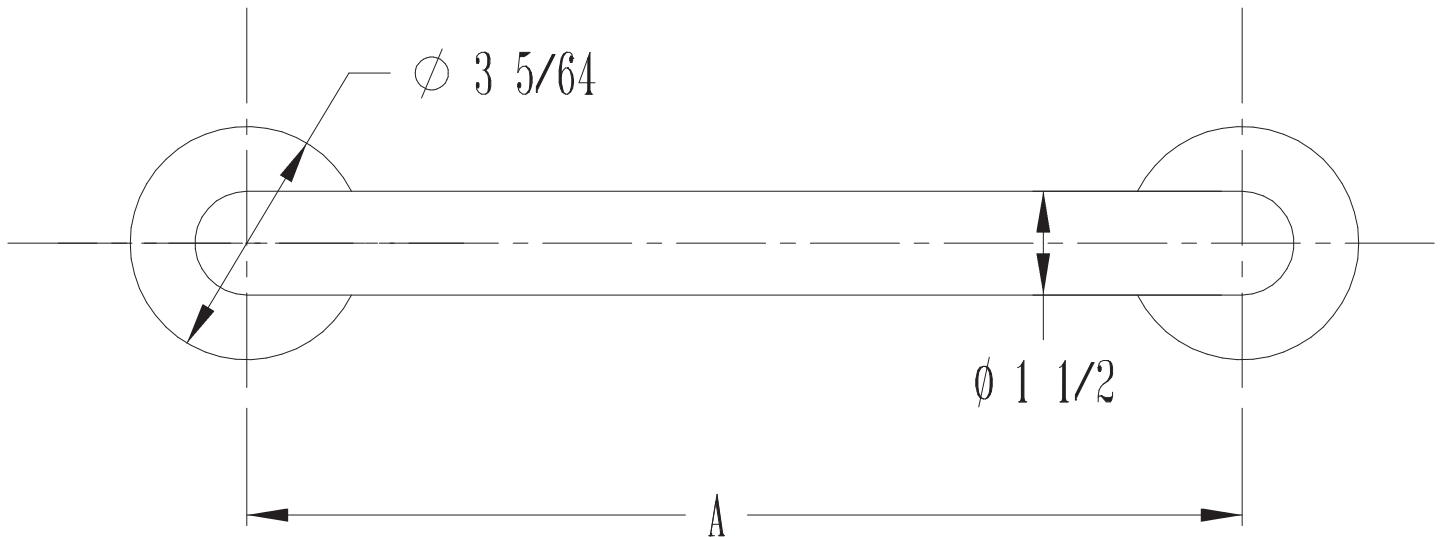

DESIGNER GRAB BARS / SAFETY RAILS

POLISHED STAINLESS STEEL GRAB BAR SERIES



* All Dimensions are in Inches

SKU	A
PP1906PS	12
PP1907PS	16
PP1908PS	18
PP1909PS	24
PP1910PS	36
PP1911PS	42

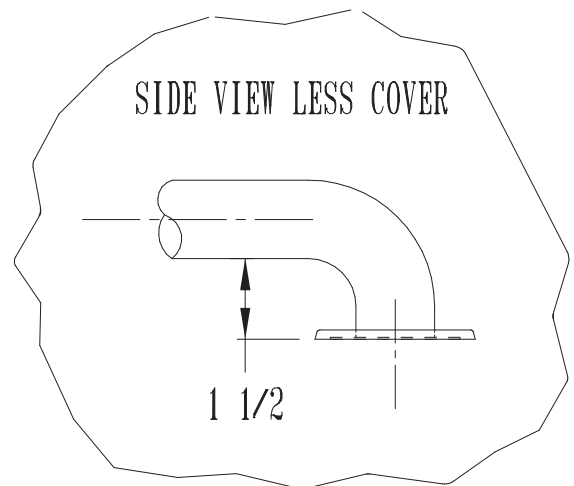

- Complies with the Americans with Disabilities Act (ADA) when properly installed, sized, and located.
- High Quality 18 Gauge 304 Stainless Steel
- Includes (2) 3" Flange Covers and (6) 2" Stainless Steel Screws

LIMITED WARRANTY

If this Keeney product, when used for its intended purpose, fails due to defects in materials or workmanship over a period of one (1) year from the date of original installation, return the item to The Keeney Manufacturing Company (at your expense) where, at our option, we will exchange or recondition the item free of charge. We require a proof of purchase. For full warranty details visit keeneymfg.com/warranty

www.keeneymfg.com | ncs@upt.com | (800) 243-0526