

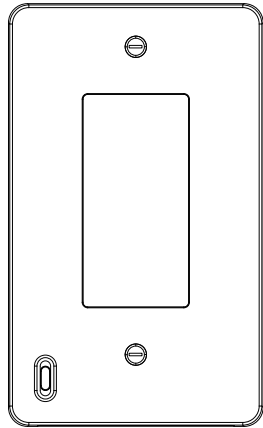

RADAR SENSOR SWITCH PLATE USER GUIDE



Model No.: AK-SW-NS

Specifications

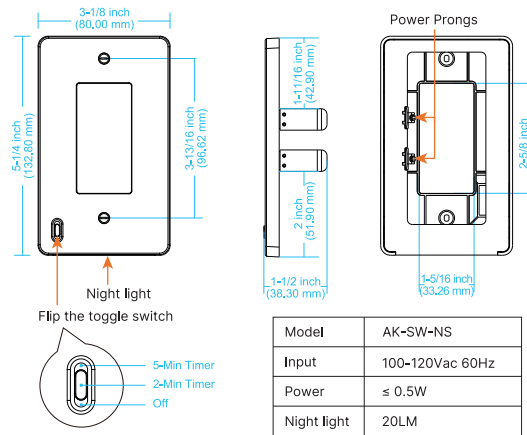

Safety Information

Please read all instructions and warnings carefully before installation and operate correctly according to the instructions.

⚠ WARNING

TO PREVENT FIRE, ELECTRIC SHOCK, OR FATAL ACCIDENTS, ALWAYS TURN OFF THE CIRCUIT BREAKER OR FUSE, AND VERIFY THAT THE POWER SUPPLY IS DEACTIVATED BEFORE INSTALLING OR REMOVING THE RADAR SENSOR SWITCH PLATE.

How Radar Sensor Switch Plate Work

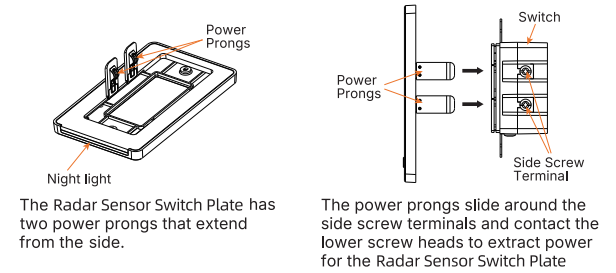

Install Radar Sensor Switch Plate

Step 1: Select the switch to install the radar sensor switch plate. This radar sensor switch plate is only compatible with switches with side screw terminals.

Step 2: Turn off the power at the circuit breaker and test if the power at the switch is off before removing the existing panel or continuing the installation.

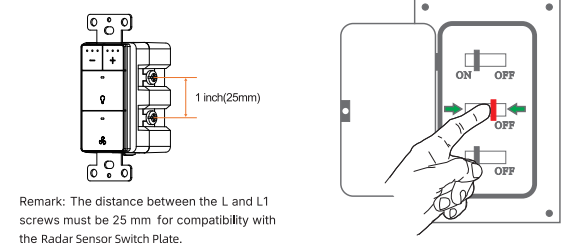

1

2

Step 3: Remove the existing cover plate from the switch.

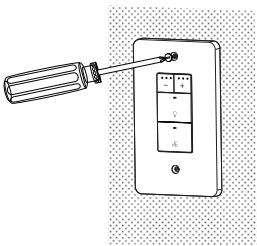

Step 4: Check inside the box to ensure the area around the screw terminals is clear, allowing the prongs to enter the box smoothly.

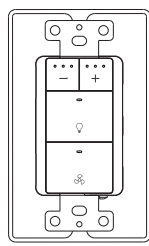

Step 5: If clear, place the radar sensor switch plate onto the switch and secure it with screws. Ensure the power prongs can slide into the electrical box.

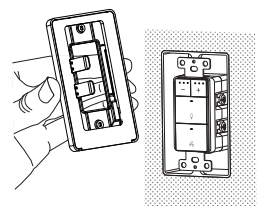

Step 6: Turn on the power at the circuit breaker, dim the room, and stand in front of the radar sensor switch plate to test its functionality.

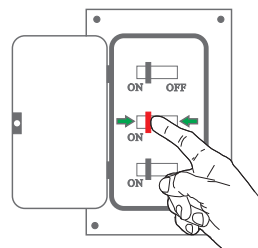

Note: The radar sensor switch plate will deactivate when the light controlled by a physical or smart switch is turned on.

3

Switch Plate Function Definition

Step 7: The radar sensor switch plate is now installed. Please use the toggle switch on the device to customize the working time of LEDs after motion is no longer detected.

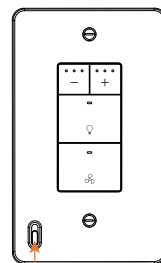

Flip the toggle switch

- The toggle switch is in the bottom position by default. When toggled upwards in sequence: → Radar off → First gear → Second gear.
 - When the radar is off: The switch plate light cannot be controlled and remain constantly off.
 - First gear: Radar default trigger hold duration 2min
 - Second gear: Radar default trigger hold duration 5min
 - Factory default: First gear, middle position.

- This product is equipped with a light sensor function: during the day, when the light intensity is greater than 20 lux, the radar cannot be triggered to turn on the lights. The radar can only be triggered to turn on the lights when the light intensity is below 20 lux.

Compatible Switch

Please note that this radar sensor switch plate is specifically designed for standard single-pole switches (with side screw terminals), which account for the vast majority of households in North America. Below are some examples of standard switches. This product is not compatible with non-standard switches, and you will need to select other compatible switches for the radar sensor switch plate.

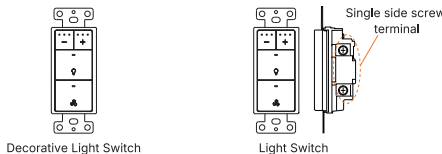

4

THANKS!

Thanks for choosing AKICON.

Limited 3-Year Warranty

This device is warranted to be free of material and workmanship defects for 3 years from the date of purchase. Original receipt or proof of purchase from an authorized retailer must be presented upon warranty claim. ALL claims must be verified and approved by Akicon, Inc. Warranties from other Akicon products may vary. This warranty is nontransferable and does not cover normal wear and tear or any malfunction, failure, or defect resulting from misuse, abuse, neglect, alteration, modification, or improper installation.

Questions, problems, or missing parts?

Contact AKICON Customer Service before returning the product.

Service Hours: Monday–Friday, 8:00 a.m.–6:00 p.m. EST

☎ +1-888-828-2025 (Toll-Free)

✉ service@akiconhvac.com

🌐 akiconhvac.com



Made in China