

PET FENCE INSTALLATION INSTRUCTIONS



Pet fences come in two sizes. Installation steps are identical except for size differences. This manual demonstrates installation for the large pet fence only.

Style 01: 43.7 x 29.5 x 22.5 Inch

Style 02: 57.9 x 29.5 x 22.5 Inch



A

PP Fence panel

x 4



B

Iron Door Frame

x 2

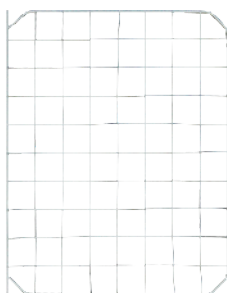

C

Wire gate

x 1

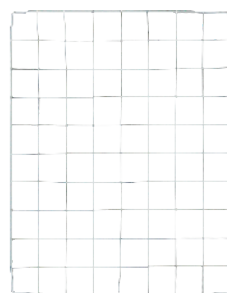

D

Wire fence

Style 01 **x 6**
Style 02 **x 8**



E

Top panel

x 2



L

Cable ties

x 1



F

Perimeter door railing

Style 01 **x 12**
Style 02 **x 14**



G

Plastic door lock

x 4



H

4-way connector

x several



I

8-way connector

x 2



J

Plastic mallet

x 1



K

Transparent adhesive

x 1

- **H: 4-way connector is used to fix around each corner**
- **I: 8-way connector is used on both sides of the door frame**



Step 1: Lay an **H** flat on the ground. Then slide an **A** horizontally into its groove.



Step 2: Take another **A** and slide it into the other groove on the same **H**.



Step 3: Use **H** to secure each corner.

Note: Place bottom **H** horizontally and top ones vertically. Leave their slots open for installing **F** later.

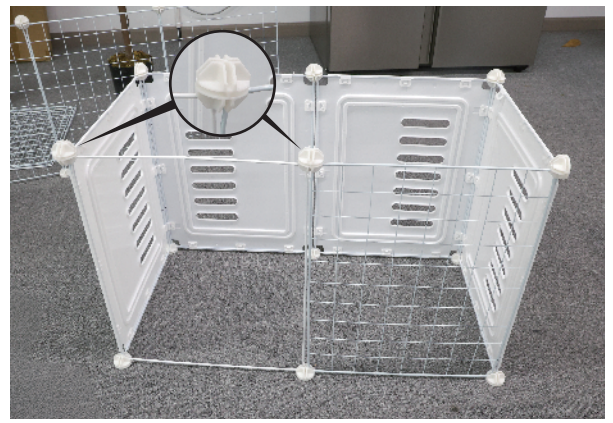

Step 4: Take one **B** and one **D**. Snap them into the left and right sides as shown.

Note: Use **I** to secure both sides of **B** into the slots.



Step 5: Install **E** by snapping it into the groove.

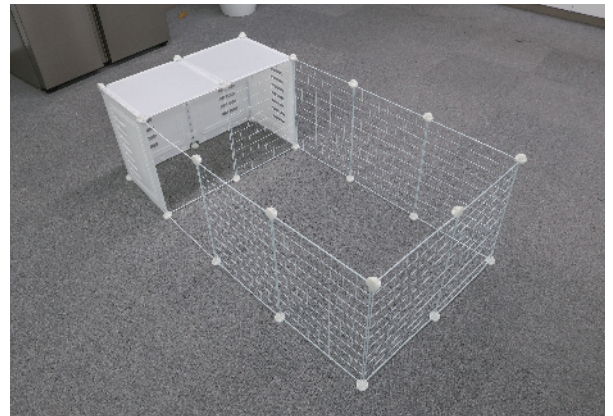

Step 6: Repeat Steps 1 - 5 to complete the entire fence frame.

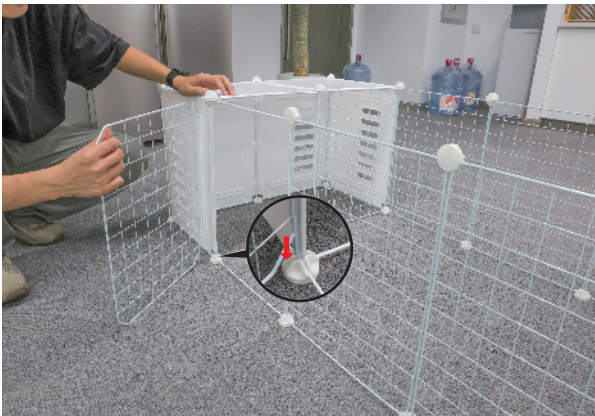

Step 7: Install **C**.

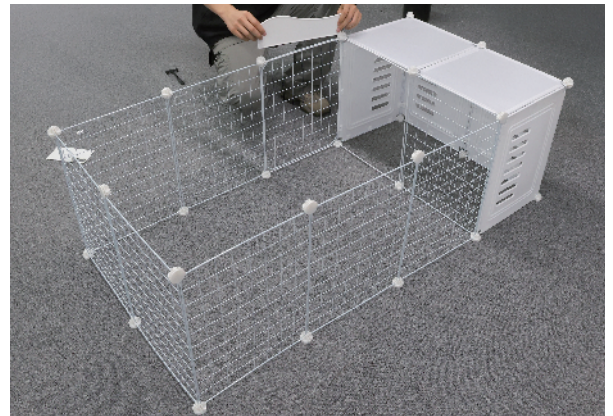

Step 8: Install **F** and secure the top rail in a continuous loop.

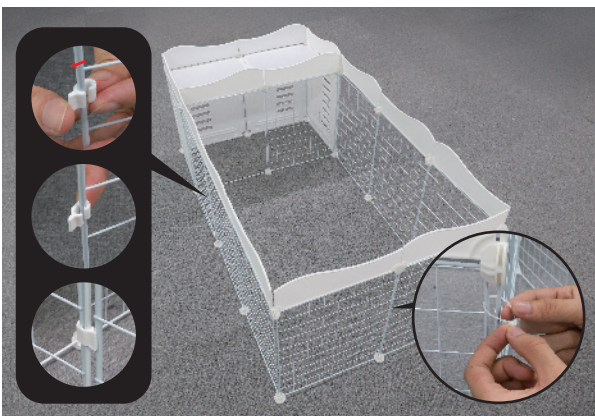

Step 9: Install **G**. First snap it into the slot, then push outward to lock it in place. Meanwhile, reinforce all perimeter wire mesh sections with **L**.

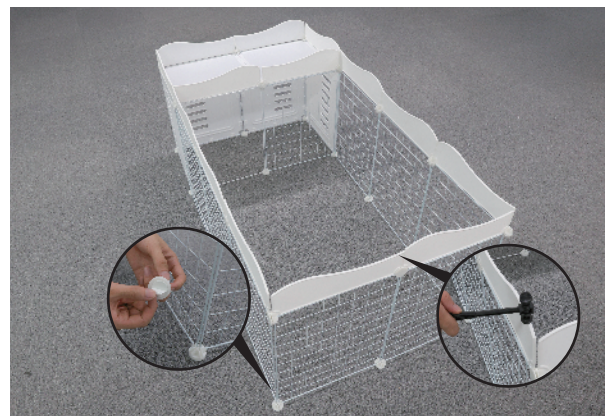

Step 10: Tap any loose perimeter sections with **J** to tighten them. Apply **K** to each bottom **H** to keep the pet fence from shifting.