

Features

- Oval basin.
- Unique overflow drain.
- No faucet holes; requires wall- or counter-mount faucet.

Material

- 20-gauge stainless steel.

Installation

- Under-mount or drop-in.

Required Accessories

K-7114-A Pop-Up Drain

or

K-7126 Pop-up drain

or

K-7124-A Pop-Up Clicker Drain

or

K-7127-A Drain

or

K-7128-A Drain

or

K-7129-A Drain

or

K-7131-A Offset Drain

Recommended Accessories

K-8998 P-Trap

Components

Additional included component/s: Basin clamp assembly, and
Cutout template.



ADA

Codes/Standards

ASME A112.19.3/CSA B45.4

ADA

ICC/ANSI A117.1

Kohler One-Year Limited Warranty

See website for detailed warranty information.

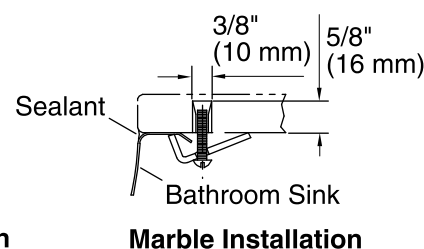
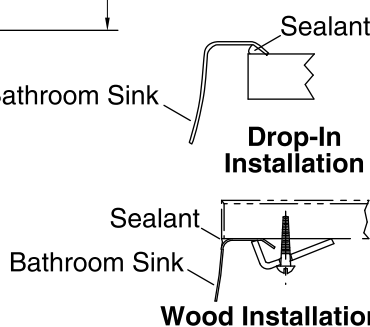
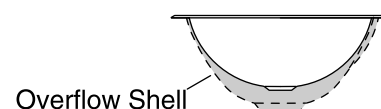
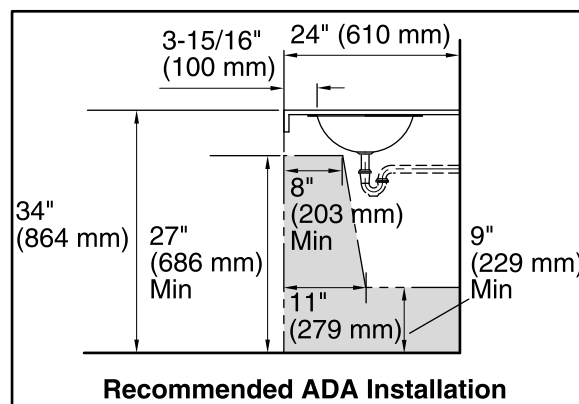
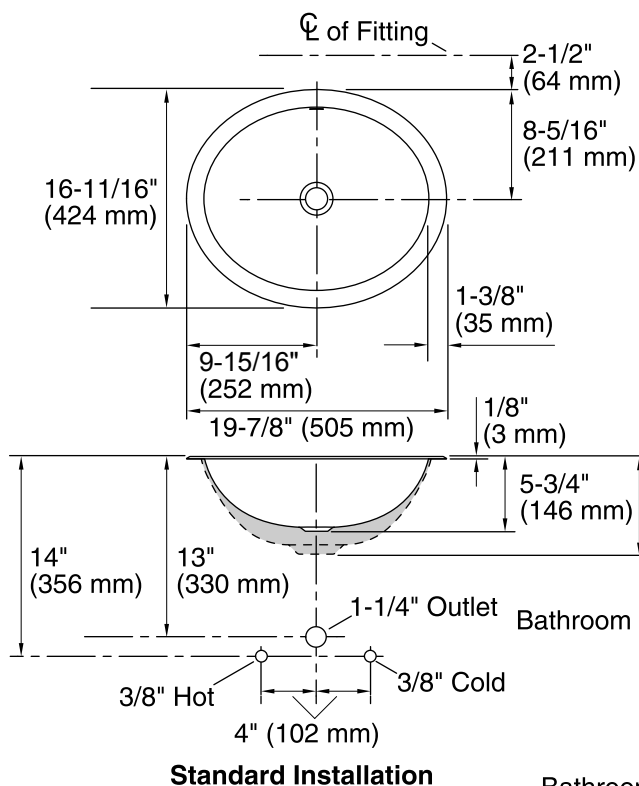

Technical Information

All product dimensions are nominal.

Installation:	Drop-In, Under-mount
Bowl area	Length: 17-1/8" (435 mm) Width: 14" (356 mm) Water depth: 4-1/16" (103 mm)
Drain hole:	1-5/8" (41 mm)
Template:	Drop-in, 1248333-7, not required, not included Under-mount, 1248333-7, not required, not included

Notes

Install this product according to the installation guide.

Installer must supply anchors based on countertop material and thickness.

ADA compliant when installed to the specific requirements of these regulations.