

Interior Cafe/Saloon Door Instructions

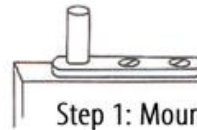

Step 1: Mount top pivot to top of door through pre-drilled holes using machine screws.

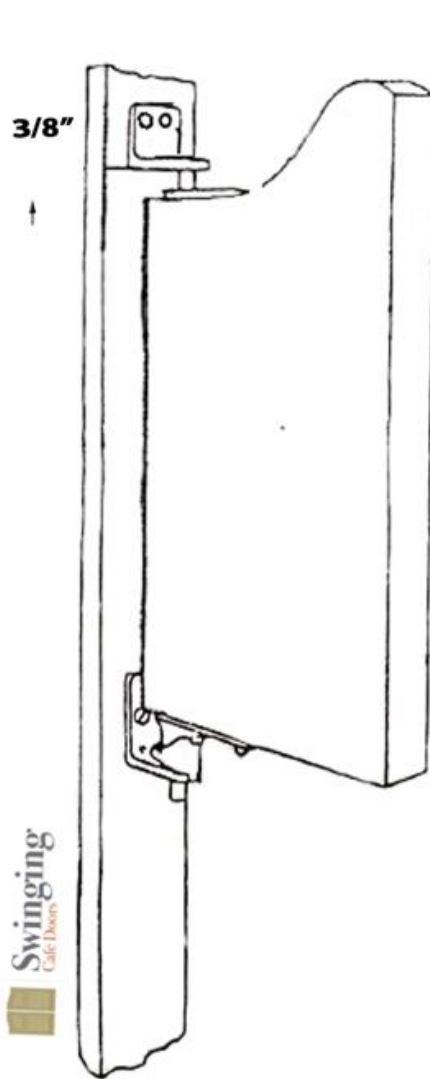
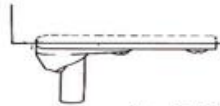

Step 2: Mount bottom pivot to bottom of door through pre-drilled holes using machine screws.



Step 3: Mount bottom bracket to door jamb using Phillips Countersunk screws.



Step 4: Set door into bottom bracket.

Locate screw hole positions for top bracket on door jamb.

Mount top bracket to jamb using round panhead screws, allowing 3/8" height between top bracket and top pivot (see diagram).

This will compensate for the rise of door when swung into open position.

Step 5: Align door by adjusting screw in bottom door plate.

REPEAT PROCESS FOR OTHER DOOR



Top Brackets



Top Pivots



Bottom Pivots



Bottom Brackets



Phillips Countersunk Screws



Round Panhead Screws



Machine Screws