

End Table

Congratulations on the purchase of your End Table. It has been crafted to the highest standards of quality and safety and will give you many years of enjoyment and practical use.

Since this is a natural wood product, there will be variations in color and grain and minor checking may occur. This is normal and does not compromise the integrity of your nightstand. In fact, variation in character of solid hardwood is integral to the beauty and appeal of hardwood furniture and distinguishes it from prefabricated, synthetic and composite materials.

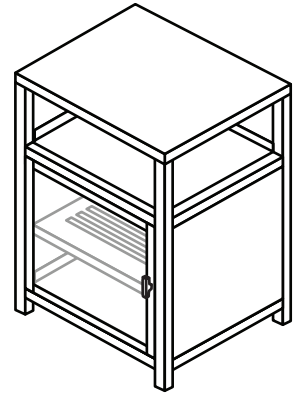

On this insert you will find a list of the hardware and parts included as well as detailed assembly instructions. Assembly is quite simple and requires only a Phillips head screwdriver. Assembly will be most easily accomplished if you take the time to carefully sort the hardware and familiarize yourself with the function of each piece.

If you need assistance with assembly, part replacement or any other matter, please contact the toll-free Customer Service Team. You may also email your request or comments and a customer service representative will respond.

Thank you and Enjoy

HARDWARE & PART LIST

2 **Wooden handles**



2 **Wood screws**

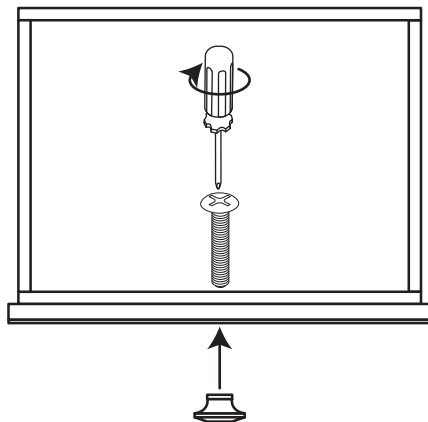

Using a Phillips head screwdriver, remove the wood screw and install the handle on the front of the drawer. Do not turn the handle to tighten or loosen the screw. Doing so will cause the handle to scratch the front of the door.