

INSTRUCTION MANUAL

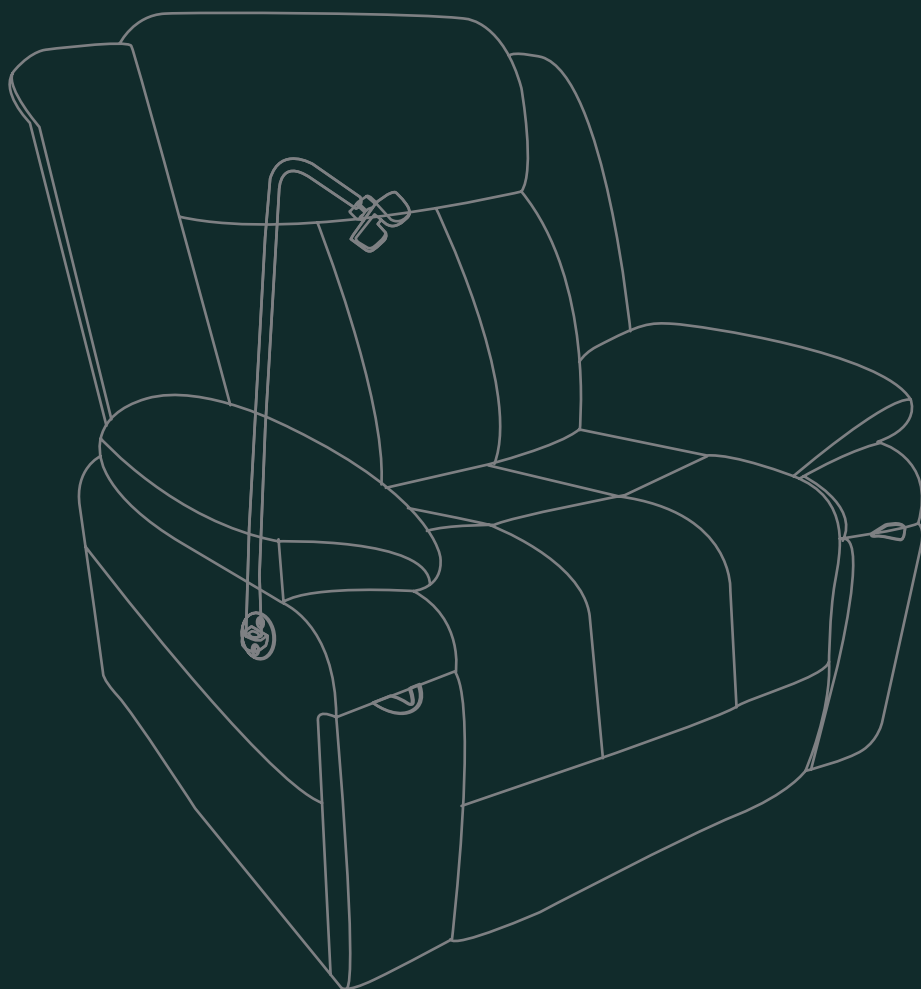

WARNING



Please read the instructions carefully and follow the assembly steps.

To ensure proper assembly, please follow all steps and use all parts provided. Not following this warning may result in serious injury to you or others.

To prevent misalignments, keep the screws loose and do not tighten them until they are all in their correct positions.

Avoid overtightening or forcing the screws, as this could cause them to break, strip, or damage the threads of the holes.

Using the wrong size of screws for a particular part could cause damage to the screw or the part.

Please lubricate all moving parts regularly and tighten all bolts and screws every 6 months, or as needed.

SAFETY INFORMATION

WEIGHT CAPACITY FOR SEATING: 300LBS



Sit in the center of the chair with your back against the backrest



Do not sit at the front edge of the chair



Do not stand on the chair



Do not use the chair with more than one person



Do not push the chair around when a person is sitting in it



Do not push down on the backrest when a person is reclined



Do not place all your weight on the backrest only

ASSEMBLY PARTS AND TOOL

BEFORE YOU GET STARTED, A FEW POINTERS:



Having a friend to help makes assembly extra-easy

A

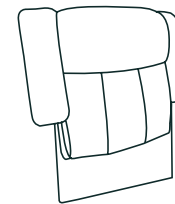

Backrest * 1

B

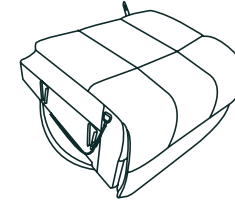

Seat* 1

C



Right Arm * 1

D

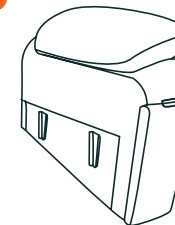

Left Arm * 1

E

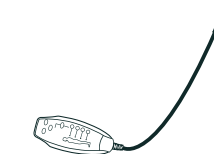

Massage Controller* 1

F



Massage Power Cord* 1

G



Phone Holder Set* 1

H



Holder Nut * 1

I



Open Wrench * 1

ASSEMBLY INSTRUCTIONS

Step 1

Please cut off the fabric ribbon under the bottom of Seat B.
Attach Right Arm C & Left Arm D to Seat B, align the slots on the seat and two arms, press down the arms until the connection is secure.

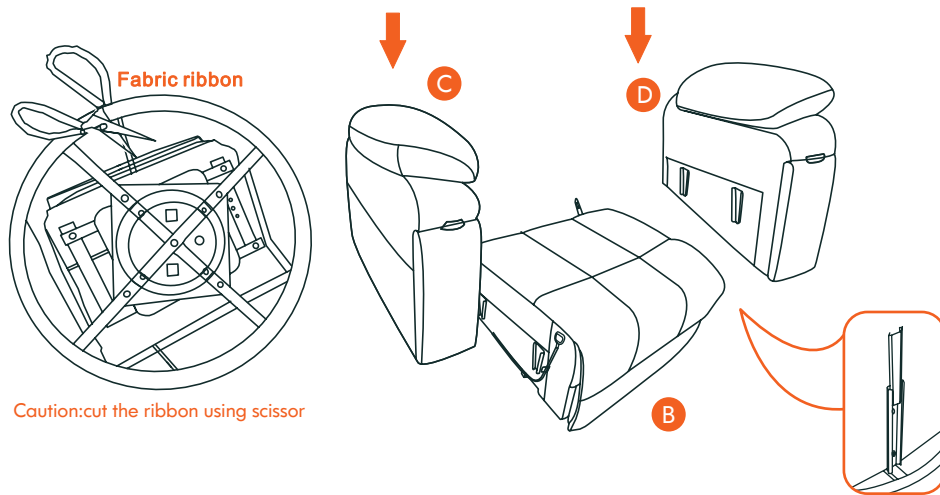

Step 2

Attach Backrest A to the finished sofa base, align the slots on the seat and backrest, press down the backrest until the connection is secure.

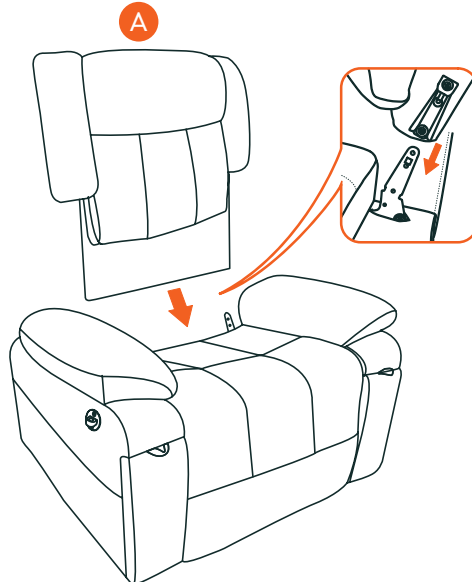

ASSEMBLY INSTRUCTIONS

Step 3

1. Connect Phone Holder Set G, insert the black plastic nut into the holder pole then twist the clip with the nut.
2. Insert Phone Holder Set G into the slot on Right Arm C, using Holder Nut H, tighten by Open Wrench I.

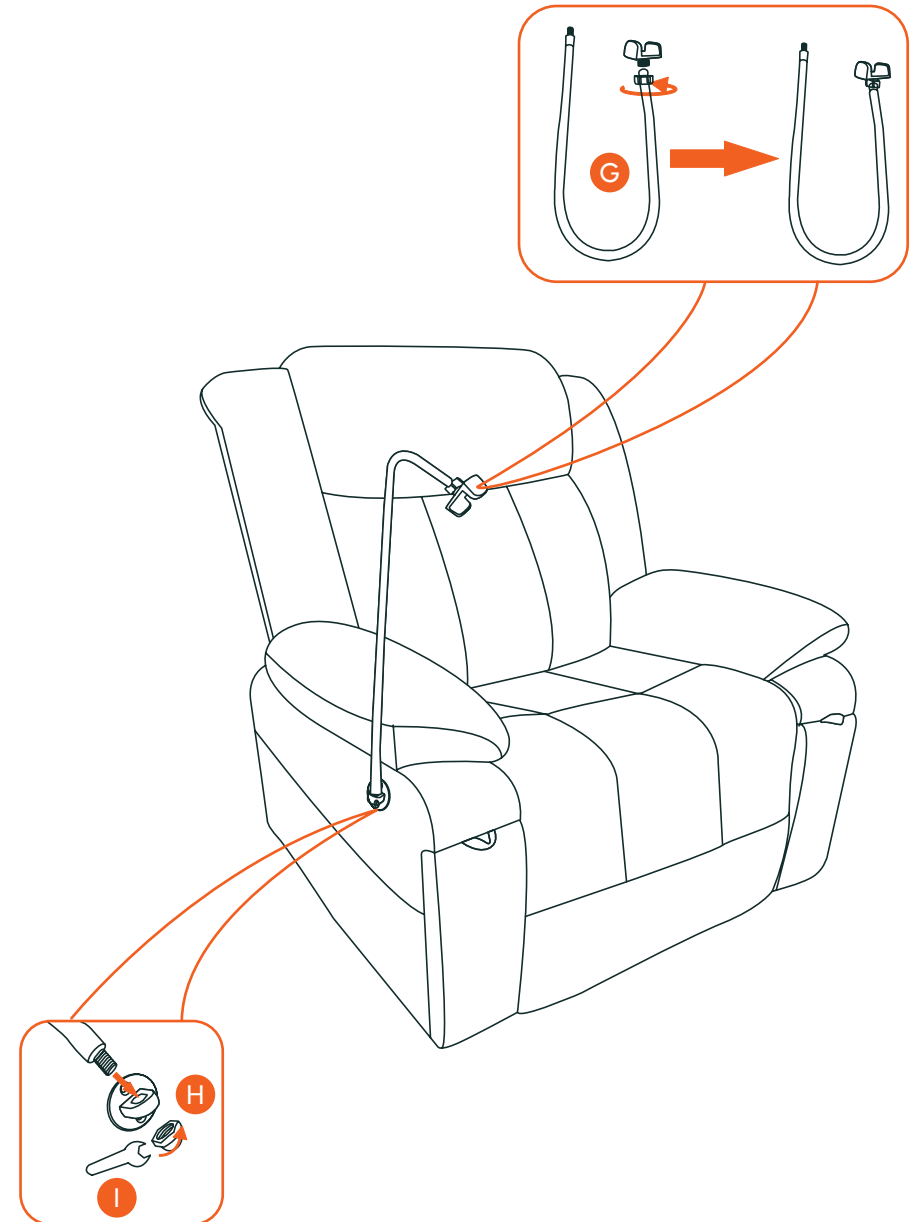

ASSEMBLY INSTRUCTIONS

Step 4

Connect Massage Power Cord F (connect the lines by the same colors), then connect Massage Controller E, and fasten the velcro on the bottom of backside.

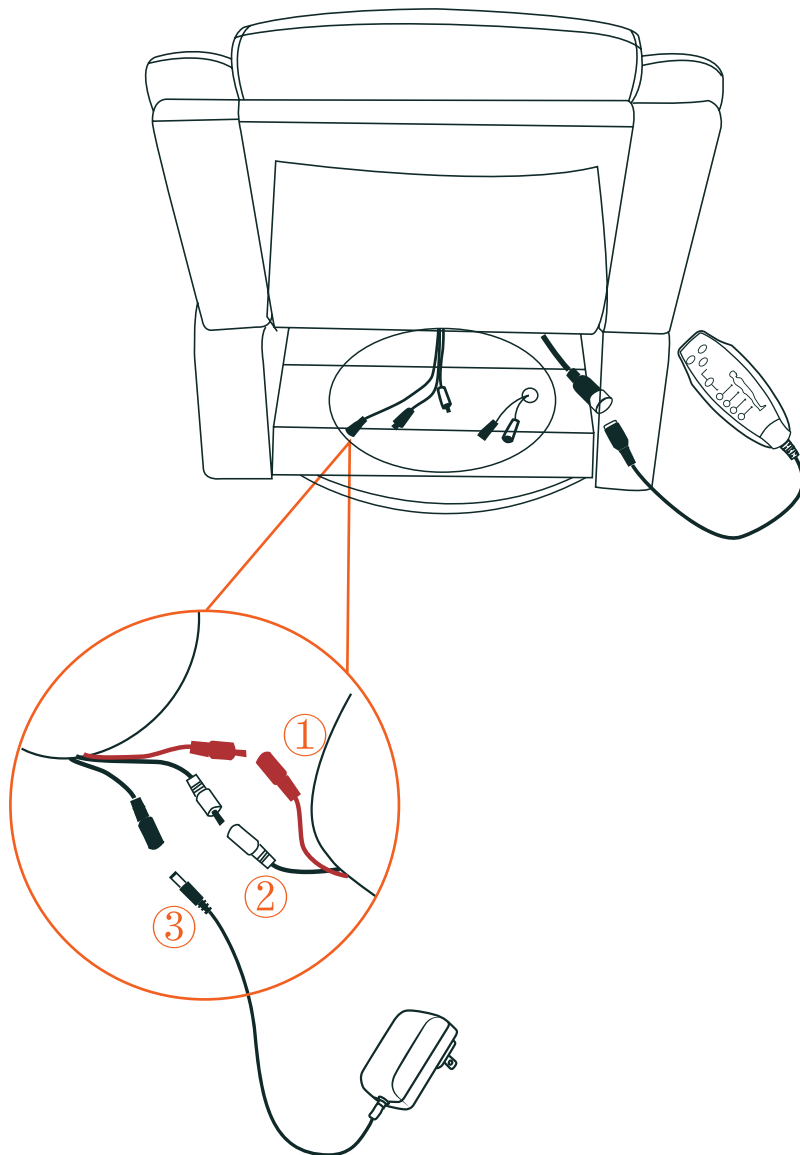

ASSEMBLY INSTRUCTIONS

Step 5

Now the sofa is successfully assembled.

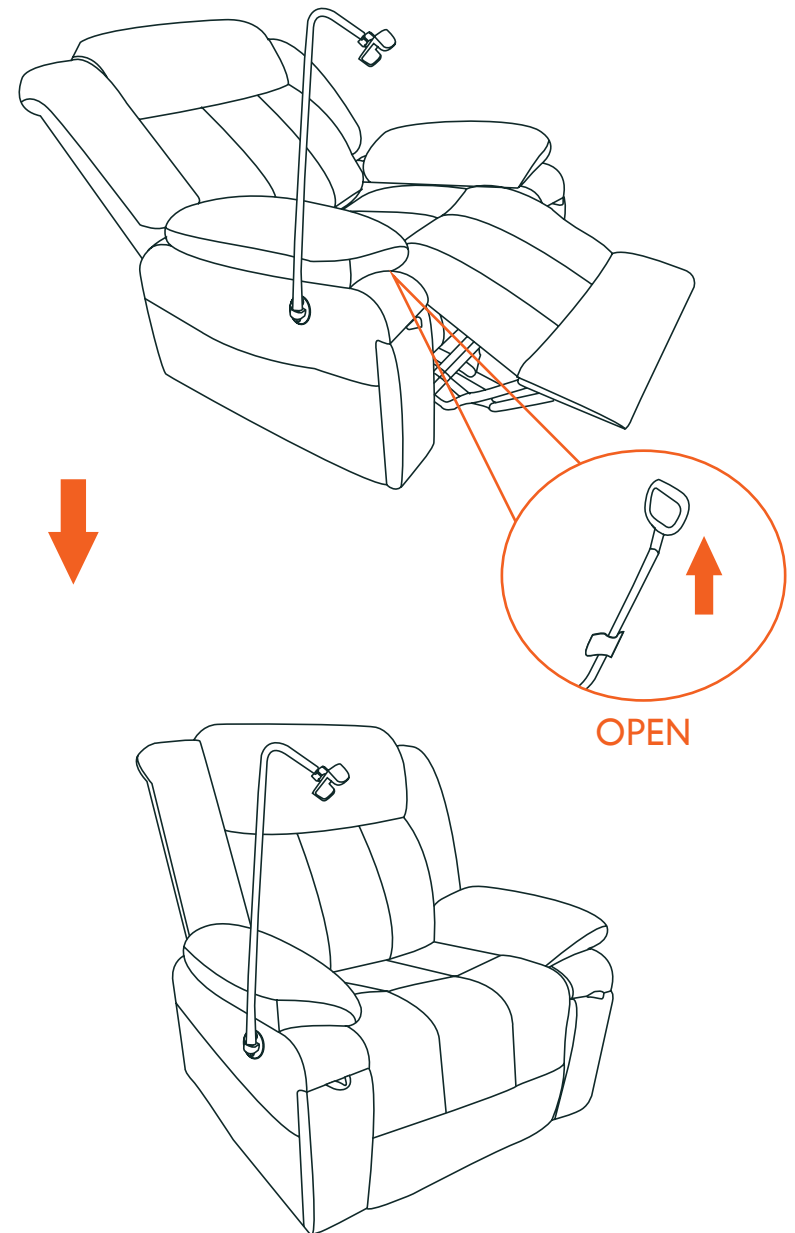

PRODUCT DETAILS

1.Extended:

Pull up the handle between the Right Arm and Sofa Seat while leaning back.

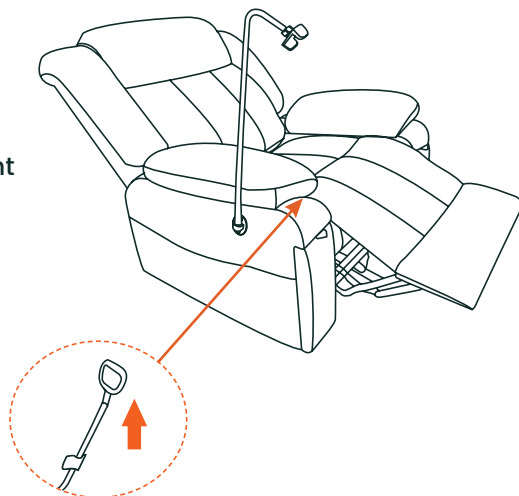

2.Retracted:

Kick the pedal down with your lower legs to bring the sofa back to its original state.

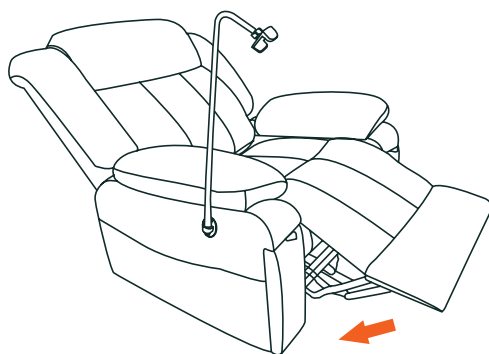

PRODUCT DETAILS

3. Storage and Cup Holder:

- 1.Opening the armrest reveals a storage compartment.
2. Open the front end of the armrest to expose the cup holder.

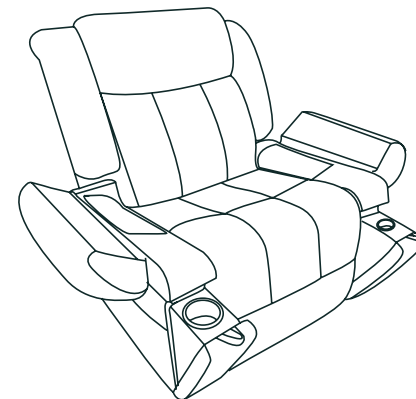

USAGE INSTRUCTION

REMOTE CONTROL Function of remote

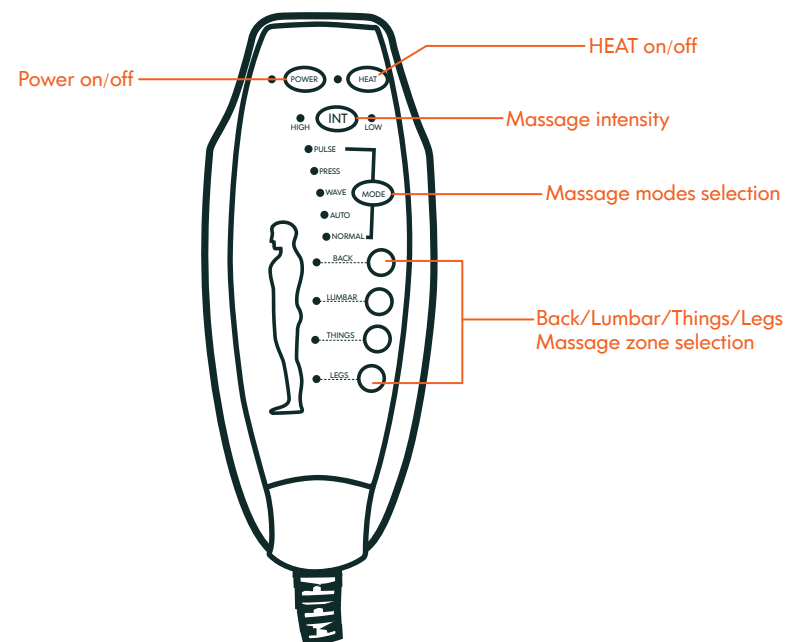

LIMITED WARRANTY

We promises to repair or replace any chair that is found to be defective in material or workmanship within one year from the date of original purchase so long as you, the original purchaser, still owns it. This is your sole and exclusive remedy. This warranty is subject to the provisions below.

EXCLUSIONS

This warranty does not apply and no other warranty applies to:

- Normal wear and tear, which are to be expected over the course of ownership.
- Misuse, abuse, or excessive use of the product.
- Modifications or attachments to the product that are not approved by COLAMY.
- Products that were not installed, used, or maintained in accordance with product instructions and warnings.
- Products used for rental purposes or unauthorized retail activities.

LIMITED WARRANTY

If the product is faulty when you receive it, please contact us and we will help you out.

We reserve the right to give a partial refund in cases when the product(s) is not in an unused condition, is damaged or has missing parts, not due to our error.
