

# ASSEMBLY INSTRUCTIONS

# EEI-6523

V0.04.06.23

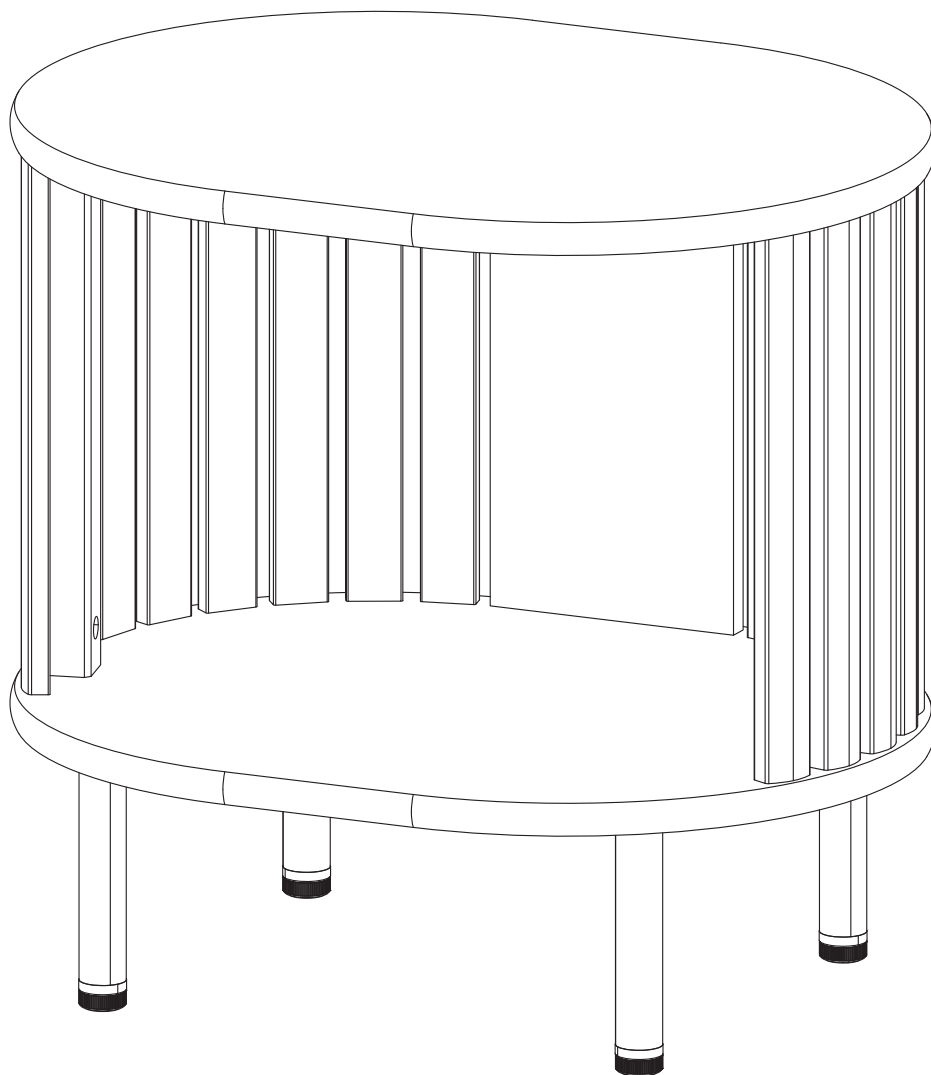

**Questions? Contact us!**

609.256.9000 • [cs@modway.com](mailto:cs@modway.com)  
[www.modway.com](http://www.modway.com)

\*modway



Read through all of the instructions before starting



Care instructions are listed in the last step of this manual



Approx. 45 minutes assembly time



Make sure you have all parts and components before discarding any packing materials



1 people recommended for assembly

**Only use hand tools to assemble this item.** Do not use power tools. Do not tighten bolts or screws completely until all hardware is lined up and inserted into the holes.

Do not over-tighten screws and bolts to avoid stripping the hardware or cracking the item.

Assemble your item on a flat, carpeted area, with plenty of space to work. This will prevent damage and scratches to your floors or the item while you're assembling the product.

Keep all components and packaging out of reach of children or animals to avoid risk of choking or suffocation.

## Furniture components:

1	Top Board	x1
2	Bottom Board	x1
3	Bar Side 1	x2
4	Bar Side 2	x16
5	Back Board	x1

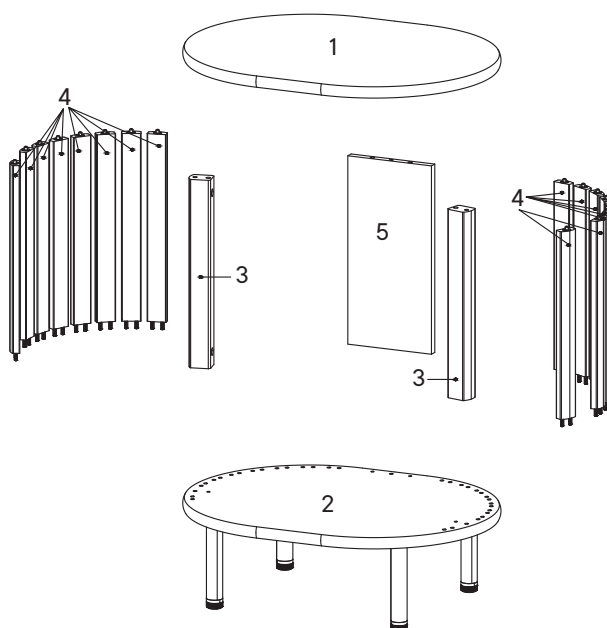

## Provided hardware:

A		Cam Bolt Ø6 x 35 mm	x8
B		Cam Lock Ø12 mm	x4
C		Cam Lock Ø15 mm	x4
D		Wood Dowel Ø6 x 30 mm	x6
E		Screw M 4.5 x 12.5 mm	x16
F		Screw Cap Ø15 mm	x4
G		PVC Sheet	x2
LM14A1		Leg Metal	x4

## What you need:



**Wait!**

Missing parts or hardware? Need assistance?  
Contact us before returning your item. We're here to help!  
609.256.9000 • cs@modway.com

# Step 1

## HARDWARE

- A** Cam Bolt  $\varnothing 6 \times 35$  mm x8
- D** Wood Dowel  $\varnothing 6 \times 30$  mm x2

## COMPONENTS

- 1** Top Board x1
- 2** Bottom Board x1
- 5** Back Board x1

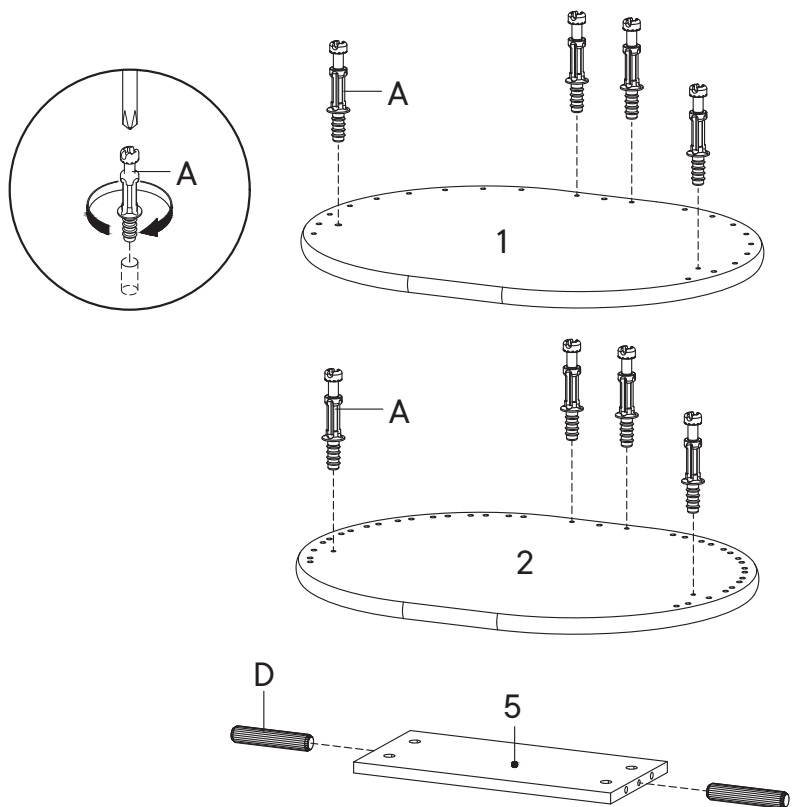

# Step 2

## HARDWARE

- D** Wood Dowel  $\varnothing 6 \times 30$  mm x4

## COMPONENTS

- 3** Bar Side 1 x2

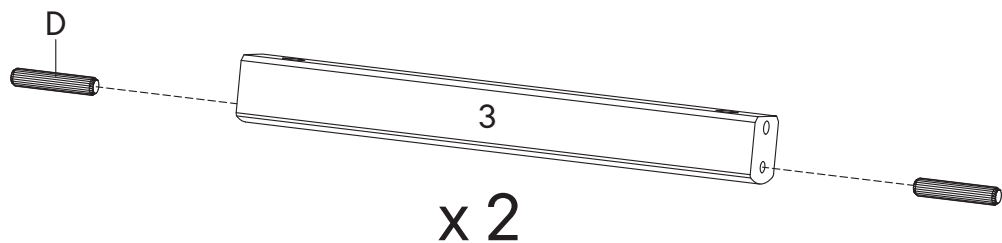

## Step 3

### HARDWARE

- B** Cam Lock Ø12 mm x2
- C** Cam Lock Ø15 mm x2
- F** Screw Cap Ø15 mm x2

### COMPONENTS

- 1** Top Board x1
- 3** Bar Side 1 x2
- 5** Back Board x1

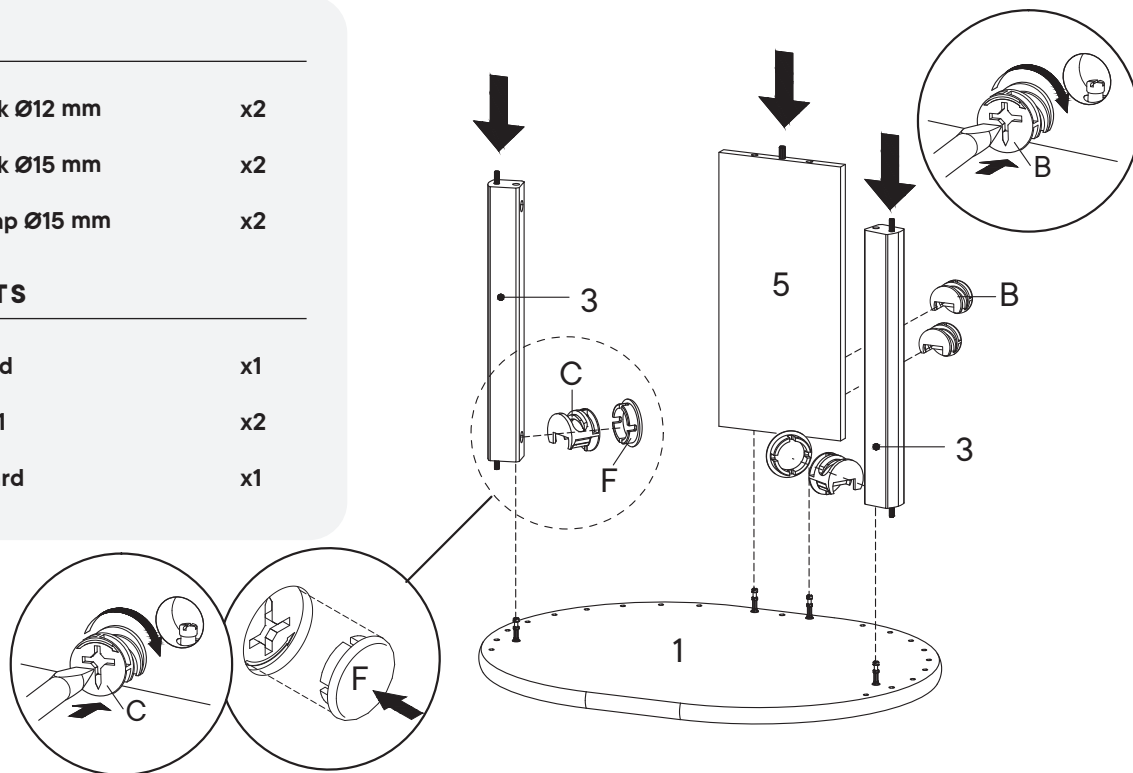

## Step 4

### HARDWARE

- B** Cam Lock Ø12 mm x2
- C** Cam Lock Ø15 mm x2
- F** Screw Cap Ø15 mm x2

### COMPONENTS

- 2** Bottom Board x1

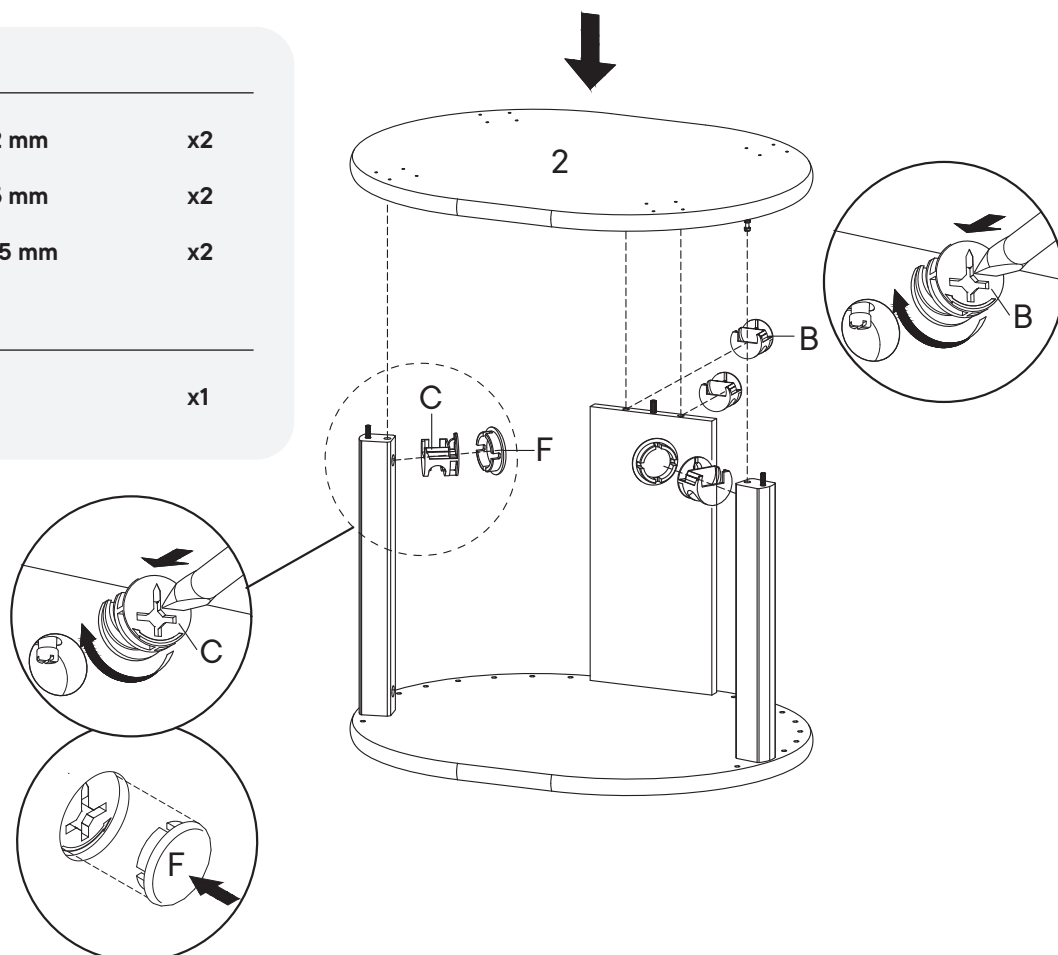

# Step 5

## HARDWARE

- E** Screw M 4.5 x 12.5 mm x16
- LM14A1** Leg Metal x4

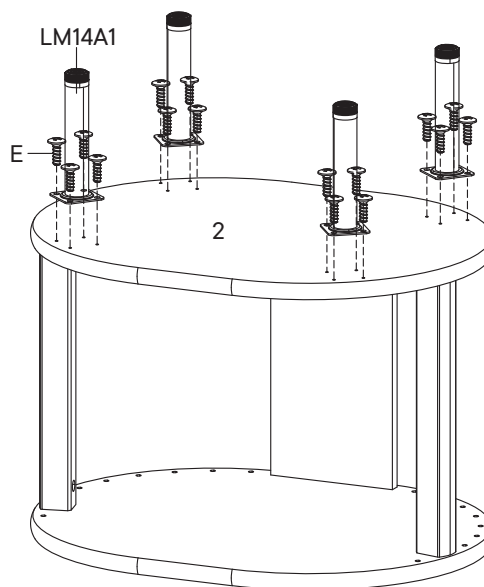
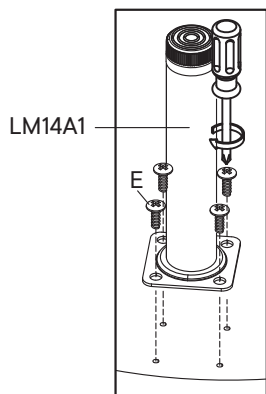

# Step 6

## HARDWARE

- G** PVC Sheet x2

## COMPONENTS

- 4** Bar Side 2 x16

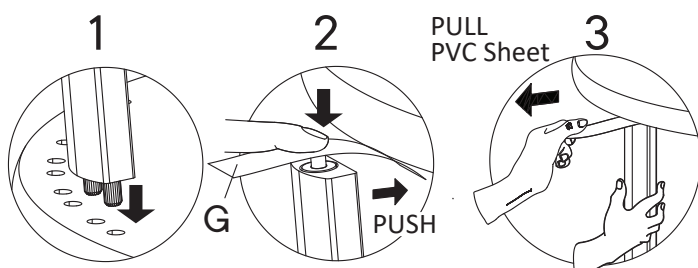
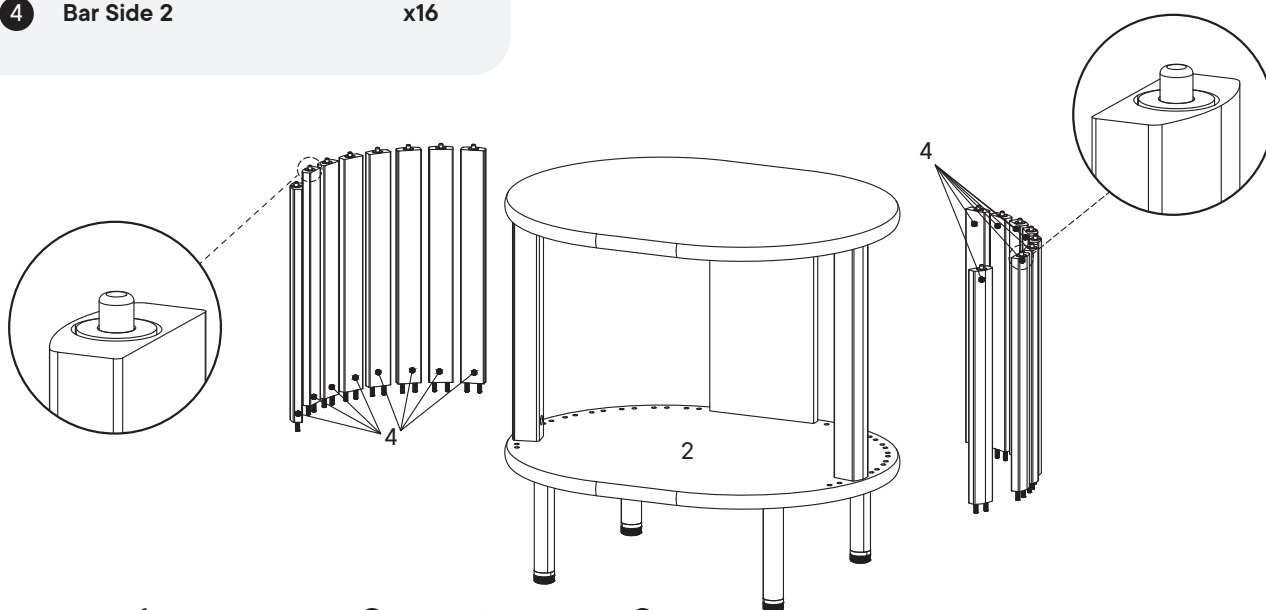

## Step 7

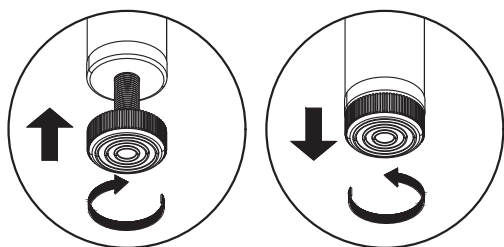
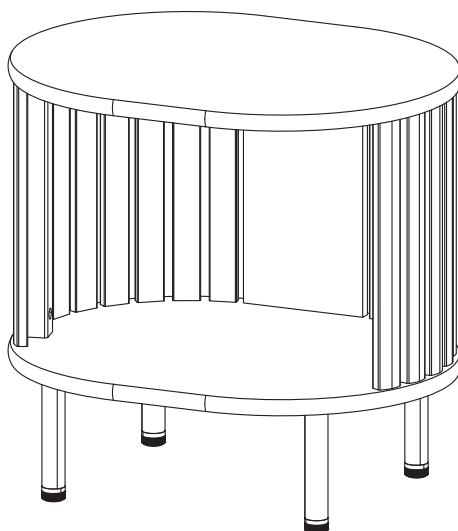

## Great job!

Side Table assembly is complete.

### ♥ CARING FOR YOUR ITEM

Indoor use only.

Not contract grade.

Clean using a non-abrasive cloth and a mild cleaner.

Never use harsh chemicals, as they could damage the finish or integrity of the item.

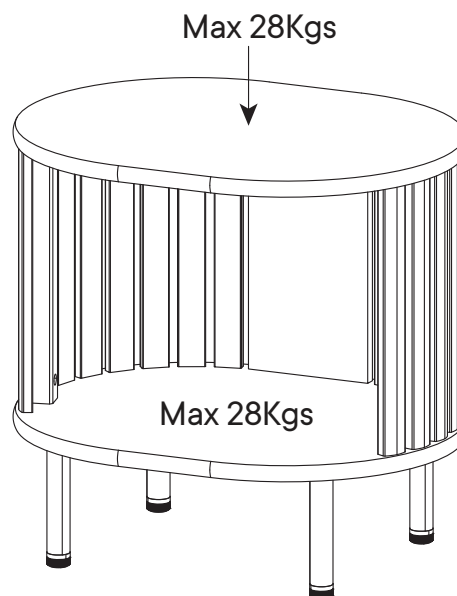

CONNECT WITH US!   

Tag us @modway\_furniture and #modway for a chance to be featured.