

Assembly Instruction

Tools Required: Flathead screwdriver, Phillips screwdriver, pliers, wire cutters, wire strippers, electrical tape, safety glasses.

Light Source: (3) A19 Medium Base 100W Maximum. Alternate Bulbs (3) 23W CFL.

Estimated Assembly Time: 30-45 minutes

Preparation: Identify and inspect all parts before beginning installation. Check package content list and diagrams below to be sure all parts are present. If any parts are missing or damaged, do not attempt to assemble, install, or operate the fixture. Contact customer service for replacement parts.

⚠ Warnings and Cautions

Turn off electricity at circuit breaker or main fuse box before installation. Consult a licensed electrician if in doubt.

These instructions are provided for your safety. It is very important you read them completely before installing the fixture. We strongly recommend that a licensed, professional electrician perform the installation.

Disconnect fixture from power source before replacing bulbs. Make sure bulbs are given sufficient time to cool before removal. Do not subject glass parts to any shock while in operation or shattering may result.

Package Contents

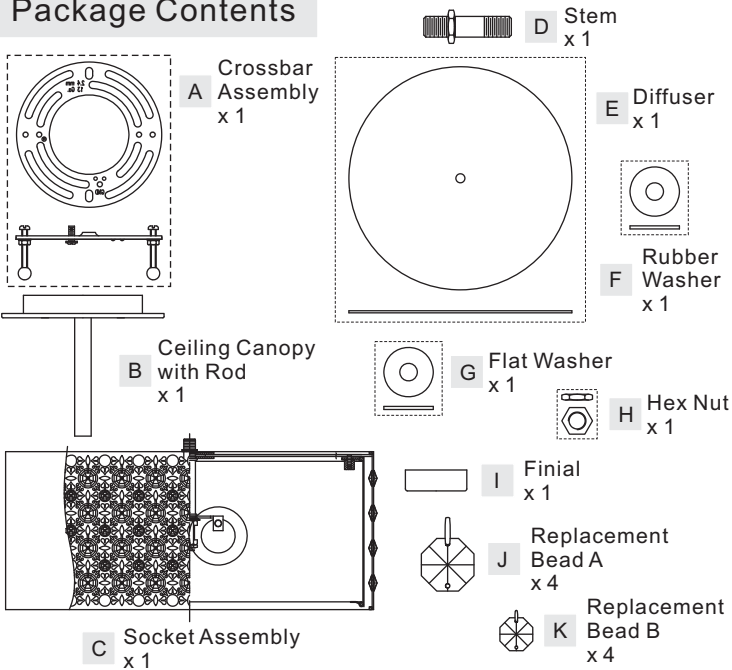

STEP 3 - Test Fitting Ceiling Canopy to Crossbar Assembly

A. Remove mounting balls from the Crossbar Assembly (A). Fit the Ceiling Canopy to the Crossbar Assembly (A) and secure with mounting balls. Note: The Ceiling Canopy should be snug against the ceiling and the mounting balls. If not, adjust the length of the mounting screws on the Crossbar Assembly (A) by unscrewing the preassembled hex nut and lock washer and then screwing the mounting screws in or out of the crossbar until the correct length is achieved. Once the Ceiling Canopy is secure, remove the mounting ball and ceiling canopy and proceed to Step 4.

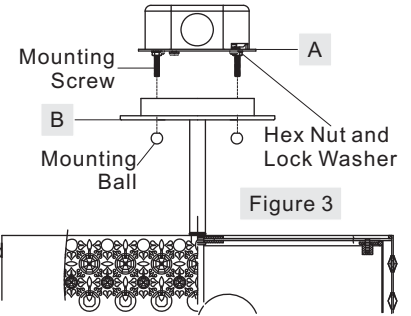

STEP 4 - Wire Connections

A. Use standard wire connectors (not included) to make all wire connections. (Connectors are not included with fixture.) Twist connectors until wires are tightly joined together. Wrap each connection with approved electrical tape and carefully stuff all the connected wires into the Outlet Box.

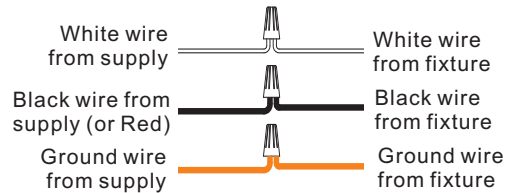

Figure 4

STEP 1 - Attach Ceiling Canopy with Rod to Socket Assembly

A. Threading Ceiling Canopy with Rod (B) onto the Socket Assembly (C) and hand tighten until snug.

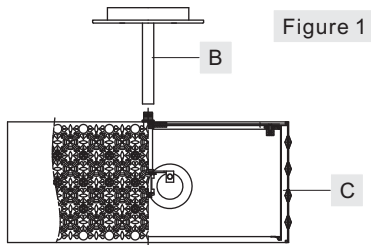
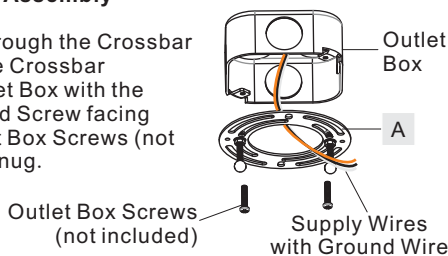

Figure 1

STEP 2 - Install Crossbar Assembly

A. Pass the supply wires through the Crossbar Assembly (A). Attach the Crossbar Assembly (A) to the Outlet Box with the head of the Green Ground Screw facing you. Secure it with Outlet Box Screws (not included). Tighten until snug.

Figure 2



STEP 5 - Install Diffuser and Bulb

A. Thread the Hex Nut end of the Stem (D) onto the bottom center of the Socket Assembly (C). By using pliers, thread the Hex Nut against the Socket Assembly (C) and hand tighten until snug.

B. This fixture uses standard bulb with standard screw base. Maximum 100 watts. Insert bulb and screw snugly into place.

C. Place the Diffuser (E) over the

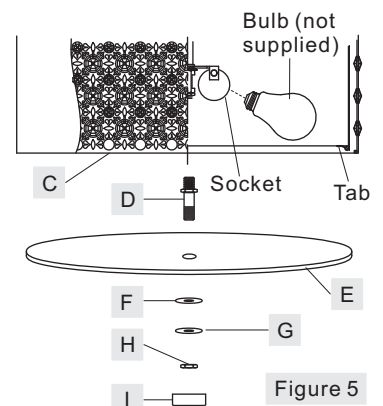

Figure 5

(Step 5 Continued)

Stem. Attach the Diffuser (E) to Tabs on the bottom edge of the shade. Place the Rubber Washer (F) and the Flat Washer (G) onto the Stem (D) as shown, secure by threading Hex Nut (H) onto the Stem (D). Hand tighten until snug.

D. Thread the Finial (I) onto the Stem (D) and hand tighten until snug.

Your fixture is now assembled and ready to use. Enjoy!

FINISH: POLISHED NICKEL

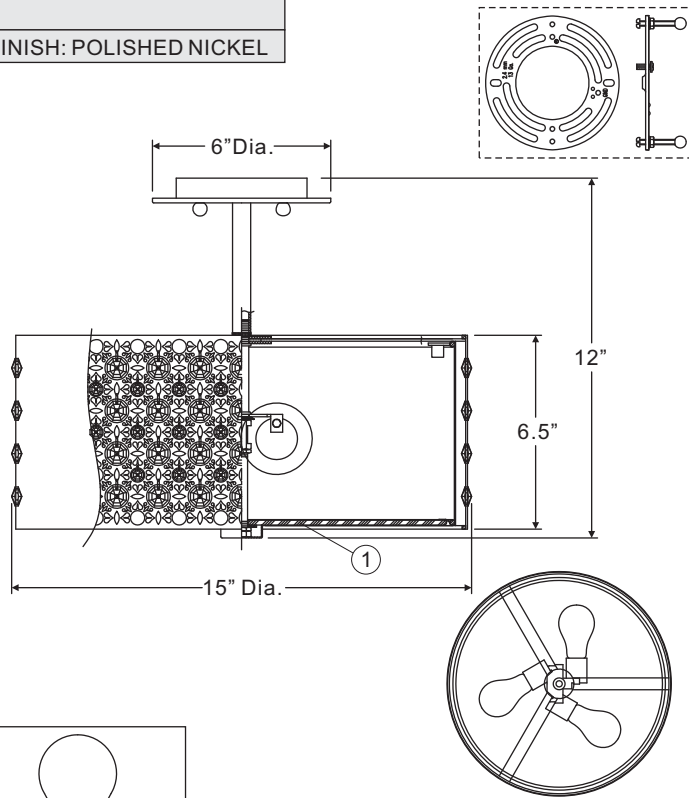

NOTE: ALL DIMENSIONS ARE ROUNDED UP TO THE NEAREST 1/4"

(3) 100W Medium Base Bulbs (Not Supplied)

NO.	PART NUMBER	REPLACEMENT PART	QTY.
1		DIFFUSER	1