

GENERAL

This controller system provides safe and convenient remote on/off switching of two 120 V load. The system consists of the following:

Controller, P/N SAFPAC272
Air Transmitter, P/N MPT-3428
Air Hose, 6 feet, P/N TU7-006

OPERATION

The control system works on a sealed air displacement principle. As the air transmitter button is pressed and released, sealed air is displaced and is transmitted through the interconnecting air hose, to the pressure sensitive electrical switch, completing the electrical circuit and turning the disposer on and the second device off. The circuit will remain energized until the air transmitter button is depressed and released again, turning the disposer off and the second device on.

CAUTION:

To avoid damage to this equipment, or the equipment being controlled, do not cycle rapidly.

INSTALLATION INSTRUCTIONS

Read all instructions before installing control system.

1) The air transmitter must be mounted within 6 feet of the controller outlet. Select a location which is convenient for user operation and easily accessible for service and/or removal. See Fig. 3

2) Drill a 1-1/4" to 1-3/8" diameter hole at the transmitter mounting location selected. The air transmitter body can be mounted through surfaces from 1/16 in. to 2 in. thick.

3) Remove the mounting nut from the air transmitter. Insert the threaded body through the mounting hole and re secure the mounting nut.

4) Connect one end of the air hose (supplied) to the fitting on the air transmitter. See Fig. 2 for additional information.

5) Route the air hose to the controller in a convenient path where it will not be kinked, cut, or become disconnected. Attach the remaining end of the air hose to the fitting on the controller. See Fig. 1.

6) Plug the controller into a dedicated, grounded, 120 V AC outlet which is continuously energized.

7) Plug the disposer into the controller.

CAUTION: The disposer may begin to operated. If it does, simply press and release the air transmitter button to turn the disposer off.

8) Be sure that the control system is operating properly before using the disposer. Press and release the air transmitter to turn the disposer on and the second device off. Press and release the air transmitter again to turn the disposer off and the second device on.

Electrical Rating
15 Amps (non-inductive) @120 V AC

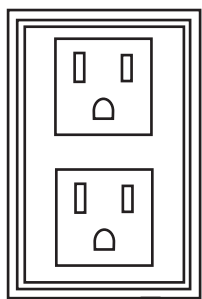

Air Hose to Controller

Fig. 1

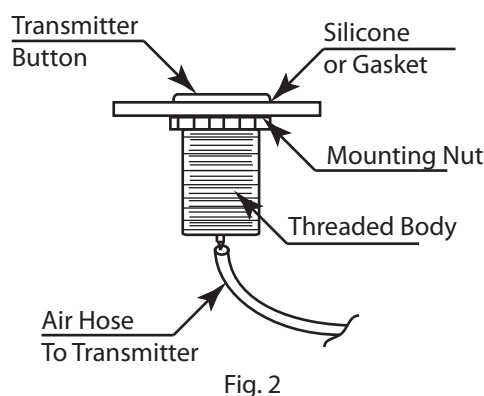

Fig. 2

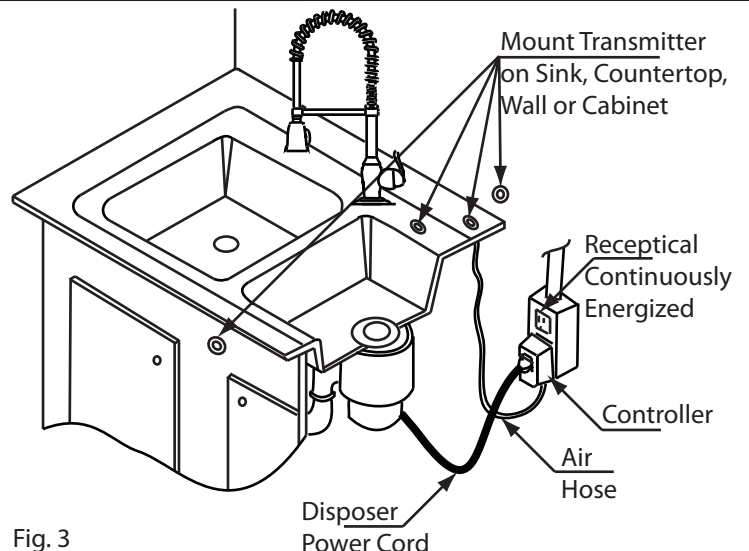

Fig. 3
Typical Mounting

WARNING - TO AVOID RISK OF INJURY

- Use indoors in dry locations only.
- Do not exceed specified electrical ratings.
- Do not crimp or damage the interconnecting air hose.
- No user servicable components inside controller.
- Opening controller will void manufacturer's warranty

DESCRIPTION:

Westbrass decorative ASB DUAL OUTLET is a simple and convenient remote on/off air switch. The unit plugs into any standard household wall receptacle. Any 120V, 1HP motor can be plugged directly into either of the MT 951 receptacles. Pressing a remote AIR BUTTON will alternately activate or deactivate two pieces of equipment.

BUTTON CONTROL DISTANCE STANDARD:

#4	#10	#15
n/a	15ft	15ft

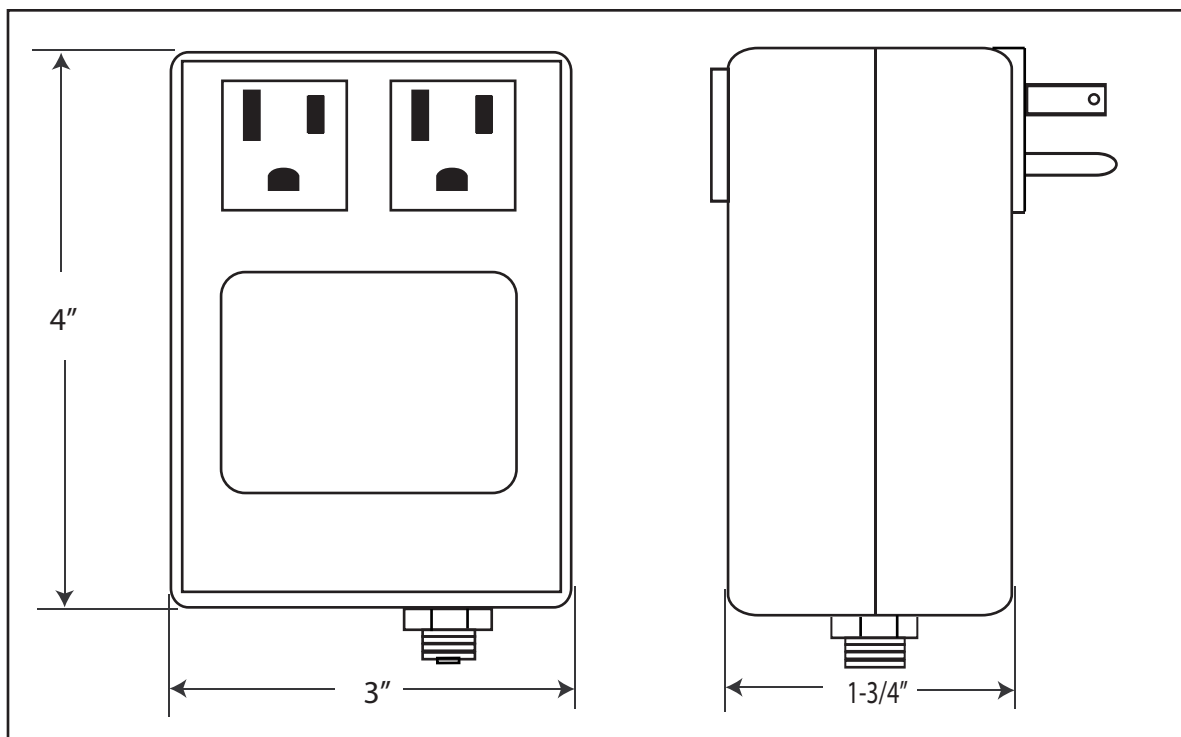

TYPICAL INSTALLATION:

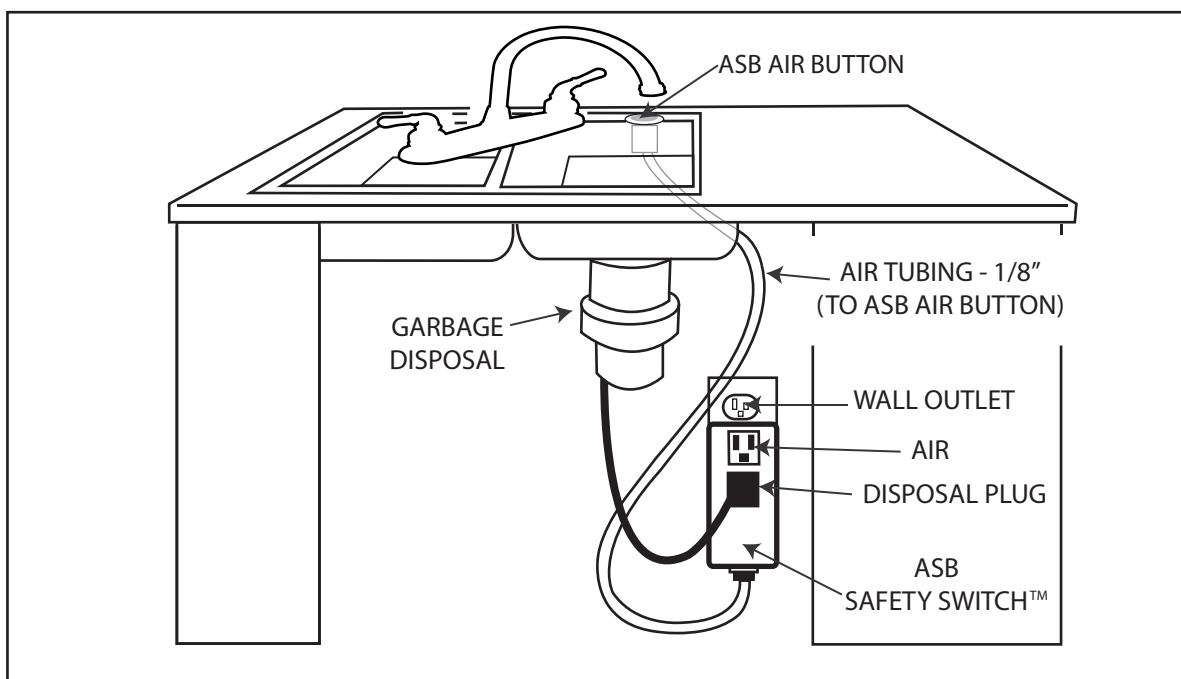

READ AND SAVE THESE INSTRUCTIONS

WARRANTY

Allied Innovations, LLC warrants its products to be free from defects in workmanship and material under normal use and conditions for a period of one year from the date of original manufacture. Should repair be required by reason of any defect or malfunction during the warranty period, allied Innovations, LLC will repair, or at their discretion, replace this product without charge, subject to verification of the defect or malfunction, upon delivery of the product to the attention of:

The Westbrass Company
2429 E. Olympic Blvd.
Los Angeles, CA 90021

If repair is required after the expiration date of the warranty period, Allied Innovations, LLC will repair this product and bill for any necessary replacement part, shipping and handling.

This warranty is void if:

- 1) the unit is not installed per instructions;
- 2) is hooked up to improper voltage;
- 3) is subjected to chemical corrosion;
- 4) is mechanically or electrically altered in any way;
- 5) is subjected to water or immersion;
- 6) contacts show evidence of short circulating, or the unit has been visibly damaged by accident or misuse or which been damaged by wind, rain, lightening, freezing or other cause; or upon which the serial number or manufacture date has been altered, effaced or removed. There is a charge for replacement parts if the defective unit is returned for any of the reasons listed above.

Allied Innovation, LLC shall not be liable for any inconvenience, loss of time, or incidental expenses incurred. Allied Innovations, LLC shall not be liable for any labor charges associated with the removal or re-installation of any so-called defective products.

This is the only warranty expressed or implied by Allied Innovations, LLC. Warranties implied under state law, including any implied warranty or merchantability or fitness for a particular purpose, shall be limited to one year from the dated of manufacture.

Allied Innovations, LLC disclaims and liability for any incidental or consequential damages.

Ship as follows:

1. Pack the unit in a well padded, heavy corrugated box.
2. Include name, return address, and daytime phone number along with a short description of problem with control.
3. Mail the unit, prepaid, to the above address.

Some states do not allow the exclusion or limitation of incidental or consequential damages, therefore the above limitation may not apply to you.