

# CAUTION: IMPORTANT SAFETY INSTRUCTIONS

## READ AND FOLLOW ALL SAFETY INSTRUCTIONS

- Do not use seasonal products outdoors unless marked suitable for indoor and outdoor use. When products are used in outdoor applications, connect the product to a Ground Fault Circuit Interrupter (GFCI) outlet. If one is not provided, contact a qualified electrician for proper installation.
- This seasonal use product is not intended for permanent installation or use.
- Do not mount or place near gas or electric heaters, fireplaces, candles or other similar sources of heat.
- Do not secure the wiring of the product with staples or nails, or place on sharp hooks or nails.
- Unplug the product when leaving the house, when retiring for the night, or if left unattended.
- Do not let lamps rest on the supply cord or any wire.
- **CAUTION:** This is an electrical product – not a toy! To avoid risk of fire, burns, personal injury and electric shock, it should not be played with or placed where small children can reach it.
- Do not use this product for other than its intended use.
- Do not hang ornaments or other objects from cord, wire or light string.
- Do not close doors or windows on the product or extension cords as this may damage the wire insulation.
- Never operate this product if the power cord or plug is damaged.
- Use only manufacturer specified replacement bulbs.
- Read and follow all instructions that are on the product or provided with the product.

### USE AND CARE INSTRUCTIONS

- When storing the product, carefully remove the product from wherever it is placed, avoiding any undue strain or stress on the product conductors, connections, and wires.
- When not in use, store neatly in a cool, dry location protected from sunlight.

**IMPORTANT NOTE:** Some unassembled section pieces have light string wires strung between them. Be careful not to put unnecessary strain on the wires during assembly procedures.

### Assembly (Diagram 1)

1. Attach the two lower sections of angel together by inserting rods at bottom front of section into loops in bottom of back section (A).
2. Attach the middle section of angel to bottom section by sliding the hooks located at the base of the middle section into and

under the frame of the bottom section and at the same time sliding the rod into the loop (B). Secure with locking pin.

3. Attach the angel upper section to the middle section (C) using the same procedure as in Step 2 above.
4. Attach the arms by inserting the rod on each arm into the appropriate loop (D). Between the two arms, insert the trumpet end into the loop in the angel head (E). Rest the hands on the trumpet.
5. Attach the wings by inserting the rods on each wing into the appropriate loops (F). Insert halo piece into loop on head (G).

Secure the assembled piece to the ground using the supplied stakes (Diagram 2).

Plug light string cords into a power supply. Plugs can be "piggy-backed" - - plugged into each other, and then into a receptacle.

Diagram 1

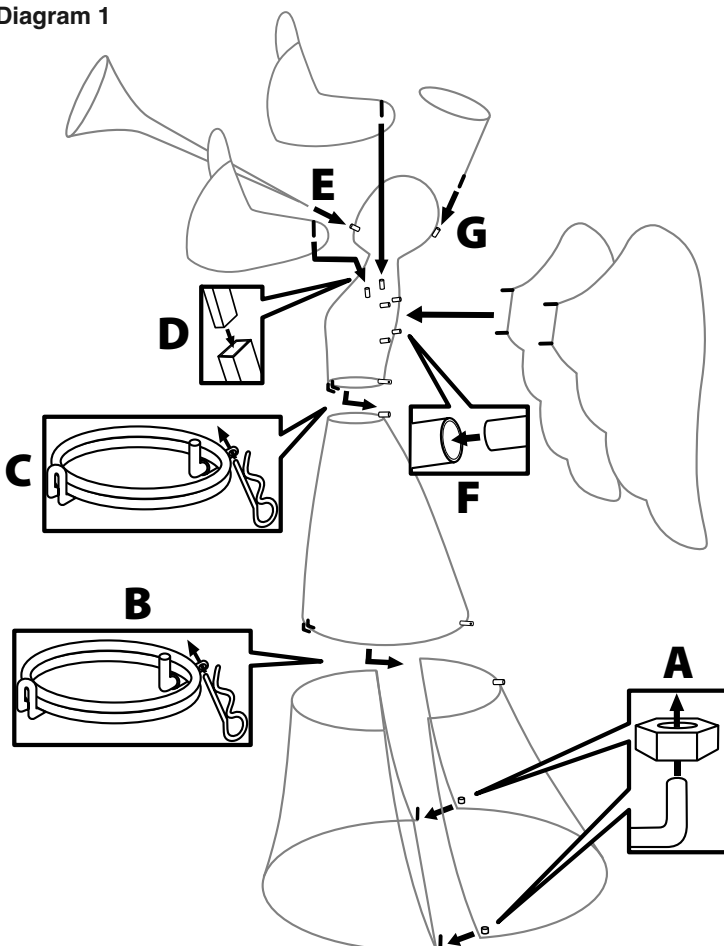

Secure display with ground stakes at points shown by dots (●).

Diagram 2

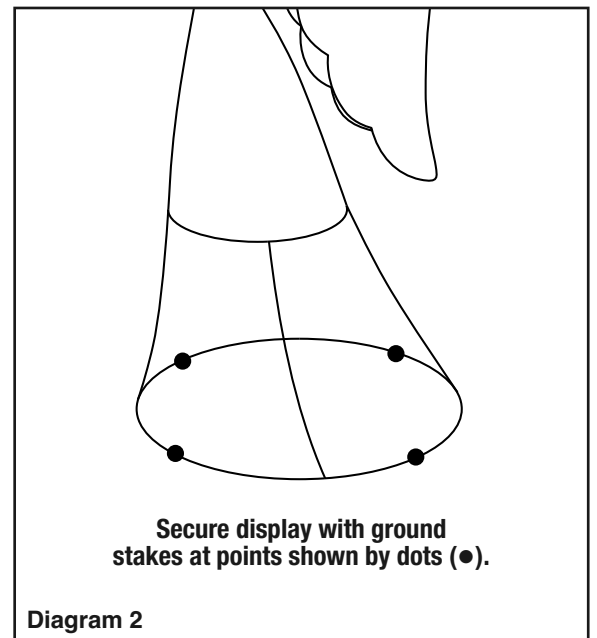

## Bulb Replacement

1. Unplug light string from power source.
2. Gently pull the bulb straight out of the socket (Figure 1).
3. Carefully insert new bulb into socket – bulb is keyed and only goes in one way (Figure 2).

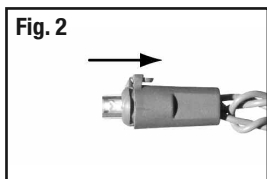
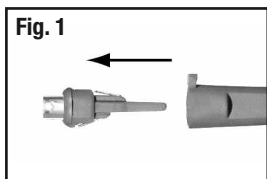

## Fuse Replacement

1. Unplug light string from power source.
2. Slide the fuse access cover away from cord side (in direction of arrow, Figure 3) exposing fuses.
3. Remove fuses from compartment and examine. Replace burnt out fuse with new one.
4. Close fuse compartment by sliding access cover back in towards cord side of plug (Figure 4).

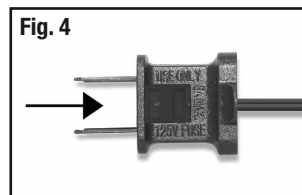
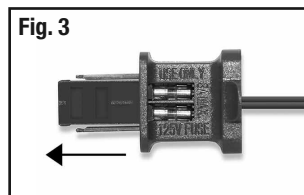

***SAVE THESE INSTRUCTIONS***