



# **Assembly Instruction Manual**

Please read instructions thoroughly before beginning assembly.

Check boxes carefully for contents listed. Some parts are packaged inside of others.

Assemble on a clean, flat, non-abrasive surface to prevent scratching.

## **Tools Required**

- Battery or Electric Drill (#2 phillips bit)
- Tape Measure
- Hammer or Rubber Mallet (Recommended)
- Shovel or Post Hole Digger (Recommended)
- PVC, Super or Crazy Glue

Part #	Description	Dimension	Box #	Qty
1	Left Post	2" sq. x 74"	1	1
2	Right Post	2" sq. x 74"	1	1
3	Top/Bottom Cross Rail	$\frac{7}{8}$ " x 1 $\frac{1}{2}$ " x 22"	1	2
4	Horizontal Slat	$\frac{1}{4}$ " x 1 $\frac{1}{2}$ " x 22"	1	7
5	Vertical Slat	$\frac{1}{4}$ " x 1 $\frac{1}{2}$ " x 66"	1	2
6	Ground Anchor	14"	1	2
7	Hardware Bag (Includes):		1	1
	▪ Post Cap	2" square		2
	▪ Painted Screw	1 $\frac{1}{4}$ "		4
	▪ Self-Tapping Painted Screw	#8 – 1"		4

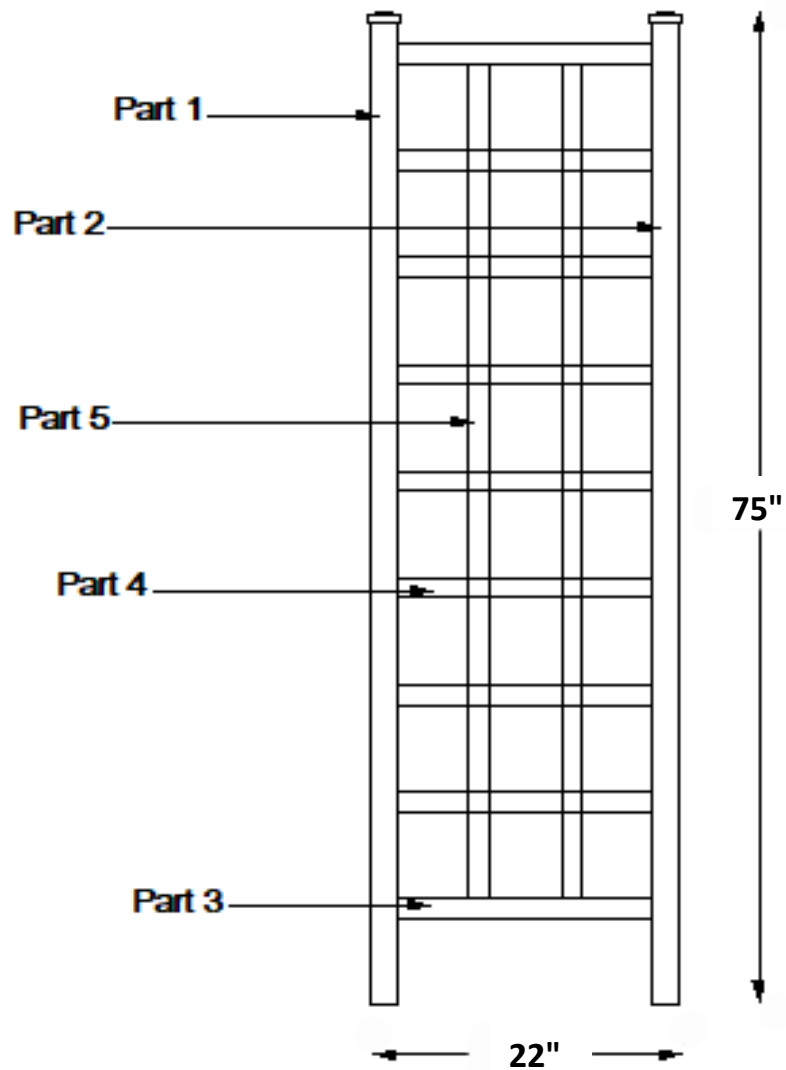

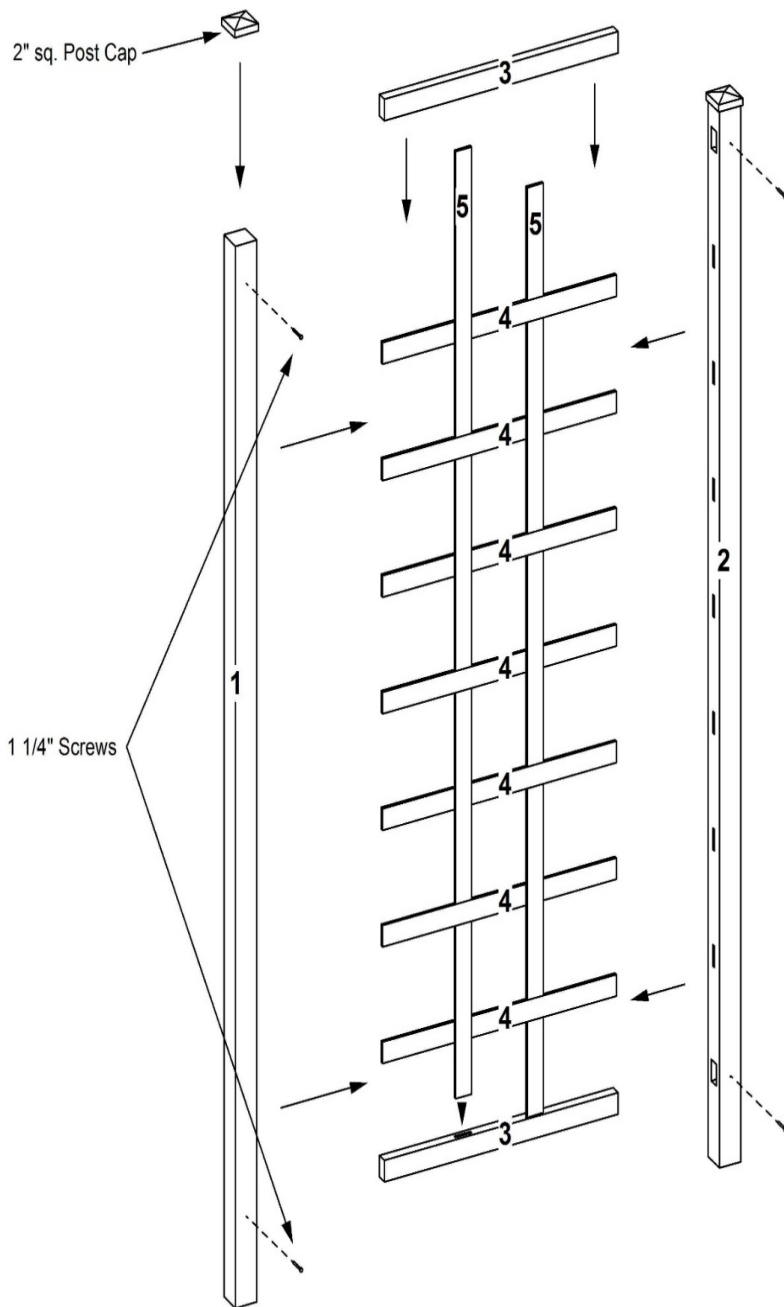

**1**

Lay out one 74" left post (part 1). Starting at bottom, insert one 22" top/bottom cross rail (part 3) and seven 22" horizontal slat (part 4). Insert free ends of bottom cross rail and horizontal slats into 74" right post (part 2).

**2**

Weave one 66" vertical slat (part 5) through horizontal slats. Insert end into left hole of bottom cross rail. Weave remaining 66" vertical slat (part 5) through horizontal slats opposite of left vertical slat. Insert end into right hole of bottom cross rail.

**3**

Separate tops of posts just enough to insert remaining 22" top/bottom cross rail (part 3) into top routed hole of each post.

**4**

Using two 1 1/4" screws per post, fasten together trellis. Be sure all parts are fully inserted into posts before fastening. Using PVC, super or crazy glue; glue post caps onto posts.



# Ground Anchor Installation

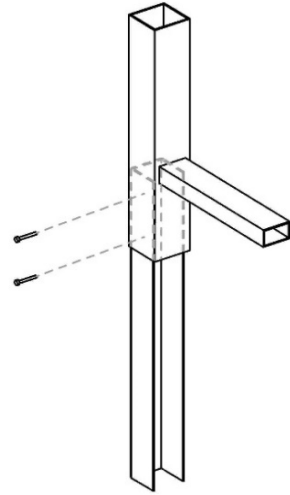
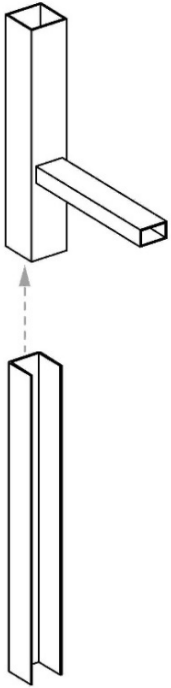

## Option 1 (soft ground)

Slide one ground anchor (part 12) into bottom of each post until it meets bottom cross rail. Using two 1" self-tapping screws per post, screw the post to ground anchor using the pilot holes for guides.

Using ground anchor installation layout drawing, dig holes approximately 12" deep. Set trellis in holes and level. Back fill with soil removed from holes.

## Option 2 (permanent installation)

***NOTE: There is very little room for error with this installation method.***

## Ground Anchor Layout Drawing

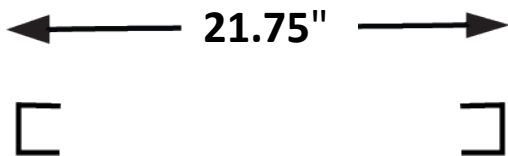

Using ground anchor installation layout drawing, dig holes 12" deep according to dimensions. Fill with cement and place ground anchors in wet cement. Be sure that ground anchors are straight and in accordance with dimension of ground anchor installation layout drawing. Allow cement to dry.

**Slide trellis over ground anchors. Using two 1" self-tapping screws, fasten post to ground anchor.**

# *Warranty Statement*

## **20 Year Guarantee**

Products are warranted to be free from manufacturing defects resulting in delaminating, peeling, flaking, corroding, cracking, crazing, or extreme amounts of fading or bleaching causing the PVC to change to its natural color for a period of 20 years from the date of purchase.

*Normal weathering is defined as exposure to sunlight and extremes of weather and atmosphere which will cause any colored surface to gradually fade.*

### **CONDITIONS NOT COVERED BY THIS WARRANTY:**

- A. Physical abuse, misuse, neglect, or improper storage.
- B. Improper installation or installation not in strict adherence to the instructions written.
- C. This warranty does not apply if materials are painted, varnished, or coated with any substance.
- D. is not responsible for damages to product during shipping.
- E. Damage attributable to atmospheric pollutants, hail, lightning, hurricane, tornado, wind borne objects, earthquake, fire, mildew, casualty, act of God, building or ground settlement, or subjection to stress or weight.

### **CLAIMS AND REMEDIES:**

Product is determined to have a manufacturing defect which is covered by this warranty, will replace the material containing the defect (labor not included) F.O.B from the point of manufacture. will not be responsible for any cost incurred in the removal or reinstallation of the product.

**Important:** All claims must be sent to the following address and should describe the defect claim.