

# Instruction

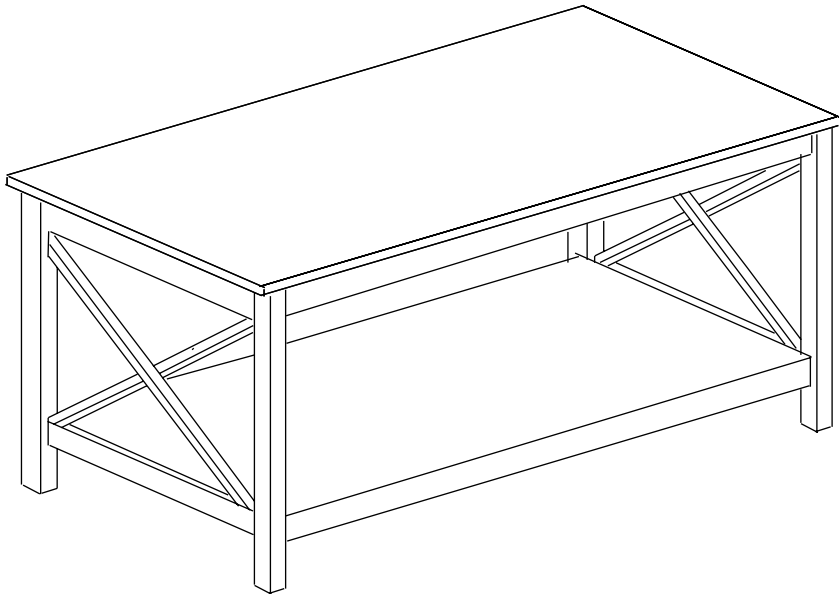

**PARTS -PIEZAS**

① x 1

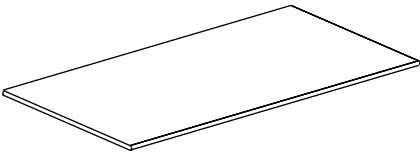

Top Panel

② x 2

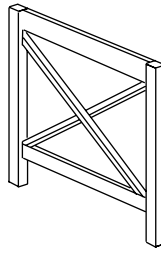

Side Panel

③ x 1

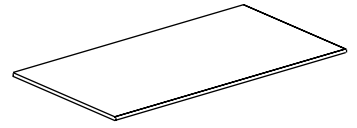

Shelf Panel

④ x 4

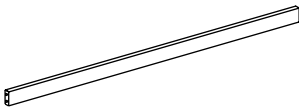

Cross Bar

**PARTS -PIEZAS**

A x 18



Cam Bolt

B x 18



Cam Lock

C x 24



Dowel

D x 12



Ø 0.16 x 1.97 inch

Actual Size

Screw

E x 4



Mat

1

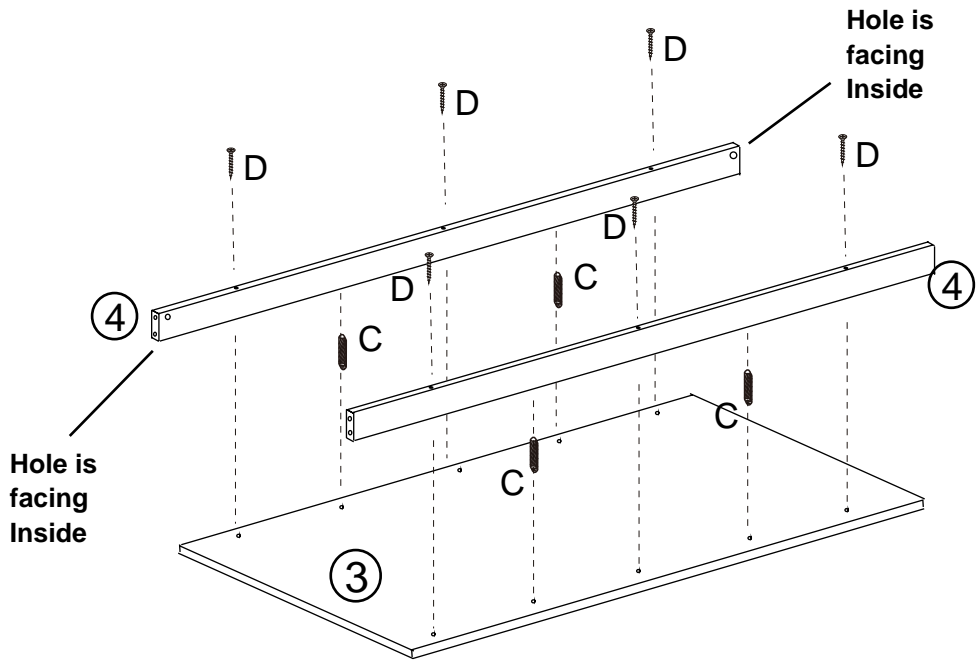

### Step 1

Have the shelf panel (3) upside down on a soft surface, such as carpet. Make sure there are not any sharp objects underneath. Insert dowels (C) into the holes on the shelf panel like the image.

Once the dowels are inserted, align the holes on the cross bars (4) to the inserted dowels, and connect them together. Tighten the cross bars to the shelf panel using screws (D).

**Note: Make sure all screws are tightened.**

2

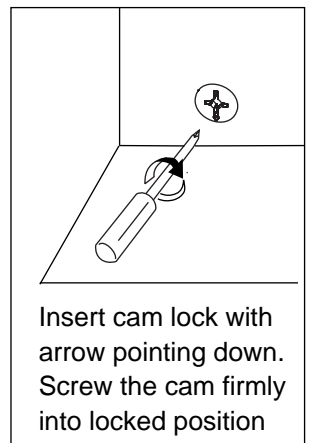
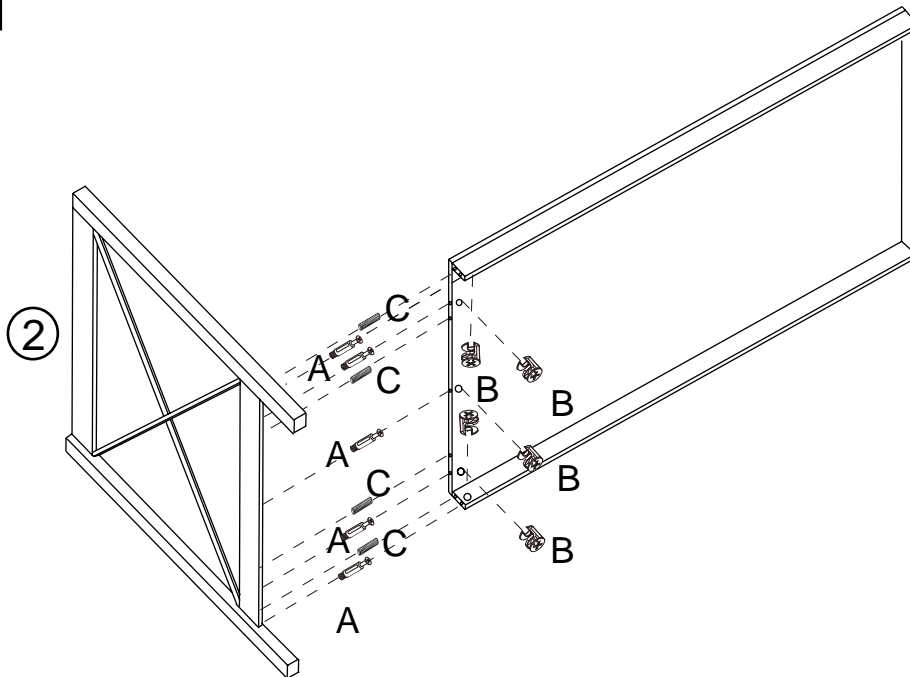

### Step 2

Insert cam bolts (A) and dowels (C) into the nine holes on the sides of the shelf panel like the image and attach the side panel (2) to the shelf panel by inserting the cam bolts and dowels into the holes on the side panel.

Once the shelf panel is attached to the side panel, insert cam locks (B) on the bottom side of the shelf panel to tighten them together.

**Note: Make sure cam locks are tightened.**

**3**

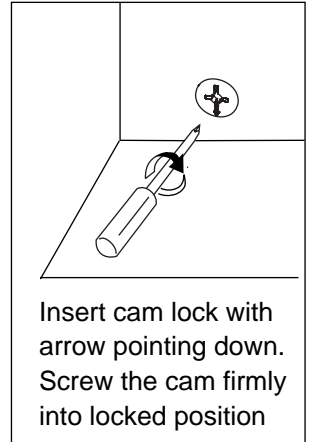
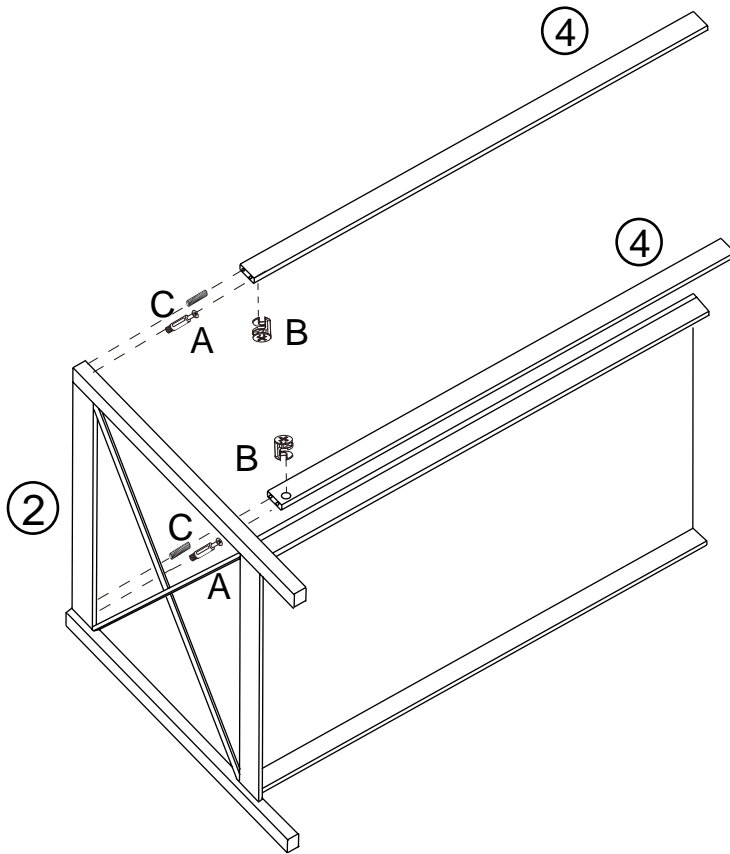

Insert cam lock with arrow pointing down. Screw the cam firmly into locked position

**Step 3**

Insert cam bolts (A) and dowels (C) into the holes on the sides of the cross bars (4).

Insert the attached cam bolts and dowels into the holes on the side panel and tighten them together using cam locks (B).

**Note: Make sure cam locks are tightened.**

**4**

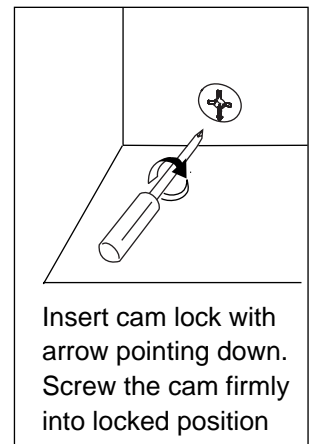
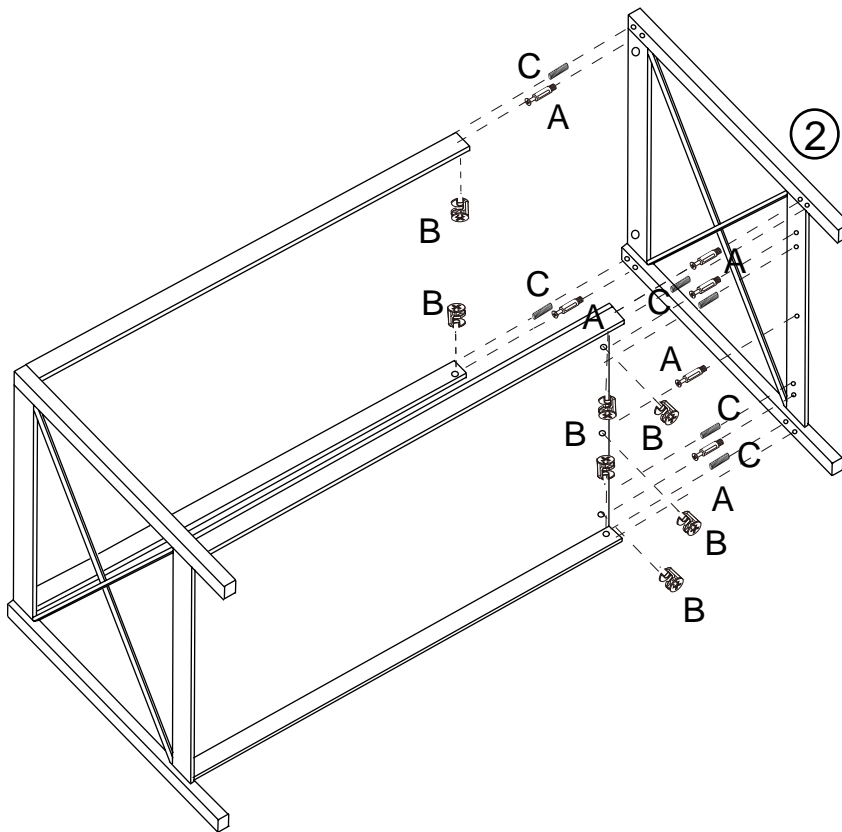

Insert cam lock with arrow pointing down. Screw the cam firmly into locked position

**Step 4**

Insert cam bolts (A) and dowels (C) into the holes on the other sides of the cross bars and shelf panel like the image.

Once all dowels and cam bolts are inserted, attach the side panel (2) to the cross bars and shelf panel.

Then, insert cam locks (B) into the holes on the inner side of the cross bars and the bottom side of the shelf panel to tighten them together.

**Note: Make sure cam locks are tightened.**

**5**

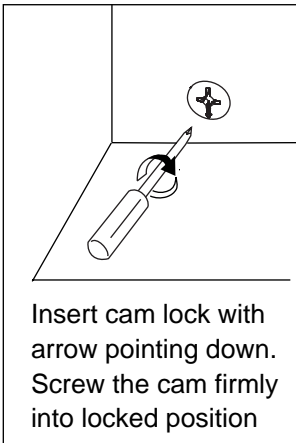
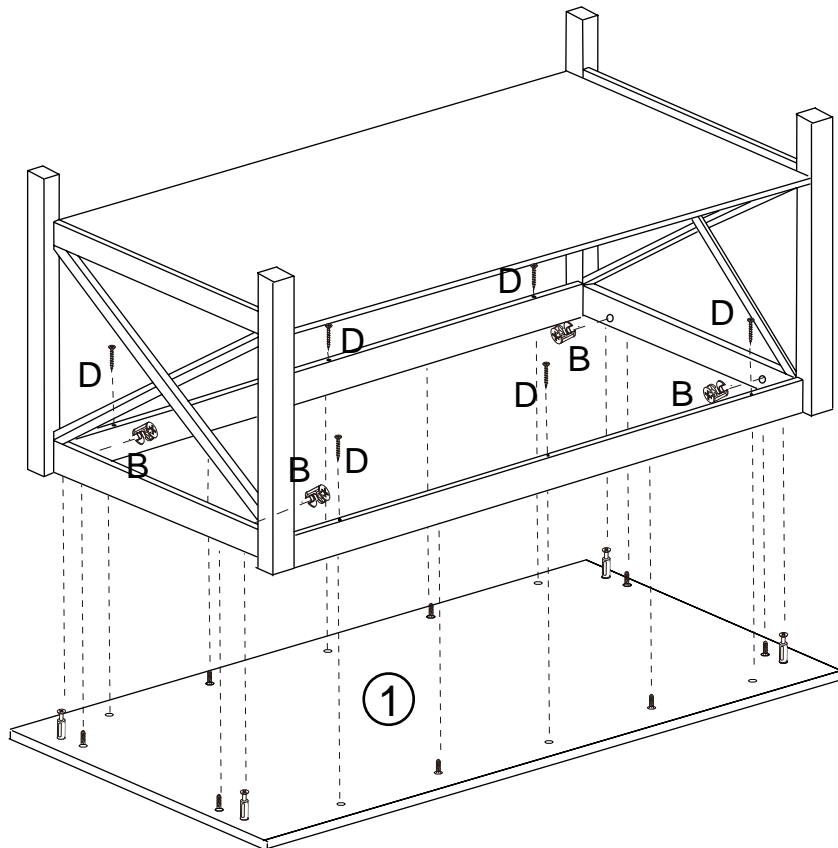
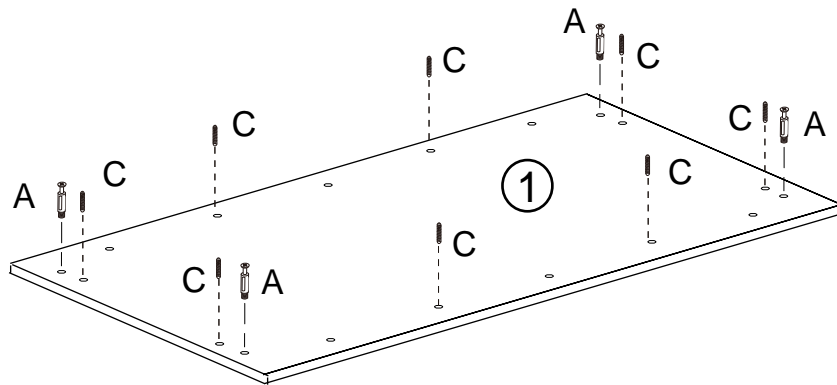

Insert cam lock with arrow pointing down. Screw the cam firmly into locked position

**Step 5**

Have the top panel (1) upside down on a soft surface, such as carpet. Make sure there are not any sharp objects underneath. Insert cam bolts (A) and dowels (C) into the holes on the top panel. Once all cam bolts and dowels are inserted in the holes, align them to the holes on the cross bars and side panels and connect them together. Insert cam locks (B) into the holes on the inner sides of the side panels and cross bars to tighten them together.

**Note: Make sure all cam locks are tightened.**

**6**

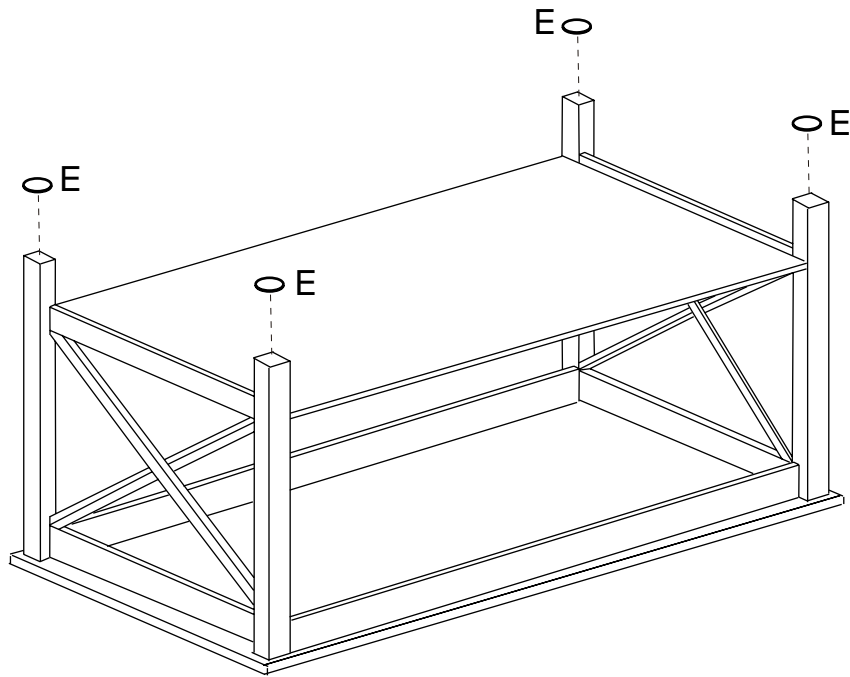

Attach the pads (E) when the table is assembled.

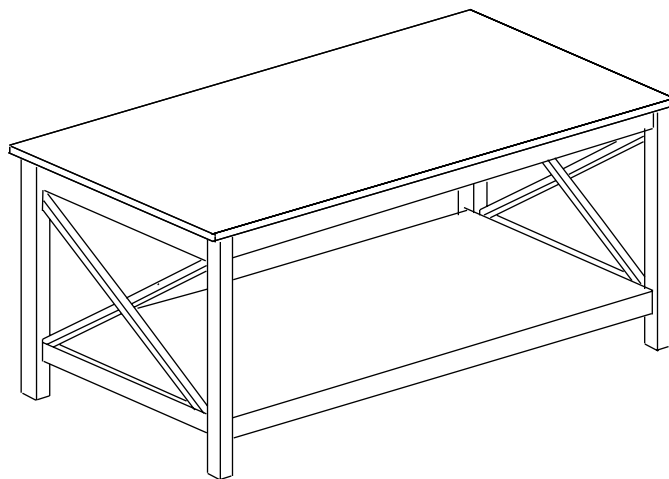

Your coffee table is now finished.  
Make sure all bolts and screws are secured tightly before using.  
**Do not sit or stand on top.**  
**Be sure to clean up any spills immediately.**  
Enjoy!